







Antarctica
51° 47' S 59° 31' W

Antarctica, South Georgia, and the Falklands

Join us for one of the grandest wild experiences the planet offers. Spend days immersed in the extreme beauty of the Antarctic Peninsula in the company of top naturalists and National Geographic Photography Experts. Expand the wonder with an exploration of South Georgia—where vast colonies of king penguins throng the beaches and Sir Ernest Shackleton rests for eternity. Cap that off with time spent in the windswept Falklands, awash in British charm and history.

From
\$ 19,106 / per person
Does not include flights

	DATES Feb, Oct and Nov		DURATION 22 Days
	SHIPS <i>National Geographic Endurance</i> <i>National Geographic Resolution</i> <i>National Geographic Explorer</i>		
	STARTS AT Ushuaia, Argentina	→	 ENDS AT Ushuaia, Argentina

Note: Some departures travel in the opposite direction. Please speak to an Expedition Specialist for details.

Highlights

- ★ Explore three distinct regions and benefit from our 50-plus years of experience here
- ★ Scan the skies for bird species and keep an eye on the sea for fin whales, southern right whales, and blue whales
- ★ Trace the story of Sir Ernest Shackleton's fateful journey in 1914 aboard *Endurance*, and toast his gravesite in South Georgia
- ★ October and November departures offer the possibility to 'park' the ship in the fast ice for a once-in-a-lifetime walk over the sea ice





Day by day

■ DAY 1

Buenos Aires, Argentina, or Santiago, Chile

Arrive in Buenos Aires, the cosmopolitan capital of Argentina, or Santiago, Chile's mountainous capital.

In Buenos Aires: Transfer from the airport to the Alvear Art, or similar (*National Geographic Endurance*).

In Santiago: Transfer to the Ritz-Carlton, Santiago, or similar (*National Geographic Resolution*).

Arrival Time: Arrive before 11:00 a.m. local time.

Arrival City: Buenos Aires, Argentina or Santiago, Chile

◇ DAY 2

Ushuaia, Argentina / Embark Ship

Join the recommended flight to Ushuaia, the southernmost city in the world, where you'll meet the ship; transfers to the airport and luggage assistance will be provided. Ushuaia's spectacular setting, between the jagged peaks of the Darwin Range and the protected waters of the Beagle Channel, makes it an appropriately wild place to begin your journey to the White Continent and a great destination in its own right. Visit Tierra del Fuego National Park. Lunch will be served onboard a private catamaran while cruising the Beagle Channel, where you'll be on the lookout for huge South American sea lions and birds like imperial cormorants.

Meals included: breakfast, lunch, dinner

◇ DAYS 3-4

At Sea

This 500-mile-wide strait between South America

and the Antarctic Peninsula is one of the most famous bodies of water in the world. Sometimes ferocious, sometimes flat calm, the Drake is always a fascinating place in its own right. This part of the journey is your best opportunity to see gorgeous seabirds like the wandering albatross, and you might be lucky enough to encounter killer whales or rare species of dolphins. This is also a day to get to know the ship and prepare for the adventures ahead. Visit the Bridge (a great place to spot wildlife), have a relaxing massage; attend a talk about the biology of the penguins you'll soon be seeing; or settle into a comfy chair in the observation lounge, look out over the waves and reflect on the incredible history of this fabled passage. If it does get a little rough, just take a couple of nice naps; you'll be in Antarctica before you know it.

Meals included: breakfast, lunch, dinner

◇ DAYS 5-9

Antarctica

With long hours of daylight at this time of year, you'll have ample opportunities to explore. The schedule is flexible, allowing you to take advantage of the unexpected. You might set out by kayak to encounter towering icebergs at water level; embark on a Zodiac excursion in search of seals and blue-eyed shags; walk amid thousands of Adélie and gentoo penguins; or experience the thrill of the ship crunching through pack ice.

Everywhere you go in Antarctica you'll be surrounded by opportunities to capture uniquely beautiful images. Along the way your expert expedition team will enrich your experiences.

Meals included: breakfast, lunch, dinner

◇ DAYS 10-11

At Sea

Setting out from the South Shetland Islands to South Georgia, you'll follow in the wake of Sir Ernest Shackleton's epic voyage in the *James Caird* across 800 miles of the wild and lonely Scotia Sea. But you won't be lonely at all—these waters are home to a large and growing population of whales, including fin whales, southern right whales and even blue whales—the largest animal on Earth. Albatross and petrels wing past the ship, providing you with another wonderful challenge for photography, while presentations from the expedition team help to prepare you for the mind-bending wildlife spectacles of South Georgia.

Days at sea are not simply transits from one place to another; they are a very important part of this epic journey in their own right. The crossing from the Antarctic Peninsula to South Georgia gives you a chance to stop and breathe, to explore the amenities of the ship and to spend a little time contemplating all your new memories. Life-changing experiences tend to pile up on one another in the Antarctic, so slow down a bit and let it all settle in. This is a great time to catch up with your journal, enjoy a rejuvenating massage or download and review all those hundreds (or thousands!) of photos. Get some rest, too—when you get to South Georgia, it's going to be go, go, go!

Meals included: breakfast, lunch, dinner

◇ DAYS 12-15

South Georgia Island

Simply put, there is nowhere else in the world like South Georgia. King penguins, the second largest penguin species in the world, are unquestionably the most iconic wildlife of South Georgia. Exact numbers are not known, but the largest single colony on the island may have as many as 500,000 of these amazing birds nesting together on a single two-mile-long beach.

Explore the spectacular coastline of South Georgia Island. In keeping with the nature of an expedition, the schedule is flexible with opportunities for walking, hiking, kayaking and Zodiac excursions. Sailing along the coast, you'll have a choice of activities every day including visits to Grytviken—the final resting place of Shackleton—and Stromness Harbour, where Ernest Shackleton, Tom Crean and Frank Worsley finally reached aid at a whaling station.

The island is also home to huge elephant seals and thousands of king penguins. South Georgia is sometimes called "the Serengeti of the Southern Ocean", but even that description seems inadequate; this lonely island is unique in the world, so rich and so beautiful that it defies any comparison.

Meals included: breakfast, lunch, dinner

◇ DAYS 16-17

At Sea

Your first day at sea on the way to the Falkland Islands is another opportunity to think back over the adventures of the past few days and make preparations for those soon to come. Spend some time chatting about your latest images with the National Geographic Photography Expert and learn to make them look their best in the digital darkroom. Put the finishing touches on your watercolor of that amazing iceberg or try to capture an albatross's flight in a poem. Everyone needs to exhale a bit after a visit to South Georgia, so take a little time to explore the details of your own memories and share them with your shipmates.

The Bridge is the nerve center of the ship in more ways than one. There's always a congenial atmosphere there, whether you've come to ask one of the officers about navigation or just to sit and watch the world go by with binoculars in hand. The waters close to the Falkland Islands are rich with marine wildlife, so this is a great time to hang out

with the naturalists and keep watch for rare dolphins or another beautiful species of albatross. All new sightings go up on the white board for the day's record!

Meals included: breakfast, lunch, dinner

◇ DAYS 18-20

Falkland Islands

All the best aspects of expedition travel seem to come together in the western Falkland Islands. Where else can you land on a beach tucked into a rocky cove, hike out across a rolling green pasture and suddenly find yourself at the crest of a sea cliff looking out over the South Atlantic surf? Just a few steps further and you're standing at the edge of a breeding colony of black-browed albatross, so close that you can hear the wind on their wings as they swoop into land beside you. Check out the thousands of irresistible gentoo, rockhopper and Magellanic penguins that congregate here, along with fur seals.

Stanley, the bright, pretty capital of the Falkland Islands, is a wonderfully unexpected place: a charming outpost of British culture tucked into a small bay on the shore of these windswept islands in the far South Atlantic. Many Falkland Islanders still live in very traditional ways, and you'll have a chance to visit a small farm to see some expert sheep shearing and learn about the best techniques for cutting blocks of peat for the fire. The rocky hills and white sand beaches outside town offer some excellent hikes, and afterward, a cup of tea or a pint at the local tavern goes down very nicely.

Meals included: breakfast, lunch, dinner

◇ DAY 21

At Sea

The final day of your expedition takes you across the shallow waters of the Falklands Shelf, back to your starting point in Ushuaia. Attend presentations from

the expedition staff on topics that help to sum up all the wonderful details of your experiences in the far south, and spend some time on deck enjoying the seabirds and dolphins that make these seas their home.

This is a day for contemplation as well. The Antarctic stays with you. Sometime soon, at a moment in the midst of a stressful day, you'll remember the feeling of the polar wind, the sight of waves crashing against the blue wall of an iceberg and the sound of the penguins calling to their chicks. It's a little bit of peace that you'll carry with you always.

Meals included: breakfast, lunch, dinner

■ DAY 22

Disembark Ship / Ushuaia / Buenos Aires or Santiago

Disembark in Ushuaia, the southernmost city in the world. Take the recommended flight to Buenos Aires or Santiago and connect with your flight home.

Departure Time: Depart after 9:00 p.m. local time.

Departure City: Buenos Aires, Argentina or Santiago, Chile

Meals included: breakfast

Northbound

Ushuaia, Argentina → Ushuaia, Argentina

2026 Departure Dates

Aboard *National Geographic Endurance*

07 Feb

2027 Departure Dates

Aboard *National Geographic Endurance*

08 Feb

2028 Departure Dates

Aboard *National Geographic Endurance*

17 Feb

Alternative Routes

Visit Expeditions.com for more information.

2025 Departure Dates

18 Oct, 28 Oct, 30 Oct, 19 Nov

2026 Departure Dates

29 Oct, 06 Nov, 12 Nov



National Geographic Endurance

Guests	Cabins
138	76

The most advanced ice-class expedition ship afloat, the *National Geographic Endurance* offers unprecedented access to polar regions.

The first new polar build in Lindblad's 50-year history, *National Geographic Endurance* is named to honor explorer Ernest Shackleton and his legendary Transantarctic Expedition.

A fully-stabilized vessel of the highest ice class (PC5 Category A), she will enable adventurous guests to go where few have or can. Endurance's most striking exterior feature is her distinctive profile, the patented X-Bow®, a game-changing design that guarantees the smoothest, most comfortable ride in all kinds of conditions; and since it eliminates bow impact, a quieter ride, as well.

An equally impressive feature may well be her capacity: she carries just 138 guests, a commitment to expedition excellence over scale. Scandinavian-inflected, luxuriously appointed, her inviting interiors would be a destination in themselves. Because she is a Lindblad expedition ship, however, her attention is focused on the world outside—with acres of window glass to keep you connected to the stunning views beyond the pane, and a fleet of expedition tools to get you out exploring.

National Geographic Endurance and *National Geographic Resolution* are next-generation expedition ships. Purpose-built for polar navigation. Fully stabilized, highly strengthened, ice-class Polar Code PC5 (Category A) vessels, they are designed to navigate polar passages year-round, and safely explore uncharted waters, while providing exceptional comfort. The patented X-bow[®] is key to their design; its powerful wave-slicing action provides an extremely smooth ride even in adverse conditions, and even reduces spray on deck for superior observation. They carry a full suite of expedition tools, and offer a variety of experience enhancing amenities.



Cabin Categories

Category 1

Fore Deck: #404, 406, 408, 411, 413, 415

Fore Deck, with two large windows, two singles that can convert to a queen, armchair, writing desk and chair, two bedside tables, window sofa and a closet.



Category 2

Fore Deck: #410, 412, 414, 416-419, 421-427

Fore Deck, with two large windows, two single beds that can convert to a queen, window sofa, two-seat sofa, coffee table, armchair, writing desk with an office chair, two bedside tables and a closet.



Category 3

Main Deck: #512, 514-524

Cabin with balcony that features two balcony chairs, hammock, and a table; two single beds that convert to a queen; convertible sleeper sofa; writing desk with a chair; two bedside tables; coffee table; and a closet.



Category 4

Lounge Deck: #608, 610, 612, 613-623

Cabin with balcony that features two balcony chairs, hammock and a table; two single beds that can convert to a queen; pull-out sofa; coffee table; writing desk with chair; two bedside tables; and a closet.

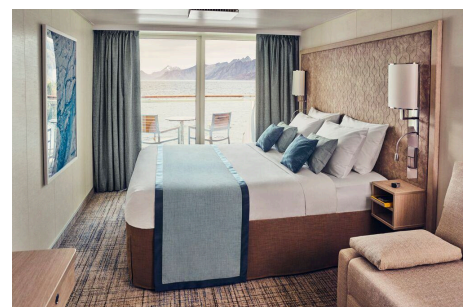

Category 5

Bridge Deck: #700-707, 712, 713, 715, 717

Cabin with balcony that features two balcony chairs, hammock, and a table; two single beds that convert to a queen; convertible sleeper sofa; coffee table; writing desk with chair; two bedside tables; and a closet.



Category 6

Bridge Deck: #714

Junior suite with balcony that features two balcony chairs, hammock, and table; two single beds that convert to a queen; pull-out sofa; writing desk with chair; two bedside tables; coffee table; espresso maker; and a closet. Guests receive priority access to one spa treatment and one igloo reservation and complementary laundry per departure.



Category 7

Bridge Deck: #708-711, 716, 718, 719, 721

These large balcony suites feature two balcony chairs, hammock, and table; two single beds that can convert to a queen; pull-out sofa; coffee table; writing desk and chair; espresso maker; and a large walk-in closet with full length mirror. Expanded bathroom has a double vanity, bathtub, towel warmer and rain shower. Guests receive priority access to one spa treatment and one igloo reservation and complementary laundry per departure.



Category A Solo

Main Deck: #504, 506-511, 513

Cabin with balcony that features two balcony chairs, hammock, and a table; single bed; writing desk with an office chair; and a closet.



Category B Solo

Lounge Deck: #604-607, 609, 611

Cabin with balcony that features two balcony chairs, hammock, and a table; single bed; writing desk with chair; hammock; and a closet.



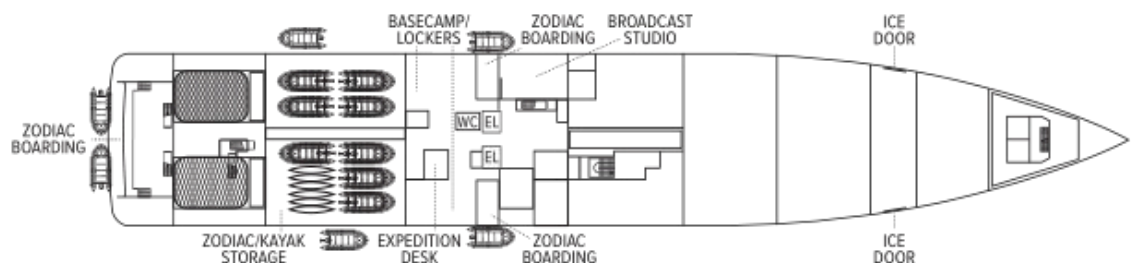
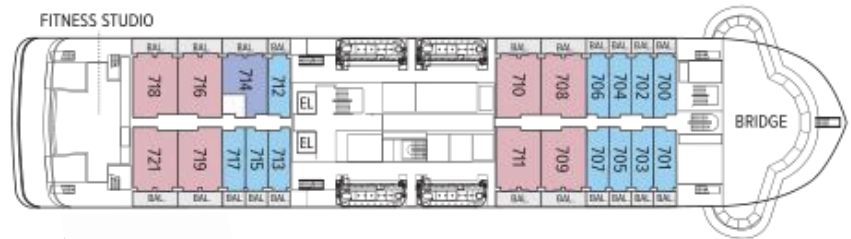
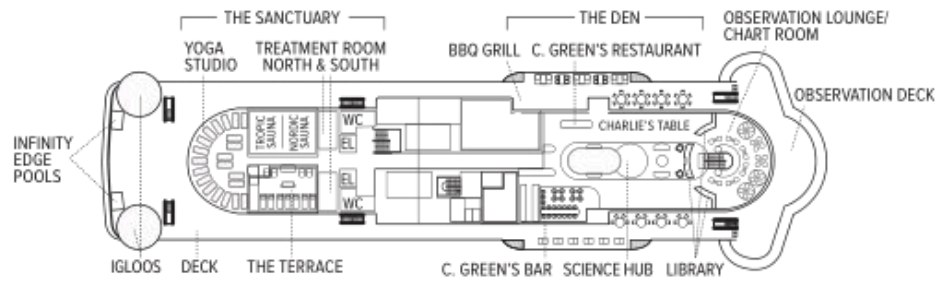

Ship amenities

Public Areas

Reception; three dining areas; an observation lounge with bar, gym, wellness area, infinity-style outdoor hot tubs with adjacent igloos; library; main lounge with full service bar, 24-hour beverage station, state-of-the-art tech for films/presentations; B&H Photo locker and a photo workshop area; science hub; an onboard broadcast studio; an expedition base with lockers for expedition gear; and open access to the Bridge, Captain, officers and on-duty wildlife spotters.

Meals

Restaurant 270° features wrap-around views; two other dining areas offer lighter, made-to-order fare or intimate, small group dinners. All feature sustainable choices, local where possible, and unassigned, flexible, inclusive seating.

Cabins

All cabins face outside with large windows, private bathroom, and climate controls. Cabins are equipped with expedition command centers with iPad tablets, multiple electrical and USB outlets, TVs, with on demand entertainment, phone, Wi-Fi, clock, barometers, hygrometers, vanity mirror, mini refrigerator, small safe, ice bucket, glasses, hair dryer, reading lights and National Geographic Atlas. Luxury linens and pillows. Bathrooms outfitted with Rain showers & hand held shower, botanically inspired shampoo, conditioner, shower gel and lotion. Complimentary insulated water bottles. Balcony cabins have hammocks, chairs and table.

Expedition Equipment

Zodiac landing craft, kayaks, snowshoes, cross-country skis, an ROV and underwater video camera for unique access to the polar undersea, hydrophone, aerial remote-controlled camera and video microscope.

Special Features

A full-time doctor, undersea specialist, National Geographic photographer, Lindblad-National Geographic certified photo instructor and video chronicler, an internet cafe and laundry. A forward and aft staircase, and elevators, reach all decks. Echoing the pioneering installation aboard *National Geographic Endurance*, artist Zaria Forman has curated a new exhibit, featuring a wide range of artists.



Wellness

A glass-enclosed yoga studio, gym, treatment rooms and spa relax area, and high and low-heat saunas with ocean views, staffed by wellness specialists.

Self-Disinfecting Ships

ACT Clean Coat™ is a light-activated, self-disinfecting cleaning process that continuously breaks down viruses, bacteria, mold, and airborne allergens across all ship surfaces. Not only does this create a cleaner, healthier shipboard environment for guests and crew alike, but this non-toxic, chemical-free system also saves more than one million gallons of water each year in our cleaning procedures, and reduces our carbon footprint as well as the amount of plastic and waste in our supply chain.



National Geographic Resolution

Guests

138

Cabins

76

**The sister ship to *National Geographic Endurance*,
she explores polar & temperate regions**

Our second new polar build, *National Geographic Resolution*, is named to honor the second voyage of the legendary Captain James Cook.

A fully-stabilized vessel of the highest ice class (PC5 Category A), she will enable adventurous guests to go where few have or can. *Resolution's* most striking exterior feature is her distinctive profile, the patented X-Bow®, a game-changing design that guarantees the smoothest, most comfortable ride in all kinds of conditions; and since it eliminates bow impact, a quieter ride, as well.

An equally impressive feature may well be her capacity: she carries just 138 guests, a commitment to expedition excellence over scale. Scandinavian-inflected, luxuriously appointed, her inviting interiors would be a destination in themselves. Because she is a Lindblad expedition ship, however, her attention is focused on the world outside— with acres of window glass to keep you connected to the stunning views beyond the pane, and a fleet of expedition tools to get you out exploring.

National Geographic Endurance and *National Geographic Resolution* are next-generation expedition ships. Purpose-built for polar navigation. Fully stabilized, highly strengthened, ice-class Polar Code PC5 (Category A) vessels, they are designed to navigate polar passages year-round, and safely explore uncharted waters, while providing exceptional comfort. The patented X-bow[®] is key to their design; its powerful wave-slicing action provides an extremely smooth ride even in adverse conditions, and even reduces spray on deck for superior observation. They carry a full suite of expedition tools, and offer a variety of experience enhancing amenities.



Cabin Categories

Category 1

Fore Deck: #404, 406, 408, 411, 413, 415

Cabin with two large windows, two singles that can convert to a queen, writing desk and chair, two bedside tables, window sofa, coffee table, and a closet.



Category 2

Fore Deck: #410, 412, 414, 416-419, 421-427

Cabin with two large windows, two single beds that can convert to a queen, window sofa, two-seat sofa, coffee table, writing desk with an office chair, two bedside tables, coffee table, and a closet.



Category 3

Main Deck: #512, 514-524

Cabin with balcony that features two balcony chairs, hammock, and a table; two single beds that convert to a queen; convertible sleeper sofa; writing desk with a chair; two bedside tables; coffee table; and a closet.



Category 4

Lounge Deck: #608, 610, 612, 613-623

Cabin with balcony that features two balcony chairs, hammock and a table; two single beds that can convert to a queen; pull-out sofa; coffee table; writing desk with chair; two bedside tables; and a closet.



Category 5

Bridge Deck: #700-707, 712, 713, 715, 717

Cabin with balcony that features two balcony chairs, hammock, and a table; two single beds that convert to a queen; convertible sleeper sofa; coffee table; writing desk with chair; two bedside tables; and a closet.



Category 6

Bridge Deck: #714

Junior suite with balcony that features two balcony chairs, hammock, and table; two single beds that convert to a queen; pull-out sofa; writing desk with chair; two bedside tables; coffee table; espresso maker and a closet. Guests receive priority access to one spa treatment and one igloo reservation and complementary laundry per departure.

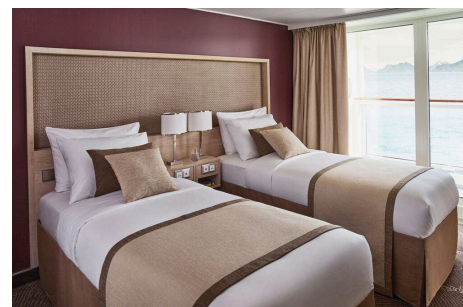

Category 7

Bridge Deck: #708-711, 716, 718, 719, 721

These large balcony suites feature two balcony chairs, hammock, and table; two single beds that can convert to a queen; pull-out sofa; coffee table; writing desk and chair; espresso maker; and a large walk-in closet with full length mirror. Expanded bathroom has a double vanity, bathtub, towel warmer and rain shower. Guests receive priority access to one spa treatment and one igloo reservation and complementary laundry per departure.

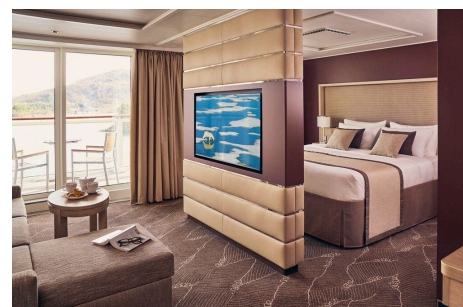

Category A Solo

Main Deck: #504, 506-511, 513

Cabin with balcony that features two balcony chairs, hammock, and a table; single bed; writing desk with an office chair; and a closet.



Category B Solo

Lounge Deck: #604-607, 609, 611

Cabin with balcony that features two balcony chairs, hammock, and a table; single bed; writing desk with chair; hammock; and a closet.



Observation Deck

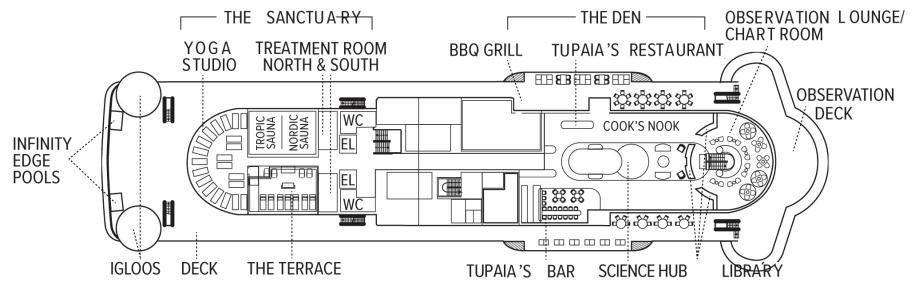

Bridge Deck

- Category 5
- Category 6
- Category 7



Lounge Deck

- Category 4
- Category B Solo



Main Deck

- Category 3
- Category A Solo



Fore Deck

- Category 1
- Category 2



Expedition Deck

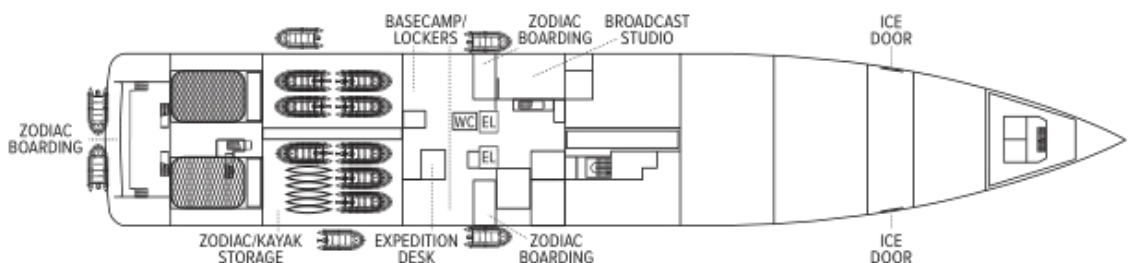

Ship amenities

Public Areas

Reception; three dining areas; an observation lounge with bar, gym, wellness area, infinity-style outdoor hot tubs with adjacent igloos; library; main lounge with full service bar, 24-hour beverage station, state-of-the-art tech for films/presentations; B&H Photo locker and a photo workshop area; science hub; an onboard broadcast studio; an expedition base with lockers for expedition gear; and open access to the Bridge, Captain, officers and on-duty wildlife spotters.

Meals

Restaurant 270° features wrap-around views; two other dining areas offer lighter, made-to-order fare or intimate, small group dinners. All feature sustainable choices, local where possible, and unassigned, flexible, inclusive seating.

Cabins

All cabins face outside with large windows, private bathroom, and climate controls. Cabins are equipped with expedition command centers with iPad tablets, multiple electrical and USB outlets, TVs, with on demand entertainment, phone, Wi-Fi, clock, barometers, hygrometers, vanity mirror, mini refrigerator, small safe, ice bucket, glasses, hair dryer, reading lights and National Geographic Atlas. Luxury linens and pillows. Bathrooms outfitted with Rain showers & hand held shower, botanically inspired shampoo, conditioner, shower gel and lotion. Complimentary insulated water bottles. Balcony cabins have hammocks, chairs and table.

Expedition Equipment

Zodiac landing craft, kayaks, snowshoes, cross-country skis, an ROV and underwater video camera for unique access to the polar undersea, hydrophone, aerial remote-controlled camera and video microscope.

Special Features

A full-time doctor, undersea specialist, National Geographic photographer, Lindblad-National Geographic certified photo instructor and video chronicler, an internet cafe and laundry. A forward and aft staircase, and elevators, reach all decks. Echoing the pioneering installation aboard *National Geographic Endurance*, artist Zaria Forman has curated a new exhibit, featuring a wide range of artists.



Wellness

A glass-enclosed yoga studio, gym, treatment rooms and spa relax area, and high and low-heat saunas with ocean views, staffed by wellness specialists.

Self-Disinfecting Ships

ACT Clean Coat™ is a light-activated, self-disinfecting cleaning process that continuously breaks down viruses, bacteria, mold, and airborne allergens across all ship surfaces. Not only does this create a cleaner, healthier shipboard environment for guests and crew alike, but this non-toxic, chemical-free system also saves more than one million gallons of water each year in our cleaning procedures, and reduces our carbon footprint as well as the amount of plastic and waste in our supply chain.



National Geographic Explorer

Guests

148

Cabins

81

Built to handle deep swells and towering waves, the *National Geographic Explorer* lends herself to globe-spanning travel and a dedication to curiosity and wonder.

Originally constructed for service along Norway's coast as part of the famed Hurtigruten, or Coastal Express, she ferried passengers among the fjords of this iconic coast in conditions that could deteriorate into heavy seas in a matter of minutes. She had to be able to handle deep swells and towering waves—and have a high degree of maneuverability. Those traits, and an ideal size, made her a natural choice for addition to the Lindblad fleet.

The plans to completely rebuild her drew on 50 years of pioneering expedition history and expertise. *National Geographic Explorer* was equipped with an ice-strengthened hull and advanced navigation equipment for polar expeditions; a roster of tools for exploration; and a well-appointed interior with vast expanses of glass for an unprecedented connection to the environment. Her interior and exterior design embodied the Lindblad expedition ethos—the privilege of wildness and the luxury of comfort.

For many guests she remains their paradigm of an expedition ship. She is devoted to exploration—from her Welcoming Bridge, and the Chart Room below it where you can tuck in to warm up with a hot chocolate, to her high-perched Observation deck with its aqueous light and compelling 24/7 views. Even the art on the walls— from the Hurley prints of Shackleton’s expedition to the stunning National Geographic photos— tells an uber- narrative of globe-spanning travel and a dedication to curiosity and wonder.

National Geographic Explorer is a state-of-the-art expedition ship. She is a fully stabilized, ice-class vessel, with an ice-reinforced hull, enabling her to navigate polar passages while providing exceptional comfort.



Cabin Categories

Category 1

Main Deck: #301-308

Cabins feature one or two portholes. Most cabins feature two single beds that can be converted to a queen. Cabins #301-306 feature one queen-sized bed. All cabins feature a writing desk, floor length mirror, reading lamps, well-appointed bathrooms with a roomy glass-wall shower, and a TV.



Category 2

Main Deck: #317-320, 335-336

Cabins feature two single beds (some can convert to a queen-sized bed), and one large window. They offer a writing desk, floor length mirror, reading lamps, sitting chair, well-appointed bathrooms with a roomy glass-wall shower, and a TV.



Category 3

Main Deck: #313-316, 321-328, 337-340, 342, 344, 348, 350

Cabins feature two single beds (some can convert to a queen-sized bed), one large window, and two sitting chairs and a small table and ample storage. They have a writing desk, floor length mirror, reading lamps, well-appointed bathrooms with a roomy glass-wall shower, and a TV. Cabins 341 & 343 have a sofa bed for a triple.



Category 4

Upper Deck: #201-202, 204-207, 210, 212, 217, 226, 228

Cabins feature two single beds and at least one large window. All cabins can convert between two single beds to a queen, except Cabins 217, 226 & 228 that feature one queen-size bed only. All cabins feature climate controls, sitting chairs, and a TV. Bathrooms are also generously sized with a roomy glass-walled shower stall.



Veranda Deck: #103-104, 107-108

Cabins feature two single beds that can convert into a queen. They have a writing desk, floor length mirror, reading lamps, sitting chair, private bathrooms with a glass-wall shower, and a TV.

Category 5

Upper Deck: #209, 211, 214, 216, 218, 220-222, 224

Cabins feature a balcony with sliding glass doors, one queen-sized bed, writing desk, floor length mirror, reading lamps, private bathrooms with a glass-wall shower, and a TV. (Cabin 221 has two single beds that can convert to a queen.)



Category 6

Upper Deck: #213

This spacious cabin has a private balcony, two single beds that can be converted into a queen, a writing desk, double closet, bookcase, pull-out sofa, armchairs, two large windows, and a TV. The sleeping area has a glass partition separating the living room. Bathrooms are generously sized with a roomy glass-walled shower stall and twin sinks.



Veranda Deck: #101-102

These spacious cabins can be converted into triples. They have two single beds that can be converted into a queen, a writing desk, double closet, bookcase, sofa-bed, chairs, two large windows, and a TV. The sleeping area can be closed off with the glass partition. Bathrooms are generously sized with a roomy glass-walled shower stall and twin sinks.

Category 7

Upper Deck: #215, 219, 230

These large cabins with private balconies have two single beds that can convert to an Olympic-sized queen. They have seating areas with a sofa-bed and can be converted to triples. Cabins also include a desk with chairs, coffee table with sitting chair, and a small table. Bathrooms are generously sized with a roomy glass-walled shower stall and twin sinks.



Category A Solo

Main Deck: #309-311, 329-334

These cabins feature one single bed and a large window, a writing desk, reading lamp, bathroom with a roomy glass-wall shower stall, and a TV.



Category B Solo

Upper Deck: #203, 208

Veranda Deck: #105-106

These cabins feature one single bed and a large window, a writing desk, reading lamp, bathroom with a roomy glass-wall shower stall, and a TV.



Bridge Deck

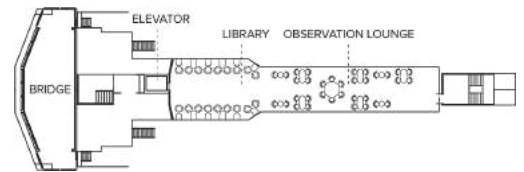

Wellness Deck

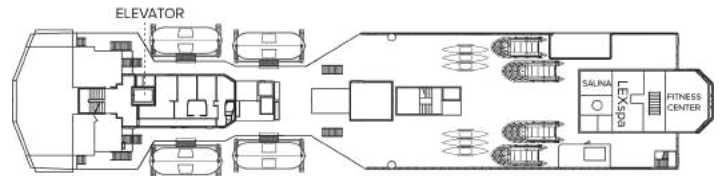

Veranda Deck

- Category 4
- Category 6
- Category B Solo

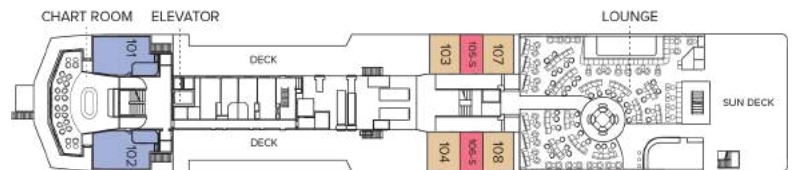

Upper Deck

- Category 4
- Category 5
- Category 6
- Category 7
- Category B Solo

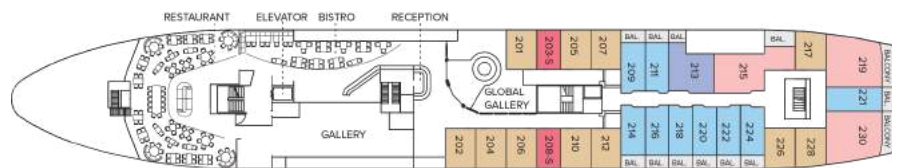

Main Deck

- Category 1
- Category 2
- Category 3
- Category 2 Solo



B Deck

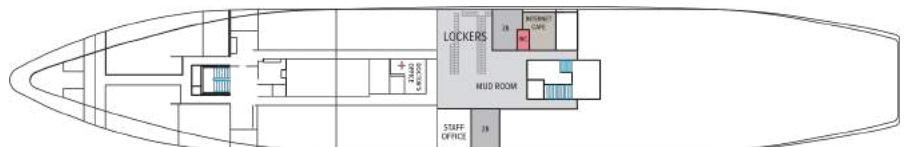

Ship amenities

Public Areas

Reception; three dining areas; global gallery; library, B&H Photo locker; 24-hour Bistro area beverage bar; lounge with bar and state-of-the-art presentation facilities; observation lounge; mudroom with lockers for expedition gear; plus open access to the Bridge, the Captain, officers and on-duty wildlife spotters.

Meals

Meals are served in the dining room, Bistro bar, or the Observation lounge, at a single seating with unassigned tables for an informal atmosphere and easy mingling. Menus feature sustainable choices, local where possible.

Cabins

81 outside cabins. All cabins face outside with windows or portholes, private bathroom, and climate controls. Cabins are equipped with Wi-Fi, multiple electrical outlets, USB outlets, full length mirror and phones. TV featuring entertainment on demand, live feed for onboard presentations, bow camera and ship's position. Luxury bed linens and pillows. Botanically inspired shampoo, conditioner, shower gel, and lotion are all available in cabin bathrooms, as well as an Expedition Essential Kit. Hair dryers, complimentary insulated water bottles and a National Geographic Atlas is available in each cabin.

Expedition Equipment

Zodiac landing craft, a fleet of double kayaks, a crow's nest camera, a hydrophone, underwater video cameras, video microscope, and an ROV. Plus, for South Pacific voyages: snorkeling gear for all guests, scuba gear for a number of pre-qualified guests, stand-up paddleboards, glass-bottom Zodiac, and splash-cam.



Special Features

A full-time doctor, undersea specialist, National Geographic photographer, Lindblad-National Geographic certified photo instructor and video chronicler, internet café and laundry. Enjoy a session in the topside library with a good book, or with the book in your lap, eyes trained on the horizon.

Wellness

A glass-enclosed fitness center, outdoor stretching area, a LEXspa treatment room and sauna, staffed by wellness specialists.

Self-Disinfecting Ships

ACT Clean Coat™ is a light-activated, self-disinfecting cleaning process that continuously breaks down viruses, bacteria, mold, and airborne allergens across all ship surfaces. Not only does this create a cleaner, healthier shipboard environment for guests and crew alike, but this non-toxic, chemical-free system also saves more than one million gallons of water each year in our cleaning procedures, and reduces our carbon footprint as well as the amount of plastic and waste in our supply chain.

Special Offers

SUITE EXCLUSIVES

Spacious living areas and incredible views immerse you in the beauty of your marine surroundings.

Our new Suite Exclusives package helps make your voyage all the more memorable. [Learn more](#)

CELEBRATE LIFE'S MILESTONES

Celebrate a milestone with a group of eight or more and enjoy a special amenity package including: 5% savings on voyage fares, custom group photo, US\$150 shipboard credit for the group, and other special gifts. Milestone celebration to be communicated at time of booking.

SAVE 5% TRAVELING AS A GROUP

Save 5% when traveling as a group of eight or more people. Valid on voyage fares only and not applicable on extensions or airfare. Deposit, final payments, and cancellation policies for group travel vary from our regular policies. Valid for new bookings only, subject to availability, and may not be combined with other offers. Call for details.

PAY BY DEBIT: EARN A \$100 ONBOARD CREDIT

The \$100 onboard credit offer is applied after the final payment and requires 85% of the cost of the voyage to be placed on a debit card. Maximum of one \$100 onboard credit per cabin. The \$100 onboard credit is a non-refundable, non-transferable credit that can be used for various onboard purchases such as global gallery and spa treatments. It has no cash value, cannot be refunded if not fully utilized, and will be forfeited if not fully redeemed by the end of the voyage. This offer is combinable with other offers.

If the booking is altered or canceled, the onboard credit may be forfeited, and it cannot be transferred if the booking is moved to another guest. Lindblad Expeditions reserves the right to modify or cancel the offer without prior notice. Offer applies to Lindblad Expeditions' owned ships only. Offer valid only for Debit Cards issued in the United States for payments made from the United States.

COMBINING OFFERS

Certain offers may be combinable, up to two savings opportunities, except where noted otherwise. For example, travel with a group of 8 or more on back-to-back expeditions, and take advantage of both savings.

Included in price

All accommodations aboard ship or in hotels per itinerary; all meals as indicated in the itinerary, both aboard and onshore; beer, wine, cocktails, liquors and spirits aboard the ship (except certain premium brands which are available for purchase); hors d'oeuvres, 24-hour access to snacks, premium coffees and teas, non-alcoholic beverages, and filtered water; excursions and airport transfers, as indicated in the itinerary, as indicated in the itinerary; crew gratuities; exploration tools curated to destination, such as Zodiacs, kayaks, snowshoes and cross-country skis; guidance and company of our leading expedition staff; assistance by the National Geographic photographer and National Geographic-Lindblad Expeditions certified photo instructor; Basic Wi-Fi aboard ship; complimentary reusable water bottle; access to the OM System Photo Gear Locker; presentations by expedition staff and expert guest speakers; complimentary parka; complimentary reusable water bottle; onboard physician consultations; morning stretch classes and 24-hour access to exercise equipment; 24-hour access to lounges, observation decks, library, and other shared spaces; park and site entrance fees, special access permits, and port taxes. Unused services or items included in our programs are non-refundable.

Not included in price

Airfare (except flights* when indicated as included); pre- and post-expedition extensions; additional hotel nights (except when indicated as included); private transfers; laundry, spa treatments, enhanced and premium Wi-Fi plans aboard expedition fleet; phone services (except when indicated as included); travel protection plans; and passport, visa, and immigration fees.

*Recommended flight costs include flight(s) that take place during the date range of your trip to transport travelers from one itinerary destination to another. This cost also includes ground transportation, luggage transfer, and airport assistance. If you prefer to arrange your own flights privately, have alternate means of transport, or wish to modify at a later time, please contact an Expedition Specialist at 1.833.400.0831

Additional costs associated with medical services outside onboard physician consultation.

For select voyages, completing a medical evaluation form with VIKAND is required. If you utilize your physician, VIKAND's processing fee for your documentation will be added to your National Geographic-Lindblad Expeditions invoice. If you utilize VIKAND's physicians, an additional charge will be due and payable directly to VIKAND.

Travel protection plan

We strongly recommend our guests to take advantage of our Travel Protection Plan. This plan offers comprehensive coverage to protect you from cancellation fees, costs incurred due to trip delays/interruption, damage or loss of baggage, medical assistance, and evacuation during your travels. Our Travel Protection Plan is available for U.S. residents only, and may be purchased any time prior to final payment due date, Travel Protection premiums are non-refundable once plan is purchased. Learn more about our Travel Protection "Plus" Plan: <https://www.expeditions.com/terms-conditions/travel-protection-plan/>

Cancellation policy

Review our cancellation policy: <https://www.expeditions.com/cancellation-policy/>