









 Baja California & North America  
 25° 58' N, 111° 15' W

# Baja California: Among the Great Whales

Explore Baja California’s pristine coastlines and living sea in search of dolphins, sea lions, and as many as five different varieties of whales. Board local pangas and enter sheltered lagoons for up-close encounters with California gray whale mothers and their newborn calves. Witness an undersea wonderland, serene desert isles, and the most beautiful sunsets on Earth. Hike through towering cacti and up striking desert canyons or take a slow photo stroll along the shore. Every day is different and rewarding, with opportunities to indulge in active or relaxing pursuits.

From  
**A\$ 9,214** / per person  
 Does not include flights

 <b>DATES</b> Jan, Feb and Mar	 <b>DURATION</b> 8 Days
 <b>SHIPS</b> <i>National Geographic Venture</i>	
 <b>STARTS AT</b> Loreto, Mexico	  <b>ENDS AT</b> Loreto, Mexico

## Highlights

- ★ Enter gray whale birthing lagoons for up-close encounters with gray whale mother-calf pairs
- ★ Embark on regular marine safaris in search of dolphins, sea lions, and up to six species of whales
- ★ Snorkel amidst the vibrant sea life, including playful sea lions at Los Islotes
- ★ Hike desert isles, including Espiritu Santo Archipelago National Park, and witness the variety of flora and fauna thriving in this region





# Day by day

## ■ DAY 1

### Loreto, Mexico / Embark Ship

Arrive in Loreto, a picturesque gulfside town dotted with Spanish colonial architecture. Transfer to the *National Geographic Venture* to set sail at sunset.

**Arrival Time:** Arrive before 2:30 p.m. local time.

**Arrival City:** Loreto, Mexico

Meals included: dinner

## ◇ DAY 2

### Bahía Concepción

Awake in Bahía Concepción, one of the largest bays of the Baja California peninsula, with over 50 miles of beaches. Take your coffee to the deck to witness the colorful landscapes revealed by the first of many gorgeous sunrises. This biodiversity hotspot is ripe for exploration. Board Zodiacs in search of whales and other marine life, kayak through lush mangrove systems, and snorkel in turquoise waters. On land, join an invigorating hike among towering cacti, or stroll the pristine beaches and learn about the ecology from our naturalists.

Meals included: breakfast, lunch, dinner

## ◇ DAY 3

### Exploring the Gulf of California

The Gulf of California is home to great biological diversity, and with some luck, sightings of whales, dolphins and other sea life are among the highlights of your journey. The plan is flexible as you explore some of the uninhabited islands sprinkled across these waters. Your Captain and Expedition Leader collaborate to choose the

perfect combination of activities for the day. Conditions permitting, you may hike, kayak or paddleboard. Learn about this ecosystem from naturalists, and capture amazing photos with help from your certified photo instructor.

Meals included: breakfast, lunch, dinner

## ◇ DAY 4

### Pacific Coast Gray Whale Lagoons

After breakfast, transfer by motorcoach from Puerto Escondido to one of the renowned gray whale lagoons along Baja's Pacific coast. Working with local experts, the Expedition Leader will determine the optimal location for whale viewing based on current conditions and whale activity. Each winter gray whales travel south from their Arctic feeding grounds to breed and give birth to their calves in these sheltered lagoons. Together with savvy local fishermen, venture out in small pangas to view the numerous mother-calf pairs. With luck, enjoy up-close interactions with these curious creatures. Enjoy lunch at a traditional restaurant before returning to the ship in late afternoon.

Meals included: breakfast, lunch, dinner

## ◇ DAYS 5-7

### Cabo Pulmo / Los Islotes / Gulf of California

Venture south to discover the gems of the southern Gulf. These islands and surrounding waters are celebrated for their conservation stories, marine life, and the many thrilling experiences on offer. Some of the locations you may visit or enjoy by Zodiac include:

#### Cabo Pulmo National Marine Park

Set out to snorkel the pristine reefs of Cabo Pulmo

National Marine Park, one of the most successful national marine parks in the world. Chat with locals about their advocacy to protect this unique place, including a cessation of fishing to protect the reef.

### **Isla Espiritu Santo**

A national park as well as UNESCO World Heritage site with volcanic rock formations, scenic beaches, and coral reefs. This magical island offers excellent hiking opportunities and crystal-clear waters for snorkeling. It's a popular destination for researchers monitoring sea turtles.

### **Los Islotes**

Located at the northern tip of the UNESCO Biosphere Reserve, Los Islotes is largely inaccessible to people and home to a large colony of sea lions. Conditions permitting, anchor off the rocky island where you'll don flippers, a mask and snorkel (which are provided) and swim with these curious inhabitants.

### **Isla San José**

One of the larger islands in the Gulf of California, San José offers several landing possibilities depending on conditions and the whim of the moment. Photograph the ochre cliffs of the island's eastern shore, hike an enchanted, cactus-laden arroyo, or visit the abandoned salt works to the west. Discover rare wildlife among desert islands.

Meals included: breakfast, lunch, dinner

## ■ DAY 8

### **Loreto / Disembark Ship**

After breakfast, disembark the ship and transfer to the Loreto airport for flights home or to Loreto's city center to begin a two-night history and whale-watching extension.

**Departure Time:** Depart after 12:00 p.m. local time.

**Departure City:** Loreto, Mexico

Meals included: breakfast

## Expedition

Loreto, Mexico → Loreto, Mexico

### 2027 DEPARTURE DATES

Aboard *National Geographic Venture*

09 Jan	16 Jan	23 Jan	30 Jan	
06 Feb	13 Feb	20 Feb	27 Feb	
06 Mar	13 Mar	20 Mar		

### 2028 DEPARTURE DATES

Aboard *National Geographic Venture*

15 Jan	22 Jan	29 Jan		
05 Feb	12 Feb	19 Feb	26 Feb	
04 Mar	11 Mar			



## National Geographic Venture

GUESTS

100

CABINS

50

**The *National Geographic Venture* is a state-of-the-art expedition ship ideal for discovering remote locations in domestic waters.**

Following the build of *National Geographic Quest* at Nichols Brothers shipyard, her sister ship, *National Geographic Venture*, floated into the bay on Whidbey Island, Washington, becoming the 4th ship in the Lindblad fleet built at this storied shipyard. In the 1970s, Nichols Brothers built the twin ships *National Geographic Sea Bird* and *National Geographic Sea Lion*, which continue to sail the waters of the west coast of North America and Central America.

*National Geographic Venture*, like much of the wildlife she follows, is migratory. She follows the seasons from Alaska, along the coast of British Columbia, up the Columbia and Snake Rivers and along the Baja California coast. In each region, her design innovations were informed by 50+ years of expedition expertise to ensure extraordinary discoveries. *National Geographic Venture's* shallow draft enables her to provide intimate 'insider' experiences of the charismatic regions we explore.

Like her sister ship *National Geographic Quest*, *National Geographic Venture* has dual boarding platforms. Enabling our team to load two Zodiacs at once means guests get off ship quickly to take advantage of wildlife sightings and maximize exploring time. Modern and clean-lined, with large expanses of glass to keep you connected to the extraordinary views, *National Geographic Venture* enables you to see, do and experience the best of her geographies.



# Cabin Categories

## Category 1

MAIN DECK #301-306

Cabins feature two single beds that can convert to a Queen, a writing desk, two nightstands and two portholes, full length mirror, and reading lights.



## Category 2

MAIN DECK #307-315

Cabins feature two single beds that can convert to a Queen, a writing desk, two nightstands and two portholes, full length mirror, and reading lights.



## Category 3

UPPER DECK #201-206

Cabins feature two single beds that can convert to a Queen, a writing desk, two nightstands, a large view window, full-length mirror, and reading lights.



## Category 4

UPPER DECK #207-229

Cabins feature two single beds that can convert to a Queen, a writing desk, closet, two nightstands, full-length mirror, reading lights, sliding glass door, and a small, private balcony.



### Note:

Solo occupancy cabins are available in Categories 1 and 2 only. Third person rates are available in Category 5 cabins at one half the double occupancy rate.

### Connecting Cabins via internal doorway access:

Main Deck: #312-314, #311-315, #306-307;  
Upper Deck: #224-226, #225-227

## Category 5

### OBSERVATION DECK #101-108 (SUITE)

Cabins feature two single beds that can convert to a Queen, large view windows, closet, two nightstands, full-length mirror, reading lights, a suite-sized expanded bathroom, writing desk, ample storage space, and a convertible sofa bed to accommodate a third person.



# Deck Plans

## Observation Deck

Category 5

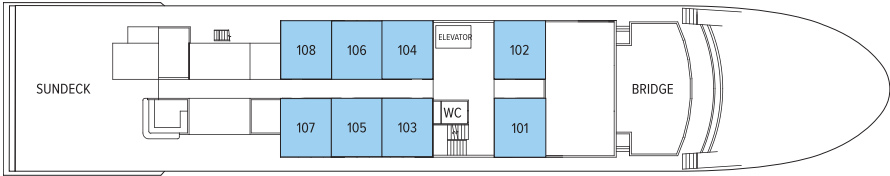

## Lounge Deck

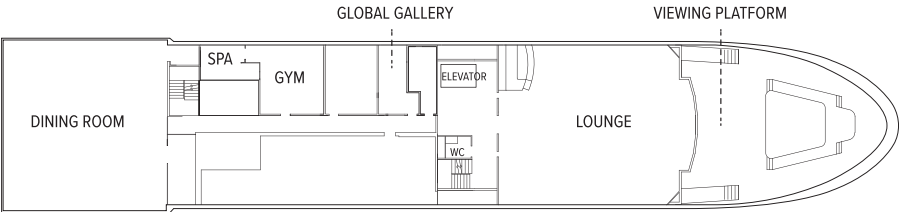

## Upper Deck

Category 3

Category 4

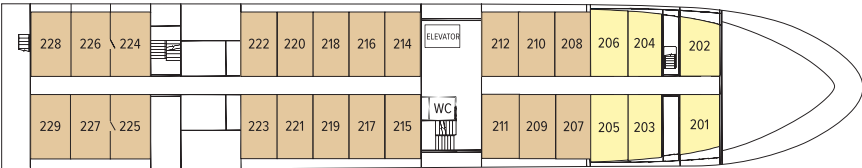

## Main Deck

Category 1

Category 2

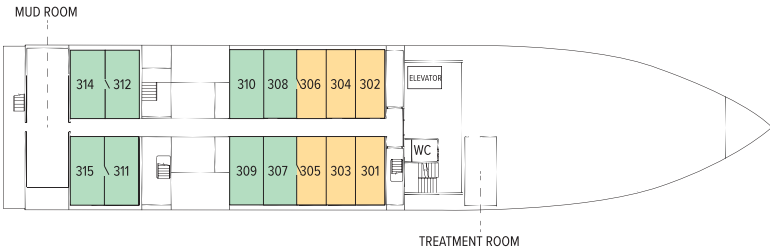

# Ship Amenities

## Public Areas

Reception; main dining area; global gallery; fitness center; lounge with full-service bar and state-of-the-art presentation facilities; observation deck; mudroom with lockers for expedition gear; partially-covered furnished sundeck; plus open access to the Bridge, the Captain, officers and on-duty wildlife spotters.

## Meals

Meals are served in the dining room at a single seating with unassigned tables for an informal atmosphere and easy mingling. Menus feature sustainable choices, local where possible.

## Cabins

50 outside cabins. All cabins face outside with windows, private bathroom, and climate controls. Cabins are equipped with Wi-Fi, phone, multiple electrical and USB outlets, and phones. Luxury linens and pillows. Botanically inspired shampoo, conditioner, shower gel, and lotion are all available in cabin bathrooms, as well as an Expedition Essential Kit. Hair dryers, complimentary insulated water bottles and a National Geographic Atlas are also available in each cabin.

## Expedition Equipment

A fleet of 8 Zodiacs, 24 kayaks, paddleboards; an ROV, hydrophone, splash-cam, underwater video camera, video microscope; snorkeling gear and wet suits for all guests (where applicable).

## Special Features

Internet access. Elevator. The design of the outside decks—with the perfect wildlife viewing platform. The proximity of the Lounge to the deck gives you instant access to spontaneous sightings. Have your camera ready!



## Wellness

A fitness center with elliptical, treadmill, weights and resistance bands; LEXspa treatment room, staffed by wellness specialists.

## Self-Disinfecting Ships

ACT Clean Coat™ is a light-activated, self-disinfecting cleaning process that continuously breaks down viruses, bacteria, mold, and airborne allergens across all ship surfaces. Not only does this create a cleaner, healthier shipboard environment for guests and crew alike, but this non-toxic, chemical-free system also saves more than one million gallons of water each year in our cleaning procedures, and reduces our carbon footprint as well as the amount of plastic and waste in our supply chain.

## Special Offers

on extensions, and may not be combined with other offers. Call for details.

### SUITE EXCLUSIVES

Spacious living areas and incredible views immerse you in the beauty of your marine surroundings.

Our new Suite Exclusives package helps make your voyage all the more memorable. [Learn more](#)

### CELEBRATE LIFE'S MILESTONES

Celebrate a milestone with a group of eight or more and enjoy a special amenity package including: 5% savings on voyage fares, custom group photo, US\$150 shipboard credit for the group, and other special gifts. Milestone celebration to be communicated at time of booking.

### COMBINING OFFERS

Certain offers may be combinable, up to two savings opportunities, except where noted otherwise.

For example, travel with a group of 8 or more on back-to-back expeditions, and take advantage of both savings.

### 10% OFF BACK-TO-BACK VOYAGES

Save 10% on consecutive departures, applicable on voyage fares only and not valid on extensions or airfare. Valid for new bookings only, subject to availability, and may not be combined with other offers. Call for details.

### SAVE 5% TRAVELING AS A GROUP

Save 5% when traveling as a group of 8 or more people. Valid for new bookings only on select departures, subject to availability, not applicable

## INCLUDED IN PRICE

All accommodations aboard ship or in hotels per itinerary; all meals as indicated in the itinerary, both aboard and onshore; beer, wine, cocktails, liquors and spirits aboard the ship (except certain premium brands which are available for purchase); hors d'oeuvres, 24-hour access to snacks, premium coffees and teas, non-alcoholic beverages, and filtered water; excursions and airport transfers to and from recommended flights, as indicated in the itinerary; exploration tools curated to destination, such as Zodiacs, stand-up paddleboards, kayaks, snorkeling equipment (including wetsuits, masks, and fins); guidance and company of our leading expedition staff; assistance by the Lindblad Expeditions-National Geographic certified photo instructor; access to the OM System Photo Gear Locker; presentations by expedition staff and expert guest speakers; complimentary reusable water bottle; onboard physician consultations; morning stretch classes and 24-hour access to exercise equipment; 24-hour access to lounges, observation decks, library, and other shared spaces; basic WiFi, park and site entrance fees, special access permits, and port taxes. Unused services or items included in our programs are non-refundable.

## NOT INCLUDED IN PRICE

Airfare (except flights\* when indicated as included); pre- and post-expedition extensions; additional hotel nights (except when indicated as included); crew gratuities; private transfers; laundry, spa treatments, travel protection plans; and passport, visa, and immigration fees.

\*Recommended flight costs include flight(s) that take place during the date range of your trip to transport travelers from one itinerary destination to another. This

cost also includes ground transportation, luggage transfer, and airport assistance. If you prefer to arrange your own flights privately, have alternate means of transport, or wish to modify at a later time, please contact an Expedition Specialist at 1.833.400.0831

Additional costs associated with medical services outside onboard physician consultation.

## TRAVEL PROTECTION PLAN

We strongly recommend our guests to take advantage of our Travel Protection Plan. This plan offers comprehensive coverage to protect you from cancellation fees, costs incurred due to trip delays/interruption, damage or loss of baggage, medical assistance, and evacuation during your travels. Our Travel Protection Plan is available for U.S. residents only, and may be purchased any time prior to final payment due date, Travel Protection premiums are non-refundable once plan is purchased. Learn more about our Travel Protection "Plus" Plan: <https://www.expeditions.com/terms-conditions/travel-protection-plan/>

## CANCELLATION POLICY

Review our cancellation policy: <https://www.expeditions.com/cancellation-policy/>