







California Coast & North America
 33° 23' N 118° 24' W

Discovering Channel Islands National Park: A 5-Day Voyage

Discover a hidden wild side of a well-known region. Just off the coast of California, one of the lesser-known U.S. national parks beckons, with dramatic sea cliffs, grassy headlands, and rocky islets. Dayboats can take you to individual islands to hike or camp, but our small ships provide a mobile base camp from which to actively explore the full natural splendor of this unique archipelago.

From
\$ 2,180 / per person
 Does not include flights

 DATES Oct and Nov	 DURATION 5 Days
 SHIPS <i>National Geographic Venture</i>	
 STARTS AT Los Angeles, California	  ENDS AT Los Angeles, California

Highlights

- ★ Discover the islands by walking miles of trails, paddling crystal-clear waters by kayak or stand-up paddleboard, or exploring by Zodiac
- ★ Hike in a Torrey pine grove, one of only two on Earth, and enjoy a picnic lunch with sweeping views of the natural harbor
- ★ See endemic species found only in the islands, such as the Channel Island fox, island scrub jay and coastal sage scrub
- ★ Take in the colorful history and architecture of Avalon, a haven for movie stars in Hollywood's golden era





Day by day

DAY 1

Los Angeles, California / Embark Ship

Arrive in Los Angeles by early afternoon and transfer to the Crowne Plaza Los Angeles Harbor Hotel in San Pedro before embarking the ship. Enjoy a cocktail on the deck and meet the expedition team as you set sail in early evening.

Arrival Time: Arrive by 2:30 p.m. local time.

Arrival City: Los Angeles, CA

Meals included: dinner

DAY 2

Anacapa and Santa Cruz Islands, Channel Islands National Park

Wake to the ship at anchor off the rocky outcropping of East Anacapa Island. Join your wellness specialist on the sundeck for morning yoga and then enjoy the breakfast buffet. After breakfast, join naturalists aboard Zodiacs to go ashore on East Anacapa. The goal is the Anacapa Lighthouse, built in 1932, the last major light station to be built on the West Coast. Soak in amazing views from the island alongside a naturalist or choose to explore stunning Arch Rock via Zodiac. This afternoon, set sail for Santa Cruz Island for activities ashore as you search for endemic flora and fauna.

Meals included: breakfast, lunch, dinner

DAY 3

Santa Rosa Island, Channel Islands National Park

Start your morning with an optional stretch class before breakfast. Weather permitting, go kayaking, hike one of the many trails or simply relax ashore. With luck, you may catch a glimpse—or photo—of

the elusive fox species endemic to the island. Join the naturalists for a more strenuous hike out to the base of the Torrey pines grove, which contains what is considered one of the world's rarest pines and is one of only two naturally occurring groves in the world. End the day with a sunset cocktail party.

Meals included: breakfast, lunch, dinner

DAY 4

Catalina Island

Spend the day discovering the colorful history and natural wonders of Catalina Island. Once a haunt of smugglers and gold diggers, the island was transformed into a resort destination by chewing gum tycoon William Wrigley, Jr. in the 1920s. Some 50 years later, William's heirs, Philip K. Wrigley and Dorothy Wrigley Offield, established the Catalina Island Conservancy, protecting nearly 90 percent of the island. Meet a conservancy member to learn about their work on the island before heading out on the trail for spectacular views of the coastline and the Catalina backcountry. With luck, catch a glimpse of the elusive bison herd that have resided on Catalina Island since 1924. Head for the water to kayak or stand-up paddleboard. Return to the ship for a farewell dinner and a last evening at sea under the stars.

Meals included: breakfast, lunch, dinner

DAY 5

Los Angeles / Disembark

Awake dockside in the bustling Port of Los Angeles (early risers can catch the action in one of the world's largest ports). Disembark after breakfast for transfers to the airport.

Departure Time: After 12:00 p.m. local time.

Departure City: Los Angeles, CA

Meals included: breakfast

Expedition

Los Angeles, California → Los Angeles, California

2026 DEPARTURE DATES

Aboard *National Geographic Venture*

31 Oct				
04 Nov	08 Nov			



National Geographic Venture

GUESTS

100

CABINS

50

The *National Geographic Venture* is a state-of-the-art expedition ship ideal for discovering remote locations in domestic waters.

Following the build of *National Geographic Quest* at Nichols Brothers shipyard, her sister ship, *National Geographic Venture*, floated into the bay on Whidbey Island, Washington, becoming the 4th ship in the Lindblad fleet built at this storied shipyard. In the 1970s, Nichols Brothers built the twin ships *National Geographic Sea Bird* and *National Geographic Sea Lion*, which continue to sail the waters of the west coast of North America and Central America.

National Geographic Venture, like much of the wildlife she follows, is migratory. She follows the seasons from Alaska, along the coast of British Columbia, up the Columbia and Snake Rivers and along the Baja California coast. In each region, her design innovations were informed by 50+ years of expedition expertise to ensure extraordinary discoveries. *National Geographic Venture's* shallow draft enables her to provide intimate 'insider' experiences of the charismatic regions we explore.

Like her sister ship *National Geographic Quest*, *National Geographic Venture* has dual boarding platforms. Enabling our team to load two Zodiacs at once means guests get off ship quickly to take advantage of wildlife sightings and maximize exploring time. Modern and clean-lined, with large expanses of glass to keep you connected to the extraordinary views, *National Geographic Venture* enables you to see, do and experience the best of her geographies.



Cabin Categories

Category 1

MAIN DECK #301-306

Cabins feature two single beds that can convert to a Queen, a writing desk, two nightstands and two portholes, full length mirror, and reading lights.



Category 2

MAIN DECK #307-315

Cabins feature two single beds that can convert to a Queen, a writing desk, two nightstands and two portholes, full length mirror, and reading lights.



Category 3

UPPER DECK #201-206

Cabins feature two single beds that can convert to a Queen, a writing desk, two nightstands, a large view window, full-length mirror, and reading lights.

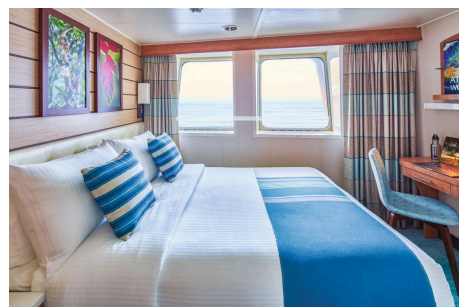

Category 4

UPPER DECK #207-229

Cabins feature two single beds that can convert to a Queen, a writing desk, closet, two nightstands, full-length mirror, reading lights, sliding glass door, and a small, private balcony.



Note:

Solo occupancy cabins are available in Categories 1 and 2 only. Third person rates are available in Category 5 cabins at one half the double occupancy rate.

Connecting Cabins via internal doorway access:

Main Deck: #312-314, #311-315, #306-307;
Upper Deck: #224-226, #225-227

Category 5

OBSERVATION DECK #101-108 (SUITE)

Cabins feature two single beds that can convert to a Queen, large view windows, closet, two nightstands, full-length mirror, reading lights, a suite-sized expanded bathroom, writing desk, ample storage space, and a convertible sofa bed to accommodate a third person.



Deck Plans

Observation Deck

Category 5

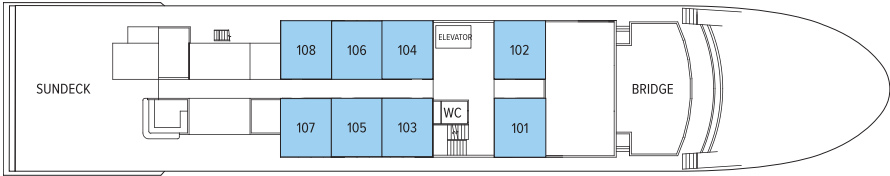

Lounge Deck

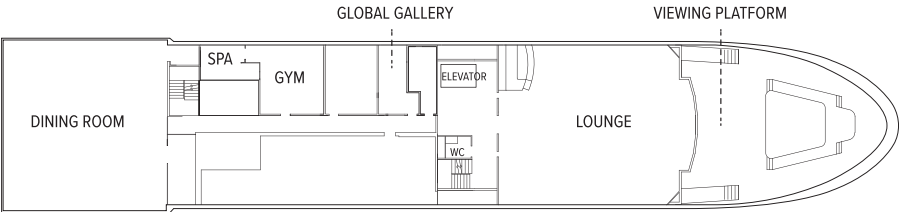

Upper Deck

Category 3

Category 4

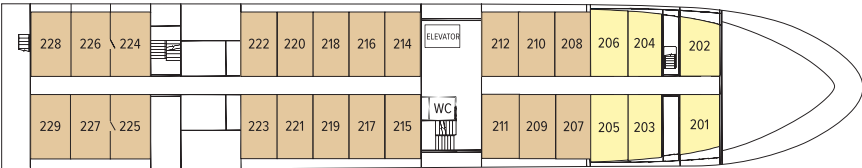

Main Deck

Category 1

Category 2

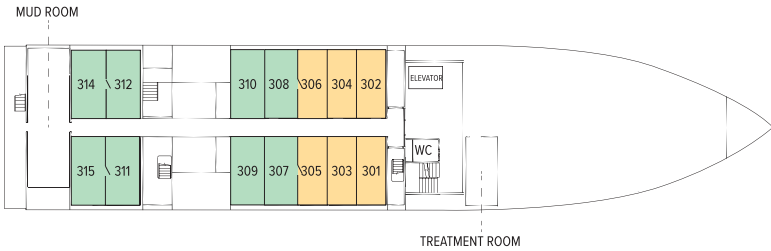

Ship Amenities

Public Areas

Reception; main dining area; global gallery; fitness center; lounge with full-service bar and state-of-the-art presentation facilities; observation deck; mudroom with lockers for expedition gear; partially-covered furnished sundeck; plus open access to the Bridge, the Captain, officers and on-duty wildlife spotters.

Meals

Meals are served in the dining room at a single seating with unassigned tables for an informal atmosphere and easy mingling. Menus feature sustainable choices, local where possible.

Cabins

50 outside cabins. All cabins face outside with windows, private bathroom, and climate controls. Cabins are equipped with Wi-Fi, phone, multiple electrical and USB outlets, and phones. Luxury linens and pillows. Botanically inspired shampoo, conditioner, shower gel, and lotion are all available in cabin bathrooms, as well as an Expedition Essential Kit. Hair dryers, complimentary insulated water bottles and a National Geographic Atlas are also available in each cabin.

Expedition Equipment

A fleet of 8 Zodiacs, 24 kayaks, paddleboards; an ROV, hydrophone, splash-cam, underwater video camera, video microscope; snorkeling gear and wet suits for all guests (where applicable).

Special Features

Internet access. Elevator. The design of the outside decks—with the perfect wildlife viewing platform. The proximity of the Lounge to the deck gives you instant access to spontaneous sightings. Have your camera ready!



Wellness

A fitness center with elliptical, treadmill, weights and resistance bands; LEXspa treatment room, staffed by wellness specialists.

Self-Disinfecting Ships

ACT Clean Coat™ is a light-activated, self-disinfecting cleaning process that continuously breaks down viruses, bacteria, mold, and airborne allergens across all ship surfaces. Not only does this create a cleaner, healthier shipboard environment for guests and crew alike, but this non-toxic, chemical-free system also saves more than one million gallons of water each year in our cleaning procedures, and reduces our carbon footprint as well as the amount of plastic and waste in our supply chain.

Special Offers

SAY YES—TO GOING WITHOUT SECOND THOUGHTS

Receive savings of \$1500 per guest deducted from cabin fare on select 2026 voyages when you pay in full at time of booking. Applicable savings will be deducted from cabin fare before any additional savings with the purchase of cabin fare. To qualify for the savings, nonrefundable payment in full is due at time of booking. This promotional offer is subject to separate terms and conditions. Standard cancellation, refund, and change policies do not apply. All amounts paid in connection with this promotion are non-refundable and non-transferable, regardless of cancellation date, and no refund, credit, or compensation will be provided except as expressly stated herein. Promotional offer valid on new bookings only for select 2026 departures, subject to availability and offer may be withdrawn at any time without prior notice, not applicable on airfare or extensions, and may not be combined with other promotions. Additional restrictions may apply.

SUITE EXCLUSIVES

Spacious living areas and incredible views immerse you in the beauty of your marine surroundings. Our new Suite Exclusives package helps make your voyage all the more memorable. [Learn more](#)

SAVE 5% TRAVELING AS A GROUP

Save 5% when traveling as a group of 8 or more people. Valid for new bookings only on select departures, subject to availability, not applicable on extensions, and may not be combined with other

offers. Call for details.

CELEBRATE LIFE'S MILESTONES

Celebrate a milestone with a group of eight or more and enjoy a special amenity package including: 5% savings on voyage fares, custom group photo, US\$150 shipboard credit for the group, and other special gifts. Milestone celebration to be communicated at time of booking.

PAY BY DEBIT: EARN A \$100 ONBOARD CREDIT

The \$100 onboard credit offer is applied after the final payment and requires 85% of the cost of the voyage to be placed on a debit card. Maximum of one \$100 onboard credit per cabin. The \$100 onboard credit is a non-refundable, non-transferable credit that can be used for various onboard purchases such as global gallery and spa treatments. It has no cash value, cannot be refunded if not fully utilized, and will be forfeited if not fully redeemed by the end of the voyage. This offer is combinable with other offers. If the booking is altered or canceled, the onboard credit may be forfeited, and it cannot be transferred if the booking is moved to another guest. Lindblad Expeditions reserves the right to modify or cancel the offer without prior notice. Offer applies to Lindblad Expeditions' owned ships only. Offer valid only for Debit Cards issued in the United States for payments made from the United States.

COMBINING OFFERS

Certain offers may be combinable, up to two savings opportunities, except where noted otherwise.

For example, travel with a group of 8 or more on
back-to-back expeditions, and take advantage of
both savings.

INCLUDED IN PRICE

All accommodations aboard ship or in hotels per itinerary; all meals as indicated in the itinerary, both aboard and onshore; beer, wine, cocktails, liquors and spirits aboard the ship (except certain premium brands which are available for purchase); hors d'oeuvres, 24-hour access to snacks, premium coffees and teas, non-alcoholic beverages, and filtered water; excursions and airport transfers to and from recommended flights, as indicated in the itinerary; exploration tools curated to destination, such as Zodiacs, stand-up paddleboards, kayaks; guidance and company of our leading expedition staff; assistance by the Lindblad Expeditions-National Geographic certified photo instructor; access to the OM System Photo Gear Locker; presentations by expedition staff and expert guest speakers; complimentary reusable water bottle; onboard physician consultations; morning stretch classes and 24-hour access to exercise equipment; 24-hour access to lounges, observation decks, library, and other shared spaces; basic WiFi, park and site entrance fees, special access permits, and port taxes. Unused services or items included in our programs are non-refundable.

NOT INCLUDED IN PRICE

Airfare (except flights* when indicated as included); pre- and post-expedition extensions; additional hotel nights (except when indicated as included); crew gratuities; private transfers; laundry, spa treatments, travel protection plans; and passport, visa, and immigration fees.

*Recommended flight costs include flight(s) that take place during the date range of your trip to transport travelers from one itinerary destination to another. This cost also includes ground transportation, luggage transfer,

and airport assistance. If you prefer to arrange your own flights privately, have alternate means of transport, or wish to modify at a later time, please contact an Expedition Specialist at 1.833.400.0831

Additional costs associated with medical services outside onboard physician consultation.

TRAVEL PROTECTION PLAN

We strongly recommend our guests to take advantage of our Travel Protection Plan. This plan offers comprehensive coverage to protect you from cancellation fees, costs incurred due to trip delays/interruption, damage or loss of baggage, medical assistance, and evacuation during your travels. Our Travel Protection Plan is available for U.S. residents only, and may be purchased any time prior to final payment due date, Travel Protection premiums are non-refundable once plan is purchased. Learn more about our Travel Protection "Plus" Plan: <https://www.expeditions.com/terms-conditions/travel-protection-plan/>

CANCELLATION POLICY

Review our cancellation policy: <https://www.expeditions.com/cancellation-policy/>