







# Exploring Patagonia's National Parks from Punta Arenas to Puerto Montt

Experience the full sweep of Patagonia at close range, from charming Chiloé Island to the wilds of Tierra del Fuego and the pinnacles of Torres del Paine National Park. Aboard the powerful yet nimble *National Geographic Resolution*, you'll navigate the region's winding network of fjords, channels and isles to access remote corners that reveal incandescent icebergs, gigantic glacial fields and ancient forests. Explore a swath of the breathtakingly scenic Route of the Parks, including Karukinka Reserve, which you'll visit with special permission, and spot the myriad creatures that thrive within this vast, natural kingdom.

From  
**A\$ 44,161** / per person  
 Does not include flights

 <b>DATES</b> Mar	 <b>DURATION</b> 17 Days
 <b>SHIPS</b> <i>National Geographic Resolution</i>	
 <b>STARTS AT</b> Punta Arenas, Chile	  <b>ENDS AT</b> Puerto Montt, Chile

# Highlights

- ★ Discover four national parks, including iconic Torres del Paine National Park, with its epic granite peaks, and Pumalín Douglas Tompkins National Park, where you'll hike through forests of Sequoia-sized alerce trees
- ★ Enjoy special access to Karukinka Natural Park in the wild heart of Tierra del Fuego to spot albatrosses, Andean condors, flying steamer ducks and more
- ★ Sail the legendary Beagle Channel and venture deep into the Chilean fjords to explore by Zodiac, kayak and on foot
- ★ Visit Chiloé Island, a World Heritage site beloved by Chileans and known for its brightly colored wooden stilt houses





# Day by day

## ■ DAY 1

### Santiago, Chile

Arrive in Santiago, Chile's mountainous capital. Transfer to the Ritz-Carlton (or similar).

**Arrival Time:** Arrive by 4:00 p.m. local time.

**Arrival City:** Puerto Montt, Chile

## ◇ DAY 2

### Punta Arenas / Embark Ship

Join the recommended flight from Santiago to Punta Arenas, Chile's southern gateway to Patagonia; transfers to the airport and luggage assistance will be provided. Transfer to the harbor to embark the *National Geographic Resolution*.

Meals included: breakfast, lunch, dinner

## ◇ DAY 3

### Tierra del Fuego: Karukinka Natural Park

Tierra del Fuego is one of Patagonia's crown jewels, and Karukinka Natural Park sits right in the heart of this breathtaking wilderness. Established in 2004 through a gift from Goldman Sachs, Karukinka is one of the largest donations ever made for conservation. With special permission from the Wildlife Conservation Society, visit this private reserve, which spans 1,160 square miles and harbors the endangered culpeo fox, Andean condors and many other kinds of wildlife. Explore Jackson Bay, backed by a skyline of rugged mountains, and look for wildlife—from the black-browed albatrosses that nest on a small nearby island to elephant seals, which you may spot on the beach, in grass meadows and even in the small river draining the valley inland.

Meals included: breakfast, lunch, dinner

## ◇ DAYS 4-5

### Chilean Fjords / Beagle Channel

Sail the historic Beagle Channel through a vast and pristine region of soaring, snowcapped mountains, gigantic glaciers, thousands of verdant islands, serene lakes and waterfalls. Wind through the fjords, getting up close to a number of different glaciers, and stopping along the way to Zodiac cruise or kayak in protected waters. Hike the rugged shores where the blue and white ice contrasts with the verdant forest and bright flowering plants. Look out for Andean condors, albatrosses, grebes, petrels, fulmars, shearwaters and many other birds that inhabit this otherworldly realm.

Meals included: breakfast, lunch, dinner

## ◇ DAYS 6-8

### Kirke Narrows / Puerto Natales / Torres del Paine National Park / White Narrows

After a thrilling navigation through the Kirke Narrows, arrive in Puerto Natales. From there, drive to monumental Torres del Paine National Park, a UNESCO Biosphere Reserve famed for its jagged, granite mountains topped with a thick layer of dark slate. One of the most spectacular and wildlife-rich areas in the Americas, this stunning park shelters an array of fascinating creatures, from Andean condors and flamingos to rhea and puma, throughout its 450,000 acres of glaciers, forests, grasslands, rivers and vibrant lagoons. Explore among the jaw-dropping scenery on exceptional hikes and walks through this world-famous national park, taking in the dramatic granite peaks and diverse wildlife.

Meals included: breakfast, lunch, dinner

◇ DAYS 9-12

## Inland Passage / Chilean Fjords

This vast region of incomparable scenery is seemingly untouched by humans except for a few fishing villages perched at “the end of the world.” Over the next few days, you’ll have multiple opportunities to hike, Zodiac cruise and kayak among snowcapped mountains, thousands of islands covered with forests, lakes, soaring granite walls and waterfalls.

One of the many highlights is the Pio XI Glacier, the longest glacier in the southern hemisphere outside of Antarctica, running some 60 miles from the Patagonia icefield to the fjord, where it noisily calves off gigantic ice masses at a rate of one every several minutes. Get up close to this impressive natural wonder on Zodiac rides.

Meals included: breakfast, lunch, dinner

◇ DAY 13

## Aysén / Coyhaique / Andes Mountains

Today, choose from two options. Take a morning excursion to Aiken del Sur, a privately owned park set in a beautiful evergreen forest with lovely lakes and waterfalls, including a 75-foot-high cascade. As you walk the well-maintained trails, keep an eye out for ringed kingfishers, woodpeckers and a variety of forest birds. Cap off the walk with a Patagonian lamb barbecue (with vegetarian options) and entertainment by local musicians.

Alternatively, take a full-day excursion to the Coyhaique National Reserve, driving up into a scenic valley nestled in the Andes, with views of the snow-covered peaks. The starting point for the day’s hike is Laguna Verde, “Green Lake,” which you’ll reach after passing through evergreen forest full of giant rhubarb and ferns into the transition zone of deciduous *Nothofagus* forest. An array

of animals can be found here, including three Chilean woodpecker species, passerines, diurnal and nocturnal predatory birds, pumas and foxes. After the hike, enjoy a picnic lunch followed by time in the city of Coyhaique to see its central plaza and artisans’ stalls.

Meals included: breakfast, lunch, dinner

◇ DAY 14

## Tantauco Park

Located in the wildest and most remote territory of the Great Island of the Chiloé Archipelago, Tantauco Park is made up of evergreen forests, millennial cypress groves, bog plains from the last glacial period and imposing lakes and rivers. A formidable diversity of flora and fauna, including many endangered species, are concentrated within, and the park has been declared one of the 36 key sites of biodiversity on Earth, as well as a priority conservation spot in Chile. You will have a choice of walks or hikes through the forests with your naturalist guides and an opportunity to visit the museum and information center to learn more about the history, ecology and conservation work in this remote and rugged region.

Meals included: breakfast, lunch, dinner

◇ DAY 15

## Castro (Chiloé Island)

Spend the day exploring Chiloé Island, which is known for its unique *palafitos*, colorful fishermen’s houses precariously built on stilts along the water’s edge, as well as its wooden churches, collectively designated a UNESCO World Heritage Site. The town of Castro has shops and a large open-air market where the Chileans show their wares, such as alpaca sweaters and lapis jewelry. You may choose a trip to Chiloé National Park to see its forests, wetlands and wildlife, with a selection of longer or shorter walks. Alternatively, visit some of the welcoming small communities that dot the

countryside and learn about their traditional rural way of life.

Meals included: breakfast, lunch, dinner

◇ DAY 16

## Pumalín Douglas Tompkins National Park

Spanning 750,000 protected acres in Chilean Patagonia, Pumalín National Park is one of the last areas where the unusual alerce forest remains. These huge trees compare in size and age to California redwoods, with some specimens reaching 2,000 years old. The Pumalín Project was established in 1995 by the late American conservationist Doug Tompkins, who wanted to preserve some of the remaining virgin forest in Chile. Walk through the forest with naturalists, visit a hidden waterfall or climb along a rushing stream and look for forest birds along the trail. In the afternoon, head for the Golfo de Corcovado in search of Magellanic penguins, sooty shearwaters, dolphins and, with luck, whales.

Meals included: breakfast, lunch, dinner

■ DAY 17

## Puerto Montt / Disembark Ship / Santiago

Disembark in Puerto Montt, where you'll have some free time to explore before proceeding to the airport for your flight to Santiago and return flights home.

**Departure Time:** Depart after 6:00 p.m. local time.

**Departure City:** Santiago, Chile

Meals included: breakfast

## Expedition

Punta Arenas, Chile → Puerto Montt, Chile

### 2027 DEPARTURE DATES

Aboard *National Geographic Resolution*

05 Mar				
--------	--	--	--	--



## National Geographic Resolution

GUESTS

138

CABINS

76

**The sister ship to *National Geographic Endurance*, she explores polar & temperate regions**

Our second new polar build, *National Geographic Resolution*, is named to honor the second voyage of the legendary Captain James Cook. A fully-stabilized vessel of the highest ice class (PC5 Category A), she will enable adventurous guests to go where few have or can. Resolution's most striking exterior feature is her distinctive profile, the patented X-Bow®, a game-changing design that guarantees the smoothest, most comfortable ride in all kinds of conditions; and since it eliminates bow impact, a quieter ride, as well.

An equally impressive feature may well be her capacity: she carries just 138 guests, a commitment to expedition excellence over scale. Scandinavian-inflected, luxuriously appointed, her inviting interiors would be a destination in themselves. Because she is a Lindblad expedition ship, however, her attention is focused on the world outside – with acres of window glass to keep you connected to the stunning views beyond the pane, and a fleet of expedition tools to get you out exploring.

*National Geographic Endurance* and *National Geographic Resolution* are next-generation expedition ships. Purpose-built for polar navigation. Fully stabilized, highly strengthened, ice-class Polar Code PC5 (Category A) vessels, they are designed to navigate polar passages year-round, and safely explore uncharted waters, while providing exceptional comfort. The patented X-bow<sup>®</sup> is key to their design; its powerful wave-slicing action provides an extremely smooth ride even in adverse conditions, and even reduces spray on deck for superior observation. They carry a full suite of expedition tools, and offer a variety of experience enhancing amenities.

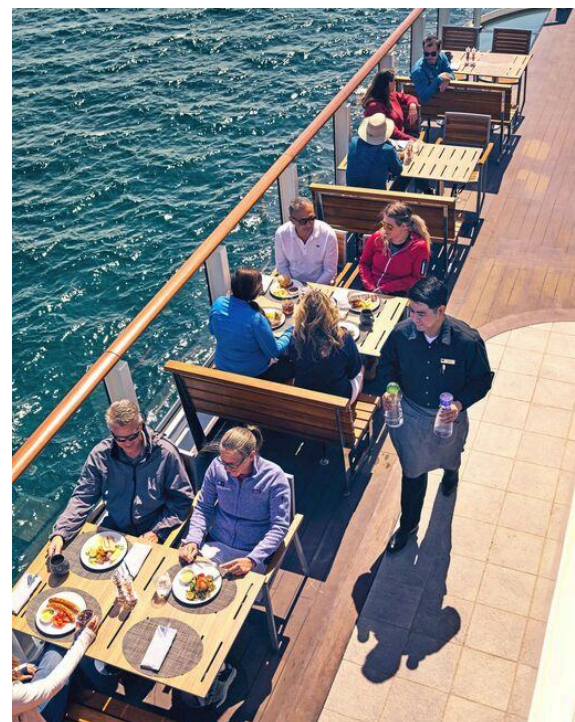

# Cabin Categories

## Category 1

FORE DECK #404, 406, 408, 411, 413, 415

Cabin with two large windows, two singles that can convert to a queen, writing desk and chair, two bedside tables, window sofa, coffee table, and a closet.



## Category 2

FORE DECK #410, 412, 414, 416-419, 421-427

Cabin with two large windows, two single beds that can convert to a queen, window sofa, two-seat sofa, coffee table, writing desk with an office chair, two bedside tables, coffee table, and a closet.



## Category 3

MAIN DECK #512-524

Cabin with balcony that features two balcony chairs, hammock, and a table; two single beds that convert to a queen; convertible sleeper sofa; writing desk with a chair; two bedside tables; coffee table; and a closet.



## Category 4

LOUNGE DECK #608, 610, 612, 613-623

Cabin with balcony that features two balcony chairs, hammock and a table; two single beds that can convert to a queen; pull-out sofa; coffee table; writing desk with chair; two bedside tables; and a closet.



## Category 5

BRIDGE DECK #700-707, 712, 713, 715, 717

Cabin with balcony that features two balcony chairs, hammock, and a table; two single beds that convert to a queen; convertible sleeper sofa; coffee table; writing desk with chair; two bedside tables; and a closet.



## Category 6

BRIDGE DECK #714

Junior suite with balcony that features two balcony chairs, hammock, and table; two single beds that convert to a queen; pull-out sofa; writing desk with chair; two bedside tables; coffee table; espresso maker and a closet. Guests receive priority access to one spa treatment and one igloo reservation and complementary laundry per departure.



## Category 7

BRIDGE DECK #708-711, 716, 718, 719, 721

These large balcony suites feature two balcony chairs, hammock, and table; two single beds that can convert to a queen; pull-out sofa; coffee table; writing desk and chair; espresso maker; and a large walk-in closet with full length mirror. Expanded bathroom has a double vanity, bathtub, towel warmer and rain shower. Guests receive priority access to one spa treatment and one igloo reservation and complementary laundry per departure.

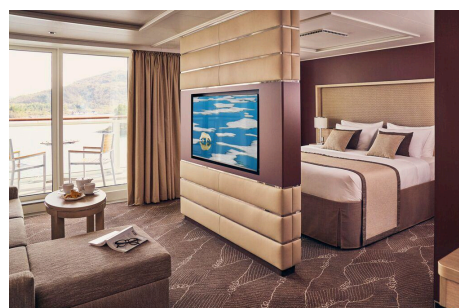

## Category A Solo

MAIN DECK #504-510, 513

Cabin with balcony that features two balcony chairs, hammock, and a table; single bed; writing desk with an office chair; and a closet.



## Category B Solo

LOUNGE DECK #604-607, 609, 611

Cabin with balcony that features two balcony chairs, hammock, and a table; single bed; writing desk with chair; hammock; and a closet.



# Deck Plans

## Observation Deck

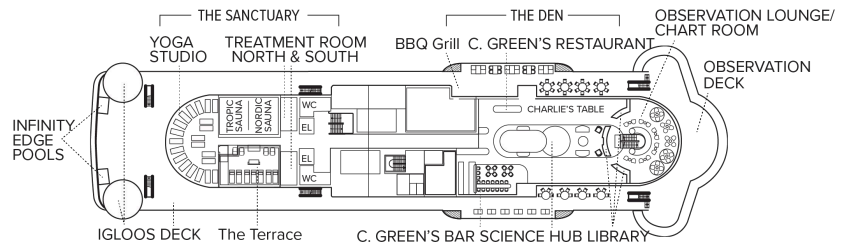

## Bridge Deck

- Category 5
- Category 6
- Category 7

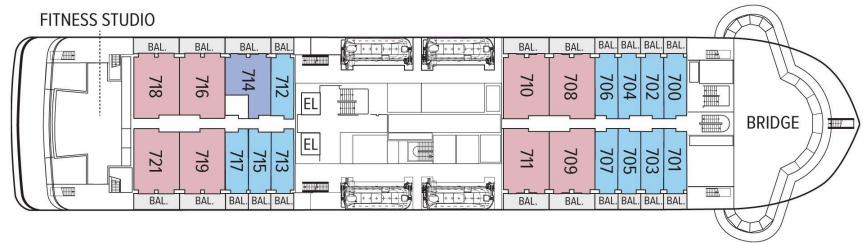

## Lounge Deck

- Category 4
- Category B Solo

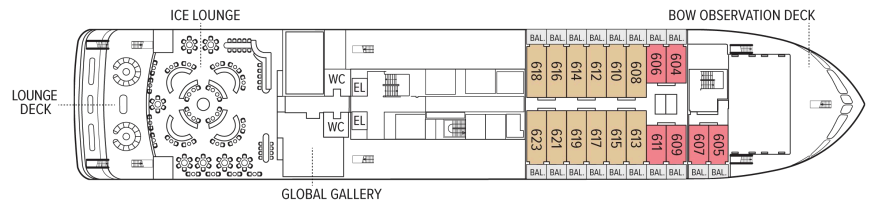

## Main Deck

- Category 3
- Category 2 Solo

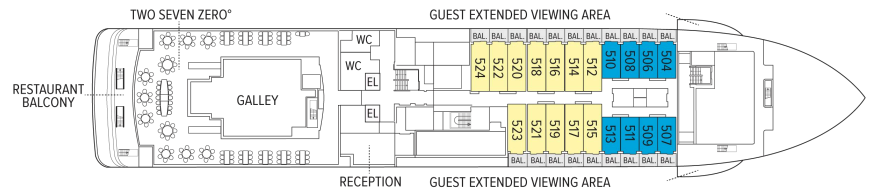

## Fore Deck

- Category 1
- Category 2

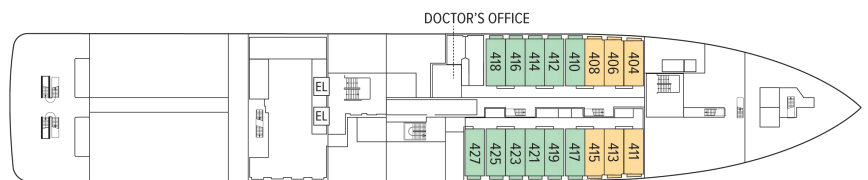

## Expedition Deck

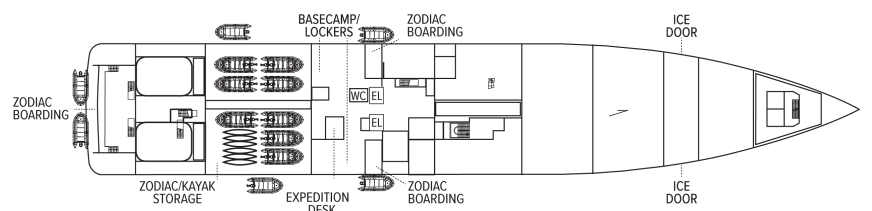

# Ship Amenities

## Public Areas

Reception; three dining areas; an observation lounge with bar, gym, wellness area, infinity-style outdoor hot tubs with adjacent igloos; library; main lounge with full service bar, 24-hour beverage station, state-of-the-art tech for films/presentations; OM System photo locker and a photo workshop area; science hub; an onboard broadcast studio; an expedition base with lockers for expedition gear; and open access to the Bridge, Captain, officers and on-duty wildlife spotters.

## Meals

Restaurant 270° features wrap-around views; two other dining areas offer lighter, made-to-order fare or intimate, small group dinners. All feature sustainable choices, local where possible, and unassigned, flexible, inclusive seating.

## Cabins

All cabins face outside with large windows, private bathroom, and climate controls. Cabins are equipped with expedition command centers with iPad tablets, multiple electrical and USB outlets, TVs, with on demand entertainment, phone, Wi-Fi, clock, barometers, hygrometers, vanity mirror, mini refrigerator, small safe, ice bucket, glasses, hair dryer, reading lights and National Geographic Atlas. Luxury linens and pillows. Bathrooms outfitted with Rain showers & hand held shower, botanically inspired shampoo, conditioner, shower gel and lotion. Complimentary insulated water bottles. Balcony cabins have hammocks, chairs and table.

## Expedition Equipment

Zodiac landing craft, kayaks, snowshoes, cross-country skis, an ROV and underwater video camera for unique access to the polar undersea, hydrophone, aerial remote-controlled camera and video microscope.

## Special Features

A full-time doctor, undersea specialist, National Geographic photographer, National Geographic-Lindblad Expeditions certified photo instructor and video chronicler, an internet cafe and laundry. A forward and aft staircase, and elevators, reach all decks. Echoing the pioneering installation aboard *National Geographic Endurance*, artist Zaria Forman has curated a new exhibit featuring a wide range of artists.



## Wellness

A glass-enclosed yoga studio, gym, treatment rooms and spa relax area, and high and low-heat saunas with ocean views, staffed by wellness specialists.

## Self-Disinfecting Ships

ACT Clean Coat™ is a light-activated, self-disinfecting cleaning process that continuously breaks down viruses, bacteria, mold, and airborne allergens across all ship surfaces. Not only does this create a cleaner, healthier shipboard environment for guests and crew alike, but this non-toxic, chemical-free system also saves more than one million gallons of water each year in our cleaning procedures, and reduces our carbon footprint as well as the amount of plastic and waste in our supply chain.

# Special Offers

on extensions, and may not be combined with other offers. Call for details.

## SUITE EXCLUSIVES

Spacious living areas and incredible views immerse you in the beauty of your marine surroundings.

Our new Suite Exclusives package helps make your voyage all the more memorable. [Learn more](#)

## CELEBRATE LIFE'S MILESTONES

Celebrate a milestone with a group of eight or more and enjoy a special amenity package including: 5% savings on voyage fares, custom group photo, US\$150 shipboard credit for the group, and other special gifts. Milestone celebration to be communicated at time of booking.

## COMBINING OFFERS

Certain offers may be combinable, up to two savings opportunities, except where noted otherwise.

For example, travel with a group of 8 or more on back-to-back expeditions, and take advantage of both savings.

## 10% OFF BACK-TO-BACK VOYAGES

Save 10% on consecutive departures, applicable on voyage fares only and not valid on extensions or airfare. Valid for new bookings only, subject to availability, and may not be combined with other offers. Call for details.

## SAVE 5% TRAVELING AS A GROUP

Save 5% when traveling as a group of 8 or more people. Valid for new bookings only on select departures, subject to availability, not applicable

## INCLUDED IN PRICE

All accommodations aboard ship or in hotels per itinerary; all meals as indicated in the itinerary, both aboard and onshore; beer, wine, cocktails, liquors and spirits aboard the ship (except certain premium brands which are available for purchase); hors d'oeuvres, 24-hour access to snacks, premium coffees and teas, non-alcoholic beverages, and filtered water; excursions and airport transfers, as indicated in the itinerary, as indicated in the itinerary; crew gratuities; exploration tools curated to destination, such as Zodiacs, and kayaks; guidance and company of our leading expedition staff; assistance by the National Geographic photographer and National Geographic-Lindblad Expeditions certified photo instructor; Basic Wi-Fi aboard ship; complimentary reusable water bottle; access to the OM System Photo Gear Locker; presentations by expedition staff and expert guest speakers; complimentary reusable water bottle; onboard physician consultations; morning stretch classes and 24-hour access to exercise equipment; 24-hour access to lounges, observation decks, library, and other shared spaces; park and site entrance fees, special access permits, and port taxes. Unused services or items included in our programs are non-refundable.

## NOT INCLUDED IN PRICE

Airfare (except flights\* when indicated as included); pre- and post-expedition extensions; additional hotel nights (except when indicated as included); private transfers; laundry, spa treatments, enhanced and premium Wi-Fi plans aboard expedition fleet; phone services (except when indicated as included); travel protection plans; and passport, visa, and immigration fees. \*Recommended flight costs include flight(s) that take place during the date

range of your trip to transport travelers from one itinerary destination to another. This cost also includes ground transportation, luggage transfer, and airport assistance. If you prefer to arrange your own flights privately, have alternate means of transport, or wish to modify at a later time, please contact an Expedition Specialist at 1.833.400.0831 Additional costs associated with medical services outside onboard physician consultation. For select voyages, completing a medical evaluation form with VIKAND is required. If you utilize your physician, VIKAND's processing fee for your documentation will be added to your National Geographic-Lindblad Expeditions invoice. If you utilize VIKAND's physicians, an additional charge will be due and payable directly to VIKAND.

## TRAVEL PROTECTION PLAN

We strongly recommend our guests to take advantage of our Travel Protection Plan. This plan offers comprehensive coverage to protect you from cancellation fees, costs incurred due to trip delays/interruption, damage or loss of baggage, medical assistance, and evacuation during your travels. Our Travel Protection Plan is available for U.S. residents only, and may be purchased any time prior to final payment due date, Travel Protection premiums are non-refundable once plan is purchased. Learn more about our Travel Protection "Plus" Plan: <https://www.expeditions.com/terms-conditions/travel-protection-plan/>

## CANCELLATION POLICY

Review our cancellation policy: <https://www.expeditions.com/cancellation-policy/>