



Iceland, Arctic & Europe
66° 4' N 27° 21' W

A Circumnavigation of Iceland

Experience the geological extremes on one of the world's youngest islands. Walk on lava fields and ice sheets. Feel the wondrous power of hot springs and waterfalls. Cruise into the Westfjords and spot nesting sea birds. Hike along magnificent stretches of coast. Icelandic experts and musicians add insight and energy to the expedition.

NEW IN 2025: Sail around Iceland in less time on a [new 8-day expedition](#) , launching Spring 2025-explore the region's famed dramatic beauty, plus receive a \$500 credit towards your departure.

From
\$ 18,400 / per person
Does not include flights



DATES

Jul



DURATION

10 Days



SHIPS

National Geographic Endurance



STARTS AT

Reykjavík,
Iceland



ENDS AT

Reykjavík,
Iceland

Highlights

- ★ Circumnavigate the Island of Fire and Ice, from its wealth of wildlife and striking geological formations to its cultural history steeped in saga
- ★ Explore a variety of landscapes across the island, from lava fields and seismic faults to geothermal springs and thundering waterfalls
- ★ Hike up mountain trails, kayak in protected fjords, bike through remote villages or take a Zodiac cruise around a seabird colony
- ★ Experience traditional Icelandic life, from the once-booming herring industry to eiderdown production or local forestry associations





Day by day

■ DAY 1

Reykjavík, Iceland / Embark Ship

Arrive in Reykjavík, the world's northernmost capital, which lies just below the Arctic Circle. Transfer from the airport to the city and spend the day exploring at your own pace. Check in with the hospitality desk this afternoon before embarking the ship.

Arrival City: Reykjavík, Iceland

Meals included: dinner

◇ DAY 2

Westfjords

Explore the beautiful and peaceful Westfjords region of Iceland. Hike along the base of a fjord to discover a towering waterfall. Enter Ísafjarðardjúp, known for its wealth of animal life including whales, seals and countless nesting seabirds. Land at Vigur Island, a fragile wildlife sanctuary, where the landowners continue the traditional eiderdown collection and cleaning process and serve as active stewards of the colonies of puffins and black guillemots who call the island home.

Meals included: breakfast, lunch, dinner

◇ DAY 3

Skagafjörður

Skagafjörður is the gateway to north Iceland, known for its glacier rivers, Icelandic horses and saga history. Take a float trip on the Jökulsá river or visit a historic rural turf farm to understand rural life in Iceland. Or choose to explore Drangey Island and learn about Grettir the Strong and the saga named after him. You'll also have a chance to spot the multitudes of birds that call the island home, such as kittiwakes, shearwaters and possibly even ravens and gyrfalcons.

Meals included: breakfast, lunch, dinner

◇ DAY 4

Siglufjörður

Siglufjörður was the center of Iceland's once-thriving herring industry. Stop by the Herring Museum for a salting demonstration and a tasting. Enjoy the surroundings of Iceland's northern most mainland settlement by joining the local forestry association for an afternoon of conservation in their local woods.

Meals included: breakfast, lunch, dinner

◇ DAY 5

Húsavík

Húsavík, the site of the first house built in Iceland, is the gateway to the geological exploration of northern Iceland. Depart for a full day overland visiting one of the largest waterfalls in Iceland, Goðafoss, as well as the Lake Mývatn area, the most geologically active area in Iceland. Alternatively, enjoy an adventurous journey through Ásbyrgi Canyon, said to be formed from the hoof of Odin, filled with hiking and waterfall exploration, or stay along the coast and take a slower pace to the day with forest bathing, bird watching and a soak in the GeoSea bath.

Meals included: breakfast, lunch, dinner

◇ DAY 6

Grímsey / At Sea

This morning, take Zodiacs ashore to the tiny island of Grímsey, which lies exactly on the Arctic Circle. Celebrate officially arriving in the Arctic, in the company of nesting arctic terns, fulmars and puffins in burrows. Enjoy an afternoon at sea sailing around the northern corner of Iceland to start your journey

south.

Meals included: breakfast, lunch, dinner

◇ DAY 7

Borgarfjörðurhöfn

Located on the eastern shore of Iceland, Bakkagerði is well known for its local puffin colony and striking fjords. Walk across boardwalks to witness these colorful symbols of Icelandic wildlife. Once you have your best puffin photos, take an invigorating hike up to the best panoramic view of the fjord or bike along the fjord for an alternative view.

Meals included: breakfast, lunch, dinner

◇ DAY 8

Djúpivogur

Arrive in Djúpivogur and drive down the coast to explore the foot of the vast Vatnajökull icecap and the deep blue icebergs of the large ice lagoon of Jökulsárlón. Alternatively, visit some of the secluded valleys and remote waterfalls in the countryside around Djúpivogur or join a hike to the black sand beaches of southern Iceland.

Meals included: breakfast, lunch, dinner

◇ DAY 9

Islands of Heimaey and Surtsey, Westman Islands

The Westman Islands were formed by undersea volcanoes between 5,000 and 10,000 years ago and are among the youngest of the world's archipelagos. In 1963, the world witnessed on film the birth of its newest island, Surtsey—a UNESCO World Heritage site—which you'll see as you cruise past the coast. In 1973, Heimaey was threatened by lava flows that nearly closed off its harbor. Visit the crater, where the earth is still hot, for amazing views of areas that had been engulfed by lava.

Meals included: breakfast, lunch, dinner

■ DAY 10

Reykjavík / Disembark Ship

Disembark in Reykjavík and transfer to the airport for flights home.

Departure City: Reykjavík, Iceland

Meals included: breakfast

Expedition

Reykjavík, Iceland → Reykjavík, Iceland

2025 Departure Dates

Aboard *National Geographic Endurance*

18 Jul			
--------	--	--	--



National Geographic Endurance

Guests	Cabins
138	76

The most advanced ice-class expedition ship afloat, the *National Geographic Endurance* offers unprecedented access to polar regions.

The first new polar build in Lindblad's 50-year history, *National Geographic Endurance* is named to honor explorer Ernest Shackleton and his legendary Transantarctic Expedition.

A fully-stabilized vessel of the highest ice class (PC5 Category A), she will enable adventurous guests to go where few have or can. Endurance's most striking exterior feature is her distinctive profile, the patented X-Bow®, a game-changing design that guarantees the smoothest, most comfortable ride in all kinds of conditions; and since it eliminates bow impact, a quieter ride, as well.

An equally impressive feature may well be her capacity: she carries just 138 guests, a commitment to expedition excellence over scale. Scandinavian-inflected, luxuriously appointed, her inviting interiors would be a destination in themselves. Because she is a Lindblad expedition ship, however, her attention is focused on the world outside—with acres of window glass to keep you connected to the stunning views beyond the pane, and a fleet of expedition tools to get you out exploring.

National Geographic Endurance and *National Geographic Resolution* are next-generation expedition ships. Purpose-built for polar navigation. Fully stabilized, highly strengthened, ice-class Polar Code PC5 (Category A) vessels, they are designed to navigate polar passages year-round, and safely explore uncharted waters, while providing exceptional comfort. The patented X-bow[®] is key to their design; its powerful wave-slicing action provides an extremely smooth ride even in adverse conditions, and even reduces spray on deck for superior observation. They carry a full suite of expedition tools, and offer a variety of experience enhancing amenities.



Cabin Categories

Category 1

Fore Deck: #404, 406, 408, 411, 413, 415

Fore Deck, with two large windows, two singles that can convert to a queen, armchair, writing desk and chair, two bedside tables, window sofa and a closet.



Category 2

Fore Deck: #410, 412, 414, 416-419, 421-427

Fore Deck, with two large windows, two single beds that can convert to a queen, window sofa, two-seat sofa, coffee table, armchair, writing desk with an office chair, two bedside tables and a closet.



Category 3

Main Deck: #512, 514-524

Cabin with balcony that features two balcony chairs, hammock, and a table; two single beds that convert to a queen; convertible sleeper sofa; writing desk with a chair; two bedside tables; coffee table; and a closet.



Category 4

Lounge Deck: #608, 610, 612, 613-623

Cabin with balcony that features two balcony chairs, hammock and a table; two single beds that can convert to a queen; pull-out sofa; coffee table; writing desk with chair; two bedside tables; and a closet.



Category 5

Bridge Deck: #700-707, 712, 713, 715, 717

Cabin with balcony that features two balcony chairs, hammock, and a table; two single beds that convert to a queen; convertible sleeper sofa; coffee table; writing desk with chair; two bedside tables; and a closet.



Category 6

Bridge Deck: #714

Junior suite with balcony that features two balcony chairs, hammock, and table; two single beds that convert to a queen; pull-out sofa; writing desk with chair; two bedside tables; coffee table; espresso maker; and a closet. Guests receive priority access to one spa treatment and one igloo reservation and complementary laundry per departure.



Category 7

Bridge Deck: #708-711, 716, 718, 719, 721

These large balcony suites feature two balcony chairs, hammock, and table; two single beds that can convert to a queen; pull-out sofa; coffee table; writing desk and chair; espresso maker; and a large walk-in closet with full length mirror. Expanded bathroom has a double vanity, bathtub, towel warmer and rain shower. Guests receive priority access to one spa treatment and one igloo reservation and complementary laundry per departure.



Category A Solo

Main Deck: #504, 506-511, 513

Cabin with balcony that features two balcony chairs, hammock, and a table; single bed; writing desk with an office chair; and a closet.



Category B Solo

Lounge Deck: #604-607, 609, 611

Cabin with balcony that features two balcony chairs, hammock, and a table; single bed; writing desk with chair; hammock; and a closet.



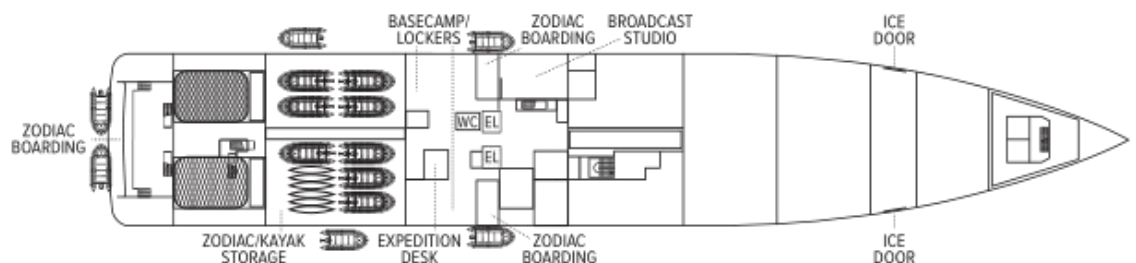
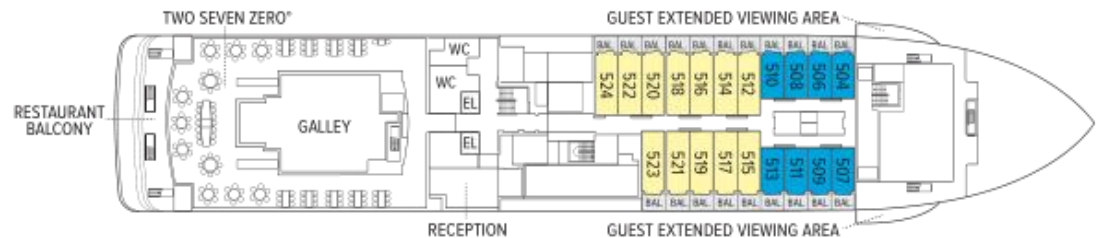
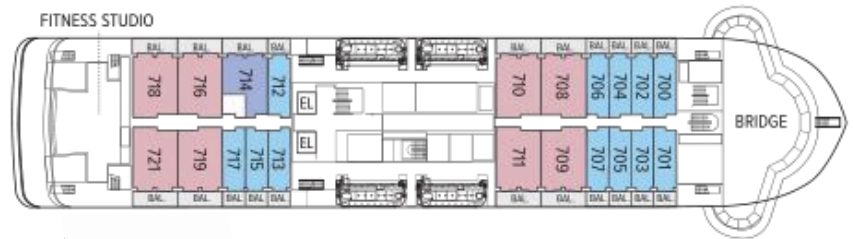
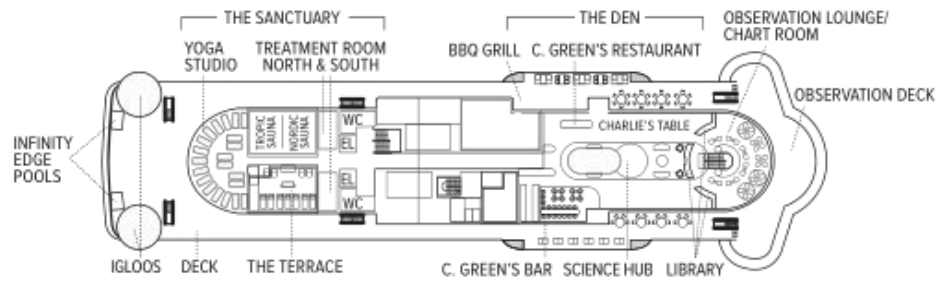

Ship amenities

Public Areas

Reception; three dining areas; an observation lounge with bar, gym, wellness area, infinity-style outdoor hot tubs with adjacent igloos; library; main lounge with full service bar, 24-hour beverage station, state-of-the-art tech for films/presentations; B&H Photo locker and a photo workshop area; science hub; an onboard broadcast studio; an expedition base with lockers for expedition gear; and open access to the Bridge, Captain, officers and on-duty wildlife spotters.

Meals

Restaurant 270° features wrap-around views; two other dining areas offer lighter, made-to-order fare or intimate, small group dinners. All feature sustainable choices, local where possible, and unassigned, flexible, inclusive seating.

Cabins

All cabins face outside with large windows, private bathroom, and climate controls. Cabins are equipped with expedition command centers with iPad tablets, multiple electrical and USB outlets, TVs, with on demand entertainment, phone, Wi-Fi, clock, barometers, hygrometers, vanity mirror, mini refrigerator, small safe, ice bucket, glasses, hair dryer, reading lights and National Geographic Atlas. Luxury linens and pillows. Bathrooms outfitted with Rain showers & hand held shower, botanically inspired shampoo, conditioner, shower gel and lotion. Complimentary insulated water bottles. Balcony cabins have hammocks, chairs and table.

Expedition Equipment

Zodiac landing craft, kayaks, snowshoes, cross-country skis, an ROV and underwater video camera for unique access to the polar undersea, hydrophone, aerial remote-controlled camera and video microscope.

Special Features

A full-time doctor, undersea specialist, National Geographic photographer, Lindblad-National Geographic certified photo instructor and video chronicler, an internet cafe and laundry. A forward and aft staircase, and elevators, reach all decks. Echoing the pioneering installation aboard *National Geographic Endurance*, artist Zaria Forman has curated a new exhibit, featuring a wide range of artists.



Wellness

A glass-enclosed yoga studio, gym, treatment rooms and spa relax area, and high and low-heat saunas with ocean views, staffed by wellness specialists.

Self-Disinfecting Ships

ACT Clean Coat™ is a light-activated, self-disinfecting cleaning process that continuously breaks down viruses, bacteria, mold, and airborne allergens across all ship surfaces. Not only does this create a cleaner, healthier shipboard environment for guests and crew alike, but this non-toxic, chemical-free system also saves more than one million gallons of water each year in our cleaning procedures, and reduces our carbon footprint as well as the amount of plastic and waste in our supply chain.

Special Offers

60% reduced deposit for any 2026 voyage

Book between June 3 and August 1, 2025 and receive 60% off the deposit due at the time of booking. Remaining deposit balance is due at the time of final payment. Additional restrictions may apply. Offer valid for new bookings only on 2026 departures, subject to availability and offer may be withdrawn at any time without prior notice, not applicable on airfare or extensions, and may not be combined with other offers. Call for details.

SUITE EXCLUSIVES

Spacious living areas and incredible views immerse you in the beauty of your marine surroundings. Our new Suite Exclusives package helps make your voyage all the more memorable. [Learn more](#)

SAVE 5% TRAVELING AS A GROUP

Save 5% when traveling as a group of eight or more people. Valid on voyage fares only and not applicable on extensions or airfare. Deposit, final payments, and cancellation policies for group travel vary from our regular policies. Valid for new bookings only, subject to availability, and may not be combined with other offers. Call for details.

CELEBRATE LIFE'S MILESTONES

Celebrate a milestone with a group of eight or more and enjoy a special amenity package including: 5% savings on voyage fares, custom group photo, US\$150 shipboard credit for the group, and other special gifts. Milestone celebration to be communicated at time of booking.

PAY BY DEBIT: EARN A \$100 ONBOARD

CREDIT

The \$100 onboard credit offer is applied after the final payment and requires 85% of the cost of the voyage to be placed on a debit card. Maximum of one \$100 onboard credit per cabin. The \$100 onboard credit is a non-refundable, non-transferable credit that can be used for various onboard purchases such as global gallery and spa treatments. It has no cash value, cannot be refunded if not fully utilized, and will be forfeited if not fully redeemed by the end of the voyage. This offer is combinable with other offers. If the booking is altered or canceled, the onboard credit may be forfeited, and it cannot be transferred if the booking is moved to another guest. Lindblad Expeditions reserves the right to modify or cancel the offer without prior notice. Offer applies to Lindblad Expeditions' owned ships only. Offer valid only for Debit Cards issued in the United States for payments made from the United States.

COMBINING OFFERS

Certain offers may be combinable, up to two savings opportunities, except where noted otherwise. For example, travel with a group of 8 or more on back-to-back expeditions, and take advantage of both savings.

Included in price

All accommodations aboard ship or in hotels per itinerary; all meals as indicated in the itinerary, both aboard and onshore; beer, wine, cocktails, liquors and spirits aboard the ship (except certain premium brands which are available for purchase); hors d'oeuvres, 24-hour access to snacks, premium coffees and teas, non-alcoholic beverages, and filtered water; excursions and airport transfers to and from recommended flights, as indicated in the itinerary; crew gratuities; exploration tools curated to destination, such as Zodiacs, kayaks, guidance and company of our leading expedition staff; assistance by the National Geographic Photographer and Lindblad Expeditions-National Geographic certified photo instructor; access to the OM System Photo Gear Locker; presentations by expedition staff and expert guest speakers; complimentary parka or jacket, complimentary reusable water bottle; onboard physician consultations; morning stretch classes and 24-hour access to exercise equipment; 24-hour access to lounges, observation decks, library, and other shared spaces; park and site entrance fees, special access permits, and port taxes. Unused services or items included in our programs are non-refundable.

Not included in price

Airfare (except flights* when indicated as included); pre- and post-expedition extensions; additional hotel nights (except when indicated as included); private transfers; laundry, spa treatments, Wi-Fi, and phone services (except when indicated as included); travel protection plans; and passport, visa, and immigration fees.

*Recommended flight costs include flight(s) that take place during the date range of your trip to transport travelers from one itinerary destination to another. This cost also includes ground transportation, luggage transfer, and airport assistance. If you prefer to arrange your own flights privately, have alternate means of transport, or wish to modify at a later time, please contact an Expedition Specialist at 1.833.400.0831

Additional costs associated with medical services outside onboard physician consultation.

We strongly recommend our guests to take advantage of our Travel Protection Plan. This plan offers comprehensive coverage to protect you from cancellation fees, costs incurred due to trip delays/interruption, damage or loss of baggage, medical assistance, and evacuation during your travels. Our Travel Protection Plan is available for U.S. residents only, and may be purchased any time prior to final payment due date. Travel Protection premiums are non-refundable once plan is purchased. Learn more about our Travel Protection "Plus" Plan: <https://www.expeditions.com/terms-conditions/travel-protection-plan/>

Cancellation policy

Review our cancellation policy: <https://www.expeditions.com/cancellation-policy/>

Travel protection plan