







Arctic, Canada & North America
 64° 10' N 51° 44' W

Baffin Island: Exploring Canada's Wild Arctic Frontier

Sail across the Davis Strait into the remote reaches of Canada's High Arctic, where sheer cliffs rise from the sea, ancient ice floes drift past the bow and charismatic wildlife thrives in one of the most untouched ecosystems on the planet. Baffin Island, with its vast, roadless landscape, is the centerpiece of this extraordinary voyage and you'll venture deep into its seemingly inaccessible network of icy bays, inlets and fjords aboard the purpose-built *National Geographic Resolution*. This is true expedition travel, and your days will be guided by the ice, weather and wildlife as your naturalists, historians and photographers deepen your understanding of the land and daily life in the Arctic.

From
A\$ 22,822 / per person
 Does not include flights

 DATES Aug	 DURATION 13 Days
 SHIPS <i>National Geographic Resolution</i>	
 STARTS AT Reykjavík, Iceland	 ENDS AT Reykjavík, Iceland

Minimum Age Requirement: Any children booked on Antarctic or Arctic voyages must be at least 4 years old at time of embarkation.

Highlights

- ★ Explore the glacier-carved fjords, coastal cliffs and remote headlands of Baffin Island—home to dramatic scenery, lively seabird colonies and ancient cultural sites
- ★ Search for the region’s iconic wildlife, from polar bears and whales to walrus and possibly narwhals, with the help of your naturalists
- ★ Venture into the wilds of the high Arctic with a flexible itinerary designed to maximize opportunities for wildlife viewing, Zodiac landings, kayaking excursions and unexpected discoveries
- ★ While crossing to and from Greenland and Canada, enjoy immersive talks and storytelling that illuminate the science, history and culture of these two dynamic Arctic icons

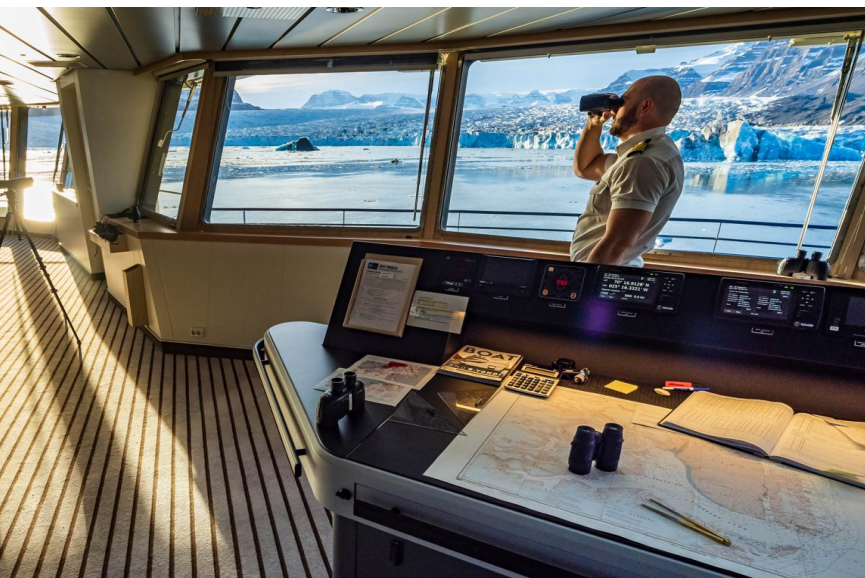
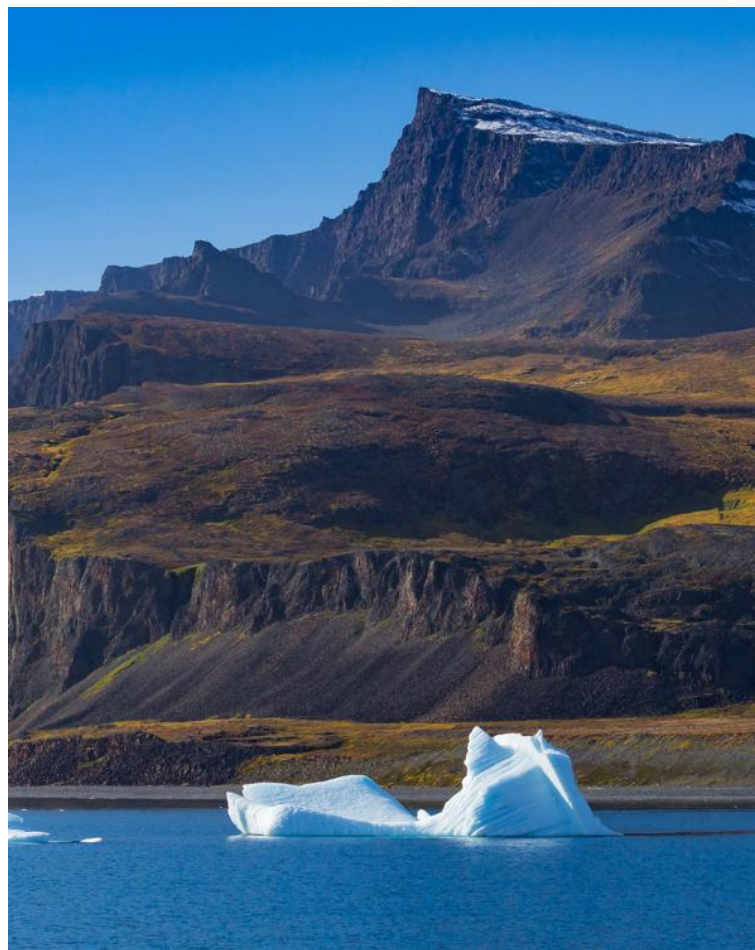



Day by day

■ DAY 1

Reykjavík, Iceland

Arrive in Reykjavík, the world's northernmost capital. Transfer from the airport and spend the day exploring the city at your own pace. Check in with the hospitality desk at your hotel this afternoon to make final arrangements before your charter flight the following day.

◇ DAY 2

Reykjavík / Nuuk, Greenland / Embark Ship

Fly from Reykjavík on the recommended flight to Nuuk, Greenland's thriving capital city, where you'll embark the *National Geographic Resolution*. Settle into your cabin and then be on deck to enjoy a scenic sailing out of Nuuk fjord as the ship navigates north along the coastline and into open waters.

Meals included: breakfast, lunch, dinner

◇ DAY 3

Crossing the Davis Strait

Spend the day at sea crossing the Davis Strait, which connects the Arctic and Atlantic Oceans. Listen to expert talks from your expedition team, relax with a book in the lounge or hang out on the Bridge or the observation deck, keeping an eye out for whales as the ship travels across the continental shelf.

Meals included: breakfast, lunch, dinner

◇ DAYS 4-10

Exploring Baffin Island, Nunavut, Canada

Over the next six days, explore the natural wonders of Baffin Island, Canada's largest island and the fifth largest in the world. Known as Qikiqtaaluk by Inuit and inhabited for over four thousand years, the shores of this majestic island are rife with opportunities to step back in time and discover one of the most remote areas of the planet like the earliest explorers who came before.

With no set itinerary, your veteran captain and expedition leader will decide on routes and activities in real time as they respond to the day's elements and wildlife sightings, navigating the state-of-the-art polar ship further into the ice to uncharted fjords or returning to favorite landing sites.

As you head south, you'll experience the region's breathtaking landscapes, defined by glaciers, waterfalls and towering peaks, and watch for the wildlife that inhabits these waterways and rugged isles such as polar bears, seals, whales and, with luck, maybe even the elusive narwhal.

Meals included: breakfast, lunch, dinner

◇ DAY 11

Crossing the Davis Strait

Sail across the Davis Strait once more as you reflect on your experience in the far reaches of the globe, exchanging stories with your fellow travelers or editing photos with the help of your certified photography instructor. Take advantage of the ship's amenities one last time with a relaxing spa treatment from your wellness specialist, a dip in the infinity-style hot tub or a session in the sauna as you take in the ocean views.

Meals included: breakfast, lunch, dinner

◇ DAY 12

Nuuk / Disembark Ship / Reykjavík, Iceland

Disembark in Nuuk and join the recommended group flight to Reykjavík. Transfer to the nearby hotel for an included overnight stay.

Meals included: breakfast, lunch, dinner

■ DAY 13

Reykjavík

Transfer to the airport for flights home.

Meals included: breakfast

Expedition

Reykjavík, Iceland → Reykjavík, Iceland

2027 DEPARTURE DATES

Aboard *National Geographic Resolution*

19 Aug	29 Aug			
--------	--------	--	--	--



National Geographic Resolution

Guests 138	Cabins 76
----------------------	---------------------

The sister ship to *National Geographic Endurance*, she explores polar & temperate regions

Our second new polar build, *National Geographic Resolution*, is named to honor the second voyage of the legendary Captain James Cook.

A fully-stabilized vessel of the highest ice class (PC5 Category A), she will enable adventurous guests to go where few have or can. *Resolution's* most striking exterior feature is her distinctive profile, the patented X-Bow®, a game-changing design that guarantees the smoothest, most comfortable ride in all kinds of conditions; and since it eliminates bow impact, a quieter ride, as well.

An equally impressive feature may well be her capacity: she carries just 138 guests, a commitment to expedition excellence over scale. Scandinavian-inflected, luxuriously appointed, her inviting interiors would be a destination in themselves. Because she is a Lindblad expedition ship, however, her attention is focused on the world outside— with acres of window glass to keep you connected to the stunning views beyond the pane, and a fleet of expedition tools to get you out exploring.

National Geographic Endurance and *National Geographic Resolution* are next-generation expedition ships. Purpose-built for polar navigation. Fully stabilized, highly strengthened, ice-class Polar Code PC5 (Category A) vessels, they are designed to navigate polar passages year-round, and safely explore uncharted waters, while providing exceptional comfort. The patented X-bow[®] is key to their design; its powerful wave-slicing action provides an extremely smooth ride even in adverse conditions, and even reduces spray on deck for superior observation. They carry a full suite of expedition tools, and offer a variety of experience enhancing amenities.

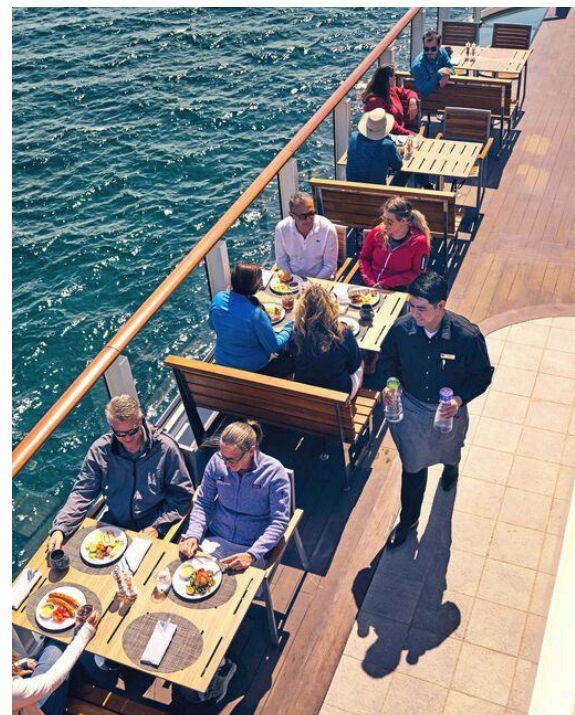

Cabin Categories

Category 1

Fore Deck: #404, 406, 408, 411, 413, 415

Cabin with two large windows, two singles that can convert to a queen, writing desk and chair, two bedside tables, window sofa, coffee table, and a closet.



Category 2

Fore Deck: #410, 412, 414, 416-419, 421-427

Cabin with two large windows, two single beds that can convert to a queen, window sofa, two-seat sofa, coffee table, writing desk with an office chair, two bedside tables, coffee table, and a closet.



Category 3

Main Deck: #512, 514-524

Cabin with balcony that features two balcony chairs, hammock, and a table; two single beds that convert to a queen; convertible sleeper sofa; writing desk with a chair; two bedside tables; coffee table; and a closet.



Category 4

Lounge Deck: #608, 610, 612, 613-623

Cabin with balcony that features two balcony chairs, hammock and a table; two single beds that can convert to a queen; pull-out sofa; coffee table; writing desk with chair; two bedside tables; and a closet.



Category 5

Bridge Deck: #700-707, 712, 713, 715, 717

Cabin with balcony that features two balcony chairs, hammock, and a table; two single beds that convert to a queen; convertible sleeper sofa; coffee table; writing desk with chair; two bedside tables; and a closet.



Category 6

Bridge Deck: #714

Junior suite with balcony that features two balcony chairs, hammock, and table; two single beds that convert to a queen; pull-out sofa; writing desk with chair; two bedside tables; coffee table; espresso maker and a closet. Guests receive priority access to one spa treatment and one igloo reservation and complementary laundry per departure.



Category 7

Bridge Deck: #708-711, 716, 718, 719, 721

These large balcony suites feature two balcony chairs, hammock, and table; two single beds that can convert to a queen; pull-out sofa; coffee table; writing desk and chair; espresso maker; and a large walk-in closet with full length mirror. Expanded bathroom has a double vanity, bathtub, towel warmer and rain shower. Guests receive priority access to one spa treatment and one igloo reservation and complementary laundry per departure.



Category A Solo

Main Deck: #504, 506-511, 513

Cabin with balcony that features two balcony chairs, hammock, and a table; single bed; writing desk with an office chair; and a closet.



Category B Solo

Lounge Deck: #604-607, 609, 611

Cabin with balcony that features two balcony chairs, hammock, and a table; single bed; writing desk with chair; hammock; and a closet.



Observation Deck

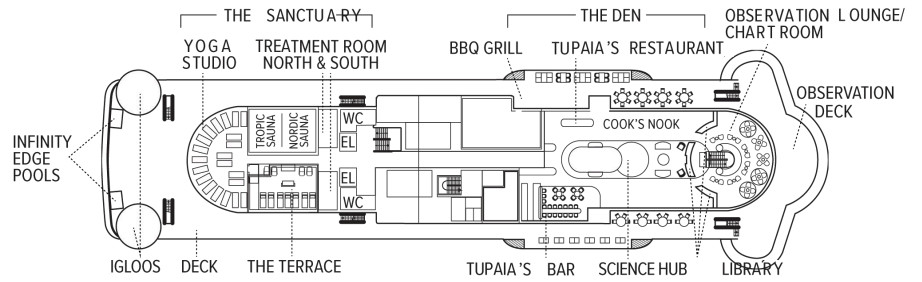

Bridge Deck

- Category 5
- Category 6
- Category 7

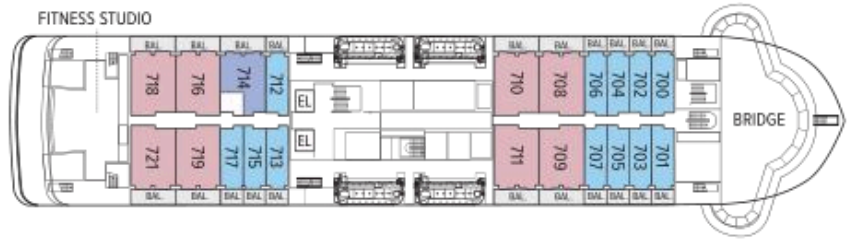

Lounge Deck

- Category 4
- Category B Solo

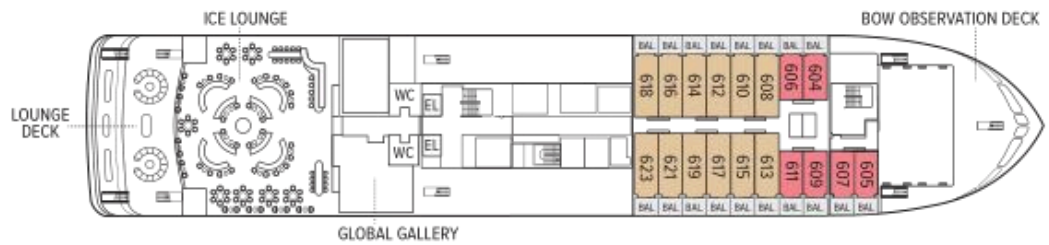

Main Deck

- Category 3
- Category A Solo



Fore Deck

- Category 1
- Category 2

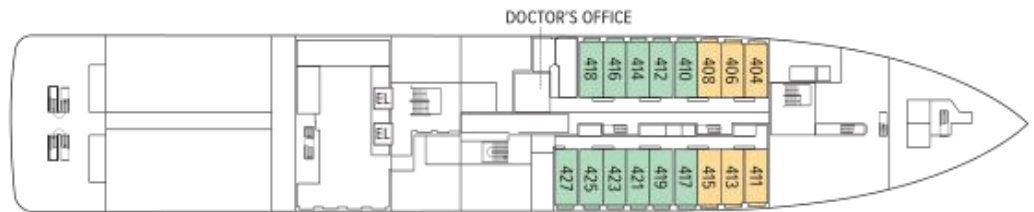

Expedition Deck

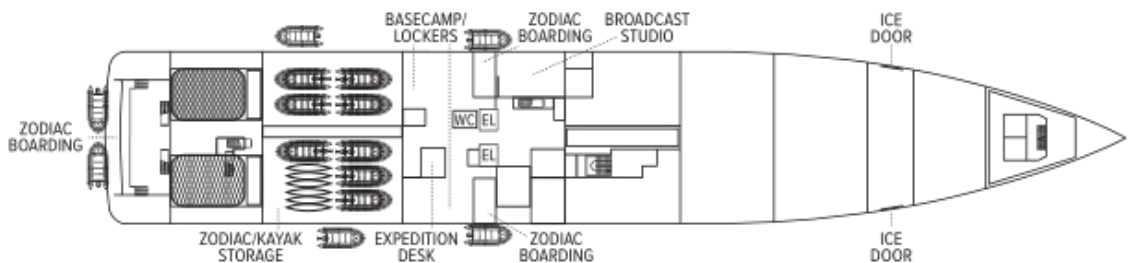

Ship amenities

Public Areas

Reception; three dining areas; an observation lounge with bar, gym, wellness area, infinity-style outdoor hot tubs with adjacent igloos; library; main lounge with full service bar, 24-hour beverage station, state-of-the-art tech for films/presentations; B&H Photo locker and a photo workshop area; science hub; an onboard broadcast studio; an expedition base with lockers for expedition gear; and open access to the Bridge, Captain, officers and on-duty wildlife spotters.

Meals

Restaurant 270° features wrap-around views; two other dining areas offer lighter, made-to-order fare or intimate, small group dinners. All feature sustainable choices, local where possible, and unassigned, flexible, inclusive seating.

Cabins

All cabins face outside with large windows, private bathroom, and climate controls. Cabins are equipped with expedition command centers with iPad tablets, multiple electrical and USB outlets, TVs, with on demand entertainment, phone, Wi-Fi, clock, barometers, hygrometers, vanity mirror, mini refrigerator, small safe, ice bucket, glasses, hair dryer, reading lights and National Geographic Atlas. Luxury linens and pillows. Bathrooms outfitted with Rain showers & hand held shower, botanically inspired shampoo, conditioner, shower gel and lotion. Complimentary insulated water bottles. Balcony cabins have hammocks, chairs and table.

Expedition Equipment

Zodiac landing craft, kayaks, snowshoes, cross-country skis, an ROV and underwater video camera for unique access to the polar undersea, hydrophone, aerial remote-controlled camera and video microscope.

Special Features

A full-time doctor, undersea specialist, National Geographic photographer, Lindblad-National Geographic certified photo instructor and video chronicler, an internet cafe and laundry. A forward and aft staircase, and elevators, reach all decks. Echoing the pioneering installation aboard *National Geographic Endurance*, artist Zaria Forman has curated a new exhibit, featuring a wide range of artists.



Wellness

A glass-enclosed yoga studio, gym, treatment rooms and spa relax area, and high and low-heat saunas with ocean views, staffed by wellness specialists.

Self-Disinfecting Ships

ACT Clean Coat™ is a light-activated, self-disinfecting cleaning process that continuously breaks down viruses, bacteria, mold, and airborne allergens across all ship surfaces. Not only does this create a cleaner, healthier shipboard environment for guests and crew alike, but this non-toxic, chemical-free system also saves more than one million gallons of water each year in our cleaning procedures, and reduces our carbon footprint as well as the amount of plastic and waste in our supply chain.

Special Offers

10% OFF BACK-TO-BACK VOYAGES

Save 10% on consecutive departures, applicable on voyage fares only and not valid on extensions or airfare. Valid for new bookings only, subject to availability, and may not be combined with other offers. Call for details.

be removed upon cancellation of party members if group drops below 4. Additional restrictions may apply. Savings offer valid on new bookings only, subject to availability, and offer may be withdrawn at any time without prior notice, not applicable on airfare or extensions, and may not be combined with other promotions. Call to book or for additional details.

COMBINING OFFERS

Certain offers may be combinable, up to two savings opportunities, except where noted otherwise.

For example, travel with a group of 8 or more on back-to-back expeditions, and take advantage of both savings.

CELEBRATE LIFE'S MILESTONES

Celebrate a milestone with a group of eight or more and enjoy a special amenity package including: 5% savings on voyage fares, custom group photo, US\$150 shipboard credit for the group, and other special gifts. Milestone celebration to be communicated at time of booking.

SAVE 10% WHEN YOU SAIL WITH A GROUP OF FOUR OR MORE

Book from April 14 to May 6, 2026: Receive savings of 10% deducted from cabin fare when you book a party of 4 or more on voyages departing on or after April 14, 2026, through 2028. To qualify for the offer, parties must be 4 or more across a minimum of 2 cabins. Applicable savings will be deducted from cabin fare after any additional savings with the purchase of cabin fare. Discount is subject to

TRAVEL PROTECTION PLAN

We strongly recommend our guests to take advantage of our Travel Protection Plan. This plan offers comprehensive coverage to protect you from cancellation fees, costs incurred due to trip delays/interruption, damage or loss of baggage, medical assistance, and evacuation during your travels. Our Travel Protection Plan is available for U.S. residents only, and may be purchased any time prior to final payment due date, Travel Protection premiums are non-refundable once plan is purchased. Learn more about our Travel Protection "Plus" Plan: <https://www.expeditions.com/terms-conditions/travel-protection-plan/>

CANCELLATION POLICY

Review our cancellation policy: <https://www.expeditions.com/cancellation-policy/>