









# Exploring Alaska, Great Bear Rainforest and the San Juan Islands

Embark on an extraordinary 14-day journey through some of the Pacific Northwest’s most pristine wilderness, from Alaska’s dramatic fjords to the ancient forests of the Great Bear Rainforest. This comprehensive expedition combines the best of three iconic regions: Southeast Alaska’s wildlife-rich waters, British Columbia’s protected coastal wilderness and Washington’s enchanting San Juan Islands. With special access to remote areas managed by First Nations peoples, explore pristine fjords and moss-draped forests where you may encounter the elusive spirit bear—found nowhere else on Earth.

From  
**\$7,800** / per person  
 Does not include flights

 <b>DATES</b> Sep	 <b>DURATION</b> 14 Days
 <b>SHIPS</b> <i>National Geographic Venture</i>	
 <b>STARTS AT</b> Juneau, Alaska	  <b>ENDS AT</b> Seattle, Washington

## Highlights

- ★ Take kayaks and Zodiacs deep into verdant fjords and wildlife-rich shores in search of bears, golden eagles, river otters and more
- ★ Journey into the most pristine forests in the region, inaccessible by road and managed by First Nations people
- ★ Immerse yourself in First Nations culture at Alert Bay's Big House, where the Kwakwaka'wakw people share their traditional art, music and regional knowledge
- ★ Cruise the eastern coast of Princess Royal Island in search of the elusive spirit bear, a rare but thrilling sighting





## Day by day

### ■ DAY 1

#### Juneau, Alaska / Embark Ship

Arrive in Juneau, Alaska's capital city, in the early afternoon and embark the ship in time for cocktails and an introduction of the vessel staff and crew.

Meals included: dinner

### ◇ DAY 2

#### Endicott Arm

Voyage into Endicott Arm, a spectacular fjord with waterfalls cascading from glacially carved walls. See the soaring Dawes Glacier up close and take a cruise in a Zodiac for an unbeatable view among sculpted icebergs. Keep an eye out for harbor seals, harbor porpoises and arctic terns.

Meals included: breakfast, lunch, dinner

### ◇ DAYS 3-4

#### Exploring Southeast Alaska

Spend two days exploring the wild gems of southeast Alaska, in the northern part of the Alexander Archipelago. With nature as your guide, you will cruise Chatham Strait in search of orca and humpback whales and experience wild Alaska up close on Zodiacs, kayaks, paddleboards and hikes.

*Explore the wild and remote areas of southeast Alaska by special use permit with the Tongass National Forest.*

Meals included: breakfast, lunch, dinner

### ◇ DAY 5

#### Prince Rupert, British Columbia, Canada

Wake up in Prince Rupert, a scenic harbor town

on British Columbia's rugged northwest coast. Get immersed in First Nations history at the Museum of Northern British Columbia, built in the style of a coastal longhouse. Breathe in the scent of cedar beams and peruse an impressive collection of ornate carvings, weavings, ceremonial objects and regalia. Visit the North Pacific Cannery Museum, a collection of cannery buildings located in pristine wilderness surroundings that highlight British Columbia's economic, cultural and natural development over the last century.

Meals included: breakfast, lunch, dinner

### ◇ DAY 6

#### Lowe Inlet Marine Provincial Park / Cruising

Seek out pods of killer whales and foraging bears as you sail north through the narrow Grenville Channel between Pitt Island and the mainland, a dramatic navigational experience. Not only does the channel narrow to less than a quarter of a mile across, but a slight bend in the passage makes the waterway seem to disappear into the hills ahead and behind the ship. Here, you'll explore the salmon run at Verney Falls in Lowe Inlet Marine Provincial Park by Zodiacs.

Meals included: breakfast, lunch, dinner

### ◇ DAYS 7-10

#### Exploring Great Bear Rainforest and Rugged Coastline of British Columbia

Over the course of the next four days, you will cruise far into the fjords and deep valleys that carve into the Coast Range looking for black and grizzly bears. You will cruise the eastern coast of Princess Royal Island in search of the elusive spirit bear. It is believed that between 10 to 20 percent

of bears in this region are born with the recessive gene that causes the white fur; fewer than 400 are estimated to exist.

British Columbia has one of the highest proportions of protected land of any jurisdiction in the world. Almost 15 percent of the land is protected, with a wide range of provincial parks, national parks and UNESCO World Heritage Sites. Alongside your veteran expedition team, go ashore and explore several remote locations where few people venture. Discover hidden gems by Zodiac and kayak, navigating the tidal narrows that lead to the backs of bays while scanning for bears along the rocky shoreline and meadows such as Gilttoeyes Inlet.

Meals included: breakfast, lunch, dinner

◇ DAY 11

### Alert Bay and Johnstone Strait, British Columbia

Visit the Big House in the First Nations village of Alert Bay, Canada and gain insight from the Kwakwaka'wakw people who will share their art, music and regional knowledge. Sail through Johnstone Strait, a waterway cut through a magnificently wild and scenic area of mountains and islands. These ocean waters are also home to extraordinary marine mammals and bird watching.

Meals included: breakfast, lunch, dinner

◇ DAY 12

### Southern British Columbia

Discover British Columbia's Sunshine Coast, a mecca for kayakers and small yachts. Anchor in calm, sheltered waters to kayak in isolated bays that beckon for exploration. On land, hike through meadows and forest ecosystems.

Meals included: breakfast, lunch, dinner

◇ DAY 13

### San Juan Islands, Washington, U.S.A.

Discover the wild charm of the San Juan Islands, a captivating archipelago in northern Washington State. Paddle hidden coves by kayak, keeping an eye out for friendly harbor seals. Navigate dramatic shorelines aboard Zodiacs. Hike along rugged coastal trails where bald eagles soar overhead, while expert naturalists provide insight on the fascinating ecology and cultural history of this distinctive northwest wilderness.

Meals included: breakfast, lunch, dinner

■ DAY 14

### Seattle / Disembark Ship

Disembark in Seattle and transfer to the airport for flights home.

**Departure Time:** Depart after 10:30 a.m. local time.

**Departure City:** Seattle, Washington

Meals included: breakfast

## Expedition

Juneau, Alaska → Seattle, Washington

### 2026 DEPARTURE DATES

Aboard *National Geographic Venture*

20 Sep				
--------	--	--	--	--

### 2027 DEPARTURE DATES

Aboard *National Geographic Venture*

26 Sep				
--------	--	--	--	--



## National Geographic Venture

GUESTS

100

CABINS

50

**The *National Geographic Venture* is a state-of-the-art expedition ship ideal for discovering remote locations in domestic waters.**

Following the build of *National Geographic Quest* at Nichols Brothers shipyard, her sister ship, *National Geographic Venture*, floated into the bay on Whidbey Island, Washington, becoming the 4th ship in the Lindblad fleet built at this storied shipyard. In the 1970s, Nichols Brothers built the twin ships *National Geographic Sea Bird* and *National Geographic Sea Lion*, which continue to sail the waters of the west coast of North America and Central America.

*National Geographic Venture*, like much of the wildlife she follows, is migratory. She follows the seasons from Alaska, along the coast of British Columbia, up the Columbia and Snake Rivers and along the Baja California coast. In each region, her design innovations were informed by 50+ years of expedition expertise to ensure extraordinary discoveries. *National Geographic Venture's* shallow draft enables her to provide intimate 'insider' experiences of the charismatic regions we explore.

Like her sister ship *National Geographic Quest*, *National Geographic Venture* has dual boarding platforms. Enabling our team to load two Zodiacs at once means guests get off ship quickly to take advantage of wildlife sightings and maximize exploring time. Modern and clean-lined, with large expanses of glass to keep you connected to the extraordinary views, *National Geographic Venture* enables you to see, do and experience the best of her geographies.



# Cabin Categories

## Category 1

MAIN DECK #301-306

Cabins feature two single beds that can convert to a Queen, a writing desk, two nightstands and two portholes, full length mirror, and reading lights.



## Category 2

MAIN DECK #307-315

Cabins feature two single beds that can convert to a Queen, a writing desk, two nightstands and two portholes, full length mirror, and reading lights.



## Category 3

UPPER DECK #201-206

Cabins feature two single beds that can convert to a Queen, a writing desk, two nightstands, a large view window, full-length mirror, and reading lights.



## Category 4

UPPER DECK #207-229

Cabins feature two single beds that can convert to a Queen, a writing desk, closet, two nightstands, full-length mirror, reading lights, sliding glass door, and a small, private balcony.



### Note:

Solo occupancy cabins are available in Categories 1 and 2 only. Third person rates are available in Category 5 cabins at one half the double occupancy rate.

### Connecting Cabins via internal doorway access:

Main Deck: #312-314, #311-315, #306-307;  
Upper Deck: #224-226, #225-227

## Category 5

### OBSERVATION DECK #101-108 (SUITE)

Cabins feature two single beds that can convert to a Queen, large view windows, closet, two nightstands, full-length mirror, reading lights, a suite-sized expanded bathroom, writing desk, ample storage space, and a convertible sofa bed to accommodate a third person.



# Deck Plans

## Observation Deck

Category 5

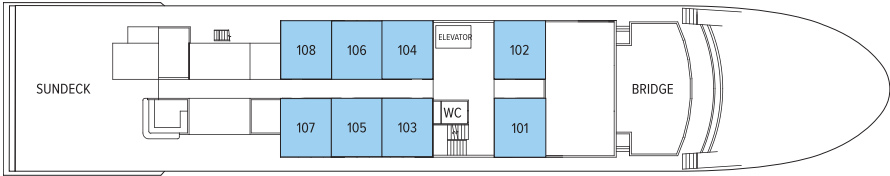

## Lounge Deck

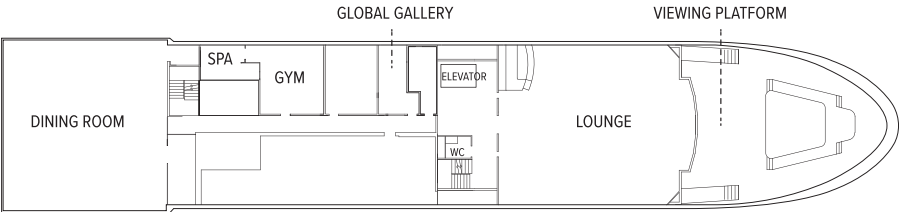

## Upper Deck

Category 3

Category 4

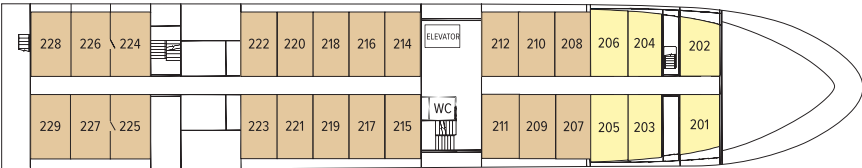

## Main Deck

Category 1

Category 2

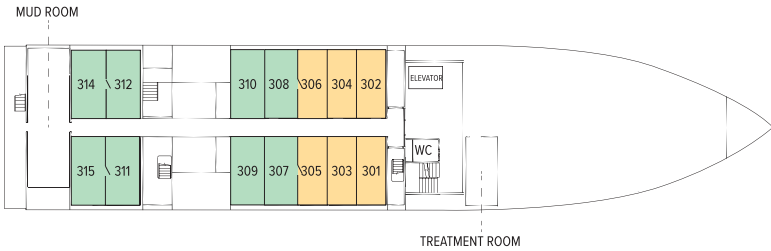

# Ship Amenities

## Public Areas

Reception; main dining area; global gallery; fitness center; lounge with full-service bar and state-of-the-art presentation facilities; observation deck; mudroom with lockers for expedition gear; partially-covered furnished sundeck; plus open access to the Bridge, the Captain, officers and on-duty wildlife spotters.

## Meals

Meals are served in the dining room at a single seating with unassigned tables for an informal atmosphere and easy mingling. Menus feature sustainable choices, local where possible.

## Cabins

50 outside cabins. All cabins face outside with windows, private bathroom, and climate controls. Cabins are equipped with Wi-Fi, phone, multiple electrical and USB outlets, and phones. Luxury linens and pillows. Botanically inspired shampoo, conditioner, shower gel, and lotion are all available in cabin bathrooms, as well as an Expedition Essential Kit. Hair dryers, complimentary insulated water bottles and a National Geographic Atlas are also available in each cabin.

## Expedition Equipment

A fleet of 8 Zodiacs, 24 kayaks, paddleboards; an ROV, hydrophone, splash-cam, underwater video camera, video microscope; snorkeling gear and wet suits for all guests (where applicable).

## Special Features

Internet access. Elevator. The design of the outside decks—with the perfect wildlife viewing platform. The proximity of the Lounge to the deck gives you instant access to spontaneous sightings. Have your camera ready!



## Wellness

A fitness center with elliptical, treadmill, weights and resistance bands; LEXspa treatment room, staffed by wellness specialists.

## Self-Disinfecting Ships

ACT Clean Coat™ is a light-activated, self-disinfecting cleaning process that continuously breaks down viruses, bacteria, mold, and airborne allergens across all ship surfaces. Not only does this create a cleaner, healthier shipboard environment for guests and crew alike, but this non-toxic, chemical-free system also saves more than one million gallons of water each year in our cleaning procedures, and reduces our carbon footprint as well as the amount of plastic and waste in our supply chain.

## Special Offers

### 50% REDUCED DEPOSIT

Book between June 10 and August 18, 2026 and receive 50% off deposit at the time of booking on voyages departing October 1, 2026 through December 31, 2027 if booked outside of final payment. Remaining deposit balance is due at the time of final payment. Standard cancellation policy applies. Additional restrictions may apply. Offer valid for new bookings, subject to availability and offer may be withdrawn at any time without prior notice, not applicable on airfare or extensions, and may not be combined with other offers. Call for details.

### 10% OFF BACK-TO-BACK VOYAGES

Save 10% on consecutive departures, applicable on voyage fares only and not valid on extensions or airfare. Valid for new bookings only, subject to availability, and may not be combined with other offers. Call for details.

### CELEBRATE LIFE'S MILESTONES

Celebrate a milestone with a group of eight or more and enjoy a special amenity package including: 5% savings on voyage fares, custom group photo, US\$150 shipboard credit for the group, and other special gifts. Milestone celebration to be communicated at time of booking.

### SAVE 5% TRAVELING AS A GROUP

Save 5% when traveling as a group of 8 or more people. Valid for new bookings only on select departures, subject to availability, not applicable

on extensions, and may not be combined with other offers. Call for details.

### PAY BY DEBIT: EARN A \$100 ONBOARD CREDIT

The \$100 onboard credit offer is applied after the final payment and requires 85% of the cost of the voyage to be placed on a debit card. Maximum of one \$100 onboard credit per cabin. The \$100 onboard credit is a non-refundable, non-transferable credit that can be used for various onboard purchases such as global gallery and spa treatments. It has no cash value, cannot be refunded if not fully utilized, and will be forfeited if not fully redeemed by the end of the voyage. This offer is combinable with other offers. If the booking is altered or canceled, the onboard credit may be forfeited, and it cannot be transferred if the booking is moved to another guest. Lindblad Expeditions reserves the right to modify or cancel the offer without prior notice. Offer applies to Lindblad Expeditions' owned ships only. Offer valid only for Debit Cards issued in the United States for payments made from the United States.

### COMBINING OFFERS

Certain offers may be combinable, up to two savings opportunities, except where noted otherwise. For example, travel with a group of 8 or more on back-to-back expeditions, and take advantage of both savings.

## INCLUDED IN PRICE

All accommodations aboard ship or in hotels per itinerary; all meals as indicated in the itinerary, both aboard and onshore; beer, wine, cocktails, and spirits (premium brands available for purchase) aboard; excursions and airport transfers to and from flights arriving and departing within recommended window, as indicated in the itinerary; exploration tools such as Zodiacs, kayaks, stand-up paddleboards (where applicable); guidance and company of leading expedition staff; presentations by expedition staff and expert guest speakers; complimentary reusable water bottle; onboard physician consultations (where available); 24-hour access to exercise equipment (where applicable); 24-hour access to lounges, observation decks, library, and other shared spaces; basic Wi-Fi (where applicable); park and site entrance fees, special access permits, and port taxes. Unused services or items included in our programs are non-refundable.

## NOT INCLUDED IN PRICE

Airfare (except flights when indicated as included and/or as required); charter airfare (where applicable, except when indicated as included and/or as required); pre- and post-expedition extensions (except flights when indicated as included); additional hotel nights; premium cocktails and spirits; private transfers (except when indicated as included); crew gratuities; additional costs associated with medical services outside onboard physician consultation (where applicable); enhanced and premium Wi-Fi plans aboard expedition fleet; laundry, spa treatments, and phone services; travel protection plans; passport, visa and immigration fees. For select voyages, completing a medical evaluation form with VIKAND is required. If you utilize your physician, VIKAND's processing fee for your documentation

will be added to your National Geographic-Lindblad Expeditions invoice. If you utilize VIKAND's physicians, an additional charge will be due and payable directly to VIKAND.

## TRAVEL PROTECTION PLAN

We strongly recommend our guests to take advantage of our Travel Protection Plan. This plan offers comprehensive coverage to protect you from cancellation fees, costs incurred due to trip delays/interruption, damage or loss of baggage, medical assistance, and evacuation during your travels. Our Travel Protection Plan is available for U.S. residents only, and may be purchased any time prior to final payment due date, Travel Protection premiums are non-refundable once plan is purchased. Learn more about our Travel Protection "Plus" Plan: <https://www.expeditions.com/terms-conditions/travel-protection-plan/>

## CANCELLATION POLICY

Review our cancellation policy: <https://www.expeditions.com/cancellation-policy/>