









 Baja California, California Coast & North America
 27° 51' N 115° 10' W

Channel Islands National Park to Baja California

Migrate alongside humpback whales and numerous seabird species on a unique early-winter journey from Los Angeles to Loreto. Explore the Channel Islands' intact wildness, thriving with endemic species. Sail to Ensenada and discover Mexico's Wine Country—the Valle de Guadalupe. Spot a variety of species among the 25,000 birds migrating along the Pacific Flyway. Continue down the pristine coastline of Baja California, home to a panoply of sea life, untamed desert wilderness, and otherworldly sunsets.

From
\$ 7,097 / per person
 Does not include flights

 DATES Nov	 DURATION 13 Days
 SHIPS <i>National Geographic Venture</i>	
 STARTS AT Los Angeles, California	  ENDS AT Loreto, Mexico

Highlights

- ★ Follow the migration of birds and humpback whales on an epic journey from Los Angeles to the Gulf of California
- ★ Discover one of the nation's best-kept secrets, Channel Islands National Park
- ★ Go behind the scenes and enjoy a private lunch at a boutique vineyard in the world-renowned Valle de Guadalupe
- ★ Explore Islas de San Benito, home to thousands of breeding elephant seals





Day by day

■ DAY 1

Los Angeles, California, U.S. / Embark Ship

Arrive in Los Angeles by early afternoon. Transfer to the port to embark the *National Geographic Venture*.

Arrival Time: Arrive before 3:00 p.m. local time.

Arrival City: Los Angeles, California

Meals included: dinner

◇ DAY 2

Channel Islands National Park

Not far from the city lights, these islands are a world away, home to incredibly diverse and endemic flora and fauna. Spend the day kayaking, hiking one of the many trails or simply relaxing ashore. Learn the fascinating prehistory of these islands from your naturalists.

Meals included: breakfast, lunch, dinner

◇ DAY 3

Ensenada, Mexico / Valle de Guadalupe

Vineyards and culinary marvels await in one of the world's hottest up-and-coming wine regions. Arise to a gorgeous sunrise and enjoy breakfast before pulling into Ensenada. Discover what the hype is all about on a visit to a sustainable, family-run vineyard with stunning views. Meet the winemaker and owner on a behind-the-scenes tour and tasting. Enjoy a multi-course paired meal and a very special music performance.

Meals included: breakfast, lunch, dinner

◇ DAY 4

Isla San Martín

Wake up to a view of the double-coned peak of Isla San Martín, a mile-wide volcanic island flanked by a giant kelp forest. Explore the lush kelp forest by kayaks, paddleboards or Zodiac and observe the antics of abundant harbor seals. Adventurous hikers can explore the volcanic rock to reach the summits of both volcanos 470 feet above the surf. Or opt to walk along the seashore, strewn with bulbous tubes of the rare *Pelagophycus* elk kelp. As a nightcap this evening, enjoy video of the kelp forests captured by your undersea specialist.

Meals included: breakfast, lunch, dinner

◇ DAYS 5-6

Isla San Benito Oeste / At Sea

Continue on your southern journey with a stop at the secluded Isla San Benito Oeste, home to thousands of breeding elephant seals. Zodiac to shore at the base of a small fishing village. Opt for a long hike to the peak of the island or explore the village and observe the elephant seal haul out, including many moms and pups. All four of Mexico's pinniped species can be found in this area, and we'll seek them out on Zodiacs. Scan the skies for a variety of bird species including blue herons, black turnstones and two species of cormorants. Enjoy a well-timed day to relax on board with stretch classes, talks and whale-watching as you make your way south to Magdalena Bay.

Meals included: breakfast, lunch, dinner

◇ DAY 7

Bahía Magdalena

Isla Magdalena and the bay of the same name are irresistible treats for the nature lover. Come

to know this island while hiking the ever-shifting, wind-sculpted dunes on a cross-island transit to Sand Dollar Beach. Watch for coyote tracks in the soft dunes and spot migratory shorebirds. Many—including western sandpipers, whimbrels, willets, Wilson’s and black-bellied plovers, and marbled godwits—are concluding their southbound journeys here. Observe astounding flora, like the endemic and sideways-growing creeping devil, a columnar cactus thick with spines packed together to protect against herbivores and the relentless sun. This evening, as you exit the bay, be on the lookout for beaked dolphins and bald eagles.

Meals included: breakfast, lunch, dinner

◇ DAY 8

San José del Cabo / Gordo Banks

Cruise past Friars Rocks and visit the historic town center of San José del Cabo before cruising Gordo Banks seamount or La Fortuna, renowned gathering places for whales, dolphins, and other marine life.

Meals included: breakfast, lunch, dinner

◇ DAYS 9-12

Cabo Pulmo / Los Islotes / Gulf of California

Venture south to discover the gems of the southern Gulf. These islands and surrounding waters are celebrated for their conservation stories, marine life, and the many thrilling experiences on offer. Some of the locations you may visit or enjoy by Zodiac include:

Cabo Pulmo National Marine Park

Set out to snorkel the pristine reefs of Cabo Pulmo National Marine Park, one of the most successful national marine parks in the world. Chat with locals about their advocacy to protect this unique place, including a cessation of fishing to protect the reef.

Isla Espíritu Santo

A national park as well as UNESCO World Heritage site with volcanic rock formations, scenic beaches, and coral reefs. This magical island offers excellent hiking opportunities and crystal-clear waters for snorkeling. It’s a popular destination for researchers monitoring sea turtles.

Los Islotes

Located at the northern tip of the UNESCO Biosphere Reserve, Los Islotes is largely inaccessible to people and home to a large colony of sea lions. Conditions permitting, anchor off the rocky island where you’ll don flippers, a mask and snorkel (which are provided) and swim with these curious inhabitants.

Isla San José

One of the larger islands in the Gulf of California, San José offers several landing possibilities depending on conditions and the whim of the moment. Photograph the ochre cliffs of the island’s eastern shore, hike an enchanted, cactus-laden arroyo, or visit the abandoned salt works to the west. Discover rare wildlife among desert islands.

Meals included: breakfast, lunch, dinner

■ DAY 13

Loreto / Disembark Ship

After breakfast, disembark the ship and transfer to the Loreto International Airport for flights home.

Departure Time: Depart after 1:00 p.m. local time.

Departure City: Loreto, Mexico

Meals included: breakfast

Expedition

Los Angeles, California → Loreto, Mexico

2026 DEPARTURE DATES

Aboard *National Geographic Venture*

22 Nov				
--------	--	--	--	--

2027 DEPARTURE DATES

Aboard *National Geographic Venture*

13 Nov				
--------	--	--	--	--



National Geographic Venture

GUESTS

100

CABINS

50

The *National Geographic Venture* is a state-of-the-art expedition ship ideal for discovering remote locations in domestic waters.

Following the build of *National Geographic Quest* at Nichols Brothers shipyard, her sister ship, *National Geographic Venture*, floated into the bay on Whidbey Island, Washington, becoming the 4th ship in the Lindblad fleet built at this storied shipyard. In the 1970s, Nichols Brothers built the twin ships *National Geographic Sea Bird* and *National Geographic Sea Lion*, which continue to sail the waters of the west coast of North America and Central America.

National Geographic Venture, like much of the wildlife she follows, is migratory. She follows the seasons from Alaska, along the coast of British Columbia, up the Columbia and Snake Rivers and along the Baja California coast. In each region, her design innovations were informed by 50+ years of expedition expertise to ensure extraordinary discoveries. *National Geographic Venture's* shallow draft enables her to provide intimate 'insider' experiences of the charismatic regions we explore.

Like her sister ship *National Geographic Quest*, *National Geographic Venture* has dual boarding platforms. Enabling our team to load two Zodiacs at once means guests get off ship quickly to take advantage of wildlife sightings and maximize exploring time. Modern and clean-lined, with large expanses of glass to keep you connected to the extraordinary views, *National Geographic Venture* enables you to see, do and experience the best of her geographies.



Cabin Categories

Category 1

MAIN DECK #301-306

Cabins feature two single beds that can convert to a Queen, a writing desk, two nightstands and two portholes, full length mirror, and reading lights.



Category 2

MAIN DECK #307-315

Cabins feature two single beds that can convert to a Queen, a writing desk, two nightstands and two portholes, full length mirror, and reading lights.



Category 3

UPPER DECK #201-206

Cabins feature two single beds that can convert to a Queen, a writing desk, two nightstands, a large view window, full-length mirror, and reading lights.



Category 4

UPPER DECK #207-229

Cabins feature two single beds that can convert to a Queen, a writing desk, closet, two nightstands, full-length mirror, reading lights, sliding glass door, and a small, private balcony.



Note:

Solo occupancy cabins are available in Categories 1 and 2 only. Third person rates are available in Category 5 cabins at one half the double occupancy rate.

Connecting Cabins via internal doorway access:

Main Deck: #312-314, #311-315, #306-307;
Upper Deck: #224-226, #225-227

Category 5

OBSERVATION DECK #101-108 (SUITE)

Cabins feature two single beds that can convert to a Queen, large view windows, closet, two nightstands, full-length mirror, reading lights, a suite-sized expanded bathroom, writing desk, ample storage space, and a convertible sofa bed to accommodate a third person.



Deck Plans

Observation Deck

Category 5

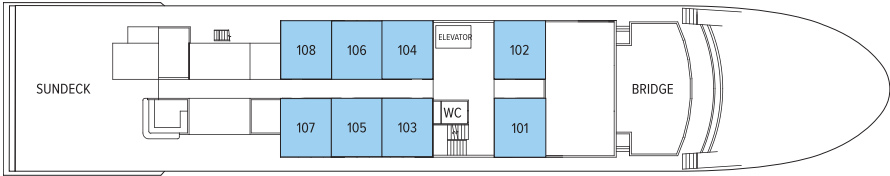

Lounge Deck

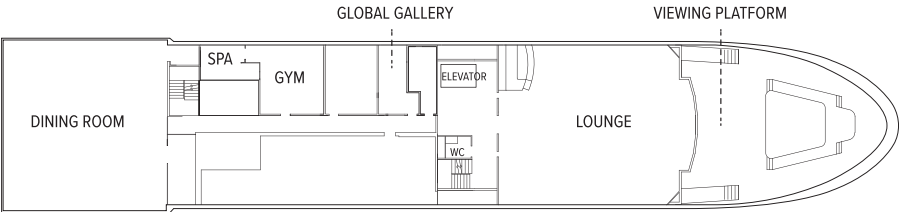

Upper Deck

Category 3

Category 4

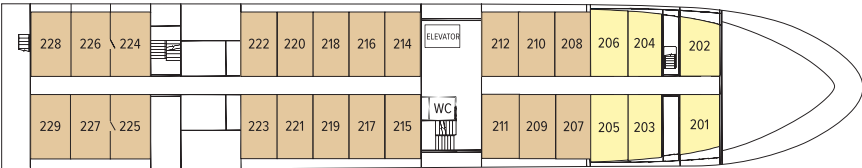

Main Deck

Category 1

Category 2

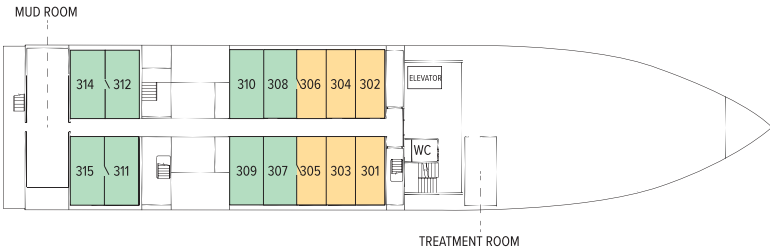

Ship Amenities

Public Areas

Reception; main dining area; global gallery; fitness center; lounge with full-service bar and state-of-the-art presentation facilities; observation deck; mudroom with lockers for expedition gear; partially-covered furnished sundeck; plus open access to the Bridge, the Captain, officers and on-duty wildlife spotters.

Meals

Meals are served in the dining room at a single seating with unassigned tables for an informal atmosphere and easy mingling. Menus feature sustainable choices, local where possible.

Cabins

50 outside cabins. All cabins face outside with windows, private bathroom, and climate controls. Cabins are equipped with Wi-Fi, phone, multiple electrical and USB outlets, and phones. Luxury linens and pillows. Botanically inspired shampoo, conditioner, shower gel, and lotion are all available in cabin bathrooms, as well as an Expedition Essential Kit. Hair dryers, complimentary insulated water bottles and a National Geographic Atlas are also available in each cabin.

Expedition Equipment

A fleet of 8 Zodiacs, 24 kayaks, paddleboards; an ROV, hydrophone, splash-cam, underwater video camera, video microscope; snorkeling gear and wet suits for all guests (where applicable).

Special Features

Internet access. Elevator. The design of the outside decks—with the perfect wildlife viewing platform. The proximity of the Lounge to the deck gives you instant access to spontaneous sightings. Have your camera ready!



Wellness

A fitness center with elliptical, treadmill, weights and resistance bands; LEXspa treatment room, staffed by wellness specialists.

Self-Disinfecting Ships

ACT Clean Coat™ is a light-activated, self-disinfecting cleaning process that continuously breaks down viruses, bacteria, mold, and airborne allergens across all ship surfaces. Not only does this create a cleaner, healthier shipboard environment for guests and crew alike, but this non-toxic, chemical-free system also saves more than one million gallons of water each year in our cleaning procedures, and reduces our carbon footprint as well as the amount of plastic and waste in our supply chain.

Special Offers

SAY YES—TO GOING WITHOUT SECOND THOUGHTS

Receive savings of \$1500 per guest deducted from cabin fare on select 2026 voyages when you pay in full at time of booking. Applicable savings will be deducted from cabin fare before any additional savings with the purchase of cabin fare. To qualify for the savings, nonrefundable payment in full is due at time of booking. This promotional offer is subject to separate terms and conditions. Standard cancellation, refund, and change policies do not apply. All amounts paid in connection with this promotion are non-refundable and non-transferable, regardless of cancellation date, and no refund, credit, or compensation will be provided except as expressly stated herein. Promotional offer valid on new bookings only for select 2026 departures, subject to availability and offer may be withdrawn at any time without prior notice, not applicable on airfare or extensions, and may not be combined with other promotions. Additional restrictions may apply.

SUITE EXCLUSIVES

Spacious living areas and incredible views immerse you in the beauty of your marine surroundings. Our new Suite Exclusives package helps make your voyage all the more memorable. [Learn more](#)

CELEBRATE LIFE'S MILESTONES

Celebrate a milestone with a group of eight or more and enjoy a special amenity package including: 5% savings on voyage fares, custom group photo, US\$150 shipboard credit for the group, and other special

gifts. Milestone celebration to be communicated at time of booking.

SAVE 5% TRAVELING AS A GROUP

Save 5% when traveling as a group of 8 or more people. Valid for new bookings only on select departures, subject to availability, not applicable on extensions, and may not be combined with other offers. Call for details.

PAY BY DEBIT: EARN A \$100 ONBOARD CREDIT

The \$100 onboard credit offer is applied after the final payment and requires 85% of the cost of the voyage to be placed on a debit card. Maximum of one \$100 onboard credit per cabin. The \$100 onboard credit is a non-refundable, non-transferable credit that can be used for various onboard purchases such as global gallery and spa treatments. It has no cash value, cannot be refunded if not fully utilized, and will be forfeited if not fully redeemed by the end of the voyage. This offer is combinable with other offers. If the booking is altered or canceled, the onboard credit may be forfeited, and it cannot be transferred if the booking is moved to another guest. Lindblad Expeditions reserves the right to modify or cancel the offer without prior notice. Offer applies to Lindblad Expeditions' owned ships only. Offer valid only for Debit Cards issued in the United States for payments made from the United States.

COMBINING OFFERS

Certain offers may be combinable, up to two savings opportunities, except where noted otherwise.

For example, travel with a group of 8 or more on
back-to-back expeditions, and take advantage of
both savings.

INCLUDED IN PRICE

All accommodations aboard ship or in hotels per itinerary; all meals as indicated in the itinerary, both aboard and onshore; beer, wine, cocktails, liquors and spirits aboard the ship (except certain premium brands which are available for purchase); hors d'oeuvres, 24-hour access to snacks, premium coffees and teas, non-alcoholic beverages, and filtered water; excursions and airport transfers to and from recommended flights, as indicated in the itinerary; exploration tools curated to destination, such as Zodiacs, stand-up paddleboards, kayaks, snorkeling equipment (including wetsuits, masks, and fins); guidance and company of our leading expedition staff; assistance by the Lindblad Expeditions-National Geographic certified photo instructor; access to the OM System Photo Gear Locker; presentations by expedition staff and expert guest speakers; complimentary reusable water bottle; onboard physician consultations; morning stretch classes and 24-hour access to exercise equipment; 24-hour access to lounges, observation decks, library, and other shared spaces; basic WiFi, park and site entrance fees, special access permits, and port taxes. Unused services or items included in our programs are non-refundable.

NOT INCLUDED IN PRICE

Airfare (except flights* when indicated as included); pre- and post-expedition extensions; additional hotel nights (except when indicated as included); crew gratuities; private transfers; laundry, spa treatments, travel protection plans; and passport, visa, and immigration fees.

*Recommended flight costs include flight(s) that take place during the date range of your trip to transport travelers from one itinerary destination to another. This

cost also includes ground transportation, luggage transfer, and airport assistance. If you prefer to arrange your own flights privately, have alternate means of transport, or wish to modify at a later time, please contact an Expedition Specialist at 1.833.400.0831

Additional costs associated with medical services outside onboard physician consultation.

TRAVEL PROTECTION PLAN

We strongly recommend our guests to take advantage of our Travel Protection Plan. This plan offers comprehensive coverage to protect you from cancellation fees, costs incurred due to trip delays/interruption, damage or loss of baggage, medical assistance, and evacuation during your travels. Our Travel Protection Plan is available for U.S. residents only, and may be purchased any time prior to final payment due date, Travel Protection premiums are non-refundable once plan is purchased. Learn more about our Travel Protection "Plus" Plan: <https://www.expeditions.com/terms-conditions/travel-protection-plan/>

CANCELLATION POLICY

Review our cancellation policy: <https://www.expeditions.com/cancellation-policy/>