

Baja California, North America &  
25° 3' N 118° 24' W

## Baja California Discovery: Exploring Mexico's Gulf of California

Journey deep into the Gulf of California to discover its hidden treasures. This encompassing expedition is the result of years of careful exploration by our veteran naturalists and features the best destinations this rich sea has to offer. It truly captures the exploratory spirit of our earliest days on the peninsula, more than 40 years ago, when Sven Lindblad first introduced intrepid travelers to its wild waters and desert shores.

From

**\$ 8,100** / per person  
Does not include flights



### DATES

Mar and Apr



### DURATION

11 Days



### SHIPS

*National Geographic Venture*



### STARTS AT

La Paz,  
Mexico



### ENDS AT

Loreto,  
Mexico

## Highlights

- ★ Immerse yourself in striking desert landscapes, pristine coastal waters, and extraordinary biodiversity
- ★ Embark on regular marine safaris in search of dolphins, sea lions, up to six species of whales, and—if we're lucky—whale sharks
- ★ Explore the lesser-visited Midriff Islands including Isla Rasa, where half a million nesting sea birds occupy a 150-acre island
- ★ Visit multiple UNESCO World Heritage sites and snorkel in the crystalline waters of protected marine reserves





## Day by day

### ■ DAY 1

#### San José del Cabo / La Paz / Embark Ship

Arrive in San José del Cabo, where the Gulf of California meets the Pacific Ocean, by early afternoon. Transfer to La Paz and embark the *National Geographic Venture* in the evening in time for cocktails and staff introductions. You may opt for a [pre-voyage extension exploring culture and cuisine](#) in La Paz, Todos Santos and San José del Cabo.

**Arrival Time:** Arrive before 1:30 p.m. local time.

**Arrival City:** San José del Cabo, Mexico

**Meals included:** dinner

### ◇ DAYS 2-4

#### Exploring Southern Gulf Islands

We begin our journey among the natural beauty of the southern Gulf of California. These islands and surrounding waters are celebrated for their conservation stories, marine life and the many thrilling experiences on offer. Our plan is flexible in order to maximize our chances for amazing encounters. Some of the locations we may visit or enjoy by Zodiac include:

##### Cabo Pulmo National Marine Park

Set out to snorkel the pristine reefs of Cabo Pulmo National Marine Park, one of the most successful national marine parks in the world. Chat with locals about their advocacy to protect this unique place, including a cessation of fishing to protect the reef.

##### Isla Espíritu Santo

A national park as well as UNESCO World Heritage Site with volcanic rock formations, scenic beaches and coral reefs. This magical island offers excellent hiking opportunities and crystal-clear waters for

snorkeling. It's a popular destination for researchers monitoring sea turtles.

##### Los Islotes

Located at the northern tip of the UNESCO Biosphere Reserve, Los Islotes is largely inaccessible to people and home to a large colony of sea lions. Conditions permitting, we'll anchor off the rocky island where we don flippers, a mask and snorkel (which we provide) and swim with these curious inhabitants.

##### Isla San José

One of the larger islands in the Gulf of California, San José offers several landing possibilities depending on conditions and the whim of the moment. Photograph the ochre cliffs of the island's eastern shore, hike an enchanted, cactus-laden arroyo or visit the abandoned salt works to the west. Discover rare wildlife among desert islands.

**Meals included:** breakfast, lunch, dinner

### ◇ DAYS 5-7

#### Exploring the Midriff Islands / Bahía Loreto Marine Park

The islands of the Midriff region in the northern Gulf of California are favorites among our naturalists for their remoteness as well as their exceptional wildlife and birdlife. With nature as our guide, we will actively explore these areas by Zodiac, kayak, paddleboard, snorkeling and hiking. Some of the locations we may visit or enjoy by Zodiac include:

##### Isla San Pedro Mártir

This 1,000-foot-high guano-covered island is home to the world's largest nesting colonies of blue-footed and brown boobies. The surrounding waters boast 14 species of marine mammals, including fin whales,

bryde's whales and a resident group of sperm whales.

### **Isla San Esteban**

Featuring volcanic slopes and cliffs, Isla San Esteban is home to spiny-tailed iguana and chuckwallas, cohabitant lizards with fascinating evolutionary traits. As we hike the broad arroyo, keep an eye out for the spiny-tailed iguana feeding on flowers atop cardon cacti, while the chuckwalla dines on the leaves and fruits of low-lying plants.

### **Isla Rasa**

This legendary, uninhabited island is less than 0.21 square miles wide and yet is crucial to the survival of two species of seabirds. 95% of the world's Heermann's gulls and elegant terns use the island as their nesting grounds, creating a cacophonous, avian spectacle seen nowhere else on earth.

### **Bahía Loreto Marine Park**

One of Mexico's natural treasures, this protected area offers a variety of pristine landscapes and a plethora of marine life. Search for bottlenose and common dolphins, with the possibility of encountering fin whales, which researchers have recently concluded may be part of a resident population.

**Meals included:** breakfast, lunch, dinner

## ◇ DAY 8

### **Bahía de los Ángeles**

Get active this morning with options to hike, kayak, swim, snorkel or beachcomb within the Bahía de los Ángeles Biosphere Reserve. Board Zodiacs to seek out this protected reserve's diverse marine population, including endangered species such as fin whales, California sea lions, and five species of sea turtles. Whale sharks have also historically been known to populate these waters. Later, enjoy a rare opportunity to see one of the strangest plants

on earth, the boojum tree. Sacred to indigenous people, and believed to have supernatural powers, this evolutionary oddity takes its name from a Lewis Carroll poem. Capture the experience with help from your Certified Photography Instructor.

**Meals included:** breakfast, lunch, dinner

## ◇ DAY 9

### **Santa Rosalía / Cruising**

After breakfast, disembark in Santa Rosalía, established as a French copper mining town in 1884. The French influence remains in the architecture—including a steel church designed by Gustave Eiffel—and the mining facilities have been left intact, with old locomotives and machinery visible throughout. Engage with the city's culture and cuisine as you walk the streets, stopping in at a world-famous French bakery for a sweet or savory treat. Back on board, take in the desert landscapes and search for a variety of whales as we cruise to our next destination.

**Meals included:** breakfast, lunch, dinner

## ◇ DAY 10

### **Bahía Concepción**

Awake in Bahía Concepción, one of the largest bays of the Baja California peninsula, with over 50 miles of beaches. Take your coffee to the deck to witness the colorful landscapes revealed by another gorgeous Baja California sunrise. This biodiversity hotspot is ripe for exploration. Board Zodiacs in search of whale sharks and other marine life, kayak through lush mangrove systems and snorkel in turquoise waters. On land, join an invigorating hike among towering cacti or stroll the pristine beaches and learn about the ecology from our naturalists.

**Meals included:** breakfast, lunch, dinner

## ■ DAY 11

### **Loreto / Disembark Ship**

Disembark in Loreto after breakfast and transfer to Loreto airport for flights home.

**Departure Time:** After 11:00 a.m., local time

**Departure City:** Loreto, Mexico

**Meals included:** breakfast

Northbound

La Paz, Mexico → Loreto, Mexico

2026 Departure Dates

Aboard *National Geographic Venture*

07 Apr

2027 Departure Dates

Aboard *National Geographic Venture*

06 Apr

2028 Departure Dates

Aboard *National Geographic Venture*

28 Mar

Alternative Routes

Visit [Expeditions.com](http://Expeditions.com) for more information.

2026 Departure Dates

28 Mar

2027 Departure Dates

27 Mar

2028 Departure Dates

18 Mar, 07 Apr



## ***National Geographic Venture***

---

**Guests**

100

**Cabins**

50

---

**The *National Geographic Venture* is a state-of-the-art expedition ship ideal for discovering remote locations in domestic waters.**

Following the build of *National Geographic Quest* at Nichols Brothers shipyard, her sister ship the 100 guest *National Geographic Venture* floated into the bay on Whidbey Island, becoming the 4th ship in the Lindblad fleet built at this storied PNW shipyard. In the 1970s, Nichols Brothers built the twin ships *National Geographic Sea Bird* and *National Geographic Sea Lion*, which continue to sail the waters of the west coast of North America and Central America.

*Venture*, like much of the wildlife she follows, is migratory. She follows the seasons from Alaska, along the coast of British Columbia, up the Columbia & Snake Rivers, and along the Baja coast and into the Sea of Cortez. In each region, her design innovations were informed by 50+ years of expedition expertise to ensure extraordinary discoveries. Larger than her sibling twin ships, *National Geographic Sea Bird* and *National Geographic Sea Lion*, *National Geographic Venture* has the same shallow draft, enabling her to nimbly navigate the same inner reaches and provide the same intimate, 'insider' experiences of the charismatic regions we explore.

Like her sister ship *National Geographic Quest*, *National Geographic Venture* has dual boarding platforms, enabling our team to load two Zodiacs at once means guests get off ship quickly, to take advantage of wildlife sightings and maximize exploring time. Modern, cleaned-lined, with large expanses of glass to keep you connected to the extraordinary views, *National Geographic Venture* enables you to see, do and experience the best of her geographies.



# Cabin Categories

## Category 1

**Main Deck: #301-306**

Cabins feature two single beds that can convert to a Queen, a writing desk, two nightstands and two portholes, full length mirror, and reading lights.



## Category 2

**Main Deck: #307-315**

Cabins feature two single beds that can convert to a Queen, a writing desk, two nightstands and two portholes, full length mirror, and reading lights.



## Category 3

**Upper Deck: #201-206**

Cabins feature two single beds that can convert to a Queen, a writing desk, two nightstands, a large view window, full-length mirror, and reading lights.



## Category 4

**Upper Deck: #207-229**

Cabins feature two single beds that can convert to a Queen, a writing desk, closet, two nightstands, full-length mirror, reading lights, sliding glass door, and a small, private balcony.



**Note:** Solo occupancy cabins are available in Categories 1 and 2 only. Third person rates are available in Category 5 cabins at one half the double occupancy rate.

### Connecting Cabins via internal doorway access:

Main Deck: #312-314, #311-315, #306-307;  
Upper Deck: #224-226, #225-227

## Category 5

### Observation Deck: #101-108 (SUITE)

Cabins feature two single beds that can convert to a Queen, large view windows, closet, two nightstands, full-length mirror, reading lights, a suite-sized expanded bathroom, writing desk, ample storage space, and a convertible sofa bed to accommodate a third person.



## Observation Deck

### Category 5

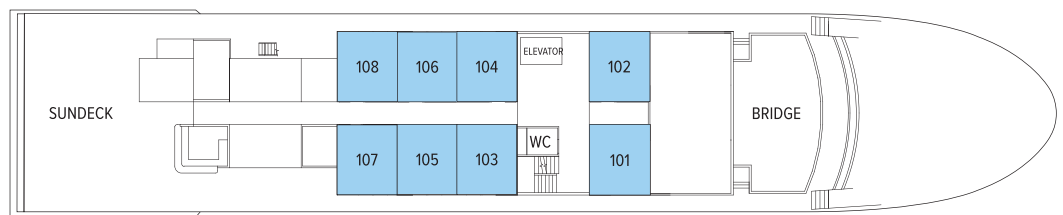

## Lounge Deck

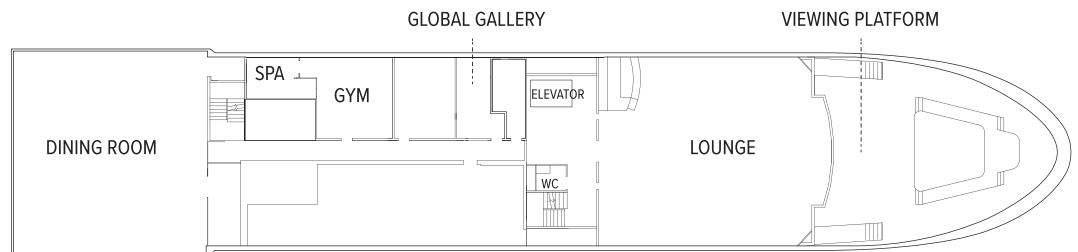

## Upper Deck

### Category 3

### Category 4

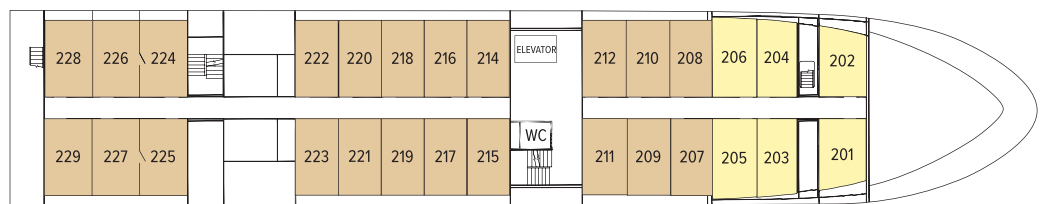

## Main Deck

### Category 1

### Category 2

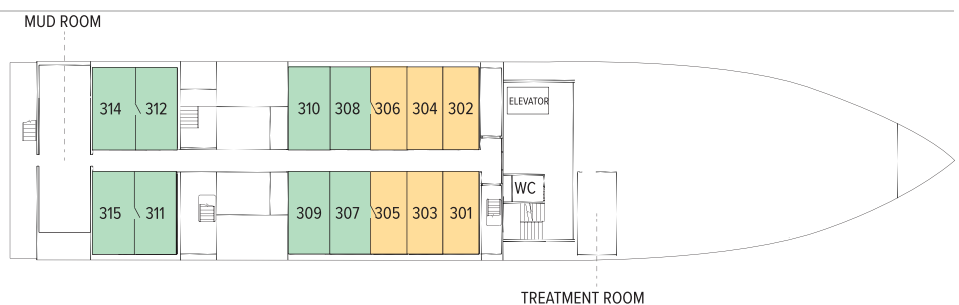

# Ship amenities

## Public Areas

Reception; main dining area; global gallery; fitness center; lounge with full-service bar and state-of-the-art presentation facilities; observation deck; mudroom with lockers for expedition gear; partially-covered furnished sundeck; plus open access to the Bridge, the Captain, officers and on-duty wildlife spotters.

## Meals

Meals are served in the dining room at a single seating with unassigned tables for an informal atmosphere and easy mingling. Menus feature sustainable choices, local where possible.

## Cabins

50 outside cabins. All cabins face outside with windows, private bathroom, and climate controls. Cabins are equipped with Wi-Fi, phone, multiple electrical and USB outlets, and phones. Luxury linens and pillows. Botanically inspired shampoo, conditioner, shower gel, and lotion are all available in cabin bathrooms, as well as an Expedition Essential Kit. Hair dryers, complimentary insulated water bottles and a National Geographic Atlas are also available in each cabin.

## Expedition Equipment

A fleet of 8 Zodiacs, 24 kayaks, paddleboards; an ROV, hydrophone, splash-cam, underwater video camera, video microscope; snorkeling gear and wet suits for all guests (where applicable).

## Special Features

Lindblad-National Geographic certified photo instructor, undersea specialist and video chronicler. Internet access. Elevator. The design of the outside decks—with the perfect wildlife viewing platform. And the way the proximity of the Lounge to the deck gives you instant access to spontaneous sightings. Have your camera ready!

## Wellness

A fitness center with elliptical, treadmill, weights, resistance bands; LEXspa treatment room, staffed by wellness specialists.



## Self-Disinfecting Ships

ACT Clean Coat™ is a light-activated, self-disinfecting cleaning process that continuously breaks down viruses, bacteria, mold, and airborne allergens across all ship surfaces. Not only does this create a cleaner, healthier shipboard environment for guests and crew alike, but this non-toxic, chemical-free system also saves more than one million gallons of water each year in our cleaning procedures, and reduces our carbon footprint as well as the amount of plastic and waste in our supply chain.

## Special Offers

### SPECIAL SAVINGS

Receive savings of up to 20% on select voyages as indicated on our special offer page. Applicable savings will be deducted from cabin fare after any additional applicable savings with the purchase of cabin fare. Receive 50% off the deposit due at the time of booking on select 2026 and 2027 voyages outside of final payment. Remaining deposit balance is due at the time of final payment. Additional restrictions may apply. Offers valid on new bookings only for select 2026 and 2027 departures, subject to availability and offer may be withdrawn at any time without prior notice, not applicable on airfare or extensions, and may not be combined with other offers. Call for details.

### CELEBRATE LIFE'S MILESTONES

Celebrate a milestone with a group of eight or more and enjoy a special amenity package including: 5% savings on voyage fares, custom group photo, US\$150 shipboard credit for the group, and other special gifts. Milestone celebration to be communicated at time of booking.

### SAVE 5% TRAVELING AS A GROUP

Save 5% when traveling as a group of eight or more people. Valid on voyage fares only and not applicable on extensions or airfare. Deposit, final payments, and cancellation policies for group travel vary from our regular policies. Valid for new bookings only, subject to availability, and may not be combined with other offers. Call for details.

### PAY BY DEBIT: EARN A \$100 ONBOARD CREDIT

The \$100 onboard credit offer is applied after the final payment and requires 85% of the cost of the voyage to be placed on a debit card. Maximum of one \$100 onboard credit per cabin. The \$100 onboard credit is a non-refundable, non-transferable credit that can be used for various onboard purchases such as global gallery and spa treatments. It has no cash value, cannot be refunded if not fully utilized, and will be forfeited if not fully redeemed by the end of the voyage. This offer is combinable with other offers. If the booking is altered or canceled, the onboard credit may be forfeited, and it cannot be transferred if the booking is moved to another guest. Lindblad Expeditions reserves the right to modify or cancel the offer without prior notice. Offer applies to Lindblad Expeditions' owned ships only. Offer valid only for Debit Cards issued in the United States for payments made from the United States.

### COMBINING OFFERS

Certain offers may be combinable, up to two savings opportunities, except where noted otherwise. For example, travel with a group of 8 or more on back-to-back expeditions, and take advantage of both savings.

### 10% OFF BACK-TO-BACK VOYAGES

Save 10% on consecutive departures, applicable on voyage fares only and not valid on extensions or airfare. Valid for new bookings only, subject to availability, and may not be combined with other offers. Call for details.

### BRINGING THE KIDS

We believe sharing an expedition with children is a life-enhancing experience. Save \$500 for each child under the age of 18 on any departure. Not applicable

on extensions or airfare. Call for details.

---

## Save 25% on Select 2026 Voyages

Receive savings of 25% on cabin fare on select 2026 voyages by using code 25FOR26 via website or phone. Applicable savings will be deducted from cabin fare after any additional applicable savings with the purchase of cabin fare. Additional restrictions may apply. Offers valid on new bookings only for select 2026 departures, subject to availability and offer may be withdrawn at any time without prior notice, not applicable on airfare or extensions. Offer may not be combined with other limited-time offers. Call for details.

## Included in price

All accommodations aboard ship or in hotels per itinerary; all meals as indicated in the itinerary, both aboard and onshore; beer, wine, cocktails, liquors and spirits aboard the ship (except certain premium brands which are available for purchase); hors d'oeuvres, 24-hour access to snacks, premium coffees and teas, non-alcoholic beverages, and filtered water; excursions and airport transfers to and from recommended flights, as indicated in the itinerary; exploration tools curated to destination, such as Zodiacs, stand-up paddleboards, kayaks, snorkeling equipment (including wetsuits, masks, and fins); guidance and company of our leading expedition staff; assistance by the Lindblad Expeditions-National Geographic certified photo instructor; access to the OM System Photo Gear Locker; presentations by expedition staff and expert guest speakers; complimentary reusable water bottle; onboard physician consultations; morning stretch classes and 24-hour access to exercise equipment; 24-hour access to lounges, observation decks, library, and other shared spaces; basic WiFi, park and site entrance fees, special access permits, and port taxes. Unused services or items included in our programs are non-refundable.

## Not included in price

Airfare (except flights\* when indicated as included); pre- and post-expedition extensions; additional hotel nights (except when indicated as included); crew gratuities; private transfers; laundry, spa treatments, travel protection plans; and passport, visa, and immigration fees.

\*Recommended flight costs include flight(s) that take place during the date range of your trip to transport travelers from one itinerary destination to another. This cost also includes ground transportation, luggage transfer, and airport assistance. If you prefer to arrange your own flights privately, have alternate means of transport, or wish to modify at a later time, please contact an Expedition Specialist at 1.833.400.0831

Additional costs associated with medical services outside onboard physician consultation.

our Travel Protection Plan. This plan offers comprehensive coverage to protect you from cancellation fees, costs incurred due to trip delays/interruption, damage or loss of baggage, medical assistance, and evacuation during your travels. Our Travel Protection Plan is available for U.S. residents only, and may be purchased any time prior to final payment due date, Travel Protection premiums are non-refundable once plan is purchased. Learn more about our Travel Protection "Plus" Plan: <https://www.expeditions.com/terms-conditions/travel-protection-plan/>

## Cancellation policy

Review our cancellation policy: <https://www.expeditions.com/cancellation-policy/>

## Travel protection plan

We strongly recommend our guests to take advantage of