







Japan & Asia
 36° 33' N 136° 39' E

Coastal Japan: Imperial Dynasties and Modern Culture

Step back in time on a voyage into Japan’s riveting history, from the storied castle towns of the Edo period to the elegant shrines and merchant districts of the Meiji era to the poignant sites of World War II. Venture into the homes of samurai and feudal lords and discover exquisite centuries-old gardens and temples. Take a detour to South Korea to discover the ancient city of Gyeongju and explore Japanese artistic traditions of the past and present.

From
A\$ 27,143 / per person
 Does not include flights

 DATES May, Jun and Sep	 DURATION 16 Days
 SHIPS <i>National Geographic Resolution</i>	
 STARTS AT Osaka, Japan	→  ENDS AT Kyoto, Japan

Highlights

- ★ Meander through Koraku-en and Sengan-en, two unique Japanese gardens that are considered some of the most beautiful in the country
- ★ Explore the cultural legacy of Korea's Silla Dynasty among the ancient ruins of Gyeongju, a UNESCO World Heritage site
- ★ Get inspired on the art-filled island of Naoshima and visit museums and studios dedicated to artists and traditional handicrafts in Matsue
- ★ Learn about the historic past and modern day lives of the Geisha - the treasures of Kyoto

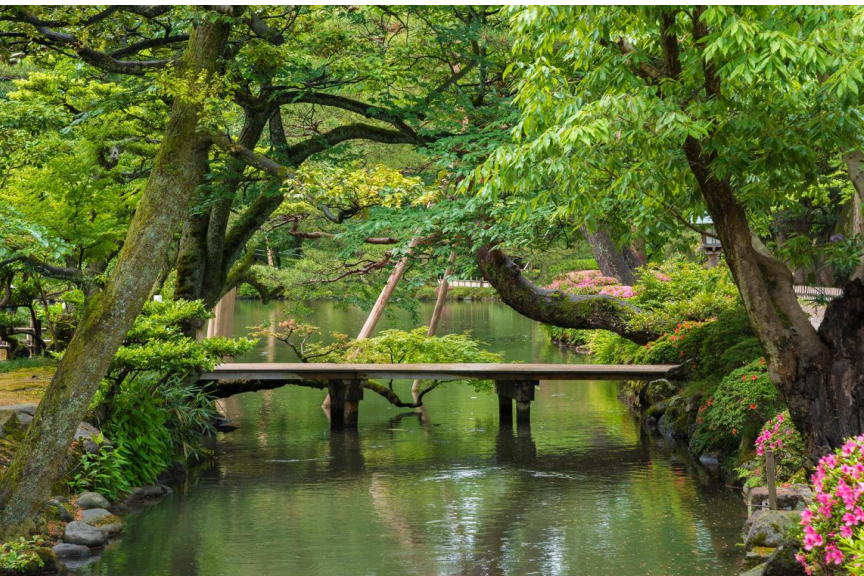
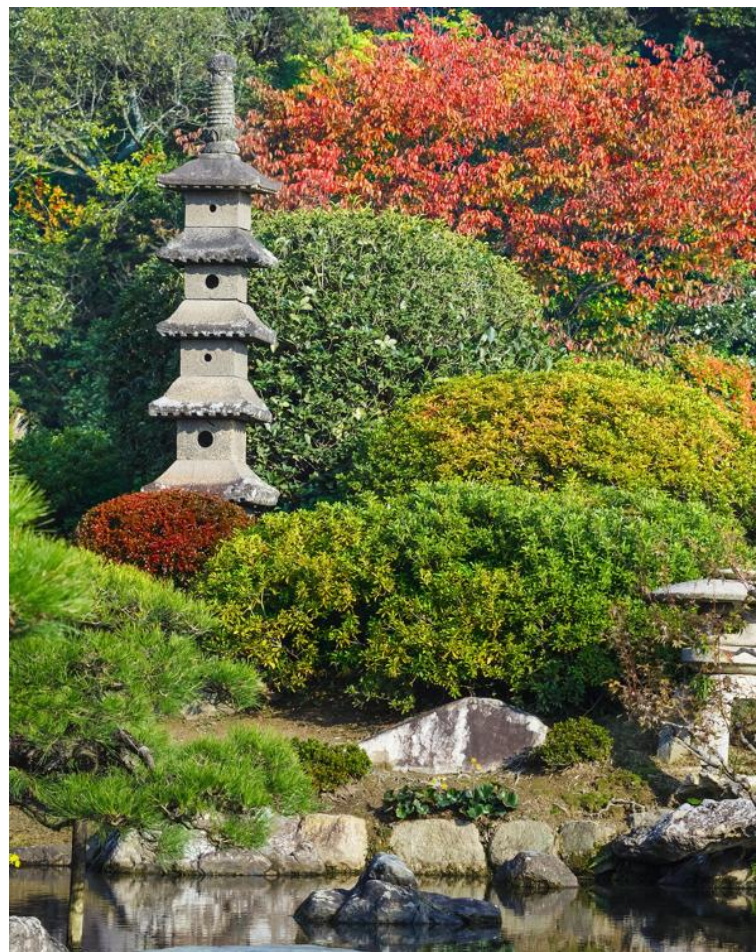



Day by day

■ DAY 1

Osaka, Japan

Arrive in Osaka and transfer to your hotel.

◇ DAY 2

Osaka / Embark Ship

After checking out of the hotel, travel to Himeji Castle, one of Japan's most spectacular. Also known as "White Heron Castle," this UNESCO World Heritage site is at once imposing and elegant. Following lunch, transfer to the *National Geographic Resolution* for embarkation.

Meals included: breakfast, lunch, dinner

◇ DAY 3

Naoshima / Okayama / Kurashiki

This morning, take a short ferry ride to Naoshima Island, which was converted into a hub for art and artists by the Benesse Corporation in 1992. Naoshima is an eclectic mixture of nature, art and architecture—you'll discover famous works, like Yayoi Kusama's *Yellow Pumpkin*, displayed in unexpected places.

This afternoon, choose to visit Okayama, home to Korakuen Garden, one of the three best landscape gardens in Japan. Stroll the elegant garden paths, enjoying the beauty and the views of Okayama Castle and its impressive black silhouette. You may also choose to walk along Kurashiki's lovely canal, lined with beautifully preserved storehouses now selling locally made handicrafts, or visit the Ohara Museum of Art and the Ohashi House, an example of a wealthy merchant's home from the 18th century.

Meals included: breakfast, lunch, dinner

◇ DAY 4

Takamatsu

Early this morning, sail to Takamatsu on Shikoku Island. Explore Shikoku Mur, an open-air museum that showcases traditional building styles. Learn how people lived during the Edo and Taisho eras. Visit Ritsurin Garden—earning three stars in the Michelin Green Guide, it is one of the most beautiful gardens in all of Japan. End the day at Kinashi Bonsai Town, dedicated to the art of pine tree bonsai.

Meals included: breakfast, lunch, dinner

◇ DAY 5

Miyajima / Hiroshima

Start the day on the island of Miyajima, home of Itsukushima Shrine, a UNESCO World Heritage site famed for its red torii gate that seems to float atop the water at high tide. In Hiroshima, visit the Peace Memorial Park, see the Atomic Bomb Dome, one of only a few buildings left standing after the attack and learn about the city's dedication to peace following World War II.

Meals included: breakfast, lunch, dinner

◇ DAY 6

Uwajima / Uchiko

Rise early for a morning hike to Uwajima Castle, one of just 12 original Edo-period castles that remain intact. Continue to Uchiko, once a center of wax production. Take a walk in the town's well-preserved Yokaichi district, where beautifully crafted wooden merchant homes recall the prosperity of the Meiji period.

Meals included: breakfast, lunch, dinner

◇ DAY 7

Yakushima Island

The diverse ecology of Yakushima Island, including a subtropical coast and temperate rainforest in the interior, has earned this island World Heritage status. On a hike, discover the island's ancient Yakusugi cedar trees, many of which date back more than a thousand years. Back on board the ship in the evening, head north toward the island of Kyushu.

Meals included: breakfast, lunch, dinner

◇ DAY 8

Kagoshima

At the southern end of Kyushu, the city of Kagoshima sits just across the bay from the active volcano Sakurajima. Take a walk in Sengan-en Garden, designed by the city's ruling Shimadzu clan in 1658 to incorporate the bay and its simmering volcano. After lunch, travel along the Satsuma Peninsula to the village of Chiran, where the samurai designed gardens inspired by their travels.

Meals included: breakfast, lunch, dinner

◇ DAY 9

Nagasaki

Long before World War II, Nagasaki was a cosmopolitan trading center, drawing merchants from Europe and China to its picturesque harbor as early as the 1500s. Visit Oura Cathedral, the oldest Christian church in Japan and venture to Nagasaki Peace Park. A poignant exhibition illustrates the aftermath of the atomic bomb attack on the city, and a somber monument now stands at ground zero. This afternoon, chart a course for the Korean Peninsula.

Meals included: breakfast, lunch, dinner

◇ DAY 10

Ulsan, South Korea / Gyeongju

Dock in Busan and travel to Gyeongju, the ancient capital of the Silla kingdom and the crown jewel of Korea's cultural heritage. Packed with the ruins of temples, pagodas and palaces dating back more than a thousand years, the historic areas of the city have been collectively designated a UNESCO World Heritage site. Visit Bulguksa Temple, a masterpiece of Silla architecture originally built in A.D. 528.

At the Gyeongju National Museum, examine jewelry, weapons and other Silla artifacts. See Cheomseongdae, a seventh-century observatory and wander among towering royal burial mounds.

Meals included: breakfast, lunch, dinner

◇ DAY 11

Matsue, Japan

Sail up the coast to Matsue, situated between a lake, a lagoon and the sea. Tour the 17th-century Matsue Castle built as a defensive fortress and discover its clever design elements intended to foil the enemy. Continue to the Adachi Museum of Art, which blends an impressive collection of 20th-century Japanese art with a gem-like traditional garden.

Meals included: breakfast, lunch, dinner

◇ DAY 12

Moji

With its location in line with the route from Honshu to Shanghai, Moji has a long history as a prominent trading post. The bustling modern day ship traffic has moved to another port, leaving Moji with a slower pace. You'll have the opportunity to step back in time and stroll the promenade, exploring the well-preserved buildings of the Meiji and Taisho periods. Moji is also known for its limestone caves. You will pass through a cedar grove to enter one of Japan's largest limestone caves: Akiyoshidai. Exploring this cave, you'll only touch a very small

corner of the national park that spans 100 meters underground.

Meals included: breakfast, lunch, dinner

◇ DAY 13

Mitarai

Located in the Seto Inland Sea, Mitarai is a seaside village that did not get swept up with all the changes and development that the 20th century brought. The traditional wooden buildings and narrow streets date back to a traditional past. The mature gardens add even more beauty and serenity to the sheltered bay. Explore this hidden gem that has been designated a Historic Preservation District of Traditional Architecture.

Meals included: breakfast, lunch, dinner

◇ DAYS 14-15

Osaka / Disembark Ship / Kyoto

Upon disembarkation, transfer to Kyoto. Once the capital of Japan, this beautiful city still holds many of the Japanese traditions very dear. It's a unique blend of modern day and ancient culture that has been refined over the last 1200 years. Spend two days exploring an array of sites, including the impressive Torii Gates of Fushimi Inari Shrine; Nishiki Market with its assortment of beautiful fresh foods; Higashiyama District one of Kyoto's best preserved historic districts; and the soaring stalks of bamboo in Arashiyama. No visit to Kyoto is complete without a glimpse into the secret life of the Geisha as you learn about the customs and experience a traditional ceremony.

Meals included: breakfast, lunch, dinner

■ DAY 16

Kyoto / Osaka

Following breakfast, check out of the hotel and transfer to the airport for flights home.

Meals included: breakfast

Expedition

Osaka, Japan → Kyoto, Japan

2026 DEPARTURE DATES

Aboard *National Geographic Resolution*

07 Sep	19 Sep			
--------	--------	--	--	--

2027 DEPARTURE DATES

Aboard *National Geographic Resolution*

23 May				
04 Jun	16 Jun			



National Geographic Resolution

GUESTS

138

CABINS

76

The sister ship to *National Geographic Endurance*, she explores polar & temperate regions

Our second new polar build, *National Geographic Resolution*, is named to honor the second voyage of the legendary Captain James Cook. A fully-stabilized vessel of the highest ice class (PC5 Category A), she will enable adventurous guests to go where few have or can. Resolution's most striking exterior feature is her distinctive profile, the patented X-Bow®, a game-changing design that guarantees the smoothest, most comfortable ride in all kinds of conditions; and since it eliminates bow impact, a quieter ride, as well.

An equally impressive feature may well be her capacity: she carries just 138 guests, a commitment to expedition excellence over scale. Scandinavian-inflected, luxuriously appointed, her inviting interiors would be a destination in themselves. Because she is a Lindblad expedition ship, however, her attention is focused on the world outside – with acres of window glass to keep you connected to the stunning views beyond the pane, and a fleet of expedition tools to get you out exploring.

National Geographic Endurance and *National Geographic Resolution* are next-generation expedition ships. Purpose-built for polar navigation. Fully stabilized, highly strengthened, ice-class Polar Code PC5 (Category A) vessels, they are designed to navigate polar passages year-round, and safely explore uncharted waters, while providing exceptional comfort. The patented X-bow[®] is key to their design; its powerful wave-slicing action provides an extremely smooth ride even in adverse conditions, and even reduces spray on deck for superior observation. They carry a full suite of expedition tools, and offer a variety of experience enhancing amenities.



Cabin Categories

Category 1

FORE DECK #404, 406, 408, 411, 413, 415

Cabin with two large windows, two singles that can convert to a queen, writing desk and chair, two bedside tables, window sofa, coffee table, and a closet.



Category 2

FORE DECK #410, 412, 414, 416-419, 421-427

Cabin with two large windows, two single beds that can convert to a queen, window sofa, two-seat sofa, coffee table, writing desk with an office chair, two bedside tables, coffee table, and a closet.



Category 3

MAIN DECK #512-524

Cabin with balcony that features two balcony chairs, hammock, and a table; two single beds that convert to a queen; convertible sleeper sofa; writing desk with a chair; two bedside tables; coffee table; and a closet.



Category 4

LOUNGE DECK #608, 610, 612, 613-623

Cabin with balcony that features two balcony chairs, hammock and a table; two single beds that can convert to a queen; pull-out sofa; coffee table; writing desk with chair; two bedside tables; and a closet.



Category 5

BRIDGE DECK #700-707, 712, 713, 715, 717

Cabin with balcony that features two balcony chairs, hammock, and a table; two single beds that convert to a queen; convertible sleeper sofa; coffee table; writing desk with chair; two bedside tables; and a closet.



Category 6

BRIDGE DECK #714

Junior suite with balcony that features two balcony chairs, hammock, and table; two single beds that convert to a queen; pull-out sofa; writing desk with chair; two bedside tables; coffee table; espresso maker and a closet. Guests receive priority access to one spa treatment and one igloo reservation and complimentary laundry per departure.



Category 7

BRIDGE DECK #708-711, 716, 718, 719, 721

These large balcony suites feature two balcony chairs, hammock, and table; two single beds that can convert to a queen; pull-out sofa; coffee table; writing desk and chair; espresso maker; and a large walk-in closet with full length mirror. Expanded bathroom has a double vanity, bathtub, towel warmer and rain shower. Guests receive priority access to one spa treatment and one igloo reservation and complimentary laundry per departure.

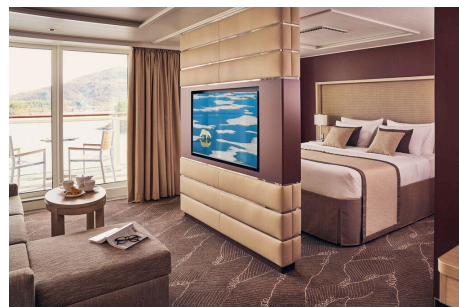

Category A Solo

MAIN DECK #504-510, 513

Cabin with balcony that features two balcony chairs, hammock, and a table; single bed; writing desk with an office chair; and a closet.



Category B Solo

LOUNGE DECK #604-607, 609, 611

Cabin with balcony that features two balcony chairs, hammock, and a table; single bed; writing desk with chair; hammock; and a closet.



Deck Plans

Observation Deck

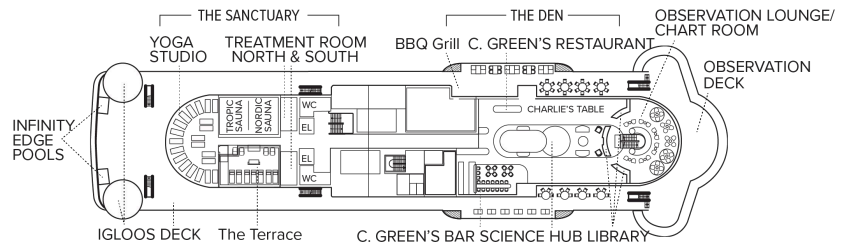

Bridge Deck

- Category 5
- Category 6
- Category 7

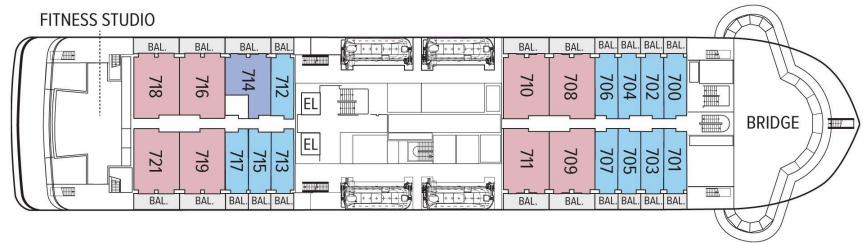

Lounge Deck

- Category 4
- Category B Solo

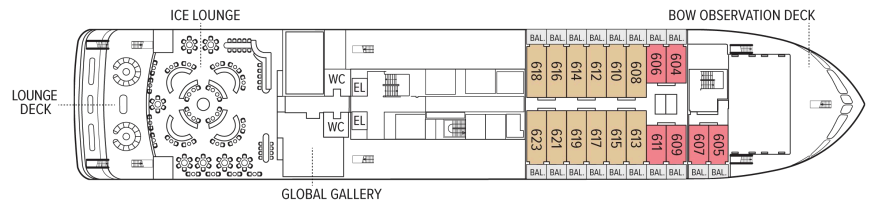

Main Deck

- Category 3
- Category 2 Solo

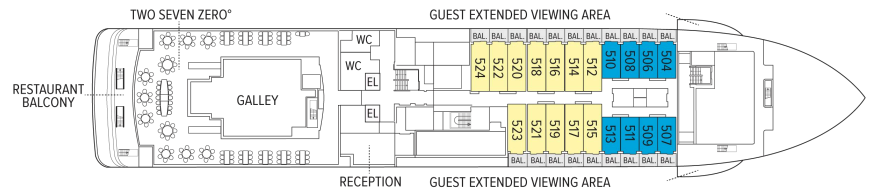

Fore Deck

- Category 1
- Category 2

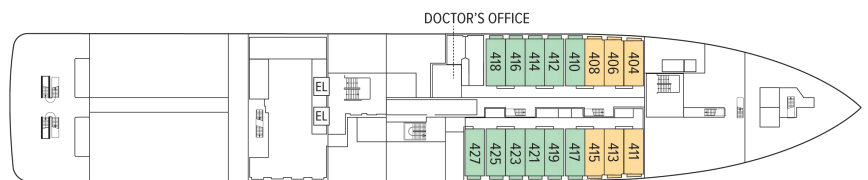

Expedition Deck

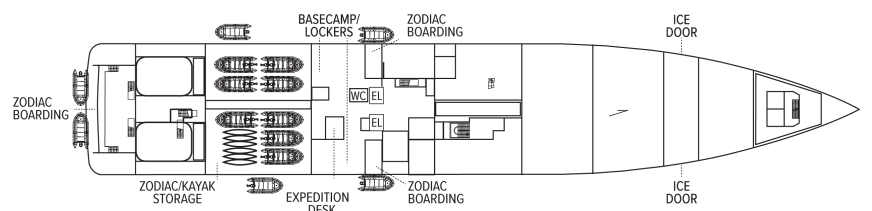

Ship Amenities

Public Areas

Reception; three dining areas; an observation lounge with bar, gym, wellness area, infinity-style outdoor hot tubs with adjacent igloos; library; main lounge with full service bar, 24-hour beverage station, state-of-the-art tech for films/presentations; OM System photo locker and a photo workshop area; science hub; an onboard broadcast studio; an expedition base with lockers for expedition gear; and open access to the Bridge, Captain, officers and on-duty wildlife spotters.

Meals

Restaurant 270° features wrap-around views; two other dining areas offer lighter, made-to-order fare or intimate, small group dinners. All feature sustainable choices, local where possible, and unassigned, flexible, inclusive seating.

Cabins

All cabins face outside with large windows, private bathroom, and climate controls. Cabins are equipped with expedition command centers with iPad tablets, multiple electrical and USB outlets, TVs, with on demand entertainment, phone, Wi-Fi, clock, barometers, hygrometers, vanity mirror, mini refrigerator, small safe, ice bucket, glasses, hair dryer, reading lights and National Geographic Atlas. Luxury linens and pillows. Bathrooms outfitted with Rain showers & hand held shower, botanically inspired shampoo, conditioner, shower gel and lotion. Complimentary insulated water bottles. Balcony cabins have hammocks, chairs and table.

Expedition Equipment

Zodiac landing craft, kayaks, snowshoes, cross-country skis, an ROV and underwater video camera for unique access to the polar undersea, hydrophone, aerial remote-controlled camera and video microscope.

Special Features

A full-time doctor, undersea specialist, National Geographic photographer, National Geographic-Lindblad Expeditions certified photo instructor and video chronicler, an internet cafe and laundry. A forward and aft staircase, and elevators, reach all decks. Echoing the pioneering installation aboard *National Geographic Endurance*, artist Zaria Forman has curated a new exhibit featuring a wide range of artists.



Wellness

A glass-enclosed yoga studio, gym, treatment rooms and spa relax area, and high and low-heat saunas with ocean views, staffed by wellness specialists.

Self-Disinfecting Ships

ACT Clean Coat™ is a light-activated, self-disinfecting cleaning process that continuously breaks down viruses, bacteria, mold, and airborne allergens across all ship surfaces. Not only does this create a cleaner, healthier shipboard environment for guests and crew alike, but this non-toxic, chemical-free system also saves more than one million gallons of water each year in our cleaning procedures, and reduces our carbon footprint as well as the amount of plastic and waste in our supply chain.

Special Offers

on extensions, and may not be combined with other offers. Call for details.

SUITE EXCLUSIVES

Spacious living areas and incredible views immerse you in the beauty of your marine surroundings.

Our new Suite Exclusives package helps make your voyage all the more memorable. [Learn more](#)

CELEBRATE LIFE'S MILESTONES

Celebrate a milestone with a group of eight or more and enjoy a special amenity package including: 5% savings on voyage fares, custom group photo, US\$150 shipboard credit for the group, and other special gifts. Milestone celebration to be communicated at time of booking.

COMBINING OFFERS

Certain offers may be combinable, up to two savings opportunities, except where noted otherwise.

For example, travel with a group of 8 or more on back-to-back expeditions, and take advantage of both savings.

10% OFF BACK-TO-BACK VOYAGES

Save 10% on consecutive departures, applicable on voyage fares only and not valid on extensions or airfare. Valid for new bookings only, subject to availability, and may not be combined with other offers. Call for details.

SAVE 5% TRAVELING AS A GROUP

Save 5% when traveling as a group of 8 or more people. Valid for new bookings only on select departures, subject to availability, not applicable

INCLUDED IN PRICE

All accommodations aboard ship or in hotels per itinerary; all meals as indicated in the itinerary, both aboard and onshore; beer, wine, cocktails, liquors and spirits aboard the ship (except certain premium brands which are available for purchase); hors d'oeuvres, 24-hour access to snacks, premium coffees and teas, non-alcoholic beverages, and filtered water; excursions and airport transfers to and from recommended flights, as indicated in the itinerary; crew gratuities; exploration tools curated to destination, such as Zodiacs and kayaks; guidance and company of our leading expedition staff; assistance by the National Geographic Photographer and Lindblad Expeditions-National Geographic certified photo instructor; access to the OM System Photo Gear Locker; presentations by expedition staff and expert guest speakers; complimentary reusable water bottle; onboard physician consultations; morning stretch classes and 24-hour access to exercise equipment; 24-hour access to lounges, observation decks, library, and other shared spaces; park and site entrance fees, special access permits, and port taxes. Unused services or items included in our programs are non-refundable.

NOT INCLUDED IN PRICE

Airfare (except flights* when indicated as included); pre- and post-expedition extensions; additional hotel nights (except when indicated as included); private transfers; laundry, spa treatments, Wi-Fi, and phone services (except when indicated as included); travel protection plans; and passport, visa, and immigration fees.

*Recommended flight costs include flight(s) that take place during the date range of your trip to transport travelers from one itinerary destination to another. This

cost also includes ground transportation, luggage transfer, and airport assistance. If you prefer to arrange your own flights privately, have alternate means of transport, or wish to modify at a later time, please contact an Expedition Specialist at 1.833.400.0831

Additional costs associated with medical services outside onboard physician consultation.

TRAVEL PROTECTION PLAN

We strongly recommend our guests to take advantage of our Travel Protection Plan. This plan offers comprehensive coverage to protect you from cancellation fees, costs incurred due to trip delays/interruption, damage or loss of baggage, medical assistance, and evacuation during your travels. Our Travel Protection Plan is available for U.S. residents only, and may be purchased any time prior to final payment due date, Travel Protection premiums are non-refundable once plan is purchased. Learn more about our Travel Protection "Plus" Plan: <https://www.expeditions.com/terms-conditions/travel-protection-plan/>

CANCELLATION POLICY

Review our cancellation policy: <https://www.expeditions.com/cancellation-policy/>