





Alaska, Japan, Asia & North America
 43° 13' N 142° 51' E

Alaska to Japan: Ring of Fire to Ainu Culture

Trace the Pacific’s “Ring of Fire” between Alaska’s volcanic Aleutian Islands and the rugged island of Hokkaido, Japan. Discover the wild, seldom-visited islands of the Bering Sea, encountering millions of seabirds as well as northern fur seals and bears in the Pribilof and Aleutian Islands. View the towering volcanic cones that frame Hokkaido—home to more than 51 volcanoes—and explore how these dramatic landscapes have shaped Ainu and Shinto traditions and centuries of Japanese history.

From
\$ 27,000 / per person
 Does not include flights

 DATES Jul and Aug	 DURATION 19 or 20 Days
 SHIPS <i>National Geographic Resolution</i>	
 STARTS AT Nome, Alaska	→  ENDS AT Osaka, Japan

Highlights

- ★ Explore the dramatic Aleutian Islands, where volcanic cones rise from the sea and wildlife thrives—from pods of orcas and porpoises to otters and seals
- ★ Search for the sacred red-crowned crane on a visit to the wetlands of Kushiro on Hokkaido
- ★ Learn about the culture of Hokkaido's indigenous Ainu people on visits to a village and a living history museum
- ★ Experience the Pribilof Islands, remote seabird enclaves teeming with whiskered auklets, red-legged kittiwakes and horned and tufted puffins

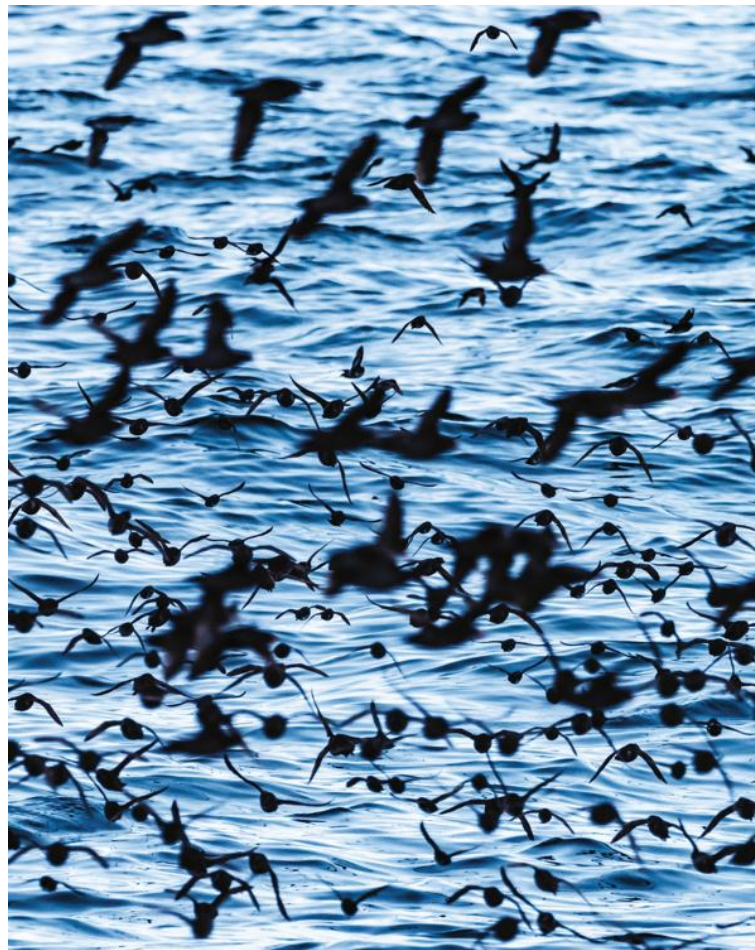

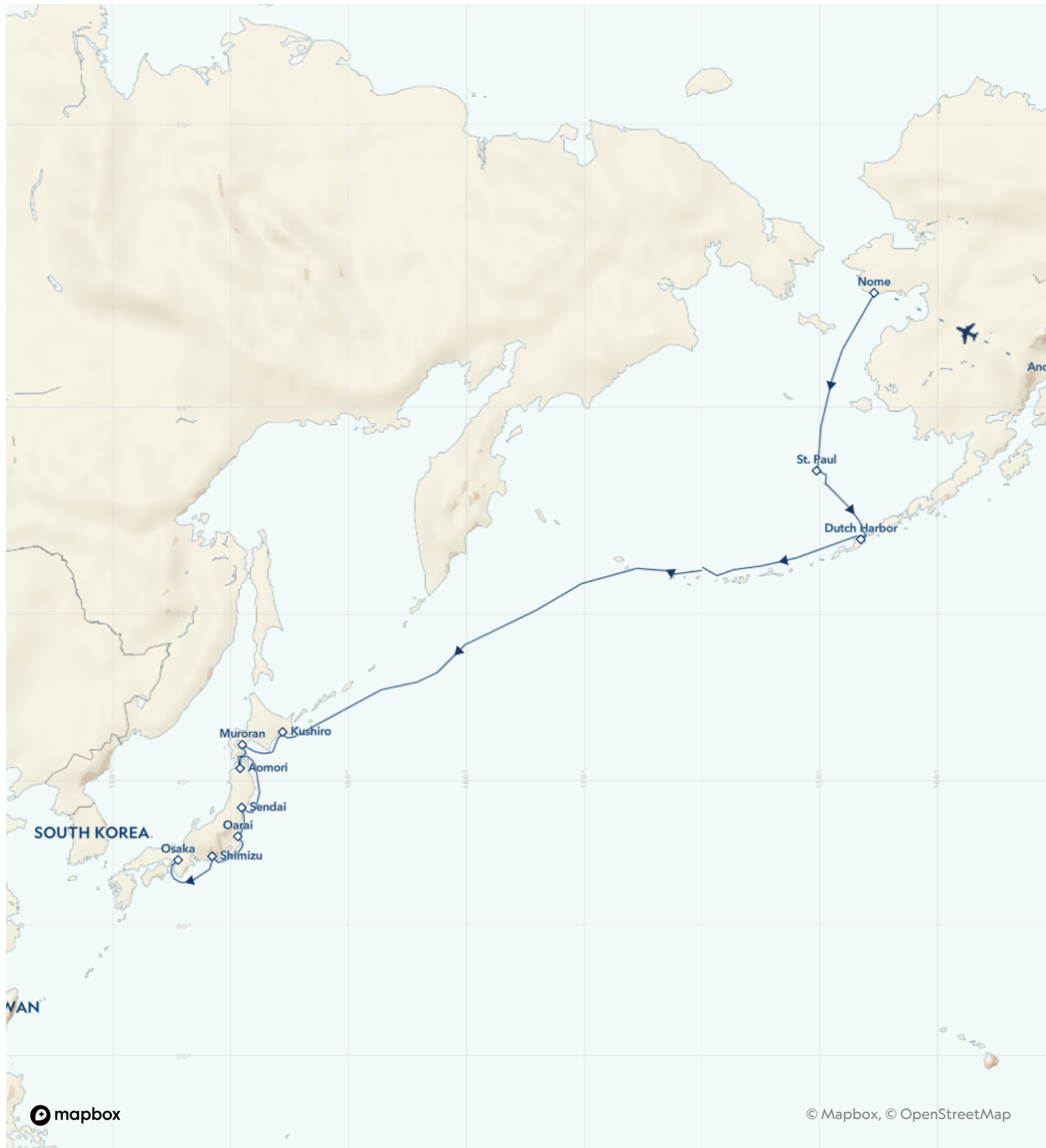

Day by day

■ DAY 1

Anchorage, Alaska / Nome / Embark Ship

Arrive in Anchorage and fly to Nome, Alaska. Embark the ship in the afternoon.

Arrival Time: Arrive before 9:00 a.m. local time.

Arrival City: Anchorage, Alaska

Meals included: dinner

◇ DAYS 2-3

Pribilof Islands / St. Paul and St. George Islands

A naturalist's paradise, the Pribilof Islands welcome three million seabirds and a million marine mammals each summer during the breeding season. Cruise beneath the cliffs of St. George, rocky outcrops that harbor one of the largest seabird colonies in the Northern Hemisphere. Watch for horned and tufted puffins, red-legged kittiwakes, crested auklets and rare Asian vagrant species seldom seen in North America. Go ashore on St. Paul, home to the majority of the Pribilofs' more than half a million northern fur seals.

Meals included: breakfast, lunch, dinner

◇ DAY 4

Baby Islands / Dutch Harbor

The westernmost tip of the Alaska mainland gives way to a 1,100-mile-long string of islands that separate the Bering Sea from the northern Pacific: the Aleutian Islands. Begin your exploration of this wildlife-rich archipelago at the Baby Islands, east of Unalaska. Here, dynamic tides offer the chance to look for sea otters and fur seals, as well as rare seabirds. Stand on deck as the ship navigates Baby Pass and be on the lookout for the islands' wildlife.

Arrive at Dutch Harbor, site of a fierce World War II battle and now one of the world's most important fishing ports.

Meals included: breakfast, lunch, dinner

◇ DAYS 5-8

Exploring the Aleutian Islands

With 69 islands, countless islets and tens of millions of seabirds, the Aleutians offer much to discover. Spend four days exploring these rugged and remote volcanic islands—some of which still harbor active volcanoes. Learn about the culture of the Aleuts, a fishing and hunting people who have inhabited these islands for millennia. Observe marine mammals such as northern fur seals, Steller sea lions and a variety of whales, as well as prolific birdlife. Witness how the weather—wind, rain, fog and glorious sunshine—impacts all aspects of life in this spectacularly scenic region.

Meals included: breakfast, lunch, dinner

◇ DAYS 9-12

At Sea

As the ship sets a course for Japan, enjoy discussions with your naturalists as they set the stage for your time exploring the northern shores of Hokkaido. Join them on deck to identify the seabirds that follow us and the volcanic cones in the distance that make up the "Ring of Fire." Be on the lookout for unexpected visits from whales and other marine mammals. There is also an array of shipboard activities to enjoy: attend a photo workshop with your National Geographic photographer, treat yourself to a massage or a wellness class or cozy up in the library with a good book. As you make your way to Asia, you will lose a day crossing the International Date Line.

Meals included: breakfast, lunch, dinner

◇ DAY 13

Kushiro, Japan

Arrive on the northeastern shore of Hokkaido, your first stop in Japan. With a deep connection to the sea, Kushiro is known for a variety of seafood, fresh from the sea. Experience the bustle of the local market where the daily catch is on display. Explore the Kushiro City Museum and delve into the rich history of the city and the traditions of the Ainu people. Following your morning of exploration, enjoy a meal loved by locals: *robata-yaki*, or “fireside grilling.” You will select your favorite seafood and grill it over the hot coals at your seat, a very special treat.

Meals included: breakfast, lunch, dinner

◇ DAY 14

Muroran

Dock at Muroran and choose to drive to Shikotsu-Tōya National Park, filled with mirror-like lakes and forest-covered hills set against the silhouette of the Mount Yotei stratovolcano. Alternatively, drive to the lush town of Shiraoi to visit the newly opened National Ainu Museum and Park, an open-air museum where visitors can experience various elements of Ainu culture.

Meals included: breakfast, lunch, dinner

◇ DAY 15

Aomori

Your first call on the northern coast of Japan’s main island of Honshu is Aomori City. With the Hakkoda mountains in the distance, this bountiful countryside is famous for apple orchards, world-famous seafood, local treasures of Tsugaru lacquerware and painted kites. Explore the tranquil Seiryuji Temple with its impressive bronze statue of Dainichi Nyorai. Learn about Nebuta Matsuri, the

summer festival with colorful papier-mâché floats, and see the amazing artistry up close.

Meals included: breakfast, lunch, dinner

◇ DAY 16

Sendai

Nestled between mountains and sea, Sendai’s lush greenery earned it the nickname of “Forest City.” As you tour this beautiful city, wind your way to the hills above town to the site of Sendai Castle. Built in 1600 by the powerful feudal lord, Date Masamune, the castle has survived anti-feudal warfare, bombings of World War II and the powerful earthquake of 2011. Continue on to Zuihoden, the mausoleum of the Date clan, whose spectacular grounds and intricate design pay tribute to the powerful Masamune and his descendants. Just outside of the city, explore the secluded bay on the shores of Matsushima. Known as one of Japan’s three most scenic views, this gorgeous bay is dotted with pine-clad islets.

Meals included: breakfast, lunch, dinner

◇ DAY 17

Oarai / Mito City

Today long stretches of white-sand beaches welcome you to the seaside city of Oarai. Heading inland, visit Mito, a power base during the Edo period and best known today for Kairakuen Garden, considered one of Japan’s three finest landscape gardens. Originally created in 1841 for the ruling lord, the park was also intended for the enjoyment of all. Paths wind through 3,000 plum trees, cedar woods and a bamboo grove. Learn about the treasures of the samurai that went beyond swords and armor. The Tokugawa Museum houses exhibits which chronicle the life of the powerful Tokugawa family, as well as those who lived under their rule.

Meals included: breakfast, lunch, dinner

◇ DAY 18

Shimizu

Be on deck as the ship sails into Shimizu to get your closest view of Mt Fuji yet (weather permitting). Get your morning steps in as you climb the zigzag pathway of 1,200 steps to Kunozan Toshogu Shrine, enjoying beautiful views of the coastline as you go. For those feeling a little less inclined to embark on the stairs, you can take the ropeway to the top. This complex houses many bright-red buildings, accented in gold and adorned with colorful carvings—a dazzling vision. You may also choose to visit the Ukiyoe Museum, which houses a lovely collection of Edo-period works.

Meals included: breakfast, lunch, dinner

■ DAY 19

Osaka / Disembark Ship

Disembark in Osaka, the largest commercial center on the island of Honshu. Depart for the airport to connect to your flight home.

Meals included: breakfast

Westbound

Nome, Alaska → Osaka, Japan

2026 DEPARTURE DATES

Aboard *National Geographic Resolution*

20 Aug				
--------	--	--	--	--

Alternative Routes

Visit Expeditions.com for more information.

2027 Departure Dates

12 Jul



National Geographic Resolution

GUESTS

138

CABINS

76

The sister ship to *National Geographic Endurance*, she explores polar & temperate regions

Our second new polar build, *National Geographic Resolution*, is named to honor the second voyage of the legendary Captain James Cook. A fully-stabilized vessel of the highest ice class (PC5 Category A), she will enable adventurous guests to go where few have or can. Resolution's most striking exterior feature is her distinctive profile, the patented X-Bow®, a game-changing design that guarantees the smoothest, most comfortable ride in all kinds of conditions; and since it eliminates bow impact, a quieter ride, as well.

An equally impressive feature may well be her capacity: she carries just 138 guests, a commitment to expedition excellence over scale. Scandinavian-inflected, luxuriously appointed, her inviting interiors would be a destination in themselves. Because she is a Lindblad expedition ship, however, her attention is focused on the world outside – with acres of window glass to keep you connected to the stunning views beyond the pane, and a fleet of expedition tools to get you out exploring.

National Geographic Endurance and *National Geographic Resolution* are next-generation expedition ships. Purpose-built for polar navigation. Fully stabilized, highly strengthened, ice-class Polar Code PC5 (Category A) vessels, they are designed to navigate polar passages year-round, and safely explore uncharted waters, while providing exceptional comfort. The patented X-bow[®] is key to their design; its powerful wave-slicing action provides an extremely smooth ride even in adverse conditions, and even reduces spray on deck for superior observation. They carry a full suite of expedition tools, and offer a variety of experience enhancing amenities.

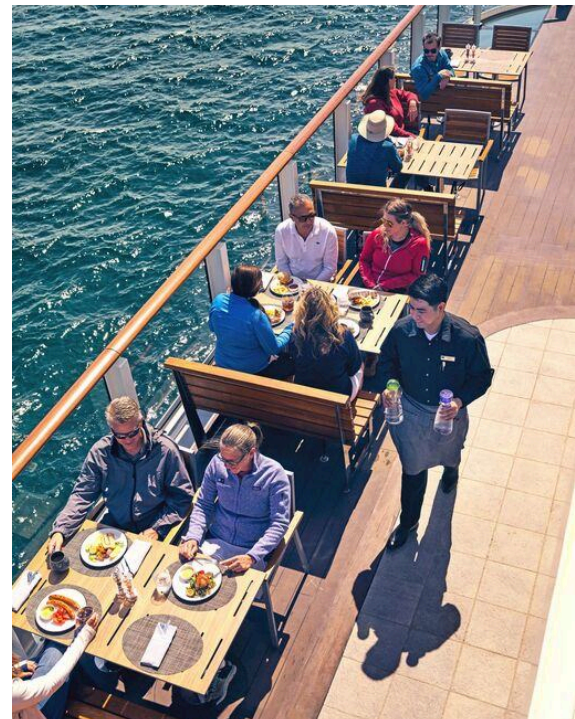

Cabin Categories

Category 1

FORE DECK #404, 406, 408, 411, 413, 415

Cabin with two large windows, two singles that can convert to a queen, writing desk and chair, two bedside tables, window sofa, coffee table, and a closet.



Category 2

FORE DECK #410, 412, 414, 416-419, 421-427

Cabin with two large windows, two single beds that can convert to a queen, window sofa, two-seat sofa, coffee table, writing desk with an office chair, two bedside tables, coffee table, and a closet.



Category 3

MAIN DECK #512-524

Cabin with balcony that features two balcony chairs, hammock, and a table; two single beds that convert to a queen; convertible sleeper sofa; writing desk with a chair; two bedside tables; coffee table; and a closet.



Category 4

LOUNGE DECK #608, 610, 612, 613-623

Cabin with balcony that features two balcony chairs, hammock and a table; two single beds that can convert to a queen; pull-out sofa; coffee table; writing desk with chair; two bedside tables; and a closet.



Category 5

BRIDGE DECK #700-707, 712, 713, 715, 717

Cabin with balcony that features two balcony chairs, hammock, and a table; two single beds that convert to a queen; convertible sleeper sofa; coffee table; writing desk with chair; two bedside tables; and a closet.



Category 6

BRIDGE DECK #714

Junior suite with balcony that features two balcony chairs, hammock, and table; two single beds that convert to a queen; pull-out sofa; writing desk with chair; two bedside tables; coffee table; espresso maker and a closet. Guests receive priority access to one spa treatment and one igloo reservation and complementary laundry per departure.



Category 7

BRIDGE DECK #708-711, 716, 718, 719, 721

These large balcony suites feature two balcony chairs, hammock, and table; two single beds that can convert to a queen; pull-out sofa; coffee table; writing desk and chair; espresso maker; and a large walk-in closet with full length mirror. Expanded bathroom has a double vanity, bathtub, towel warmer and rain shower. Guests receive priority access to one spa treatment and one igloo reservation and complementary laundry per departure.

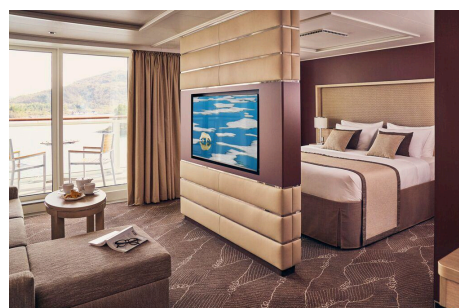

Category A Solo

MAIN DECK #504-510, 513

Cabin with balcony that features two balcony chairs, hammock, and a table; single bed; writing desk with an office chair; and a closet.



Category B Solo

LOUNGE DECK #604-607, 609, 611

Cabin with balcony that features two balcony chairs, hammock, and a table; single bed; writing desk with chair; hammock; and a closet.



Deck Plans

Observation Deck

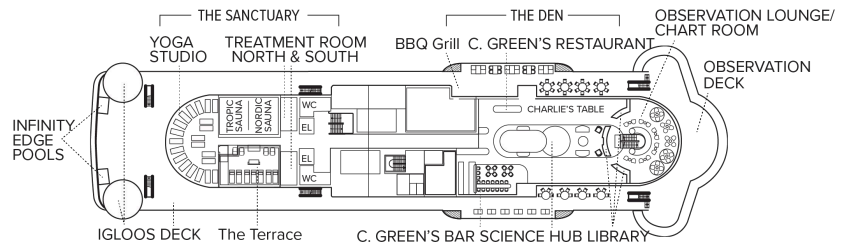

Bridge Deck

- Category 5
- Category 6
- Category 7

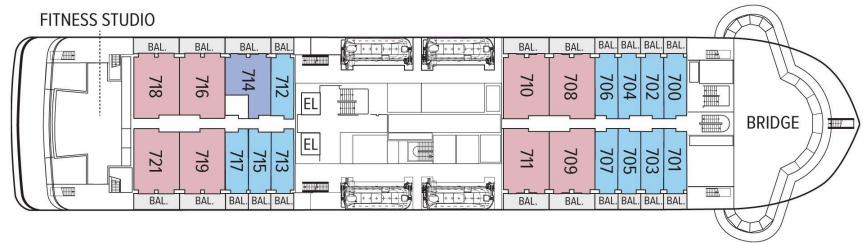

Lounge Deck

- Category 4
- Category B Solo

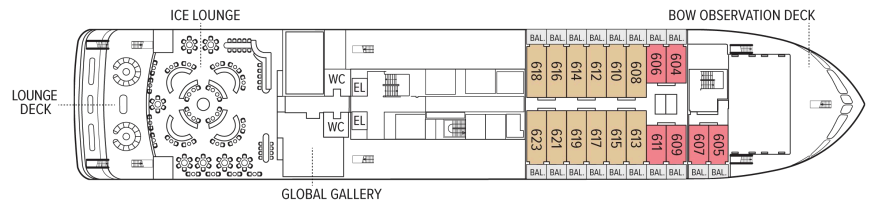

Main Deck

- Category 3
- Category 2 Solo

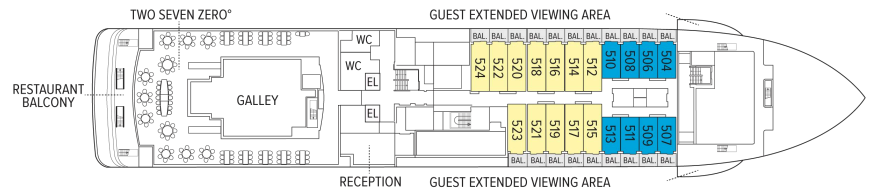

Fore Deck

- Category 1
- Category 2

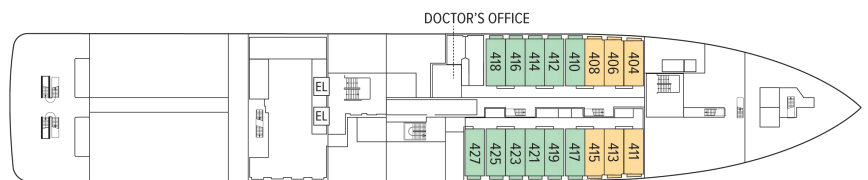

Expedition Deck

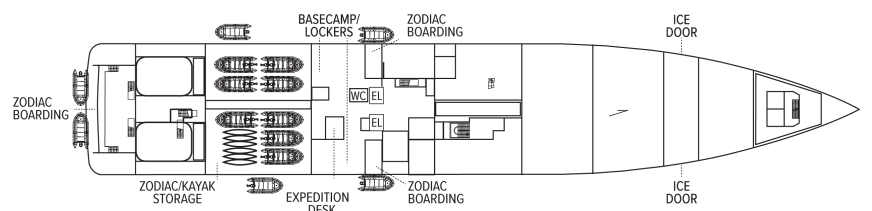

Ship Amenities

Public Areas

Reception; three dining areas; an observation lounge with bar, gym, wellness area, infinity-style outdoor hot tubs with adjacent igloos; library; main lounge with full service bar, 24-hour beverage station, state-of-the-art tech for films/presentations; OM System photo locker and a photo workshop area; science hub; an onboard broadcast studio; an expedition base with lockers for expedition gear; and open access to the Bridge, Captain, officers and on-duty wildlife spotters.

Meals

Restaurant 270° features wrap-around views; two other dining areas offer lighter, made-to-order fare or intimate, small group dinners. All feature sustainable choices, local where possible, and unassigned, flexible, inclusive seating.

Cabins

All cabins face outside with large windows, private bathroom, and climate controls. Cabins are equipped with expedition command centers with iPad tablets, multiple electrical and USB outlets, TVs, with on demand entertainment, phone, Wi-Fi, clock, barometers, hygrometers, vanity mirror, mini refrigerator, small safe, ice bucket, glasses, hair dryer, reading lights and National Geographic Atlas. Luxury linens and pillows. Bathrooms outfitted with Rain showers & hand held shower, botanically inspired shampoo, conditioner, shower gel and lotion. Complimentary insulated water bottles. Balcony cabins have hammocks, chairs and table.

Expedition Equipment

Zodiac landing craft, kayaks, snowshoes, cross-country skis, an ROV and underwater video camera for unique access to the polar undersea, hydrophone, aerial remote-controlled camera and video microscope.

Special Features

A full-time doctor, undersea specialist, National Geographic photographer, National Geographic-Lindblad Expeditions certified photo instructor and video chronicler, an internet cafe and laundry. A forward and aft staircase, and elevators, reach all decks. Echoing the pioneering installation aboard *National Geographic Endurance*, artist Zaria Forman has curated a new exhibit featuring a wide range of artists.



Wellness

A glass-enclosed yoga studio, gym, treatment rooms and spa relax area, and high and low-heat saunas with ocean views, staffed by wellness specialists.

Self-Disinfecting Ships

ACT Clean Coat™ is a light-activated, self-disinfecting cleaning process that continuously breaks down viruses, bacteria, mold, and airborne allergens across all ship surfaces. Not only does this create a cleaner, healthier shipboard environment for guests and crew alike, but this non-toxic, chemical-free system also saves more than one million gallons of water each year in our cleaning procedures, and reduces our carbon footprint as well as the amount of plastic and waste in our supply chain.

Special Offers

SAY YES—TO GOING WITHOUT SECOND THOUGHTS

Receive savings of \$1500 per guest deducted from cabin fare on select 2026 voyages when you pay in full at time of booking. Applicable savings will be deducted from cabin fare before any additional savings with the purchase of cabin fare. To qualify for the savings, nonrefundable payment in full is due at time of booking. This promotional offer is subject to separate terms and conditions. Standard cancellation, refund, and change policies do not apply. All amounts paid in connection with this promotion are non-refundable and non-transferable, regardless of cancellation date, and no refund, credit, or compensation will be provided except as expressly stated herein. Promotional offer valid on new bookings only for select 2026 departures, subject to availability and offer may be withdrawn at any time without prior notice, not applicable on airfare or extensions, and may not be combined with other promotions. Additional restrictions may apply.

SUITE EXCLUSIVES

Spacious living areas and incredible views immerse you in the beauty of your marine surroundings. Our new Suite Exclusives package helps make your voyage all the more memorable. [Learn more](#)

CELEBRATE LIFE'S MILESTONES

Celebrate a milestone with a group of eight or more and enjoy a special amenity package including: 5% savings on voyage fares, custom group photo, US\$150 shipboard credit for the group, and other special

gifts. Milestone celebration to be communicated at time of booking.

10% OFF BACK-TO-BACK VOYAGES

Save 10% on consecutive departures, applicable on voyage fares only and not valid on extensions or airfare. Valid for new bookings only, subject to availability, and may not be combined with other offers. Call for details.

SAVE 5% TRAVELING AS A GROUP

Save 5% when traveling as a group of 8 or more people. Valid for new bookings only on select departures, subject to availability, not applicable on extensions, and may not be combined with other offers. Call for details.

PAY BY DEBIT: EARN A \$100 ONBOARD CREDIT

The \$100 onboard credit offer is applied after the final payment and requires 85% of the cost of the voyage to be placed on a debit card. Maximum of one \$100 onboard credit per cabin. The \$100 onboard credit is a non-refundable, non-transferable credit that can be used for various onboard purchases such as global gallery and spa treatments. It has no cash value, cannot be refunded if not fully utilized, and will be forfeited if not fully redeemed by the end of the voyage. This offer is combinable with other offers. If the booking is altered or canceled, the onboard credit may be forfeited, and it cannot be transferred if the booking is moved to another guest. Lindblad Expeditions reserves the right to modify or cancel the offer without prior notice. Offer applies to

Lindblad Expeditions' owned ships only. Offer valid only for Debit Cards issued in the United States for payments made from the United States.

COMBINING OFFERS

Certain offers may be combinable, up to two savings opportunities, except where noted otherwise.

For example, travel with a group of 8 or more on back-to-back expeditions, and take advantage of both savings.

INCLUDED IN PRICE

All accommodations aboard ship or in hotels per itinerary; all meals as indicated in the itinerary, both aboard and onshore; beer, wine, cocktails, liquors and spirits aboard the ship (except certain premium brands which are available for purchase); hors d'oeuvres, 24-hour access to snacks, premium coffees and teas, non-alcoholic beverages, and filtered water; excursions and airport transfers to and from recommended flights, as indicated in the itinerary; crew gratuities; exploration tools curated to destination, such as Zodiacs and kayaks; guidance and company of our leading expedition staff; assistance by the National Geographic Photographer and Lindblad Expeditions-National Geographic certified photo instructor; access to the OM System Photo Gear Locker; presentations by expedition staff and expert guest speakers; complimentary reusable water bottle; onboard physician consultations; morning stretch classes and 24-hour access to exercise equipment; 24-hour access to lounges, observation decks, library, and other shared spaces; park and site entrance fees, special access permits, and port taxes. Unused services or items included in our programs are non-refundable.

NOT INCLUDED IN PRICE

Airfare (except flights* when indicated as included); pre- and post-expedition extensions; additional hotel nights (except when indicated as included); private transfers; laundry, spa treatments, Wi-Fi, and phone services (except when indicated as included); travel protection plans; and passport, visa, and immigration fees.

*Recommended flight costs include flight(s) that take place during the date range of your trip to transport travelers from one itinerary destination to another. This

cost also includes ground transportation, luggage transfer, and airport assistance. If you prefer to arrange your own flights privately, have alternate means of transport, or wish to modify at a later time, please contact an Expedition Specialist at 1.833.400.0831

Additional costs associated with medical services outside onboard physician consultation.

TRAVEL PROTECTION PLAN

We strongly recommend our guests to take advantage of our Travel Protection Plan. This plan offers comprehensive coverage to protect you from cancellation fees, costs incurred due to trip delays/interruption, damage or loss of baggage, medical assistance, and evacuation during your travels. Our Travel Protection Plan is available for U.S. residents only, and may be purchased any time prior to final payment due date, Travel Protection premiums are non-refundable once plan is purchased. Learn more about our Travel Protection "Plus" Plan: <https://www.expeditions.com/terms-conditions/travel-protection-plan/>

CANCELLATION POLICY

Review our cancellation policy: <https://www.expeditions.com/cancellation-policy/>