



 Arctic & North America  
67° 0' N 50° 43' W

## Northwest Passage: Greenland to Alaska

Embark on an epic journey across the Northwest Passage from Greenland to Alaska, and follow in the footsteps of intrepid explorers who searched for centuries for a northwest route connecting the Atlantic and Pacific oceans. Experience this epic quest aboard *National Geographic Resolution* and discover the otherworldly landscapes that challenged generations of adventurers.

From  
**\$ 47,813** / per person  
Does not include flights

	<b>DATES</b> Jul		<b>DURATION</b> 23 Days
	<b>SHIPS</b> <i>National Geographic Resolution</i>		
	<b>STARTS AT</b> Nuuk, Greenland	→	 <b>ENDS AT</b> Nome, Alaska

**Itinerary note:** 2025 Westbound is 23 days since it allows for a direct charter flight from Nome to Anchorage for immediate onward travel, while 2025 Eastbound is 24 days due to a necessary hotel night in Reykjavik, after the charter flight from Nuuk, before onward travel.

## Highlights

- ★ Venture into the fabled Northwest Passage and learn dramatic stories of explorers and adventurers who sought this magnificent, icy frontier
- ★ Glide between soaring icebergs at the mouth of Greenland's Ilulissat Icefjord, a UNESCO World Heritage site
- ★ Visit a handful of remote Inuit communities throughout the Passage who continue to carve out life in the demanding landscape
- ★ Observe polar bears, walruses, ringed seals, belugas, and bowhead whales—and, with luck, the elusive narwhal







## Day by day

### ■ DAY 1

#### Reykjavík, Iceland

Arrive in Reykjavík, the world's northernmost capital, which lies just below the Arctic Circle. Transfer from the airport to the city and spend the day exploring at your own pace. Check in with the hospitality desk this afternoon to make final arrangements before your charter flight the following day.

### ◇ DAY 2

#### Reykjavík / Nuuk, Greenland / Embark Ship

Fly from Reykjavík by chartered aircraft to Nuuk, Greenland's capital thriving capital city. Settle into your cabin and enjoy a scenic sailing out of the Nuuk fjord and into the open water of the Davis Strait, as we navigate north along the coastline.

Meals included: breakfast, lunch, dinner

### ◇ DAY 3

#### Greenland's West Coast and Sisimiut

The massive ice sheet that blankets much of Greenland feeds dozens of fjords and glaciers on the dramatic western coast. Be on the lookout for humpback and minke whales as you trace these rugged shores. During a stop at the former whaling port of Sisimiut, visit the local museum and stroll among the town's 18th-century wooden buildings.

Meals included: breakfast, lunch, dinner

### ◇ DAY 4

#### Disko Bay / Ilulissat

Sail into Disko Bay to explore the World Heritage-listed Ilulissat Icefjord, a tongue of the Greenland ice sheet that extends to the bay. Here,

the Sermeq Kujalleq glacier calves enormous amounts of ice at an astonishing rate, releasing icebergs that can soar up to 300 feet. A cruise among these gigantic sculptures of ice is a highlight of your voyage. Explore the remains of the historic fishing village of Sermermiut and take in spectacular views of the ice-laden mouth of the fjord.

Meals included: breakfast, lunch, dinner

### ◇ DAYS 5-7

#### Exploring East Baffin Island, Nunavut, Canada

Begin your exploration of the Canadian High Arctic with a visit to the small Inuit community of Pond Inlet, Nunavut. Explore some of the beautiful bays and inlets along Baffin Island's Lancaster Sound, a favorite Inuit hunting and fishing location for hundreds of years. Carved by Ice Age glaciers, Lancaster Sound is also the eastern gateway to the Arctic Archipelago, where European explorers like William Baffin first ventured in the 17th century to search for the Northwest Passage. Days here are spent searching for ringed seals, arctic foxes, walruses and polar bears, as well as beluga and bowhead whales. Visit Devon Island and take a walk with the ship's archaeologist to learn about the Thule people—ancestors of the modern Inuit—that once inhabited this region.

Meals included: breakfast, lunch, dinner

### ◇ DAYS 8-17

#### Exploring the Northwest Passage

Your ice-strengthened ship, *National Geographic Resolution*, navigates the Northwest Passage following nature's path—dependent on ice and weather conditions. Taking cues from nature, you'll follow wildlife, stop for hikes on the tundra or drop anchor in a beautiful fjord or an icy bay to explore

and kayak beneath massive ice sculptures and soaring cliffs.

Along the way, explore ice-studded channels and glacier-carved islands that stretch for hundreds of miles—a stunning display of raw geology; sail past the northernmost part of mainland North America in the Bellot Strait, one of the narrowest and most infamous of the passage; and cross the top of the Northwest Territory of Canada to search for ringed seals, arctic foxes, musk oxen, walruses and polar bears, as well as beluga and bowhead whales.

History and culture are also on the itinerary. Learn about the Inuit peoples who have hunted and fished here for thousands of years. And hear heroic stories of the early explorers: Roald Amundsen, John Ross, William Edward Parry and James Clark Ross, among others.

Meals included: breakfast, lunch, dinner

#### ◇ DAY 18

### At Sea

Indulge in *National Geographic Resolution's* amenities as you continue along the shores of the Canadian High Arctic. Soak in the ship's infinity-style outdoor hot tubs, take in panoramic views from the rooftop observation deck and enjoy talks from onboard experts. Take time to reflect on the amazing wildlife and geology that have highlighted your journey so far.

Meals included: breakfast, lunch, dinner

#### ◇ DAY 19

### Herschel Island, Yukon Territory

Once a thriving whaling village off the coast of the Yukon Territory, Herschel Island is now classified as a Natural Environmental Park. The island protects the wildlife alongside the heritage of the Inuvialuit people and the whaling industry. As you wander through Herschel's historic dwellings, keep an eye

out for the wildlife residents, which include bears, musk oxen and arctic foxes. The area is also home to the largest colony of black guillemots in the Western Arctic.

Meals included: breakfast, lunch, dinner

#### ◇ DAYS 20-22

### At Sea

As we continue to sail westward along the northern coast of Alaska, reflect on our adventures while scanning the water for marine life and enjoying life on board. Take a yoga class, unwind with a massage in the wellness center, and curl up next to the fireplace in the library. Share images with your National Geographic-Lindblad Expeditions certified photography instructor, and marvel at footage captured by the ship's underwater camera. Our voyage culminates with a farewell dinner on board.

Meals included: breakfast, lunch, dinner

#### ■ DAY 23

### Nome, Alaska, U.S. / Disembark Ship / Home

Arrive in the remote city of Nome, Alaska, on the coast of the Bering Sea. Disembark and take a charter flight to Anchorage. In Anchorage, transfer to flights home.

Meals included: breakfast, lunch

### Westbound

Nuuk, Greenland → Nome, Alaska

### 2025 Departure Dates

Aboard *National Geographic Resolution*

04 Aug

### 2026 Departure Dates

Aboard *National Geographic Resolution*

29 Jul

### Alternative Routes

Visit [Expeditions.com](http://Expeditions.com) for more information.

### 2025 Departure Dates

25 Aug



## ***National Geographic Resolution***

---

**Guests**

138

**Cabins**

76

---

**The sister ship to *National Geographic Endurance*,  
she explores polar & temperate regions**

Our second new polar build, *National Geographic Resolution*, is named to honor the second voyage of the legendary Captain James Cook.

A fully-stabilized vessel of the highest ice class (PC5 Category A), she will enable adventurous guests to go where few have or can. *Resolution's* most striking exterior feature is her distinctive profile, the patented X-Bow®, a game-changing design that guarantees the smoothest, most comfortable ride in all kinds of conditions; and since it eliminates bow impact, a quieter ride, as well.



An equally impressive feature may well be her capacity: she carries just 138 guests, a commitment to expedition excellence over scale. Scandinavian-inflected, luxuriously appointed, her inviting interiors would be a destination in themselves. Because she is a Lindblad expedition ship, however, her attention is focused on the world outside— with acres of window glass to keep you connected to the stunning views beyond the pane, and a fleet of expedition tools to get you out exploring.

*National Geographic Endurance* and *National Geographic Resolution* are next-generation expedition ships. Purpose-built for polar navigation. Fully stabilized, highly strengthened, ice-class Polar Code PC5 (Category A) vessels, they are designed to navigate polar passages year-round, and safely explore uncharted waters, while providing exceptional comfort. The patented X-bow<sup>®</sup> is key to their design; its powerful wave-slicing action provides an extremely smooth ride even in adverse conditions, and even reduces spray on deck for superior observation. They carry a full suite of expedition tools, and offer a variety of experience enhancing amenities.

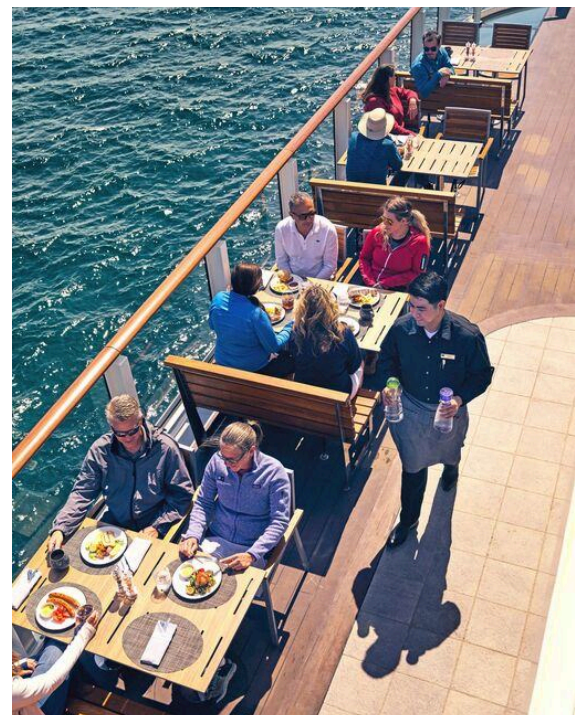



# Cabin Categories

## Category 1

**Fore Deck:** #404, 406, 408, 411, 413, 415

Cabin with two large windows, two singles that can convert to a queen, writing desk and chair, two bedside tables, window sofa, coffee table, and a closet.



## Category 2

**Fore Deck:** #410, 412, 414, 416-419, 421-427

Cabin with two large windows, two single beds that can convert to a queen, window sofa, two-seat sofa, coffee table, writing desk with an office chair, two bedside tables, coffee table, and a closet.



## Category 3

**Main Deck:** #512, 514-524

Cabin with balcony that features two balcony chairs, hammock, and a table; two single beds that convert to a queen; convertible sleeper sofa; writing desk with a chair; two bedside tables; coffee table; and a closet.



## Category 4

**Lounge Deck:** #608, 610, 612, 613-623

Cabin with balcony that features two balcony chairs, hammock and a table; two single beds that can convert to a queen; pull-out sofa; coffee table; writing desk with chair; two bedside tables; and a closet.



## Category 5

**Bridge Deck:** #700-707, 712, 713, 715, 717

Cabin with balcony that features two balcony chairs, hammock, and a table; two single beds that convert to a queen; convertible sleeper sofa; coffee table; writing desk with chair; two bedside tables; and a closet.



## Category 6

**Bridge Deck:** #714

Junior suite with balcony that features two balcony chairs, hammock, and table; two single beds that convert to a queen; pull-out sofa; writing desk with chair; two bedside tables; coffee table; espresso maker and a closet. Guests receive priority access to one spa treatment and one igloo reservation and complementary laundry per departure.

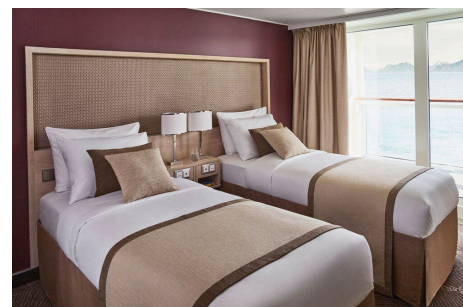

## Category 7

**Bridge Deck:** #708-711, 716, 718, 719, 721

These large balcony suites feature two balcony chairs, hammock, and table; two single beds that can convert to a queen; pull-out sofa; coffee table; writing desk and chair; espresso maker; and a large walk-in closet with full length mirror. Expanded bathroom has a double vanity, bathtub, towel warmer and rain shower. Guests receive priority access to one spa treatment and one igloo reservation and complementary laundry per departure.

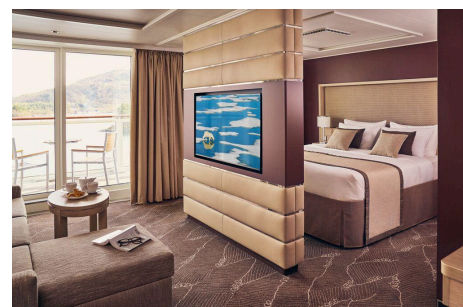

## Category A Solo

**Main Deck:** #504, 506-511, 513

Cabin with balcony that features two balcony chairs, hammock, and a table; single bed; writing desk with an office chair; and a closet.



## Category B Solo

**Lounge Deck:** #604-607, 609, 611

Cabin with balcony that features two balcony chairs, hammock, and a table; single bed; writing desk with chair; hammock; and a closet.



## Observation Deck

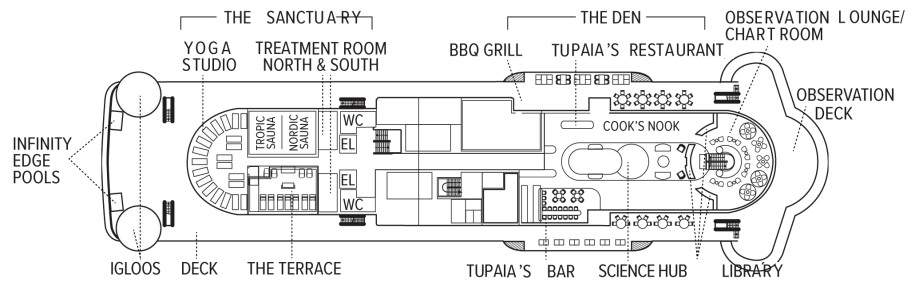

## Bridge Deck

- Category 5
- Category 6
- Category 7

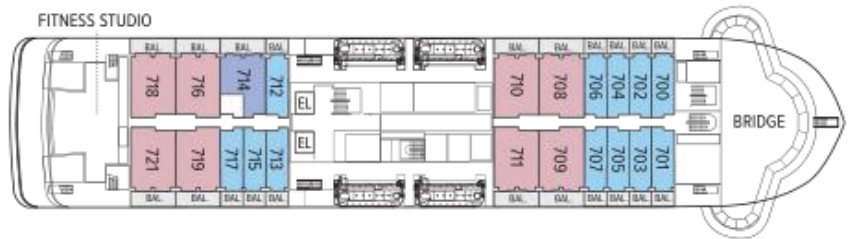

## Lounge Deck

- Category 4
- Category B Solo

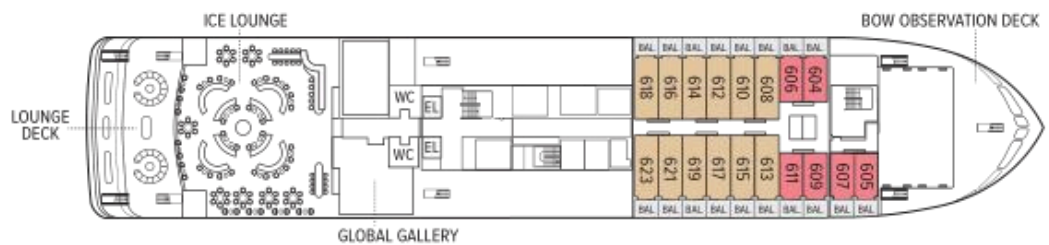

## Main Deck

- Category 3
- Category A Solo



## Fore Deck

- Category 1
- Category 2



## Expedition Deck

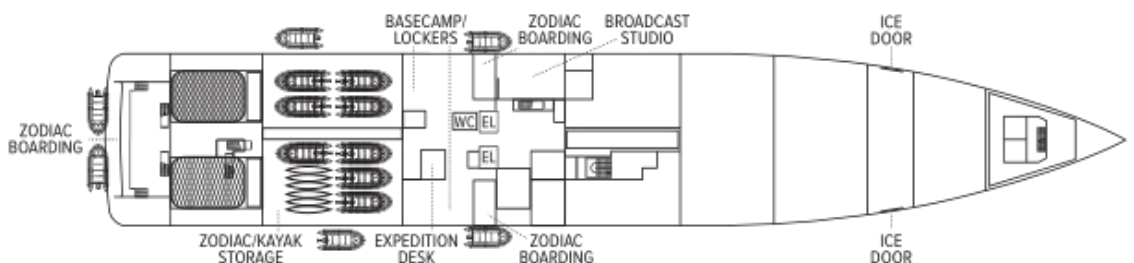



# Ship amenities

## Public Areas

Reception; three dining areas; an observation lounge with bar, gym, wellness area, infinity-style outdoor hot tubs with adjacent igloos; library; main lounge with full service bar, 24-hour beverage station, state-of-the-art tech for films/presentations; B&H Photo locker and a photo workshop area; science hub; an onboard broadcast studio; an expedition base with lockers for expedition gear; and open access to the Bridge, Captain, officers and on-duty wildlife spotters.

## Meals

Restaurant 270° features wrap-around views; two other dining areas offer lighter, made-to-order fare or intimate, small group dinners. All feature sustainable choices, local where possible, and unassigned, flexible, inclusive seating.

## Cabins

All cabins face outside with large windows, private bathroom, and climate controls. Cabins are equipped with expedition command centers with iPad tablets, multiple electrical and USB outlets, TVs, with on demand entertainment, phone, Wi-Fi, clock, barometers, hygrometers, vanity mirror, mini refrigerator, small safe, ice bucket, glasses, hair dryer, reading lights and National Geographic Atlas. Luxury linens and pillows. Bathrooms outfitted with Rain showers & hand held shower, botanically inspired shampoo, conditioner, shower gel and lotion. Complimentary insulated water bottles. Balcony cabins have hammocks, chairs and table.

## Expedition Equipment

Zodiac landing craft, kayaks, snowshoes, cross-country skis, an ROV and underwater video camera for unique access to the polar undersea, hydrophone, aerial remote-controlled camera and video microscope.

## Special Features

A full-time doctor, undersea specialist, National Geographic photographer, Lindblad-National Geographic certified photo instructor and video chronicler, an internet cafe and laundry. A forward and aft staircase, and elevators, reach all decks. Echoing the pioneering installation aboard *National Geographic Endurance*, artist Zaria Forman has curated a new exhibit, featuring a wide range of artists.



## Wellness

A glass-enclosed yoga studio, gym, treatment rooms and spa relax area, and high and low-heat saunas with ocean views, staffed by wellness specialists.

## Self-Disinfecting Ships

ACT Clean Coat™ is a light-activated, self-disinfecting cleaning process that continuously breaks down viruses, bacteria, mold, and airborne allergens across all ship surfaces. Not only does this create a cleaner, healthier shipboard environment for guests and crew alike, but this non-toxic, chemical-free system also saves more than one million gallons of water each year in our cleaning procedures, and reduces our carbon footprint as well as the amount of plastic and waste in our supply chain.

## Special Offers

### 60% reduced deposit for any 2026 voyage

Book between June 3 and August 1, 2025 and receive 60% off the deposit due at the time of booking. Remaining deposit balance is due at the time of final payment. Additional restrictions may apply. Offer valid for new bookings only on 2026 departures, subject to availability and offer may be withdrawn at any time without prior notice, not applicable on airfare or extensions, and may not be combined with other offers. Call for details.

### SUITE EXCLUSIVES

Spacious living areas and incredible views immerse you in the beauty of your marine surroundings. Our new Suite Exclusives package helps make your voyage all the more memorable. [Learn more](#)

### SAVE 5% TRAVELING AS A GROUP

Save 5% when traveling as a group of eight or more people. Valid on voyage fares only and not applicable on extensions or airfare. Deposit, final payments, and cancellation policies for group travel vary from our regular policies. Valid for new bookings only, subject to availability, and may not be combined with other offers. Call for details.

### CELEBRATE LIFE'S MILESTONES

Celebrate a milestone with a group of eight or more and enjoy a special amenity package including: 5% savings on voyage fares, custom group photo, US\$150 shipboard credit for the group, and other special gifts. Milestone celebration to be communicated at time of booking.

### PAY BY DEBIT: EARN A \$100 ONBOARD

## CREDIT

The \$100 onboard credit offer is applied after the final payment and requires 85% of the cost of the voyage to be placed on a debit card. Maximum of one \$100 onboard credit per cabin. The \$100 onboard credit is a non-refundable, non-transferable credit that can be used for various onboard purchases such as global gallery and spa treatments. It has no cash value, cannot be refunded if not fully utilized, and will be forfeited if not fully redeemed by the end of the voyage. This offer is combinable with other offers. If the booking is altered or canceled, the onboard credit may be forfeited, and it cannot be transferred if the booking is moved to another guest. Lindblad Expeditions reserves the right to modify or cancel the offer without prior notice. Offer applies to Lindblad Expeditions' owned ships only. Offer valid only for Debit Cards issued in the United States for payments made from the United States.

## COMBINING OFFERS

Certain offers may be combinable, up to two savings opportunities, except where noted otherwise. For example, travel with a group of 8 or more on back-to-back expeditions, and take advantage of both savings.

## Included in price

All accommodations aboard ship or in hotels per itinerary; all meals as indicated in the itinerary, both aboard and onshore; beer, wine, cocktails, liquors and spirits aboard the ship (except certain premium brands which are available for purchase); hors d'oeuvres, 24-hour access to snacks, premium coffees and teas, non-alcoholic beverages, and filtered water; excursions and airport transfers to and from recommended flights, as indicated in the itinerary; crew gratuities; exploration tools curated to destination, such as Zodiacs, kayaks, guidance and company of our leading expedition staff; assistance by the National Geographic Photographer and Lindblad Expeditions-National Geographic certified photo instructor; access to the OM System Photo Gear Locker; presentations by expedition staff and expert guest speakers; complimentary parka or jacket, complimentary reusable water bottle; onboard physician consultations; morning stretch classes and 24-hour access to exercise equipment; 24-hour access to lounges, observation decks, library, and other shared spaces; park and site entrance fees, special access permits, and port taxes. Unused services or items included in our programs are non-refundable.

## Not included in price

Airfare (except flights\* when indicated as included); pre- and post-expedition extensions; additional hotel nights (except when indicated as included); private transfers; laundry, spa treatments, Wi-Fi, and phone services (except when indicated as included); travel protection plans; and passport, visa, and immigration fees.

\*Recommended flight costs include flight(s) that take place during the date range of your trip to transport travelers from one itinerary destination to another. This cost also includes ground transportation, luggage transfer, and airport assistance. If you prefer to arrange your own flights privately, have alternate means of transport, or wish to modify at a later time, please contact an Expedition Specialist at 1.833.400.0831

Additional costs associated with medical services outside onboard physician consultation.

We strongly recommend our guests to take advantage of our Travel Protection Plan. This plan offers comprehensive coverage to protect you from cancellation fees, costs incurred due to trip delays/interruption, damage or loss of baggage, medical assistance, and evacuation during your travels. Our Travel Protection Plan is available for U.S. residents only, and may be purchased any time prior to final payment due date, Travel Protection premiums are non-refundable once plan is purchased. Learn more about our Travel Protection "Plus" Plan: <https://www.expeditions.com/terms-conditions/travel-protection-plan/>

## Cancellation policy

Review our cancellation policy: <https://www.expeditions.com/cancellation-policy/>

## Travel protection plan