



Asia & Japan
 34° 41' N 135° 30' E

Japan's Western Shores: Ancient Traditions and Natural Beauty

Exploring the storied waters between Japan and Korea reveals coastlines shaped by ancient kingdoms, maritime trade and deeply layered cultural traditions. This voyage brings you into places where spiritual rituals, everyday craftsmanship and coastal life remain closely tied to the land—whether in mountain-ringed northern villages or along quiet rural shores. With unhurried time in small ports, you'll meet local experts, witness heritage in its authentic context and gain a deeper understanding of how these communities have evolved at the edge of sea and sky.

From
\$ 20,900 / per person
 Does not include flights

DATES Jun	DURATION 16 Days
SHIPS <i>National Geographic Resolution</i>	
STARTS AT Osaka, Japan	ENDS AT Sapporo, Japan

Highlights

- ★ Step inside historic temples and cliffside shrines with cultural specialists who illuminate their enduring significance
- ★ Explore traditional districts where artisans continue centuries-old craftsmanship
- ★ Experience traditional Japan in Kanazawa's historic neighborhoods, from the samurai district to the teahouse district
- ★ Walk the canyons and hiking trails of Toyama's Northern Alps





Day by day

■ DAY 1

Osaka, Japan

Arrive in Osaka and transfer to your hotel.

◇ DAY 2

Osaka / Embark Ship

Travel to Himeji Castle, one of Japan’s most iconic fortresses. Also known as “White Heron Castle,” this UNESCO World Heritage site—flanked by the lush Koko-en Garden—is at once imposing and elegant. After lunch, transfer to the ship for embarkation.

Meals included: breakfast, lunch, dinner

◇ DAY 3

Mitarai

Located in the Seto Inland Sea, Mitarai is a seaside village that has remained largely untouched by the rapid changes and development of the 20th century. The village’s wooden buildings and narrow lanes reflect centuries of history, while its mature gardens lend additional beauty and serenity to the sheltered bay. Explore this hidden gem, designated as a Historic Preservation District of Traditional Architecture.

Meals included: breakfast, lunch, dinner

◇ DAY 4

Miyajima

Arrive on the island of Miyajima, home of Itsukushima Shrine, a UNESCO World Heritage site famed for its red *torii* gate that seems to float atop the water at high tide. Walk the seaside promenade and capture photos of the famous shrine from many different angles, or find time along the shore for reflection.

Meals included: breakfast, lunch, dinner

◇ DAY 5

Moji

With its position along the historic route between Honshu and Shanghai, Moji has a long history as a prominent trading post. As modern shipping shifted to a newer harbor, the district settled into a gentler rhythm, allowing its heritage to take center stage. Step back in time as you stroll the promenade, exploring the well-preserved buildings of the Meiji and Taisho periods. Moji is also known for its limestone caves, and you’ll have the chance to explore one of these remarkable formations to witness the region’s stunning geology.

Meals included: breakfast, lunch, dinner

◇ DAY 6

Busan, South Korea / Gyeongju

Dock in Busan and travel to Gyeongju, the ancient capital of the Silla kingdom and the crown jewel of Korea’s cultural heritage. Filled with ruins of temples, pagodas and palaces dating back more than a thousand years, the city’s historic areas have been collectively designated a UNESCO World Heritage site. Visit Bulguksa Temple, a masterpiece of Silla architecture originally built in A.D. 528, and explore the Gyeongju National Museum to view jewelry, weapons and other Silla artifacts. See Cheomseongdae, a seventh-century observatory, and wander among the area’s towering royal burial mounds.

Meals included: breakfast, lunch, dinner

◇ DAY 7

Matsue, Japan

Sail up the coast to Matsue, set gracefully between

a lake, a lagoon and the sea. Tour the 17th-century Matsue Castle, a defensive fortress renowned for its ingenious architectural features designed to deter attackers. Continue to the Adachi Museum of Art, where an impressive collection of 20th-century Japanese works is complemented by a meticulously crafted traditional garden.

Meals included: breakfast, lunch, dinner

◇ DAY 8

Kanazawa

Step into old Japan in Kanazawa, once a powerful stronghold of the Maeda clan. Stroll past the elegant wooden samurai homes of the Nagamachi district, where intentionally narrow, winding streets were designed to confuse would-be attackers. Continue to the geisha and teahouse district of Higashi Chaya Machi before wandering the pathways of Kenroku-en, one of Japan’s designated “three best landscape gardens.” Established in 1676 by the Maeda family and refined over more than 150 years, it remains a masterpiece of Japanese garden design.

Meals included: breakfast, lunch, dinner

◇ DAY 9

Fushiki, Toyama

Toyama Bay is framed by the Amaharashi coast to the west and the Tateyama mountains to the east. Tracing the coastline is a photographer’s dream, with sweeping views of the peaks rising beyond the bay and oceanfront walkways that invite you to slow down and soak in village life.

Meals included: breakfast, lunch, dinner

◇ DAY 10

Sado Island

Known for its unique blend of rich history and vibrant local culture, Sado Island offers a range of ways to engage with its heritage. Explore the

island’s ancient taiko drumming tradition and trace its 400-year history of gold mining.

Meals included: breakfast, lunch, dinner

◇ DAY 11

Niigata

Sitting on the western shore of Honshu, Niigata is a historic rice port surrounded by mountains whose meltwater nourishes the coastal fields. This landscape has long shaped Niigata’s reputation for exceptional rice and sake production. Delve into this rich tradition, or venture to the countryside to witness the rice fields firsthand.

Meals included: breakfast, lunch, dinner

◇ DAY 12

Sakata

Once home to Japan’s wealthiest merchant family, the city of Sakata offers a glimpse into 400 years of trade and maritime prosperity. Walk these storied streets to see preserved merchant homes, visit historic facades of rice warehouses and trace the lasting influence of the *Kitamaebune*—merchant ships that once connected communities across the Sea of Japan.

Meals included: breakfast, lunch, dinner

◇ DAY 13

Aomori

On the northern coast of Honshu lies Aomori City, set against the distant backdrop of the Hakkōda Mountains. This bountiful region is renowned for its apple orchards, exceptional seafood and local treasures, such as Tsugaru lacquerware and painted kites. Explore the tranquil Seiryū-ji Temple, with its impressive bronze statue of Dainichi Nyorai. Then learn about Nebuta Matsuri—Aomori’s vibrant summer festival—and see the extraordinary craftsmanship of its colorful papier-mâché floats up close.

Meals included: breakfast, lunch, dinner

◇ DAY 14

Southern Hokkaido Island

At the southern tip of Hokkaido, the Oshima subprefecture greets us after a morning at sea. Rapid modernization in the late 1800s left the region with a distinctive blend of contemporary development, traditional fishing villages and the castles and fortifications of earlier eras. Explore the preserved buildings and stone walls of historic landmarks, or take time to soak in the natural landscapes overlooking the Tsugaru Strait.

Meals included: breakfast, lunch, dinner

◇ DAY 15

Otaru / Sapporo

The capital of the Hokkaido prefecture, Sapporo is known for its more relaxed, open atmosphere. This afternoon, enjoy its museums and airy parks, and sample the region's culinary delicacies.

Meals included: breakfast, lunch, dinner

■ DAY 16

Otaru / Disembark Ship

Following breakfast, disembark and transfer to the airport for flights home.

Meals included: breakfast

Expedition

Osaka, Japan → Sapporo, Japan

2027 DEPARTURE DATES

Aboard *National Geographic Resolution*

28 Jun				
--------	--	--	--	--



National Geographic Resolution

GUESTS

138

CABINS

76

The sister ship to *National Geographic Endurance*, she explores polar & temperate regions

Our second new polar build, *National Geographic Resolution*, is named to honor the second voyage of the legendary Captain James Cook. A fully-stabilized vessel of the highest ice class (PC5 Category A), she will enable adventurous guests to go where few have or can. Resolution's most striking exterior feature is her distinctive profile, the patented X-Bow®, a game-changing design that guarantees the smoothest, most comfortable ride in all kinds of conditions; and since it eliminates bow impact, a quieter ride, as well.

An equally impressive feature may well be her capacity: she carries just 138 guests, a commitment to expedition excellence over scale. Scandinavian-inflected, luxuriously appointed, her inviting interiors would be a destination in themselves. Because she is a Lindblad expedition ship, however, her attention is focused on the world outside – with acres of window glass to keep you connected to the stunning views beyond the pane, and a fleet of expedition tools to get you out exploring.

National Geographic Endurance and *National Geographic Resolution* are next-generation expedition ships. Purpose-built for polar navigation. Fully stabilized, highly strengthened, ice-class Polar Code PC5 (Category A) vessels, they are designed to navigate polar passages year-round, and safely explore uncharted waters, while providing exceptional comfort. The patented X-bow[®] is key to their design; its powerful wave-slicing action provides an extremely smooth ride even in adverse conditions, and even reduces spray on deck for superior observation. They carry a full suite of expedition tools, and offer a variety of experience enhancing amenities.

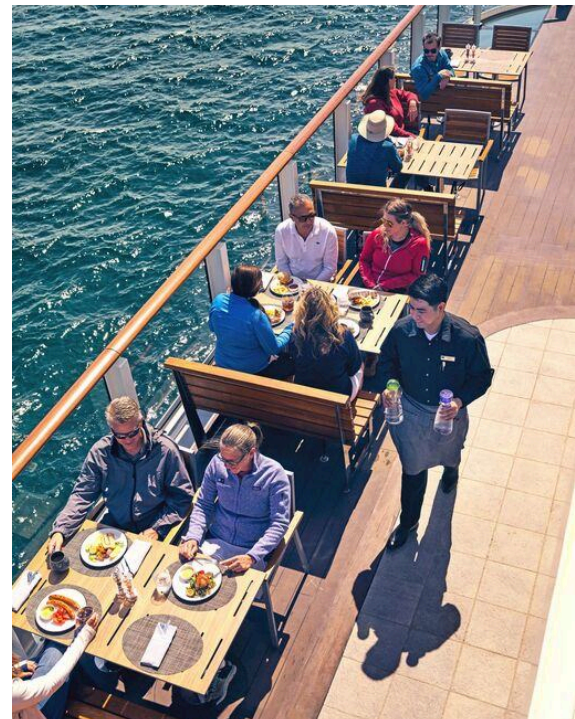

Cabin Categories

Category 1

FORE DECK #404, 406, 408, 411, 413, 415

Cabin with two large windows, two singles that can convert to a queen, writing desk and chair, two bedside tables, window sofa, coffee table, and a closet.



Category 2

FORE DECK #410, 412, 414, 416-419, 421-427

Cabin with two large windows, two single beds that can convert to a queen, window sofa, two-seat sofa, coffee table, writing desk with an office chair, two bedside tables, coffee table, and a closet.



Category 3

MAIN DECK #512-524

Cabin with balcony that features two balcony chairs, hammock, and a table; two single beds that convert to a queen; convertible sleeper sofa; writing desk with a chair; two bedside tables; coffee table; and a closet.



Category 4

LOUNGE DECK #608, 610, 612, 613-623

Cabin with balcony that features two balcony chairs, hammock and a table; two single beds that can convert to a queen; pull-out sofa; coffee table; writing desk with chair; two bedside tables; and a closet.



Category 5

BRIDGE DECK #700-707, 712, 713, 715, 717

Cabin with balcony that features two balcony chairs, hammock, and a table; two single beds that convert to a queen; convertible sleeper sofa; coffee table; writing desk with chair; two bedside tables; and a closet.



Category 6

BRIDGE DECK #714

Junior suite with balcony that features two balcony chairs, hammock, and table; two single beds that convert to a queen; pull-out sofa; writing desk with chair; two bedside tables; coffee table; espresso maker and a closet. Guests receive priority access to one spa treatment and one igloo reservation and complementary laundry per departure.



Category 7

BRIDGE DECK #708-711, 716, 718, 719, 721

These large balcony suites feature two balcony chairs, hammock, and table; two single beds that can convert to a queen; pull-out sofa; coffee table; writing desk and chair; espresso maker; and a large walk-in closet with full length mirror. Expanded bathroom has a double vanity, bathtub, towel warmer and rain shower. Guests receive priority access to one spa treatment and one igloo reservation and complementary laundry per departure.

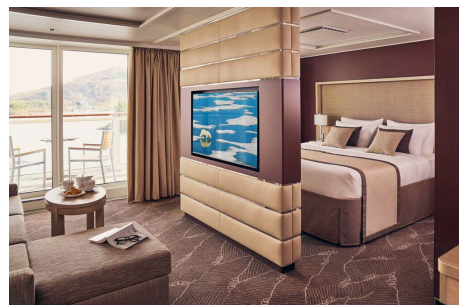

Category A Solo

MAIN DECK #504-510, 513

Cabin with balcony that features two balcony chairs, hammock, and a table; single bed; writing desk with an office chair; and a closet.



Category B Solo

LOUNGE DECK #604-607, 609, 611

Cabin with balcony that features two balcony chairs, hammock, and a table; single bed; writing desk with chair; hammock; and a closet.



Deck Plans

Observation Deck

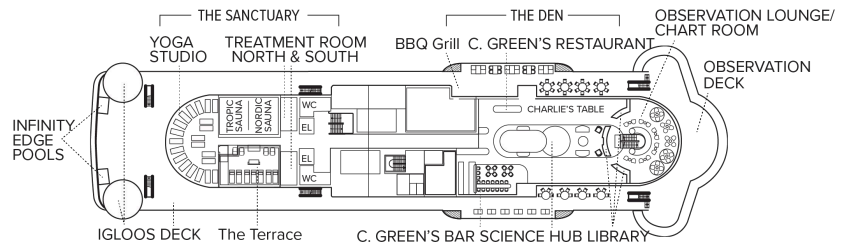

Bridge Deck

- Category 5
- Category 6
- Category 7

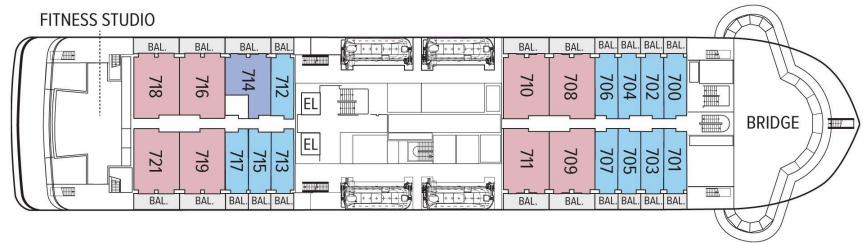

Lounge Deck

- Category 4
- Category B Solo

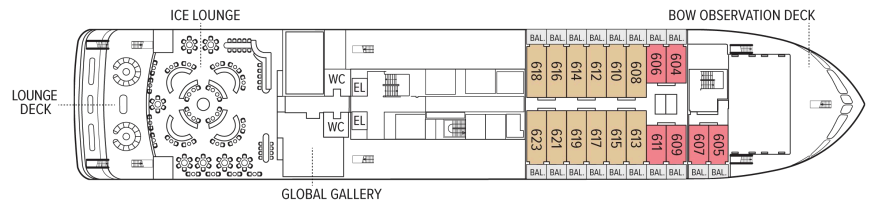

Main Deck

- Category 3
- Category 2 Solo

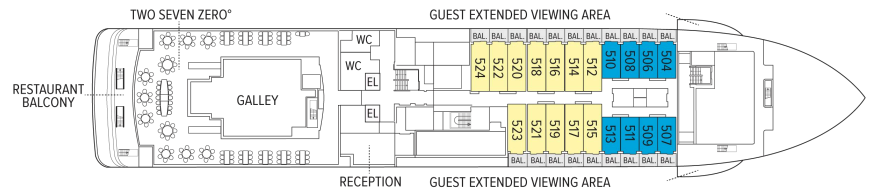

Fore Deck

- Category 1
- Category 2

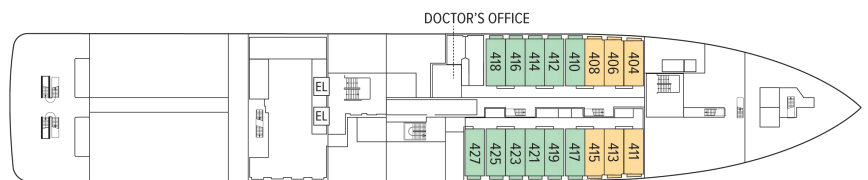

Expedition Deck

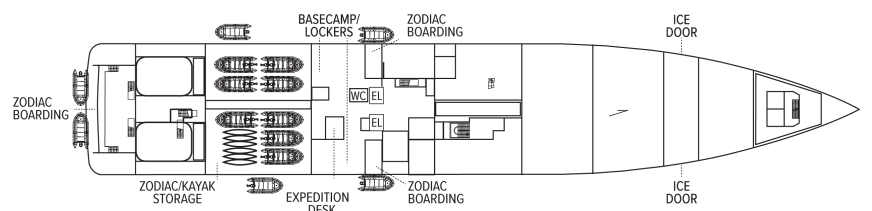

Ship Amenities

Public Areas

Reception; three dining areas; an observation lounge with bar, gym, wellness area, infinity-style outdoor hot tubs with adjacent igloos; library; main lounge with full service bar, 24-hour beverage station, state-of-the-art tech for films/presentations; OM System photo locker and a photo workshop area; science hub; an onboard broadcast studio; an expedition base with lockers for expedition gear; and open access to the Bridge, Captain, officers and on-duty wildlife spotters.

Meals

Restaurant 270° features wrap-around views; two other dining areas offer lighter, made-to-order fare or intimate, small group dinners. All feature sustainable choices, local where possible, and unassigned, flexible, inclusive seating.

Cabins

All cabins face outside with large windows, private bathroom, and climate controls. Cabins are equipped with expedition command centers with iPad tablets, multiple electrical and USB outlets, TVs, with on demand entertainment, phone, Wi-Fi, clock, barometers, hygrometers, vanity mirror, mini refrigerator, small safe, ice bucket, glasses, hair dryer, reading lights and National Geographic Atlas. Luxury linens and pillows. Bathrooms outfitted with Rain showers & hand held shower, botanically inspired shampoo, conditioner, shower gel and lotion. Complimentary insulated water bottles. Balcony cabins have hammocks, chairs and table.

Expedition Equipment

Zodiac landing craft, kayaks, snowshoes, cross-country skis, an ROV and underwater video camera for unique access to the polar undersea, hydrophone, aerial remote-controlled camera and video microscope.

Special Features

A full-time doctor, undersea specialist, National Geographic photographer, National Geographic-Lindblad Expeditions certified photo instructor and video chronicler, an internet cafe and laundry. A forward and aft staircase, and elevators, reach all decks. Echoing the pioneering installation aboard *National Geographic Endurance*, artist Zaria Forman has curated a new exhibit featuring a wide range of artists.



Wellness

A glass-enclosed yoga studio, gym, treatment rooms and spa relax area, and high and low-heat saunas with ocean views, staffed by wellness specialists.

Self-Disinfecting Ships

ACT Clean Coat™ is a light-activated, self-disinfecting cleaning process that continuously breaks down viruses, bacteria, mold, and airborne allergens across all ship surfaces. Not only does this create a cleaner, healthier shipboard environment for guests and crew alike, but this non-toxic, chemical-free system also saves more than one million gallons of water each year in our cleaning procedures, and reduces our carbon footprint as well as the amount of plastic and waste in our supply chain.

Special Offers

CELEBRATE LIFE'S MILESTONES

Celebrate a milestone with a group of eight or more and enjoy a special amenity package including: 5% savings on voyage fares, custom group photo, US\$150 shipboard credit for the group, and other special gifts. Milestone celebration to be communicated at time of booking.

COMBINING OFFERS

Certain offers may be combinable, up to two savings opportunities, except where noted otherwise. For example, travel with a group of 8 or more on back-to-back expeditions, and take advantage of both savings.

SAVE 5% TRAVELING AS A GROUP

Save 5% when traveling as a group of 8 or more people. Valid for new bookings only on select departures, subject to availability, not applicable on extensions, and may not be combined with other offers. Call for details.

10% OFF BACK-TO-BACK VOYAGES

Save 10% on consecutive departures, applicable on voyage fares only and not valid on extensions or airfare. Valid for new bookings only, subject to availability, and may not be combined with other offers. Call for details.

PAY BY DEBIT: EARN A \$100 ONBOARD CREDIT

The \$100 onboard credit offer is applied after the final payment and requires 85% of the cost of the voyage to be placed on a debit card. Maximum of one \$100 onboard credit per cabin. The \$100 onboard credit is a non-refundable, non-transferable credit that can be used for various onboard purchases such as global gallery and spa treatments. It has no cash value, cannot be refunded if not fully utilized, and will be forfeited if not fully redeemed by the end of the voyage. This offer is combinable with other offers. If the booking is altered or canceled, the onboard credit may be forfeited, and it cannot be transferred if the booking is moved to another guest. Lindblad Expeditions reserves the right to modify or cancel the offer without prior notice. Offer applies to Lindblad Expeditions' owned ships only. Offer valid only for Debit Cards issued in the United States for payments made from the United States.

TRAVEL PROTECTION PLAN

We strongly recommend our guests to take advantage of our Travel Protection Plan. This plan offers comprehensive coverage to protect you from cancellation fees, costs incurred due to trip delays/interruption, damage or loss of baggage, medical assistance, and evacuation during your travels. Our Travel Protection Plan is available for U.S. residents only, and may be purchased any time prior to final payment due date, Travel Protection premiums are non-refundable once plan is purchased. Learn more about our Travel Protection "Plus" Plan: <https://www.expeditions.com/terms-conditions/travel-protection-plan/>

CANCELLATION POLICY

Review our cancellation policy: <https://www.expeditions.com/cancellation-policy/>