



England, Germany and Belgium: North Sea Heritage and History

Sail across the North Sea on a journey that weaves together centuries of seafaring history, striking coastal landscapes and vibrant cultural heritage. From Hanseatic harbors in Northern Germany and Flemish UNESCO sites in Belgium to the historic trails of England's Northumberland and East Sussex, this expedition traces the maritime spine of northern Europe as you discover how the North Sea has shaped kingdoms and culture for millennia. Actively explore each day while choosing from a variety of excursions that include walking storied streets in medieval port cities, encountering rare wildlife in protected estuaries and hiking hidden islands known more for their seabirds than tourists.

From
\$ 5,022 / per person
Does not include flights

 DATES Apr	 DURATION 9 Days
 SHIPS <i>National Geographic Explorer</i>	
 STARTS AT Edinburgh, Scotland	 ENDS AT Portsmouth, England

Highlights

- ★ Roam the pristine estuaries and beaches of Northumberland—home to more than 400 different bird species—and walk the stunning chalk sea cliffs of East Sussex
- ★ Experience dramatic red sandstone cliffs, seabird colonies and a vehicle-free atmosphere on the remote island of Heliogland, the home of one of the renowned captains
- ★ Step into a living history of trade, architecture and Frisian culture in Bremen, where Gothic spires and ornate guild halls recall the height of the Hanseatic League, a powerful alliance of merchant guilds and market towns that dominated trade in Northern Europe for centuries
- ★ In Harlingen, explore the intersection of natural wonder and human ingenuity at the Wadden Sea, the world's largest unbroken intertidal zone and a





Day by day

■ DAY 1

Edinburgh, Scotland / Embark Ship

Arrive in Edinburgh and transfer to the city center. Known throughout time for its hill fort, and now the iconic Edinburgh Castle, Scotland's capital offers a variety of experiences throughout its streets. Explore the city at your own pace before embarking the ship in the afternoon.

Meals included: dinner

◇ DAY 2

Newcastle upon Tyne, England

Spend the day exploring the estuaries and beaches of Northumberland, the northernmost county in England, home to more than 400 different bird species. Once a medieval Anglo-Saxon kingdom encompassing parts of present-day northern England, this region is rich in striking coastlines and estuaries of the Tyne and Tweed rivers, as well as the ancient cities protecting the area for millennia.

Meals included: breakfast, lunch, dinner

◇ DAY 3

At Sea

Spend a relaxing day sailing across the North Sea. Join your captain and crew on the Bridge and learn about the trade route to the Hanseatic cities or attend a presentation led by one of your naturalists. Take advantage of the amenities on board such as a rejuvenating spa treatment with your wellness specialist.

Meals included: breakfast, lunch, dinner

◇ DAYS 4-5

Northern Germany

Arrive in Germany on the remote island of Heligoland in the North Sea, a destination that has seen many different rulers throughout the ages. Sitting approximately 38 miles from the entrance of the River Elbe and 29 miles off the coast of mainland Germany, Heligoland boasts a unique landscape of red sandstone cliffs, bird colonies that include northern gannets and seal haul-out sites. It's such a small island that there are no private vehicles, and all areas are accessible by walking. Heligoland also happens to be the home of one of National Geographic-Lindblad Expeditions' renowned ship captains, Oliver Kruess.

The next day, navigate up the Weser River into the Free Hanseatic City of Bremen. A bustling trade center in the famous Hanseatic League, the modern city continues this rich tradition while protecting the architecture and grandeur of the past, most notably the Town Hall and the 13th-century St. Peter's Cathedral. Choose to uncover Hanseatic history, visit tranquil countryside windmills or take an active bike ride on a network of trails outside the city center.

Meals included: breakfast, lunch, dinner

◇ DAY 6

Harlingen, Netherlands

This morning, you'll enter northeastern Netherlands through an estuary in Friesland, a region settled by German tribes since the 4th century, controlling lands from Bremen to Bruges. Harlingen sits at the meeting point of the UNESCO-listed Wadden Sea—the world's largest unbroken intertidal zone—and the IJsselmeer, the Netherlands' largest lake. Choose between exploring the charming streets of one of the oldest seaports in the Netherlands or venturing to the Afsluitdijk Wadden Center to learn about the innovation projects

continuing in the Wadden Sea and controlling the waterworks of the Netherlands.

Meals included: breakfast, lunch, dinner

Disembark in Portsmouth after breakfast and transfer to the airport for your flight home.

Meals included: breakfast

◇ DAY 7

Ostend, Belgium / Bruges

Ostend is the North Sea gateway into Flemish Belgium, or Flanders. Rich in intangible cultural heritage, Flanders offers a wide range of subjects to explore—from beer brewing dating back to the Middle Ages and fascinating folklore to captivating arts and religious traditions. The city of Bruges, known as the “Venice of the North,” is a UNESCO World Heritage Site filled with Gothic architecture and serene canals. You’ll discover this city’s historic wonders on foot during a panoramic walking tour past the Belfort Bell Tower and City Hall. As part of the day, you’ll also have the choice to visit the Beguinages, a series of UNESCO-designated, enclosed communities once home to a religious order of nuns that offer insight into 17th-century spiritual and urban life.

Meals included: breakfast, lunch, dinner

◇ DAY 8

East Sussex, England

After crossing the English Channel, arrive in East Sussex, known for its rich medieval history, stunning ivory coasts and quaint villages that are approximately 1,000 years old. Spend the day exploring coastal trails that trace these ivory shores with their iconic chalk cliffs, wandering through narrow passages of ancient castles and battlefields or soaking up village life along idyllic winding lanes.

Meals included: breakfast, lunch, dinner

■ DAY 9

Portsmouth / Disembark Ship

Expedition

Edinburgh, Scotland → Portsmouth, England

2026 Departure Dates

Aboard *National Geographic Explorer*

18 Apr				
--------	--	--	--	--



National Geographic Explorer

Guests

148

Cabins

81

Built to handle deep swells and towering waves, the *National Geographic Explorer* lends herself to globe-spanning travel and a dedication to curiosity and wonder.

Originally constructed for service along Norway's coast as part of the famed Hurtigruten, or Coastal Express, she ferried passengers among the fjords of this iconic coast in conditions that could deteriorate into heavy seas in a matter of minutes. She had to be able to handle deep swells and towering waves—and have a high degree of maneuverability. Those traits, and an ideal size, made her a natural choice for addition to the Lindblad fleet.

The plans to completely rebuild her drew on 50 years of pioneering expedition history and expertise. *National Geographic Explorer* was equipped with an ice-strengthened hull and advanced navigation equipment for polar expeditions; a roster of tools for exploration; and a well-appointed interior with vast expanses of glass for an unprecedented connection to the environment. Her interior and exterior design embodied the Lindblad expedition ethos—the privilege of wildness and the luxury of comfort.

For many guests she remains their paradigm of an expedition ship. She is devoted to exploration—from her Welcoming Bridge, and the Chart Room below it where you can tuck in to warm up with a hot chocolate, to her high-perched Observation deck with its aqueous light and compelling 24/7 views. Even the art on the walls— from the Hurley prints of Shackleton’s expedition to the stunning National Geographic photos— tells an uber- narrative of globe-spanning travel and a dedication to curiosity and wonder.

National Geographic Explorer is a state-of-the-art expedition ship. She is a fully stabilized, ice-class vessel, with an ice-reinforced hull, enabling her to navigate polar passages while providing exceptional comfort.



Cabin Categories

Category 1

Main Deck: #301-308

Cabins feature one or two portholes. Most cabins feature two single beds that can be converted to a queen. Cabins #301-306 feature one queen-sized bed. All cabins feature a writing desk, floor length mirror, reading lamps, well-appointed bathrooms with a roomy glass-wall shower, and a TV.



Category 2

Main Deck: #317-320, 335-336

Cabins feature two single beds (some can convert to a queen-sized bed), and one large window. They offer a writing desk, floor length mirror, reading lamps, sitting chair, well-appointed bathrooms with a roomy glass-wall shower, and a TV.



Category 3

Main Deck: #313-316, 321-328, 337-340, 342, 344, 348, 350

Cabins feature two single beds (some can convert to a queen-sized bed), one large window, and two sitting chairs and a small table and ample storage. They have a writing desk, floor length mirror, reading lamps, well-appointed bathrooms with a roomy glass-wall shower, and a TV. Cabins 341 & 343 have a sofa bed for a triple.



Category 4

Upper Deck: #201-202, 204-207, 210, 212, 217, 226, 228

Cabins feature two single beds and at least one large window. All cabins can convert between two single beds to a queen, except Cabins 217, 226 & 228 that feature one queen-size bed only. All cabins feature climate controls, sitting chairs, and a TV. Bathrooms are also generously sized with a roomy glass-walled shower stall.



Veranda Deck: #103-104, 107-108

Cabins feature two single beds that can convert into a queen. They have a writing desk, floor length mirror, reading lamps, sitting chair, private bathrooms with a glass-wall shower, and a TV.

Category 5

Upper Deck: #209, 211, 214, 216, 218, 220-222, 224

Cabins feature a balcony with sliding glass doors, one queen-sized bed, writing desk, floor length mirror, reading lamps, private bathrooms with a glass-wall shower, and a TV. (Cabin 221 has two single beds that can convert to a queen.)



Category 6

Upper Deck: #213

This spacious cabin has a private balcony, two single beds that can be converted into a queen, a writing desk, double closet, bookcase, pull-out sofa, armchairs, two large windows, and a TV. The sleeping area has a glass partition separating the living room. Bathrooms are generously sized with a roomy glass-walled shower stall and twin sinks.



Veranda Deck: #101-102

These spacious cabins can be converted into triples. They have two single beds that can be converted into a queen, a writing desk, double closet, bookcase, sofa-bed, chairs, two large windows, and a TV. The sleeping area can be closed off with the glass partition. Bathrooms are generously sized with a roomy glass-walled shower stall and twin sinks.

Category 7

Upper Deck: #215, 219, 230

These large cabins with private balconies have two single beds that can convert to an Olympic-sized queen. They have seating areas with a sofa-bed and can be converted to triples. Cabins also include a desk with chairs, coffee table with sitting chair, and a small table. Bathrooms are generously sized with a roomy glass-walled shower stall and twin sinks.



Category A Solo

Main Deck: #309-311, 329-334

These cabins feature one single bed and a large window, a writing desk, reading lamp, bathroom with a roomy glass-wall shower stall, and a TV.



Category B Solo

Upper Deck: #203, 208

Veranda Deck: #105-106

These cabins feature one single bed and a large window, a writing desk, reading lamp, bathroom with a roomy glass-wall shower stall, and a TV.



Bridge Deck

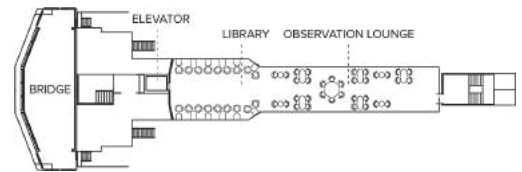

Wellness Deck

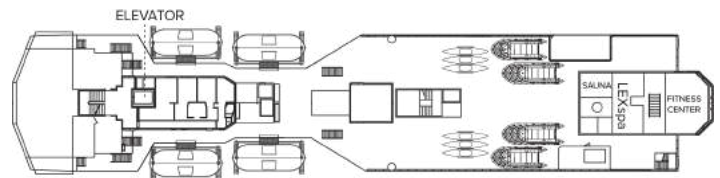

Veranda Deck

- Category 4
- Category 6
- Category B Solo

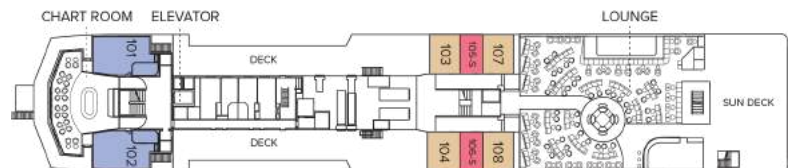

Upper Deck

- Category 4
- Category 5
- Category 6
- Category 7
- Category B Solo

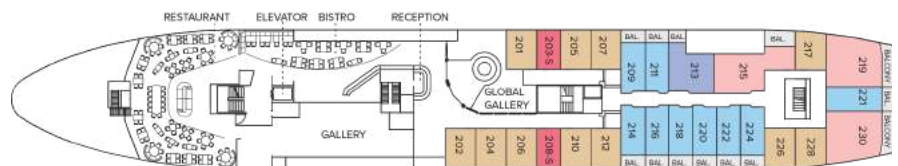

Main Deck

- Category 1
- Category 2
- Category 3
- Category 2 Solo



B Deck



Ship amenities

Public Areas

Reception; three dining areas; global gallery; library, B&H Photo locker; 24-hour Bistro area beverage bar; lounge with bar and state-of-the-art presentation facilities; observation lounge; mudroom with lockers for expedition gear; plus open access to the Bridge, the Captain, officers and on-duty wildlife spotters.

Meals

Meals are served in the dining room, Bistro bar, or the Observation lounge, at a single seating with unassigned tables for an informal atmosphere and easy mingling. Menus feature sustainable choices, local where possible.

Cabins

81 outside cabins. All cabins face outside with windows or portholes, private bathroom, and climate controls. Cabins are equipped with Wi-Fi, multiple electrical outlets, USB outlets, full length mirror and phones. TV featuring entertainment on demand, live feed for onboard presentations, bow camera and ship's position. Luxury bed linens and pillows. Botanically inspired shampoo, conditioner, shower gel, and lotion are all available in cabin bathrooms, as well as an Expedition Essential Kit. Hair dryers, complimentary insulated water bottles and a National Geographic Atlas is available in each cabin.

Expedition Equipment

Zodiac landing craft, a fleet of double kayaks, a crow's nest camera, a hydrophone, underwater video cameras, video microscope, and an ROV. Plus, for South Pacific voyages: snorkeling gear for all guests, scuba gear for a number of pre-qualified guests, stand-up paddleboards, glass-bottom Zodiac, and splash-cam.



Special Features

A full-time doctor, undersea specialist, National Geographic photographer, Lindblad-National Geographic certified photo instructor and video chronicler, internet café and laundry. Enjoy a session in the topside library with a good book, or with the book in your lap, eyes trained on the horizon.

Wellness

A glass-enclosed fitness center, outdoor stretching area, a LEXspa treatment room and sauna, staffed by wellness specialists.

Self-Disinfecting Ships

ACT Clean Coat™ is a light-activated, self- disinfecting cleaning process that continuously breaks down viruses, bacteria, mold, and airborne allergens across all ship surfaces. Not only does this create a cleaner, healthier shipboard environment for guests and crew alike, but this non-toxic, chemical- free system also saves more than one million gallons of water each year in our cleaning procedures, and reduces our carbon footprint as well as the amount of plastic and waste in our supply chain.

Special Offers

BRINGING THE KIDS

We believe sharing an expedition with children is a life-enhancing experience. Save \$500 for each child under the age of 18 on any departure. Not applicable on extensions or airfare. Call for details.

PAY BY DEBIT: EARN A \$100 ONBOARD CREDIT

The \$100 onboard credit offer is applied after the final payment and requires 85% of the cost of the voyage to be placed on a debit card. Maximum of one \$100 onboard credit per cabin. The \$100 onboard credit is a non-refundable, non-transferable credit that can be used for various onboard purchases such as global gallery and spa treatments. It has no cash value, cannot be refunded if not fully utilized, and will be forfeited if not fully redeemed by the end of the voyage. This offer is combinable with other offers. If the booking is altered or canceled, the onboard credit may be forfeited, and it cannot be transferred if the booking is moved to another guest. Lindblad Expeditions reserves the right to modify or cancel the offer without prior notice. Offer applies to Lindblad Expeditions' owned ships only. Offer valid only for Debit Cards issued in the United States for payments made from the United States.

COMBINING OFFERS

Certain offers may be combinable, up to two savings opportunities, except where noted otherwise. For example, travel with a group of 8 or more on back-to-back expeditions, and take advantage of both savings.

10% OFF BACK-TO-BACK VOYAGES

Save 10% on consecutive departures, applicable on voyage fares only and not valid on extensions or airfare. Valid for new bookings only, subject to availability, and may not be combined with other offers. Call for details.

SAVE 5% TRAVELING AS A GROUP

Save 5% when traveling as a group of eight or more people. Valid on voyage fares only and not applicable on extensions or airfare. Deposit, final payments, and cancellation policies for group travel vary from our regular policies. Valid for new bookings only, subject to availability, and may not be combined with other offers. Call for details.

CELEBRATE LIFE'S MILESTONES

Celebrate a milestone with a group of eight or more and enjoy a special amenity package including: 5% savings on voyage fares, custom group photo, US\$150 shipboard credit for the group, and other special gifts. Milestone celebration to be communicated at time of booking.

Travel protection plan

We strongly recommend our guests to take advantage of our Travel Protection Plan. This plan offers comprehensive coverage to protect you from cancellation fees, costs incurred due to trip delays/interruption, damage or loss of baggage, medical assistance, and evacuation during your travels. Our Travel Protection Plan is available for U.S. residents only, and may be purchased any time prior to final payment due date, Travel Protection premiums are non-refundable once plan is purchased. Learn more about our Travel Protection "Plus" Plan: <https://www.expeditions.com/terms-conditions/travel-protection-plan/>

Cancellation policy

Review our cancellation policy: <https://www.expeditions.com/cancellation-policy/>