

Patagonia & South America
50° 56' S 73° 24' W

Best of Chilean Patagonia: Fjords, Glaciers, and Torres Del Paine

Go by land and sea to discover the breadth of Patagonia’s wildness. Spend three days exploring the grandeur of Torres del Paine National Park—a UNESCO biosphere reserve. Then set sail to discover Chile’s wonderland of fjords, islands, and icebergs. Search for fur seals, sea lions, and penguins; take in panoramic views from the Beagle Channel; and explore the windswept archipelago of Tierra del Fuego. Enjoy special access to Argentina’s Staten Island, brimming with wildlife.

From
\$ 22,218 / per person
Does not include flights

	DATES Feb and Oct		DURATION 14 Days
	SHIPS <i>National Geographic Explorer</i> <i>National Geographic Endurance</i>		
	STARTS AT Ushuaia, Argentina	→	 ENDS AT Puerto Natales, Chile

Highlights

- ★ Venture inland to explore the wildlife-rich, iconic landscapes of Torres del Paine, Patagonia's jewel, with either the Tierra Patagonia Hotel or the Explora Patagonia Hotel as your base camp
- ★ With special permission, explore wild, rugged Isla de los Estados (Staten Island), located at the extreme end of South America and largely off limits to travelers since 1923
- ★ Transit the legendary Beagle Channel and look out for shearwater, petrels, albatrosses, and more
- ★ Venture through wildlife reserves not easily accessible to the public, including Karukinka Natural Park in Tierra del Fuego





Day by day

■ DAY 1

Santiago, Chile

Depart on an overnight flight to Santiago, Chile. We check into the centrally located Ritz-Carlton, Santiago (or similar) before our guided overview of this vibrant city backed by the inspiring Andes. Discover sites like the Plaza de Armas and get a feel for the mix of old and new that makes this city so great. This area is excellent for photos! In the early evening, we gather for an informal reception and a drink at the hotel.

Arrival Time: Arrive before 11:00 a.m. local time.

Arrival City: Santiago, Chile

◇ DAY 2

Ushuaia, Argentina / Embark Ship

Join our recommended flight from Buenos Aires to Ushuaia; we'll provide transfers to the airport and luggage assistance*. If the weather is fine, you'll have a chance to view the spectacular mountains rising out of the Beagle Channel while enjoying lunch on a catamaran cruise. Later, embark and set sail.

*If you are not purchasing our recommended flight, please get in touch with us to confirm your arrangements.

Meals included: breakfast, lunch, dinner

◇ DAYS 3-4

Isla de Los Estados (Staten Island), Argentina

We have been given special permission to visit extraordinary Staten Island, and our ship is one of the only expedition ships ever allowed here. It is a place of superlatives, barely touched in recent

decades and visited primarily by a few scientists and the staff of the tiny naval observatory. The island was named by Dutch explorers in 1615. Its mountainous, forested landscapes and rugged fjords are beautiful, and there is much to discover here. Our exact schedule remains flexible to take best advantage of conditions. We search for southern rockhopper and Magellanic penguins, other waterbirds, fur seals, and sea lions. We also look for otters on our landings ashore, and we see the replica of the 1884 San Juan de Salvamento "lighthouse at the end of the world," which inspired Jules Verne's novel by the same name.

Meals included: breakfast, lunch, dinner

◇ DAYS 5-6

Chilean Fjords / Beagle Channel

This southernmost corner of the South American continent is also home to Cape Horn, the island at the convergence of the Atlantic and Pacific oceans, famously difficult waters that, throughout the centuries, has been the graveyard of many ships from the time before the Panama Canal. Sail the Beagle Channel and look to hike and kayak one of the wild areas in this region of beech forests, mountains, and rivers. We take Zodiacs out to explore these protected waters and rugged shores, keeping watch for the shearwaters, petrels, albatrosses, and many other birds that inhabit this otherworldly realm. We experience more stunning wilderness as we explore the fjords and glaciers of the region by Zodiac, kayak, and on foot.

Meals included: breakfast, lunch, dinner

◇ DAY 7

Tierra del Fuego / Karukinka Natural Park

Tierra del Fuego is one of Patagonia's crown jewels.

We visit its newest and largest protected area: Karukinka Natural Park. Established in 2004 through a gift from Goldman Sachs, Karukinka is one of the largest donations ever made for conservation. We are thrilled to have special permission from the Wildlife Conservation Society to visit this private reserve, which spans 1,160 square miles and harbors the endangered culpeo fox, Andean condors, albatrosses, grebes, petrels, fulmars, shearwaters, and many other kinds of wildlife. We may explore Jackson Bay, backed by a skyline of rugged mountains, and look for wildlife including black-browed albatrosses, which nest on one of the nearby small islands. We may walk a trail to a lovely waterfall and look for elephant seals resting on not only the beach but also high in the grass meadows and even in the small river draining the valley inland.

Meals included: breakfast, lunch, dinner

◇ DAYS 8-9

Chilean Fjords / Kirke or White Narrows / Puerto Natales

Today we are treated to the spectacular features of an active glaciated landscape with hanging valleys and tributary glaciers. This region was navigated by Ferdinand Magellan's expedition, and it took most of November 1520 for his ships to find a way through the channels that lie between the continental mainland and Tierra del Fuego to the south. We look to make a first stop in the extensive maze of channels and islands of the Chilean fjords, where we may go out by Zodiac and kayak. Our captain and local pilots guide us through the Kirke or White Narrows—accessible only to small ships like the Lindblad Expeditions-National Geographic fleet—and always a challenge to navigate because of the powerful currents that flow through the pinch point. Be on deck to look for condors and other wildlife as we make our way to Puerto Natales.

Meals included: breakfast, lunch, dinner

◇ DAYS 10-12

Puerto Natales / Disembark Ship / Torres del Paine National Park

Disembark this morning and drive to this UNESCO Biosphere reserve and spend three days at Tierra Patagonia Hotel or Explora Patagonia (or similar), discovering one of the most wildlife-rich areas in the Americas, covering 450,000 acres of glaciers, forests, grasslands, rivers, and colorful lagoons. Choose among a variety of possibilities, including walks and hikes, horseback riding, sailing among icebergs to the foot of the immense Grey Glacier, visiting the Salto Grande waterfall, and seeing the towers of the central massif from the Blue Lagoon. Look out for guanacos, gray foxes, rheas, and Andean condors.

Meals included: breakfast, lunch, dinner

◇ DAY 13

Torres del Paine / Puerto Natales

We have a final morning to explore Torres del Paine. We then drive to Puerto Natales for a final night at The Singular Patagonia (or similar hotel).

Meals included: breakfast, lunch, dinner

■ DAYS 14-15

Puerto Natales / Punta Arenas / Santiago, Chile / Home

Disembark in Puerto Natales, and drive to Punta Arenas, the southmost city in Chile, and join our recommended flights to Santiago for your flights home; we'll provide transfers to the airport and luggage assistance.*

*If you are not purchasing our recommended flight, please get in touch with us to confirm your arrangements.

Departure Time: Depart after 9:00 p.m. local time.

Departure City: Santiago, Chile

Northbound

Ushuaia, Argentina → Puerto Natales, Chile

2025 Departure Dates

Aboard *National Geographic Explorer*

06 Oct		
--------	--	--

Alternative Routes

Visit Expeditions.com for more information.

2024 Departure Dates

18 Oct

2026 Departure Dates

27 Feb



National Geographic Explorer

Guests

148

Cabins

81

Built to handle deep swells and towering waves, the *National Geographic Explorer* lends herself to globe-spanning travel and a dedication to curiosity and wonder.

Originally constructed for service along Norway's coast as part of the famed Hurtigruten, or Coastal Express, she ferried passengers among the fjords of this iconic coast in conditions that could deteriorate into heavy seas in a matter of minutes. She had to be able to handle deep swells and towering waves—and have a high degree of maneuverability. Those traits, and an ideal size, made her a natural choice for addition to the Lindblad fleet.

The plans to completely rebuild her drew on 50 years of pioneering expedition history and expertise. *National Geographic Explorer* was equipped with an ice-strengthened hull and advanced navigation equipment for polar expeditions; a roster of tools for exploration; and a well-appointed interior with vast expanses of glass for an unprecedented connection to the environment. Her interior and exterior design embodied the Lindblad expedition ethos—the privilege of wildness and the luxury of comfort.

For many guests she remains their paradigm of an expedition ship. She is devoted to exploration—from her Welcoming Bridge, and the Chart Room below it where you can tuck in to warm up with a hot chocolate, to her high-perched Observation deck with its aqueous light and compelling 24/7 views. Even the art on the walls— from the Hurley prints of Shackleton’s expedition to the stunning National Geographic photos— tells an uber- narrative of globe-spanning travel and a dedication to curiosity and wonder.

National Geographic Explorer is a state-of-the-art expedition ship. She is a fully stabilized, ice-class vessel, with an ice-reinforced hull, enabling her to navigate polar passages while providing exceptional comfort.



Cabin Categories

Category 1

Main Deck: #301-308

Cabins feature one or two portholes. Most cabins feature two single beds that can be converted to a queen. Cabins #301-306 feature one queen-sized bed. All cabins feature a writing desk, floor length mirror, reading lamps, well-appointed bathrooms with a roomy glass-wall shower, and a TV.



Category 2

Main Deck: #317-320, 335-336

Cabins feature two single beds (some can convert to a queen-sized bed), and one large window. They offer a writing desk, floor length mirror, reading lamps, sitting chair, well-appointed bathrooms with a roomy glass-wall shower, and a TV.



Category 3

Main Deck: #313-316, 321-328, 337-340, 342, 344, 348, 350

Cabins feature two single beds (some can convert to a queen-sized bed), one large window, and two sitting chairs and a small table and ample storage. They have a writing desk, floor length mirror, reading lamps, well-appointed bathrooms with a roomy glass-wall shower, and a TV. Cabins 341 & 343 have a sofa bed for a triple.



Category 4

Upper Deck: #201-202, 204-207, 210, 212, 217, 226, 228

Cabins feature two single beds and at least one large window. All cabins can convert between two single beds to a queen, except Cabins 217, 226 & 228 that feature one queen-size bed only. All cabins feature climate controls, sitting chairs, and a TV. Bathrooms are also generously sized with a roomy glass-walled shower stall.



Veranda Deck: #103-104, 107-108

Cabins feature two single beds that can convert into a queen. They have a writing desk, floor length mirror, reading lamps, sitting chair, private bathrooms with a glass-wall shower, and a TV.

Category 5

Upper Deck: #209, 211, 214, 216, 218, 220-222, 224

Cabins feature a balcony with sliding glass doors, one queen-sized bed, writing desk, floor length mirror, reading lamps, private bathrooms with a glass-wall shower, and a TV. (Cabin 221 has two single beds that can convert to a queen.)



Category 6

Upper Deck: #213

This spacious cabin has a private balcony, two single beds that can be converted into a queen, a writing desk, double closet, bookcase, pull-out sofa, armchairs, two large windows, and a TV. The sleeping area has a glass partition separating the living room. Bathrooms are generously sized with a roomy glass-walled shower stall and twin sinks.



Veranda Deck: #101-102

These spacious cabins can be converted into triples. They have two single beds that can be converted into a queen, a writing desk, double closet, bookcase, sofa-bed, chairs, two large windows, and a TV. The sleeping area can be closed off with the glass partition. Bathrooms are generously sized with a roomy glass-walled shower stall and twin sinks.

Category 7

Upper Deck: #215, 219, 230

These large cabins with private balconies have two single beds that can convert to an Olympic-sized queen. They have seating areas with a sofa-bed and can be converted to triples. Cabins also include a desk with chairs, coffee table with sitting chair, and a small table. Bathrooms are generously sized with a roomy glass-walled shower stall and twin sinks.



Category A Solo

Main Deck: #309-311, 329-334

These cabins feature one single bed and a large window, a writing desk, reading lamp, bathroom with a roomy glass-wall shower stall, and a TV.



Category B Solo

Upper Deck: #203, 208

Veranda Deck: #105-106

These cabins feature one single bed and a large window, a writing desk, reading lamp, bathroom with a roomy glass-wall shower stall, and a TV.



Bridge Deck



Wellness Deck



Veranda Deck

- Category 4
- Category 6
- Category B Solo

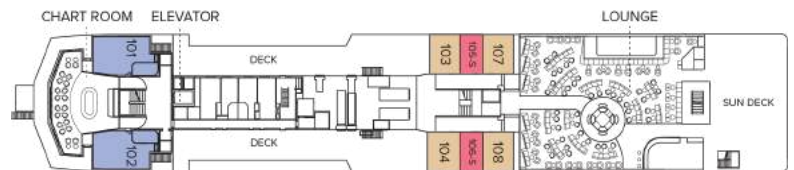

Upper Deck

- Category 4
- Category 5
- Category 6
- Category 7
- Category B Solo



Main Deck

- Category 1
- Category 2
- Category 3
- Category 2 Solo



B Deck



Ship amenities

Public Areas

Reception; three dining areas; global gallery; library, B&H Photo locker; 24-hour Bistro area beverage bar; lounge with bar and state-of-the-art presentation facilities; observation lounge; mudroom with lockers for expedition gear; plus open access to the Bridge, the Captain, officers and on-duty wildlife spotters.

Meals

Meals are served in the dining room, Bistro bar, or the Observation lounge, at a single seating with unassigned tables for an informal atmosphere and easy mingling. Menus feature sustainable choices, local where possible.

Cabins

81 outside cabins. All cabins face outside with windows or portholes, private bathroom, and climate controls. Cabins are equipped with Wi-Fi, multiple electrical outlets, USB outlets, full length mirror and phones. TV featuring entertainment on demand, live feed for onboard presentations, bow camera and ship's position. Luxury bed linens and pillows. Botanically inspired shampoo, conditioner, shower gel, and lotion are all available in cabin bathrooms, as well as an Expedition Essential Kit. Hair dryers, complimentary insulated water bottles and a National Geographic Atlas is available in each cabin.

Expedition Equipment

Zodiac landing craft, a fleet of double kayaks, a crow's nest camera, a hydrophone, underwater video cameras, video microscope, and an ROV. Plus, for South Pacific voyages: snorkeling gear for all guests, scuba gear for a number of pre-qualified guests, stand-up paddleboards, glass-bottom Zodiac, and splash-cam.



Special Features

A full-time doctor, undersea specialist, National Geographic photographer, Lindblad-National Geographic certified photo instructor and video chronicler, internet café and laundry. Enjoy a session in the topside library with a good book, or with the book in your lap, eyes trained on the horizon.

Wellness

A glass-enclosed fitness center, outdoor stretching area, a LEXspa treatment room and sauna, staffed by wellness specialists.

Self-Disinfecting Ships

ACT Clean Coat™ is a light-activated, self- disinfecting cleaning process that continuously breaks down viruses, bacteria, mold, and airborne allergens across all ship surfaces. Not only does this create a cleaner, healthier shipboard environment for guests and crew alike, but this non-toxic, chemical- free system also saves more than one million gallons of water each year in our cleaning procedures, and reduces our carbon footprint as well as the amount of plastic and waste in our supply chain.



National Geographic Endurance

Guests	Cabins
138	76

The most advanced ice-class expedition ship afloat, the *National Geographic Endurance* offers unprecedented access to polar regions.

The first new polar build in Lindblad's 50-year history, *National Geographic Endurance* is named to honor explorer Ernest Shackleton and his legendary Transantarctic Expedition.

A fully-stabilized vessel of the highest ice class (PC5 Category A), she will enable adventurous guests to go where few have or can. Endurance's most striking exterior feature is her distinctive profile, the patented X-Bow®, a game-changing design that guarantees the smoothest, most comfortable ride in all kinds of conditions; and since it eliminates bow impact, a quieter ride, as well.

An equally impressive feature may well be her capacity: she carries just 138 guests, a commitment to expedition excellence over scale. Scandinavian-inflected, luxuriously appointed, her inviting interiors would be a destination in themselves. Because she is a Lindblad expedition ship, however, her attention is focused on the world outside—with acres of window glass to keep you connected to the stunning views beyond the pane, and a fleet of expedition tools to get you out exploring.

National Geographic Endurance and *National Geographic Resolution* are next-generation expedition ships. Purpose-built for polar navigation. Fully stabilized, highly strengthened, ice-class Polar Code PC5 (Category A) vessels, they are designed to navigate polar passages year-round, and safely explore uncharted waters, while providing exceptional comfort. The patented X-bow[®] is key to their design; its powerful wave-slicing action provides an extremely smooth ride even in adverse conditions, and even reduces spray on deck for superior observation. They carry a full suite of expedition tools, and offer a variety of experience enhancing amenities.



Cabin Categories

Category 1

Fore Deck: #406, 408, 411, 413, 415

Fore Deck, with two large windows, two singles that can convert to a queen, armchair, writing desk and chair, two bedside tables, window sofa, and a closet.



Category 2

Fore Deck: #410, 412, 414, 416-419, 421-427

Fore Deck, with two large windows, two single beds that can convert to a queen, window sofa, 2 seat sofa, coffee table, armchair, writing desk with an office chair, two bedside tables, and a closet.

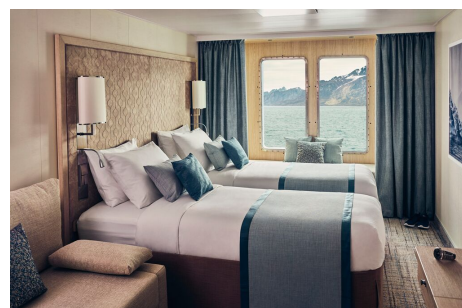

Category 3

Main Deck: #512-524

Suite with balcony that features two balcony chairs, hammock, and a table; two single beds that convert to a queen, convertible sleeper sofa, writing desk with a chair, two bedside tables, and a closet.



Category 4

Lounge Deck: #608, 610, 612, 613-623

Suite with balcony that features two balcony chairs, hammock, and a table; two single beds that convert to a queen, convertible sleeper sofa, writing desk with a chair, two bedside tables, and a closet.



Category 5

Bridge Deck: #700-707, 712, 713, 715, 717

Cabin with balcony that features two balcony chairs, hammock, and a table; two single beds that convert to a queen; convertible sleeper sofa; coffee table; writing desk with chair; two bedside tables; and a closet.



Category 6

Bridge Deck: #714

Junior suite with balcony that features two balcony chairs, hammock, and table; two single beds that convert to a queen; pull-out sofa; writing desk with chair; two bedside tables; coffee table; espresso maker; and a closet. Guests receive a welcome amenity, complimentary laundry, priority access to one igloo reservation, and one spa appointment per departure.

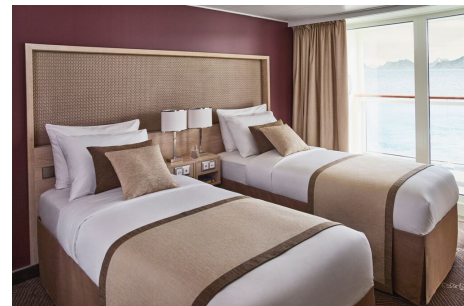

Category 7

Bridge Deck: #708-711, 716, 718, 719, 721

These large balcony suites feature two balcony chairs, hammock, and table; two single beds that can convert to a queen; pull-out sofa; coffee table; writing desk and chair; espresso maker; hammock; and a large walk-in closet with full length mirror. Expanded bathroom has a double vanity, bathtub, towel warmer, and rain shower. Guests receive a welcome amenity, complimentary laundry, priority access to one igloo reservation, and one spa appointment per departure.



Category A Solo

Main Deck: #504-510, 513

Suite with balcony that features two balcony chairs and a table; single bed, writing desk with an office chair, bedside table, and a closet.



Category B Solo

Lounge Deck: #604-607, 609, 611

Suite with balcony that features two balcony chairs, hammock, and a table; single bed, bedside table, writing desk with chair, hammock, and a closet.



Observation Deck

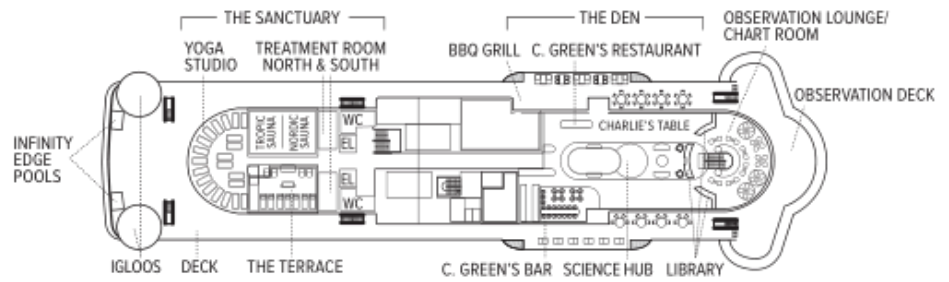

Bridge Deck

- Category 5
- Category 6
- Category 7

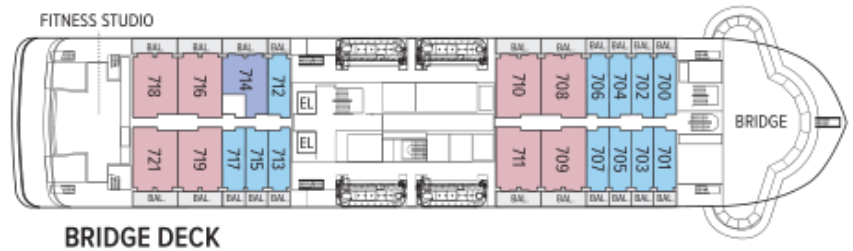

Lounge Deck

- Category 4
- Category B Solo



Main Deck

- Category 3
- Category 2 Solo



Fore Deck

- Category 1
- Category 2



Expedition Deck

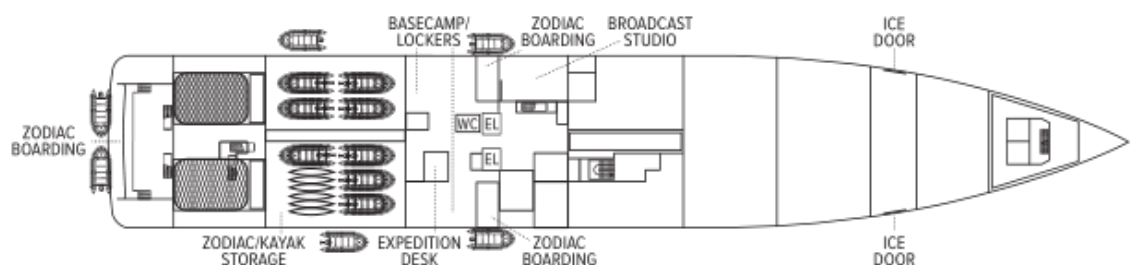

Ship amenities

Public Areas

Reception; three dining areas; an observation lounge with bar, gym, wellness area, infinity-style outdoor hot tubs with adjacent igloos; library; main lounge with full service bar, 24-hour beverage station, state-of-the-art tech for films/presentations; B&H Photo locker and a photo workshop area; science hub; an onboard broadcast studio; an expedition base with lockers for expedition gear; and open access to the Bridge, Captain, officers and on-duty wildlife spotters.

Meals

Restaurant 270° features wrap-around views; two other dining areas offer lighter, made-to-order fare or intimate, small group dinners. All feature sustainable choices, local where possible, and unassigned, flexible, inclusive seating.

Cabins

All cabins face outside with large windows, private bathroom, and climate controls. Cabins are equipped with expedition command centers with iPad tablets, multiple electrical and USB outlets, TVs, with on demand entertainment, phone, Wi-Fi, clock, barometers, hygrometers, vanity mirror, mini refrigerator, small safe, ice bucket, glasses, hair dryer, reading lights and National Geographic Atlas. Luxury linens and pillows. Bathrooms outfitted with Rain showers & hand held shower, botanically inspired shampoo, conditioner, shower gel and lotion. Complimentary insulated water bottles. Balcony cabins have hammocks, chairs and table.

Expedition Equipment

Zodiac landing craft, kayaks, snowshoes, cross-country skis, an ROV and underwater video camera for unique access to the polar undersea, hydrophone, aerial remote-controlled camera and video microscope.

Special Features

A full-time doctor, undersea specialist, National Geographic photographer, Lindblad-National Geographic certified photo instructor and video chronicler, an internet cafe and laundry. A forward and aft staircase, and elevators, reach all decks. Echoing the pioneering installation aboard *National Geographic Endurance*, artist Zaria Forman has curated a new exhibit, featuring a wide range of artists.



Wellness

A glass-enclosed yoga studio, gym, treatment rooms and spa relax area, and high and low-heat saunas with ocean views, staffed by wellness specialists.

Self-Disinfecting Ships

ACT Clean Coat™ is a light-activated, self-disinfecting cleaning process that continuously breaks down viruses, bacteria, mold, and airborne allergens across all ship surfaces. Not only does this create a cleaner, healthier shipboard environment for guests and crew alike, but this non-toxic, chemical-free system also saves more than one million gallons of water each year in our cleaning procedures, and reduces our carbon footprint as well as the amount of plastic and waste in our supply chain.

Special Offers

2026-2027 EARLY BOOKING OFFERS

Booking and deposit must be made by Nov. 1, 2024. Valid for new bookings only on departures from Jan. 1, 2026 through Mar. 31, 2027, subject to availability, may not be combinable with other offers, and not applicable on airfare or extensions.

Book Early to Lock in Current Rates on All 2026-2027 Departures: Pricing will increase on Nov. 2, 2024. Not applicable on airfare or extensions.

Bringing the Kids - Save \$1,000 Per Child Up To 22: We believe sharing an expedition with children is a life-enhancing experience. Take \$1,000 off for each child under the age of 23 on any departure.

Save Up To 15% on Back-to-Back Voyages: Save up to 15% on voyage fares on consecutive back-to-back departures. Applicable on select departures only.

Book Two or More Voyages and Save 10%: Save 10% on the lowest priced departure when you book two or more expeditions.

Bring a Friend and Save 5%: Save 5% when you book two or more cabins on the same departure. Valid on voyage fares only. Deposit, final payments, and cancellation policies for group travel vary from our regular policies when you book 8 or more guests.

SUITE EXCLUSIVES

Spacious living areas and incredible views immerse you in the beauty of your marine surroundings. Our new Suite Exclusives package helps make your voyage all the more memorable. [Learn more](#)

CELEBRATE LIFE'S MILESTONES

Celebrate a milestone with a group of eight or more

and enjoy a special amenity package including: 5% savings on voyage fares, custom group photo, US\$150 shipboard credit for the group, and other special gifts. Milestone celebration to be communicated at time of booking.

SAVE 5% TRAVELING AS A GROUP

Save 5% when traveling as a group of eight or more people. Valid on voyage fares only and not applicable on extensions or airfare. Deposit, final payments, and cancellation policies for group travel vary from our regular policies. Valid for new bookings only, subject to availability, and may not be combined with other offers. Call for details.

COMBINING OFFERS

Certain offers may be combinable, up to two savings opportunities, except where noted otherwise. For example, travel with a group of 8 or more on back-to-back expeditions, and take advantage of both savings.

Included in price

All accommodations aboard ship or in hotels per itinerary; all meals as indicated in the itinerary, both aboard and onshore; beer, wine, cocktails, and spirits aboard the ship (except certain super premium brands which are available for purchase); hors d'oeuvres, 24-hour access to snacks, premium coffees and teas, non-alcoholic beverages, and filtered water; excursions and airport transfers to and from recommended flights, as indicated in the itinerary; crew gratuities; exploration tools curated to destination, such as Zodiacs and kayaks; guidance and company of our leading expedition staff; assistance by the National Geographic Photography Expert and Lindblad Expeditions-National Geographic certified photo instructor; access to the OM System Photo Gear Locker; presentations by expedition staff and expert guest speakers; complimentary reusable water bottle; services of a physician, physician's assistant, nurse practitioner, or paramedic; morning stretch classes and 24-hour access to exercise equipment; 24-hour access to lounges, observation decks, library, and other shared spaces; park and site entrance fees, special access permits, and port taxes. Unused services or items included in our programs are non-refundable.

Not included in price

Airfare (except flights when indicated as included); pre- and post-expedition extensions; additional hotel nights (except when indicated as included); private transfers; laundry, spa treatments, Wi-Fi, and phone services (except when indicated as included); travel protection plans; and passport, visa, and immigration fees.

Travel protection plan

We strongly recommend our guests to take advantage of our Travel Protection Plan. This plan offers comprehensive coverage to protect you from cancellation fees, costs incurred due to trip delays/interruption, damage or loss of baggage, medical assistance, and evacuation during your travels. Our Travel Protection Plan is available for U.S. residents only, and may be purchased any time prior to final payment due date, Travel Protection premiums are non-refundable once plan is purchased. Learn more about our Travel Protection "Plus" Plan: <https://www.expeditions.com/terms-conditions/travel-protection-plan/>

Cancellation policy

Review our cancellation policy: <https://www.expeditions.com/cancellation-policy/>