

Iceland, Greenland & Arctic
67° 0' N 50° 43' W

Iceland and Greenland: Edge of the Arctic

More than a thousand years ago, the legendary Viking Erik the Red set sail from Iceland to Greenland and was exiled to a stark and spectacular land of endless ice, rocky pinnacles, and steep-sided fjords. Follow his route from Iceland's magnificent Westfjords peninsula across the Denmark Strait to the ice-sculpted shores of Greenland. Trace the coast of the world's largest island from the rugged eastern fjords to the fishing villages of the western coast. Search for whales and caribou, and use our ship's exploration tools to discover the undersea. Visit archaeological sites of Viking and Thule settlements and learn about everyday life near the Arctic Circle in charming coastal villages from Flatey Island to Uummannaq.

From
\$ 19,300 / per person
Does not include flights



DATES

Jul



DURATION

18 Days



SHIPS

National Geographic Resolution



STARTS AT

Reykjavík,
Iceland



ENDS AT

Reykjavík,
Iceland

Highlights

- ★ Explore Greenland's vast and varied landscapes: the iceberg-filled channels of the Ilulissat Icefjord, the bustling streets of capital city Nuuk, the backcountry tundra of Disko Island and more
- ★ Alongside local residents and visionaries, learn about the rich layers of Greenlandic culture on visits to remote farms and fishing villages, and enjoy traditional tastings and vibrant customs
- ★ Visit Brattahlíð, the 10th-century agricultural estate of Erik the Red, and meet locals continuing his farming traditions at UNESCO World Heritage- listed Kujataa
- ★ Capture stunning photos of glacier-filled fjords with help from a National Geographic Photography Expert

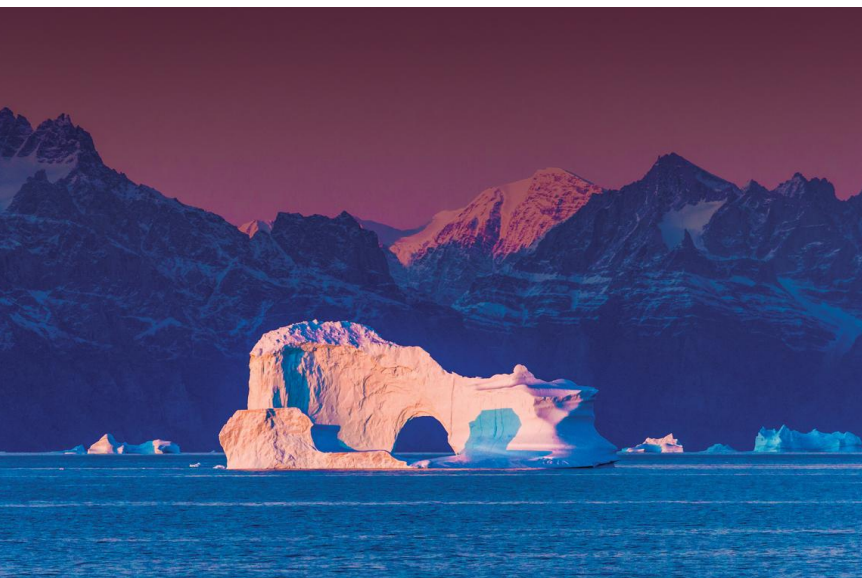



Day by day

■ DAY 1

Reykjavík, Iceland

Arrive in Reykjavík, the world's northernmost capital, which lies just below the Arctic Circle. Transfer from the airport to the city and spend the day exploring at your own pace. Check in with the hospitality desk this afternoon before embarking the ship.

Meals included: dinner

◇ DAY 2

Flatey Island

Explore Iceland's western frontier, visiting Flatey Island, a trading post for many centuries turned sleepy summer islet. Walk around the charming little hamlet and hike across hiking trails that trace the path past seasonal puffin population on the cliffs.

Meals included: breakfast, lunch, dinner

◇ DAYS 3-4

Westfjords

Explore the beautiful and peaceful Westfjords region of Iceland. Enjoy a hike to a remote waterfall, a Zodiac cruise alongside stunning scenery or bike along the coast of the Westfjords. Enter Ísafjarðardjúp and land at Vigur Island to visit the eider farm and learn about the down cleaning process. Get to know the capital of the Westfjords, Ísafjörður, through a walking tour complete with local sights, sounds and tastes.

Meals included: breakfast, lunch, dinner

◇ DAY 5

Crossing the Denmark Strait

Sail away from the Westfjords of Iceland and across the Denmark Strait, which connects the Arctic and Atlantic Ocean. The Strait is home to the world's

largest waterfall, caused by powerful currents and glaciers. Listen to talks by experts, relax with a book in the lounge or the observation deck and keep an eye out for wildlife as the ship sails across the continental shelf.

Meals included: breakfast, lunch, dinner

◇ DAY 6

Exploring East Greenland

The coast of the world's largest island is etched with thousands of fjords, some of which reach back to the Greenlandic ice sheet. Spend the day exploring these stunning inlets of the eastern coast as the staff uses the ship's underwater cameras and Remotely Operated Vehicle (ROV) to help you discover marine life and fascinating underwater geology. Ice permitting, sail deep into Skjoldungen fjord and soak in your arrival to Greenland on a Zodiac cruise or in a kayak among the icebergs.

Meals included: breakfast, lunch, dinner

◇ DAY 7

Prins Christian Sund / Tasermiut Fjord

Sail into Prins Christian Sund, which cuts into the southern tip of Greenland, passing between soaring pinnacles and glaciers, allowing the ship to sail through the sheltered waters of this dramatic landscape. As you round the southern coast of Greenland, enter Tasermiut Fjord, known as Arctic Patagonia, for its sheer granite rock faces and dramatic valley filled with glaciers or their moraines. Spend time exploring by foot, kayak or zodiac along its shores.

Meals included: breakfast, lunch, dinner

◇ DAYS 8-9

Qaqortoq and Tunulliarfik Fjord

Qaqortoq and Tunulliarfik Fjord provide two days of insight, culture and local interactions. Walk through the ruins of Bratthlid, Erik the Red's farm, visiting replicas of the church and the family's longhouse. Explore the same shores from which their son, Leif Eriksson, launched the first voyages to North America—500 years before Columbus. Visit the unofficial capital of southern Greenland at Qaqortoq, with just over 3,200 residents. The colonial influence is visible throughout the town, with houses painted in primary colors and architecture dating back to the 1700s. Stroll through the town square and visit the museum, where Greenlandic kayaks, hunting equipment and local art and handicrafts are on display. Finally, walk through the walls of Hvalsey church, located in the fjords behind Qaqortoq, the best-preserved Norse ruins in all of Greenland and a UNESCO World Heritage site.

Meals included: [breakfast, lunch, dinner](#)

◇ DAY 10

Nuuk

Perched on the seaside in the shadow of ice-capped Sermitsiaq Mountain, Nuuk is the world's smallest capital city by population, with some 19,000 inhabitants, experiencing tremendous cultural and economic growth. Watch for harp seals as you enter the harbor and take a walking tour with local residents to learn how the community has changed over the generations. At the National Museum, examine the extraordinary 15th-century Qilakitsoq mummies found near Uummannaq—a discovery that was featured in a *National Geographic* magazine cover story in 1985. The Arctic ice preserved these mummies so well that researchers have been able to study their tattoos, their medical conditions and even what they ate.

Meals included: [breakfast, lunch, dinner](#)

◇ DAY 11

Eternity Fjord

In the early morning, the ship enters Eternity Fjord (Kangerlussuatsiaq Fjord), which winds picturesquely past steep mountains and stunning tidewater glaciers. In the far reaches of the fjord, take a Zodiac cruise along the face of one of the many glaciers or hike over glacial moraines to a waterfall. In the afternoon, continue exploring this varied landscape and fjord system either by foot, kayak, or zodiac and hear from experts about the physical changes to the landscape year over year.

Meals included: [breakfast, lunch, dinner](#)

◇ DAY 12

Sisimiut

Upon arrival to Sisimiut, a former whaling port, enjoy your choice of guided walks through the sights and sounds of the village, including a meeting with the caretakers of the Greenlandic Dog Project, or hiking part of the Arctic Circle trail. In your free time, enjoy a local food tasting, visit the open-air museum or explore the local artisan workshops.

Meals included: [breakfast, lunch, dinner](#)

◇ DAYS 13-14

Ilulissat and Disko Bay

Sail into Qeqertarsuup Tunua, also known as Disko Bay, and be welcomed by floating icebergs calved off the world's most active glacier, Sermeq Kujalleq. Enjoy an extraordinary cruise aboard local boats among towering icebergs of the UNESCO World Heritage-designated Ilulissat Icefjord. Visit the town of Ilulissat and hike into the Sermermiut Valley, once an Inuit settlement and now home to a peaceful boardwalk overlooking the Icefjord. As the ship make its way north through Disko Bay, if ice conditions permit, you'll follow the inside passage of Disko Island and trace the shores of the Nuussuaq Peninsula as you keep watch for a glimpse of the Greenlandic Ice Sheet.

Meals included: [breakfast, lunch, dinner](#)

◇ DAY 15

Uummannaq / Qilakitsoq

The village of Uummannaq sits on a tiny, yet dramatic island in the Uummannaq Fjord, dominated by a massive peak rising at its center. Visit the town's excellent community museum to see traditional clothing and tools along with scenes of everyday life on these islands and enjoy a stroll through the streets of this northern outpost. In the afternoon, with special village permissions, cross the fjord to the site of Qilakitsoq, an important archaeological site for Greenlanders, where eight mummies, dating back to 1475, were discovered in 1972. These eight individuals, all extraordinarily well-preserved women and children, were Thule people, the ancestors of the modern Inuit and was featured on the cover of the February 1985 issue of *National Geographic* magazine. For the adventurous hikers, make your own respectful journey up to the final resting place of these ancestors.

Meals included: breakfast, lunch, dinner

◇ DAY 16

Exploring Greenland's Fjords

Sail along Greenland's fjords and look for Arctic foxes, whales and—with luck—caribou. Paddle a kayak along the steep sides of the fjord or ride a Zodiac to see the glacially carved landscape up close.

Meals included: breakfast, lunch, dinner

◇ DAY 17

Nuuk, Greenland / Disembark Ship / Reykjavík, Iceland

Disembark in Nuuk and join the recommended group flight to Keflavik; transfers to the nearby hotel and luggage assistance will be provided. Upon arrival, enjoy an included dinner and overnight.

Meals included: breakfast, lunch, dinner

■ DAY 18

Reykjavík

After breakfast, transfer to the airport for flights home.

Meals included: breakfast

Expedition

Reykjavík, Iceland → Reykjavík, Iceland

2026 Departure Dates

Aboard *National Geographic Resolution*

14 Jul				
--------	--	--	--	--



National Geographic Resolution

Guests

138

Cabins

76

**The sister ship to *National Geographic Endurance*,
she explores polar & temperate regions**

Our second new polar build, *National Geographic Resolution*, is named to honor the second voyage of the legendary Captain James Cook.

A fully-stabilized vessel of the highest ice class (PC5 Category A), she will enable adventurous guests to go where few have or can. *Resolution's* most striking exterior feature is her distinctive profile, the patented X-Bow®, a game-changing design that guarantees the smoothest, most comfortable ride in all kinds of conditions; and since it eliminates bow impact, a quieter ride, as well.

An equally impressive feature may well be her capacity: she carries just 138 guests, a commitment to expedition excellence over scale. Scandinavian-inflected, luxuriously appointed, her inviting interiors would be a destination in themselves. Because she is a Lindblad expedition ship, however, her attention is focused on the world outside— with acres of window glass to keep you connected to the stunning views beyond the pane, and a fleet of expedition tools to get you out exploring.

National Geographic Endurance and *National Geographic Resolution* are next-generation expedition ships. Purpose-built for polar navigation. Fully stabilized, highly strengthened, ice-class Polar Code PC5 (Category A) vessels, they are designed to navigate polar passages year-round, and safely explore uncharted waters, while providing exceptional comfort. The patented X-bow[®] is key to their design; its powerful wave-slicing action provides an extremely smooth ride even in adverse conditions, and even reduces spray on deck for superior observation. They carry a full suite of expedition tools, and offer a variety of experience enhancing amenities.



Cabin Categories

Category 1

Fore Deck: #404, 406, 408, 411, 413, 415

Cabin with two large windows, two singles that can convert to a queen, writing desk and chair, two bedside tables, window sofa, coffee table, and a closet.



Category 2

Fore Deck: #410, 412, 414, 416-419, 421-427

Cabin with two large windows, two single beds that can convert to a queen, window sofa, two-seat sofa, coffee table, writing desk with an office chair, two bedside tables, coffee table, and a closet.



Category 3

Main Deck: #512, 514-524

Cabin with balcony that features two balcony chairs, hammock, and a table; two single beds that convert to a queen; convertible sleeper sofa; writing desk with a chair; two bedside tables; coffee table; and a closet.



Category 4

Lounge Deck: #608, 610, 612, 613-623

Cabin with balcony that features two balcony chairs, hammock and a table; two single beds that can convert to a queen; pull-out sofa; coffee table; writing desk with chair; two bedside tables; and a closet.



Category 5

Bridge Deck: #700-707, 712, 713, 715, 717

Cabin with balcony that features two balcony chairs, hammock, and a table; two single beds that convert to a queen; convertible sleeper sofa; coffee table; writing desk with chair; two bedside tables; and a closet.



Category 6

Bridge Deck: #714

Junior suite with balcony that features two balcony chairs, hammock, and table; two single beds that convert to a queen; pull-out sofa; writing desk with chair; two bedside tables; coffee table; espresso maker and a closet. Guests receive priority access to one spa treatment and one igloo reservation and complementary laundry per departure.

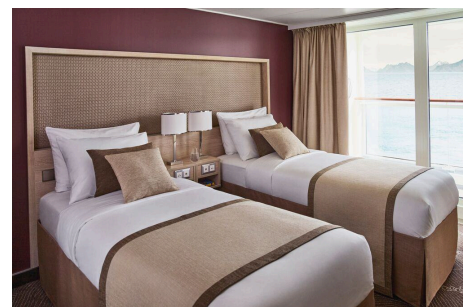

Category 7

Bridge Deck: #708-711, 716, 718, 719, 721

These large balcony suites feature two balcony chairs, hammock, and table; two single beds that can convert to a queen; pull-out sofa; coffee table; writing desk and chair; espresso maker; and a large walk-in closet with full length mirror. Expanded bathroom has a double vanity, bathtub, towel warmer and rain shower. Guests receive priority access to one spa treatment and one igloo reservation and complementary laundry per departure.

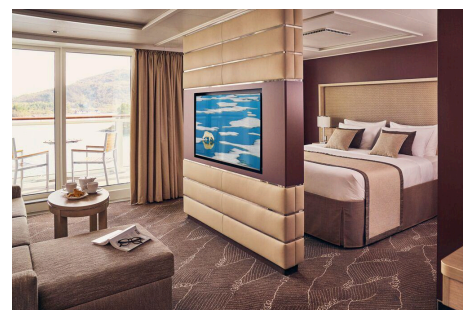

Category A Solo

Main Deck: #504, 506-511, 513

Cabin with balcony that features two balcony chairs, hammock, and a table; single bed; writing desk with an office chair; and a closet.



Category B Solo

Lounge Deck: #604-607, 609, 611

Cabin with balcony that features two balcony chairs, hammock, and a table; single bed; writing desk with chair; hammock; and a closet.



Observation Deck

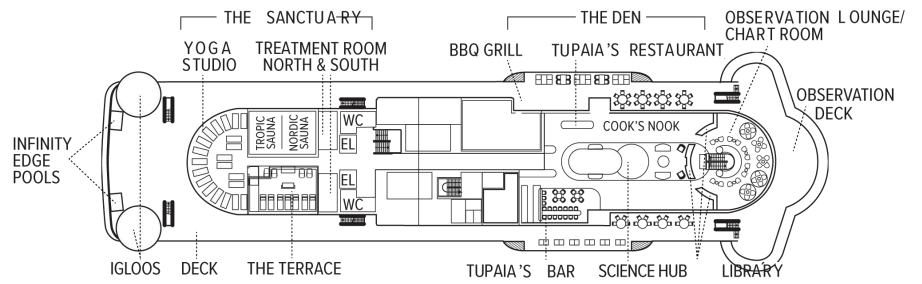

Bridge Deck

- Category 5
- Category 6
- Category 7

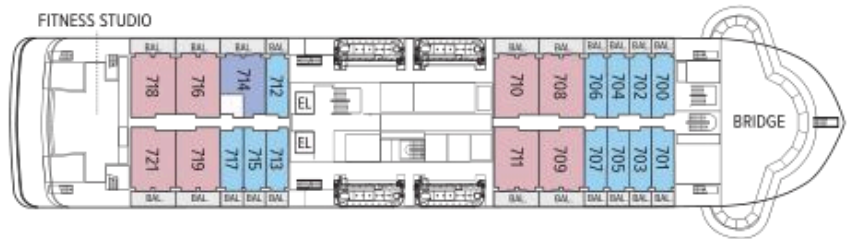

Lounge Deck

- Category 4
- Category B Solo



Main Deck

- Category 3
- Category A Solo



Fore Deck

- Category 1
- Category 2



Expedition Deck

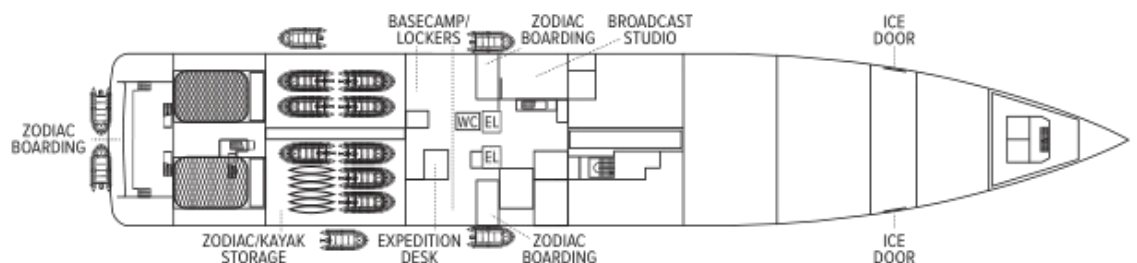

Ship amenities

Public Areas

Reception; three dining areas; an observation lounge with bar, gym, wellness area, infinity-style outdoor hot tubs with adjacent igloos; library; main lounge with full service bar, 24-hour beverage station, state-of-the-art tech for films/presentations; B&H Photo locker and a photo workshop area; science hub; an onboard broadcast studio; an expedition base with lockers for expedition gear; and open access to the Bridge, Captain, officers and on-duty wildlife spotters.

Meals

Restaurant 270° features wrap-around views; two other dining areas offer lighter, made-to-order fare or intimate, small group dinners. All feature sustainable choices, local where possible, and unassigned, flexible, inclusive seating.

Cabins

All cabins face outside with large windows, private bathroom, and climate controls. Cabins are equipped with expedition command centers with iPad tablets, multiple electrical and USB outlets, TVs, with on demand entertainment, phone, Wi-Fi, clock, barometers, hygrometers, vanity mirror, mini refrigerator, small safe, ice bucket, glasses, hair dryer, reading lights and National Geographic Atlas. Luxury linens and pillows. Bathrooms outfitted with Rain showers & hand held shower, botanically inspired shampoo, conditioner, shower gel and lotion. Complimentary insulated water bottles. Balcony cabins have hammocks, chairs and table.

Expedition Equipment

Zodiac landing craft, kayaks, snowshoes, cross-country skis, an ROV and underwater video camera for unique access to the polar undersea, hydrophone, aerial remote-controlled camera and video microscope.

Special Features

A full-time doctor, undersea specialist, National Geographic photographer, Lindblad-National Geographic certified photo instructor and video chronicler, an internet cafe and laundry. A forward and aft staircase, and elevators, reach all decks. Echoing the pioneering installation aboard *National Geographic Endurance*, artist Zaria Forman has curated a new exhibit, featuring a wide range of artists.



Wellness

A glass-enclosed yoga studio, gym, treatment rooms and spa relax area, and high and low-heat saunas with ocean views, staffed by wellness specialists.

Self-Disinfecting Ships

ACT Clean Coat™ is a light-activated, self-disinfecting cleaning process that continuously breaks down viruses, bacteria, mold, and airborne allergens across all ship surfaces. Not only does this create a cleaner, healthier shipboard environment for guests and crew alike, but this non-toxic, chemical-free system also saves more than one million gallons of water each year in our cleaning procedures, and reduces our carbon footprint as well as the amount of plastic and waste in our supply chain.

Special Offers

SPECIAL SAVINGS

Receive savings of up to 20% on select voyages as indicated on our special offer page. Applicable savings will be deducted from cabin fare after any additional applicable savings with the purchase of cabin fare. Receive 50% off the deposit due at the time of booking on select 2026 and 2027 voyages outside of final payment. Remaining deposit balance is due at the time of final payment. Additional restrictions may apply. Offers valid on new bookings only for select 2026 and 2027 departures, subject to availability and offer may be withdrawn at any time without prior notice, not applicable on airfare or extensions, and may not be combined with other offers. Call for details.

SUITE EXCLUSIVES

Spacious living areas and incredible views immerse you in the beauty of your marine surroundings. Our new Suite Exclusives package helps make your voyage all the more memorable. [Learn more](#)

SAVE 5% TRAVELING AS A GROUP

Save 5% when traveling as a group of eight or more people. Valid on voyage fares only and not applicable on extensions or airfare. Deposit, final payments, and cancellation policies for group travel vary from our regular policies. Valid for new bookings only, subject to availability, and may not be combined with other offers. Call for details.

CELEBRATE LIFE'S MILESTONES

Celebrate a milestone with a group of eight or more and enjoy a special amenity package including: 5% savings on voyage fares, custom group photo, US\$150

shipboard credit for the group, and other special gifts. Milestone celebration to be communicated at time of booking.

PAY BY DEBIT: EARN A \$100 ONBOARD CREDIT

The \$100 onboard credit offer is applied after the final payment and requires 85% of the cost of the voyage to be placed on a debit card. Maximum of one \$100 onboard credit per cabin. The \$100 onboard credit is a non-refundable, non-transferable credit that can be used for various onboard purchases such as global gallery and spa treatments. It has no cash value, cannot be refunded if not fully utilized, and will be forfeited if not fully redeemed by the end of the voyage. This offer is combinable with other offers. If the booking is altered or canceled, the onboard credit may be forfeited, and it cannot be transferred if the booking is moved to another guest. Lindblad Expeditions reserves the right to modify or cancel the offer without prior notice. Offer applies to Lindblad Expeditions' owned ships only. Offer valid only for Debit Cards issued in the United States for payments made from the United States.

COMBINING OFFERS

Certain offers may be combinable, up to two savings opportunities, except where noted otherwise. For example, travel with a group of 8 or more on back-to-back expeditions, and take advantage of both savings.

AIR CREDIT

Book from February 10, 2026, to March 31, 2026 and receive air credit of \$1,000 per person, deducted from air fare with the purchase of cabin fare on select 2026 departures code AIR2026. To qualify for the offer, airfare must be ticketed by Lindblad Expeditions. In

the case that airfare at the time of booking is higher than \$1,000 per person, guest will be required to pay any amount in excess of \$1,000 per person. Valid for new bookings only on select 2026 departures, subject to availability, not applicable on extensions. This offer is combinable with the Anniversary Offer of up to 20% savings on select voyages as indicated on expeditions.com/anniversaryoffer until March 3, 2026. Not combinable with any other offers. Baggage fees may incur additional costs and seat assignments may not be guaranteed. Valid for US and Canadian residents only.

Included in price

All accommodations aboard ship or in hotels per itinerary; all meals as indicated in the itinerary, both aboard and onshore; beer, wine, cocktails, liquors and spirits aboard the ship (except certain premium brands which are available for purchase); hors d'oeuvres, 24-hour access to snacks, premium coffees and teas, non-alcoholic beverages, and filtered water; excursions and airport transfers to and from recommended flights, as indicated in the itinerary; crew gratuities; exploration tools curated to destination, such as Zodiacs, kayaks, guidance and company of our leading expedition staff; assistance by the National Geographic Photographer and Lindblad Expeditions-National Geographic certified photo instructor; access to the OM System Photo Gear Locker; presentations by expedition staff and expert guest speakers; complimentary parka or jacket, complimentary reusable water bottle; onboard physician consultations; morning stretch classes and 24-hour access to exercise equipment; 24-hour access to lounges, observation decks, library, and other shared spaces; park and site entrance fees, special access permits, and port taxes. Unused services or items included in our programs are non-refundable.

Not included in price

Airfare (except flights* when indicated as included); pre- and post-expedition extensions; additional hotel nights (except when indicated as included); private transfers; laundry, spa treatments, Wi-Fi, and phone services (except when indicated as included); travel protection plans; and passport, visa, and immigration fees.

*Recommended flight costs include flight(s) that take place during the date range of your trip to transport travelers from one itinerary destination to another. This cost also includes ground transportation, luggage transfer, and airport assistance. If you prefer to arrange your own flights privately, have alternate means of transport, or wish to modify at a later time, please contact an Expedition Specialist at 1.833.400.0831

Additional costs associated with medical services outside onboard physician consultation.

For select voyages, completing a medical evaluation form with VIKAND is required. If you utilize your physician,

VIKAND's processing fee for your documentation will be added to your National Geographic-Lindblad Expeditions invoice. If you utilize VIKAND's physicians, an additional charge will be due and payable directly to VIKAND.

Travel protection plan

We strongly recommend our guests to take advantage of our Travel Protection Plan. This plan offers comprehensive coverage to protect you from cancellation fees, costs incurred due to trip delays/interruption, damage or loss of baggage, medical assistance, and evacuation during your travels. Our Travel Protection Plan is available for U.S. residents only, and may be purchased any time prior to final payment due date, Travel Protection premiums are non-refundable once plan is purchased. Learn more about our Travel Protection "Plus" Plan: <https://www.expeditions.com/terms-conditions/travel-protection-plan/>

Cancellation policy

Review our cancellation policy: <https://www.expeditions.com/cancellation-policy/>