

## Arctic Odyssey: Iceland, Greenland and Canada

Sail in the wake of early Viking explorers on a compelling journey that mixes Arctic wildlife and landscapes with a riveting history that comes alive in well-preserved ruins and local communities continuing to thrive on the edge of the Arctic. Start your adventure in Iceland's remote Westfjords before charting a course for southern Greenland, where you'll glide into dramatic fjords flanked by towering, jagged mountains; and visit colorful Qaqortoq, the unofficial capital of the region. In Canada, trace wild coastlines, keeping an eye out for polar bears, whales, and migrating birdlife.

From  
**\$ 18,571** / per person  
Does not include flights

	<b>DATES</b> Aug		<b>DURATION</b> 15 Days
	<b>SHIPS</b> <i>National Geographic Explorer</i>		
	<b>STARTS AT</b> Reykjavík, Iceland	→	 <b>ENDS AT</b> St. John's, Newfoundland

**Note:** the 2026 sailing is 16 days to allow for viewing of the total solar eclipse.



## Highlights

- ★ Take in picturesque views as we sail through dramatic fjords and past glaciers and ice floes in southern Greenland
- ★ Step back in time at Viking ruins, like Erik the Red's farm in Greenland and the 11th-century village at L'Anse aux Meadows, a UNESCO World Heritage site in Canada
- ★ Navigate across the Denmark Strait, home to the world's largest underwater waterfall, and the Labrador Sea, known for its nutrient-rich cold water currents
- ★ Keep watch on the open Bridge for polar bears, falcons, whales and migrating seabirds along the stunning coast of Labrador







## Day by day

### ■ DAY 1

#### Reykjavík, Iceland / Embark Ship

Arrive in Reykjavík, the world's northernmost capital, which lies just below the Arctic Circle. Transfer from the airport to the city and spend the day exploring at your own pace. Check in with the hospitality desk this afternoon before embarking the ship.

Meals included: dinner

### ◇ DAY 2

#### Flatey Island

Explore Iceland's western frontier, visiting Flatey Island, a trading post for many centuries turned sleepy summer islet. Walk around the charming little hamlet that has survived, and hike across trails that trace the cliffs past a seasonal seabird population.

*\*\*In 2025, please know that this landing could be cancelled due to weather conditions across the Denmark Strait and sailing directly to Greenland from Reykjavík.*

Meals included: breakfast, lunch, dinner

### ◇ DAY 3

#### Crossing the Denmark Strait

Sail away from the Westfjords of Iceland and across the Denmark Strait. Connecting the Arctic and Atlantic Oceans, the strait is home to the world's largest waterfall, caused by powerful currents underneath the surface. Listen to talks by experts, relax with a book in the lounge or on the observation deck and keep an eye out for wildlife as the ship sails across the continental shelf.

Meals included: breakfast, lunch, dinner

### ◇ DAY 4

#### Prins Christian Sund, Greenland

Sail into Prins Christian Sund, which cuts into the southern tip of Greenland, passing between soaring pinnacles and glaciers, allowing the ship to sail through the sheltered waters of this dramatic landscape. Glimpse hanging glaciers through the fjords that stretch back to the Greenlandic Ice Sheet and keep an eye out for marine and bird life in these sheltered waters.

Meals included: breakfast, lunch, dinner

### ◇ DAYS 5-6

#### Southern Greenland Fjords

Home to some of the best preserved ruins of the Viking era in Greenland, Qaqortoq and Qassiarsuk will provide you with two days of insight, culture and local interactions. Walk through the ruins of Bratthlid, Erik the Red's farm, visiting replicas of the church and the family's longhouse. Explore the same shores from which their son, Leif Eriksson, launched the first voyages to North America—500 years before Columbus.

Visit the unofficial capital of southern Greenland at Qaqortoq, with just over 3,200 residents. The colonial influence is visible throughout the town, with houses painted in primary colors and architecture dating back to the 1700's. Stroll through the town square and visit the museum, where Greenlandic kayaks, hunting equipment and local art and handicrafts are on display. Finally, walk through the walls of Hvalsey church, located in the fjords behind Qaqortoq, the best preserved Norse ruins in all of Greenland.

Meals included: breakfast, lunch, dinner

### ◇ DAYS 7-8

#### At Sea / Crossing the Davis Strait

Spend time on the bow of the ship watching

for whales, polar bears and other wildlife; enjoy the ship's amenities; edit your photos alongside photography experts; and attend expert-led talks about the Arctic as the ship navigates the massive icebergs of Davis Strait on the way to Baffin Island.

Meals included: breakfast, lunch, dinner

#### ◇ DAYS 9-12

### Exploring the Labrador Coast, Canada

Spend three days tracing the beautiful, wild coast of Labrador, exploring on foot and by kayak and Zodiac. As the ship weaves its way through the Lower Savage islands, you'll keep a watchful eye for the polar bears that call these islands home and use Zodiacs as safe havens to experience their environment firsthand. Watch for peregrine falcons and other birds soaring over the rocky shorelines of the spectacularly narrow Mugford Tickle and take in the impressive sight of the 4,000-foot-high Kaumajet Mountains. Continue to scenic Battle Harbour to discover the reconstructed 19th-century buildings and legacy of this historic fishing village.

Meals included: breakfast, lunch, dinner

#### ◇ DAY 13

### L'Anse aux Meadows

In the 1960s, the remains of a Viking village established in the 11th century were excavated at L'Anse aux Meadows, now a UNESCO World Heritage site. Walk among the Norse ruins and reconstructed sod huts and learn the saga of the Vikings in North America, who arrived here nearly 500 years before the explorations of Columbus.

Meals included: breakfast, lunch, dinner

#### ◇ DAY 14

### Eastern Newfoundland

Cliffs, fjords and beaches grace the eastern coast of

Newfoundland. Hike, kayak or explore by Zodiac with your experts amid this stunning scenery, and keep an eye out for migrating birds and whales.

Meals included: breakfast, lunch, dinner

#### ■ DAY 15

### St. John's, Newfoundland / Disembark Ship

Disembark in St. John's and transfer to the airport for flights home.

Meals included: breakfast

### 2025 Expedition

Reykjavík, Iceland → St. John's, Newfoundland

### 2025 Departure Dates

Aboard *National Geographic Explorer*

17 Aug			
--------	--	--	--

### Alternative Routes

Visit [Expeditions.com](http://Expeditions.com) for more information.

### 2026 Departure Dates

09 Aug
--------



## ***National Geographic Explorer***

---

**Guests**

**148**

**Cabins**

**81**

---

**Built to handle deep swells and towering waves, the *National Geographic Explorer* lends herself to globe-spanning travel and a dedication to curiosity and wonder.**

Originally constructed for service along Norway's coast as part of the famed Hurtigruten, or Coastal Express, she ferried passengers among the fjords of this iconic coast in conditions that could deteriorate into heavy seas in a matter of minutes. She had to be able to handle deep swells and towering waves—and have a high degree of maneuverability. Those traits, and an ideal size, made her a natural choice for addition to the Lindblad fleet.



The plans to completely rebuild her drew on 50 years of pioneering expedition history and expertise. *National Geographic Explorer* was equipped with an ice-strengthened hull and advanced navigation equipment for polar expeditions; a roster of tools for exploration; and a well-appointed interior with vast expanses of glass for an unprecedented connection to the environment. Her interior and exterior design embodied the Lindblad expedition ethos—the privilege of wildness and the luxury of comfort.

For many guests she remains their paradigm of an expedition ship. She is devoted to exploration—from her Welcoming Bridge, and the Chart Room below it where you can tuck in to warm up with a hot chocolate, to her high-perched Observation deck with its aqueous light and compelling 24/7 views. Even the art on the walls— from the Hurley prints of Shackleton’s expedition to the stunning National Geographic photos— tells an uber- narrative of globe-spanning travel and a dedication to curiosity and wonder.

*National Geographic Explorer* is a state-of-the-art expedition ship. She is a fully stabilized, ice-class vessel, with an ice-reinforced hull, enabling her to navigate polar passages while providing exceptional comfort.





# Cabin Categories

## Category 1

**Main Deck: #301-308**

Cabins feature one or two portholes. Most cabins feature two single beds that can be converted to a queen. Cabins #301-306 feature one queen-sized bed. All cabins feature a writing desk, floor length mirror, reading lamps, well-appointed bathrooms with a roomy glass-wall shower, and a TV.



## Category 2

**Main Deck: #317-320, 335-336**

Cabins feature two single beds (some can convert to a queen-sized bed), and one large window. They offer a writing desk, floor length mirror, reading lamps, sitting chair, well-appointed bathrooms with a roomy glass-wall shower, and a TV.



## Category 3

**Main Deck: #313-316, 321-328, 337-340, 342, 344, 348, 350**

Cabins feature two single beds (some can convert to a queen-sized bed), one large window, and two sitting chairs and a small table and ample storage. They have a writing desk, floor length mirror, reading lamps, well-appointed bathrooms with a roomy glass-wall shower, and a TV. Cabins 341 & 343 have a sofa bed for a triple.



## Category 4

**Upper Deck:** #201-202, 204-207, 210, 212, 217, 226, 228

Cabins feature two single beds and at least one large window. All cabins can convert between two single beds to a queen, except Cabins 217, 226 & 228 that feature one queen-size bed only. All cabins feature climate controls, sitting chairs, and a TV. Bathrooms are also generously sized with a roomy glass-walled shower stall.



**Veranda Deck:** #103-104, 107-108

Cabins feature two single beds that can convert into a queen. They have a writing desk, floor length mirror, reading lamps, sitting chair, private bathrooms with a glass-wall shower, and a TV.

## Category 5

**Upper Deck:** #209, 211, 214, 216, 218, 220-222, 224

Cabins feature a balcony with sliding glass doors, one queen-sized bed, writing desk, floor length mirror, reading lamps, private bathrooms with a glass-wall shower, and a TV. (Cabin 221 has two single beds that can convert to a queen.)



## Category 6

**Upper Deck:** #213

This spacious cabin has a private balcony, two single beds that can be converted into a queen, a writing desk, double closet, bookcase, pull-out sofa, armchairs, two large windows, and a TV. The sleeping area has a glass partition separating the living room. Bathrooms are generously sized with a roomy glass-walled shower stall and twin sinks.



**Veranda Deck:** #101-102

These spacious cabins can be converted into triples. They have two single beds that can be converted into a queen, a writing desk, double closet, bookcase, sofa-bed, chairs, two large windows, and a TV. The sleeping area can be closed off with the glass partition. Bathrooms are generously sized with a roomy glass-walled shower stall and twin sinks.

## Category 7

**Upper Deck:** #215, 219, 230

These large cabins with private balconies have two single beds that can convert to an Olympic-sized queen. They have seating areas with a sofa-bed and can be converted to triples. Cabins also include a desk with chairs, coffee table with sitting chair, and a small table. Bathrooms are generously sized with a roomy glass-walled shower stall and twin sinks.



## Category A Solo

**Main Deck:** #309-311, 329-334

These cabins feature one single bed and a large window, a writing desk, reading lamp, bathroom with a roomy glass-wall shower stall, and a TV.



## Category B Solo

**Upper Deck:** #203, 208

**Veranda Deck:** #105-106

These cabins feature one single bed and a large window, a writing desk, reading lamp, bathroom with a roomy glass-wall shower stall, and a TV.





## Bridge Deck



## Wellness Deck



## Veranda Deck

- Category 4
- Category 6
- Category B Solo

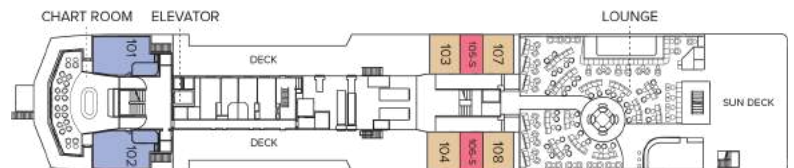

## Upper Deck

- Category 4
- Category 5
- Category 6
- Category 7
- Category B Solo



## Main Deck

- Category 1
- Category 2
- Category 3
- Category 2 Solo



## B Deck



# Ship amenities

## Public Areas

Reception; three dining areas; global gallery; library, B&H Photo locker; 24-hour Bistro area beverage bar; lounge with bar and state-of-the-art presentation facilities; observation lounge; mudroom with lockers for expedition gear; plus open access to the Bridge, the Captain, officers and on-duty wildlife spotters.

## Meals

Meals are served in the dining room, Bistro bar, or the Observation lounge, at a single seating with unassigned tables for an informal atmosphere and easy mingling. Menus feature sustainable choices, local where possible.

## Cabins

81 outside cabins. All cabins face outside with windows or portholes, private bathroom, and climate controls. Cabins are equipped with Wi-Fi, multiple electrical outlets, USB outlets, full length mirror and phones. TV featuring entertainment on demand, live feed for onboard presentations, bow camera and ship's position. Luxury bed linens and pillows. Botanically inspired shampoo, conditioner, shower gel, and lotion are all available in cabin bathrooms, as well as an Expedition Essential Kit. Hair dryers, complimentary insulated water bottles and a National Geographic Atlas is available in each cabin.

## Expedition Equipment

Zodiac landing craft, a fleet of double kayaks, a crow's nest camera, a hydrophone, underwater video cameras, video microscope, and an ROV. Plus, for South Pacific voyages: snorkeling gear for all guests, scuba gear for a number of pre-qualified guests, stand-up paddleboards, glass-bottom Zodiac, and splash-cam.



## Special Features

A full-time doctor, undersea specialist, National Geographic photographer, Lindblad-National Geographic certified photo instructor and video chronicler, internet café and laundry. Enjoy a session in the topside library with a good book, or with the book in your lap, eyes trained on the horizon.

## Wellness

A glass-enclosed fitness center, outdoor stretching area, a LEXspa treatment room and sauna, staffed by wellness specialists.

## Self-Disinfecting Ships

ACT Clean Coat™ is a light-activated, self- disinfecting cleaning process that continuously breaks down viruses, bacteria, mold, and airborne allergens across all ship surfaces. Not only does this create a cleaner, healthier shipboard environment for guests and crew alike, but this non-toxic, chemical- free system also saves more than one million gallons of water each year in our cleaning procedures, and reduces our carbon footprint as well as the amount of plastic and waste in our supply chain.

## Special Offers

### 60% reduced deposit for any 2026 voyage

Book between June 3 and August 1, 2025 and receive 60% off the deposit due at the time of booking. Remaining deposit balance is due at the time of final payment. Additional restrictions may apply. Offer valid for new bookings only on 2026 departures, subject to availability and offer may be withdrawn at any time without prior notice, not applicable on airfare or extensions, and may not be combined with other offers. Call for details.

### SUITE EXCLUSIVES

Spacious living areas and incredible views immerse you in the beauty of your marine surroundings. Our new Suite Exclusives package helps make your voyage all the more memorable. [Learn more](#)

### CELEBRATE LIFE'S MILESTONES

Celebrate a milestone with a group of eight or more and enjoy a special amenity package including: 5% savings on voyage fares, custom group photo, US\$150 shipboard credit for the group, and other special gifts. Milestone celebration to be communicated at time of booking.

### SAVE 5% TRAVELING AS A GROUP

Save 5% when traveling as a group of eight or more people. Valid on voyage fares only and not applicable on extensions or airfare. Deposit, final payments, and cancellation policies for group travel vary from our regular policies. Valid for new bookings only, subject to availability, and may not be combined with other offers. Call for details.

### BRINGING THE KIDS

We believe sharing an expedition with children is a life-enhancing experience. Save \$500 for each child under the age of 18 on any departure. Not applicable on extensions or airfare. Call for details.

### PAY BY DEBIT: EARN A \$100 ONBOARD CREDIT

The \$100 onboard credit offer is applied after the final payment and requires 85% of the cost of the voyage to be placed on a debit card. Maximum of one \$100 onboard credit per cabin. The \$100 onboard credit is a non-refundable, non-transferable credit that can be used for various onboard purchases such as global gallery and spa treatments. It has no cash value, cannot be refunded if not fully utilized, and will be forfeited if not fully redeemed by the end of the voyage. This offer is combinable with other offers. If the booking is altered or canceled, the onboard credit may be forfeited, and it cannot be transferred if the booking is moved to another guest. Lindblad Expeditions reserves the right to modify or cancel the offer without prior notice. Offer applies to Lindblad Expeditions' owned ships only. Offer valid only for Debit Cards issued in the United States for payments made from the United States.

### COMBINING OFFERS

Certain offers may be combinable, up to two savings opportunities, except where noted otherwise. For example, travel with a group of 8 or more on back-to-back expeditions, and take advantage of both savings.



## Included in price

All accommodations aboard ship or in hotels per itinerary; all meals as indicated in the itinerary, both aboard and onshore; beer, wine, cocktails, liquors and spirits aboard the ship (except certain premium brands which are available for purchase); hors d'oeuvres, 24-hour access to snacks, premium coffees and teas, non-alcoholic beverages, and filtered water; excursions and airport transfers to and from recommended flights, as indicated in the itinerary; crew gratuities; exploration tools curated to destination, such as Zodiacs, kayaks, guidance and company of our leading expedition staff; assistance by the National Geographic Photographer and Lindblad Expeditions-National Geographic certified photo instructor; access to the OM System Photo Gear Locker; presentations by expedition staff and expert guest speakers; complimentary parka or jacket, complimentary reusable water bottle; onboard physician consultations; morning stretch classes and 24-hour access to exercise equipment; 24-hour access to lounges, observation decks, library, and other shared spaces; park and site entrance fees, special access permits, and port taxes. Unused services or items included in our programs are non-refundable.

## Not included in price

Airfare (except flights\* when indicated as included); pre- and post-expedition extensions; additional hotel nights (except when indicated as included); private transfers; laundry, spa treatments, Wi-Fi, and phone services (except when indicated as included); travel protection plans; and passport, visa, and immigration fees.

\*Recommended flight costs include flight(s) that take place during the date range of your trip to transport travelers from one itinerary destination to another. This cost also includes ground transportation, luggage transfer, and airport assistance. If you prefer to arrange your own flights privately, have alternate means of transport, or wish to modify at a later time, please contact an Expedition Specialist at 1.833.400.0831

Additional costs associated with medical services outside onboard physician consultation.

We strongly recommend our guests to take advantage of our Travel Protection Plan. This plan offers comprehensive coverage to protect you from cancellation fees, costs incurred due to trip delays/interruption, damage or loss of baggage, medical assistance, and evacuation during your travels. Our Travel Protection Plan is available for U.S. residents only, and may be purchased any time prior to final payment due date. Travel Protection premiums are non-refundable once plan is purchased. Learn more about our Travel Protection "Plus" Plan: <https://www.expeditions.com/terms-conditions/travel-protection-plan/>

## Cancellation policy

Review our cancellation policy: <https://www.expeditions.com/cancellation-policy/>

## Travel protection plan