



Arctic & Greenland  
60° 8' N 45° 14' W

## South Greenland Exploration: Fjords, Waterfalls and Fishing Villages

Blanketed in ice and carved by glaciers, Greenland is a dazzling tableau of the Arctic's epic glory. Witness the centuries of tradition and ingenuity of Arctic farmers, from the ruins of Brattahlíð, the estate of Eric the Red, to the modern landscape of Kujataa, the UNESCO World Heritage region of Southern Greenland. Explore these storied fjords as the ship cruises through the dramatic cliffs of Prins Christian Sund and Skjoldungen Island, and experience them up close through hikes and kayaking alongside locals. This is an expedition deep into wilderness, rich Inuit culture and Norse lore.

From

**\$ 13,955** / per person  
Does not include flights



### DATES

Aug



### DURATION

11 Days



### SHIPS

*National Geographic Endurance*



### STARTS AT

Reykjavík,  
Iceland



### ENDS AT

Nuuk,  
Greenland

## Highlights

- ★ Experience the ice floes and deep fjords of southern Greenland by Zodiac, kayak and hiking excursions
- ★ Navigate the spectacular majesty of Prins Christian Sund, flanked by soaring snow-topped mountains, rock-strewn cliffs and icebergs
- ★ Discover the Western and Eastern Settlements of Erik the Red, the great Norse explorer credited with naming Greenland
- ★ Discover Inuit tradition and history along the southern fjords in Qaqortoq and Nanortalik through music, food tastings and demonstrations







## Day by day

### ■ DAY 1

#### Reykjavík, Iceland / Embark Ship

Arrive in Reykjavík, the world's northernmost capital, which lies just below the Arctic Circle. Transfer from the airport to the city and spend the day exploring at your own pace. Check in with the hospitality desk this afternoon before embarking the ship.

Meals included: dinner

### ◇ DAY 2

#### Grundarfjörður

Serving as the center of trade on the Snaefellsnes Peninsula since the 15th century, Grundarfjörður is now best known for its Kirkjufell Mountain and picturesque waterfall. Alongside the National Geographic Photography Expert, capture your own images of this dynamic landscape and the weather swirling around the peninsula. Alternatively, hike through a local lava field or explore the town's Saga Center.

Meals included: breakfast, lunch, dinner

### ◇ DAY 3

#### Crossing the Denmark Strait

Sail away from the Peninsula and across the Denmark Strait. Connecting the Arctic and Atlantic Ocean, the strait is home to the world's largest waterfall, caused by powerful currents and glaciers. Listen to talks by experts, relax with a book in the lounge or the observation deck and keep an eye out for wildlife as the ship sails across the continental shelf.

Meals included: breakfast, lunch, dinner

### ◇ DAY 4

#### Exploring East Greenland

The coast of the world's largest island is etched with thousands of fjords, some of which reach back to the Greenlandic ice sheet. Spend the day exploring these stunning inlets of the eastern coast, using underwater cameras and Remotely Operated Vehicle (ROV) to discover marine life and fascinating underwater geology. Ice permitting, sail deep into Skjoldungen fjord and soak in your arrival to Greenland on a Zodiac cruise or in a kayak among the icebergs.

Meals included: breakfast, lunch, dinner

### ◇ DAY 5

#### Prins Christian Sund and Tasermiut Fjord

Sail into Prins Christian Sund, which cuts into the southern tip of Greenland. Pass between soaring pinnacles and glaciers and through the sheltered waters of this dramatic landscape. As you round the southern coast of Greenland, enter Tasermiut Fjord, known as Arctic Patagonia, for its sheer granite rock faces and dramatic valley filled with glaciers or their moraines. Spend time exploring by foot, kayak or zodiac along its shores.

Meals included: breakfast, lunch, dinner

### ◇ DAY 6

#### Qaqortoq

Your exploration of Erik the Red's Eastern Settlement continues in the fjords around Qaqortoq. The Sissarluttoq World Heritage Center is dotted with ruins of Inuit and Norse farm, stables and storerooms made of sandstone and granite blocks, allowing you to imagine what farming was like on the edge of the ice cap over 1,000 years ago. Explore the ruins of the 14th-century Hvalsey Church, and venture deep into the fjord to witness how these ancient remnants create the backdrop for

daily farming life in southern Greenland. Continue to Qaqortoq, inhabited since the Viking era and now the largest town in South Greenland, with just over 3,200 residents. Stroll through the town square and visit the museum, where Greenlandic kayaks, hunting equipment and local art and handicrafts are on display. Sample traditional Greenlandic food this afternoon.

**Meals included:** breakfast, lunch, dinner

## ◇ DAY 7

### Qassarsuk

Spend your last day in what was known as Erik the Red's Eastern Settlement, present-day Qassarsuk. Visit Brattahlíð, where Erik the Red established his farm in 982 A.D. after his exile from Iceland. Erik's wife, Þjóðhild, built the first Christian church in the western hemisphere here. Visit replicas of the church and Erik the Red's longhouse and see the shores from which their son, Leif Eriksson, launched the first voyages to North America—500 years before Columbus. Later, visit a local family farm that continues the farming tradition which has earned this region a UNESCO World Heritage designation for Arctic farming on the edge of the ice cap.

**Meals included:** breakfast, lunch, dinner

## ◇ DAY 8

### Paamiut and Kuannersooq Fjord

Lying at the unofficial boundary between western and southern Greenland, Paamiut serves as the gatekeeper to a fjord system filled with hundreds of islands, fjords and bays, as well as terminal glaciers stretching out from the Greenlandic ice sheet. Enjoy an exploration day in these fjords, on the lookout for a view of the ice sheet as well as the wildlife that calls the fjords home, such as fin whales and sea eagles.

**Meals included:** breakfast, lunch, dinner

## ◇ DAY 9

### Nuuk

Perched on the seaside in the shadow of ice-capped Sermitsiaq Mountain, Nuuk is the world's smallest capital city by population, with some 19,000 inhabitants experiencing tremendous cultural and economic growth. Watch for harp seals as you enter the harbor, and hear from local residents to learn how the community has changed over the generations. At the National Museum, examine the extraordinary 15th-century Qilakitsoq mummies found near Uummannaq—a discovery that was featured in a *National Geographic* magazine cover story in 1985. The Arctic ice preserved these mummies so well that researchers have been able to study their tattoos, their medical conditions and even what they ate.

**Meals included:** breakfast, lunch, dinner

## ◇ DAY 10

### Nuuk / Disembark Ship / Reykjavík, Iceland

Disembark in Nuuk and join the recommended group flight to Keflavik; transfers to the nearby hotel and luggage assistance will be provided. Upon arrival, enjoy an included dinner and overnight.

**Meals included:** breakfast, lunch, dinner

## ■ DAY 11

### Reykjavík

After breakfast, transfer to the airport for flights home.

**Meals included:** breakfast

## Expedition

Reykjavík, Iceland → Nuuk, Greenland

## 2025 Departure Dates

Aboard *National Geographic Endurance*

18 Aug				
--------	--	--	--	--





## National Geographic Endurance

---

Guests	Cabins
138	76

---

The most advanced ice-class expedition ship afloat, the *National Geographic Endurance* offers unprecedented access to polar regions.

The first new polar build in Lindblad's 50-year history, *National Geographic Endurance* is named to honor explorer Ernest Shackleton and his legendary Transantarctic Expedition.

A fully-stabilized vessel of the highest ice class (PC5 Category A), she will enable adventurous guests to go where few have or can. Endurance's most striking exterior feature is her distinctive profile, the patented X-Bow®, a game-changing design that guarantees the smoothest, most comfortable ride in all kinds of conditions; and since it eliminates bow impact, a quieter ride, as well.



An equally impressive feature may well be her capacity: she carries just 138 guests, a commitment to expedition excellence over scale. Scandinavian-inflected, luxuriously appointed, her inviting interiors would be a destination in themselves. Because she is a Lindblad expedition ship, however, her attention is focused on the world outside—with acres of window glass to keep you connected to the stunning views beyond the pane, and a fleet of expedition tools to get you out exploring.

*National Geographic Endurance* and *National Geographic Resolution* are next-generation expedition ships. Purpose-built for polar navigation. Fully stabilized, highly strengthened, ice-class Polar Code PC5 (Category A) vessels, they are designed to navigate polar passages year-round, and safely explore uncharted waters, while providing exceptional comfort. The patented X-bow<sup>®</sup> is key to their design; its powerful wave-slicing action provides an extremely smooth ride even in adverse conditions, and even reduces spray on deck for superior observation. They carry a full suite of expedition tools, and offer a variety of experience enhancing amenities.





# Cabin Categories

## Category 1

**Fore Deck:** #404, 406, 408, 411, 413, 415

Fore Deck, with two large windows, two singles that can convert to a queen, armchair, writing desk and chair, two bedside tables, window sofa and a closet.



## Category 2

**Fore Deck:** #410, 412, 414, 416-419, 421-427

Fore Deck, with two large windows, two single beds that can convert to a queen, window sofa, two-seat sofa, coffee table, armchair, writing desk with an office chair, two bedside tables and a closet.



## Category 3

**Main Deck:** #512, 514-524

Cabin with balcony that features two balcony chairs, hammock, and a table; two single beds that convert to a queen; convertible sleeper sofa; writing desk with a chair; two bedside tables; coffee table; and a closet.



## Category 4

**Lounge Deck:** #608, 610, 612, 613-623

Cabin with balcony that features two balcony chairs, hammock and a table; two single beds that can convert to a queen; pull-out sofa; coffee table; writing desk with chair; two bedside tables; and a closet.



## Category 5

**Bridge Deck:** #700-707, 712, 713, 715, 717

Cabin with balcony that features two balcony chairs, hammock, and a table; two single beds that convert to a queen; convertible sleeper sofa; coffee table; writing desk with chair; two bedside tables; and a closet.



## Category 6

**Bridge Deck:** #714

Junior suite with balcony that features two balcony chairs, hammock, and table; two single beds that convert to a queen; pull-out sofa; writing desk with chair; two bedside tables; coffee table; espresso maker; and a closet. Guests receive priority access to one spa treatment and one igloo reservation and complementary laundry per departure.



## Category 7

**Bridge Deck:** #708-711, 716, 718, 719, 721

These large balcony suites feature two balcony chairs, hammock, and table; two single beds that can convert to a queen; pull-out sofa; coffee table; writing desk and chair; espresso maker; and a large walk-in closet with full length mirror. Expanded bathroom has a double vanity, bathtub, towel warmer and rain shower. Guests receive priority access to one spa treatment and one igloo reservation and complementary laundry per departure.



## Category A Solo

**Main Deck:** #504, 506-511, 513

Cabin with balcony that features two balcony chairs, hammock, and a table; single bed; writing desk with an office chair; and a closet.



## Category B Solo

**Lounge Deck:** #604-607, 609, 611

Cabin with balcony that features two balcony chairs, hammock, and a table; single bed; writing desk with chair; hammock; and a closet.





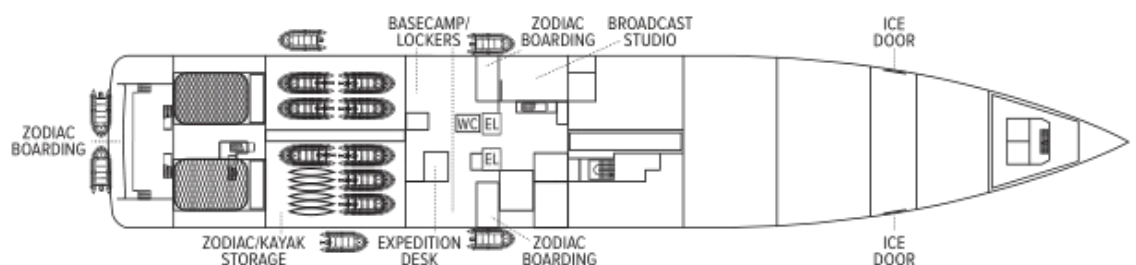
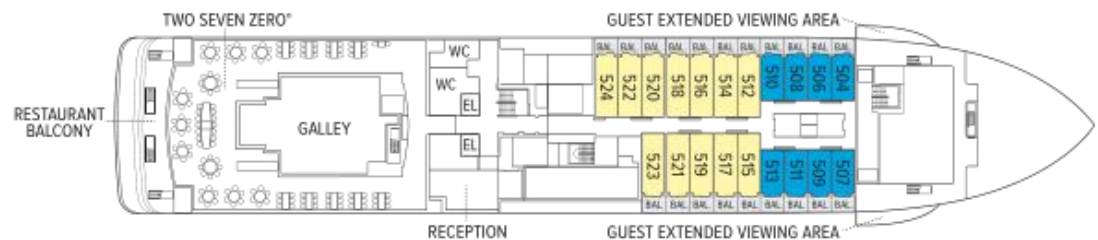
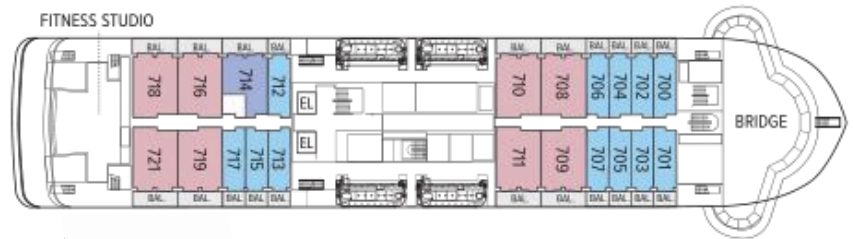
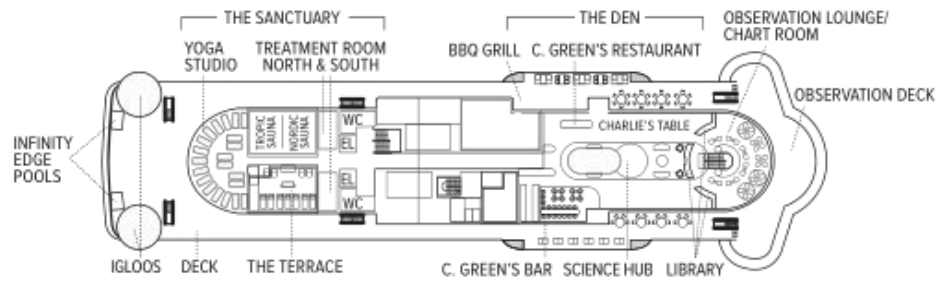

# Ship amenities

## Public Areas

Reception; three dining areas; an observation lounge with bar, gym, wellness area, infinity-style outdoor hot tubs with adjacent igloos; library; main lounge with full service bar, 24-hour beverage station, state-of-the-art tech for films/presentations; B&H Photo locker and a photo workshop area; science hub; an onboard broadcast studio; an expedition base with lockers for expedition gear; and open access to the Bridge, Captain, officers and on-duty wildlife spotters.

## Meals

Restaurant 270° features wrap-around views; two other dining areas offer lighter, made-to-order fare or intimate, small group dinners. All feature sustainable choices, local where possible, and unassigned, flexible, inclusive seating.

## Cabins

All cabins face outside with large windows, private bathroom, and climate controls. Cabins are equipped with expedition command centers with iPad tablets, multiple electrical and USB outlets, TVs, with on demand entertainment, phone, Wi-Fi, clock, barometers, hygrometers, vanity mirror, mini refrigerator, small safe, ice bucket, glasses, hair dryer, reading lights and National Geographic Atlas. Luxury linens and pillows. Bathrooms outfitted with Rain showers & hand held shower, botanically inspired shampoo, conditioner, shower gel and lotion. Complimentary insulated water bottles. Balcony cabins have hammocks, chairs and table.

## Expedition Equipment

Zodiac landing craft, kayaks, snowshoes, cross-country skis, an ROV and underwater video camera for unique access to the polar undersea, hydrophone, aerial remote-controlled camera and video microscope.

## Special Features

A full-time doctor, undersea specialist, National Geographic photographer, Lindblad-National Geographic certified photo instructor and video chronicler, an internet cafe and laundry. A forward and aft staircase, and elevators, reach all decks. Echoing the pioneering installation aboard *National Geographic Endurance*, artist Zaria Forman has curated a new exhibit, featuring a wide range of artists.



## Wellness

A glass-enclosed yoga studio, gym, treatment rooms and spa relax area, and high and low-heat saunas with ocean views, staffed by wellness specialists.

## Self-Disinfecting Ships

ACT Clean Coat™ is a light-activated, self-disinfecting cleaning process that continuously breaks down viruses, bacteria, mold, and airborne allergens across all ship surfaces. Not only does this create a cleaner, healthier shipboard environment for guests and crew alike, but this non-toxic, chemical-free system also saves more than one million gallons of water each year in our cleaning procedures, and reduces our carbon footprint as well as the amount of plastic and waste in our supply chain.



## Special Offers

### SUITE EXCLUSIVES

Spacious living areas and incredible views immerse you in the beauty of your marine surroundings. Our new Suite Exclusives package helps make your voyage all the more memorable. [Learn more](#)

### 10% OFF BACK-TO-BACK VOYAGES

Save 10% on consecutive departures, applicable on voyage fares only and not valid on extensions or airfare. Valid for new bookings only, subject to availability, and may not be combined with other offers. Call for details.

### BRINGING THE KIDS

We believe sharing an expedition with children is a life-enhancing experience. Save \$500 for each child under the age of 18 on any departure. Not applicable on extensions or airfare. Call for details.

### CELEBRATE LIFE'S MILESTONES

Celebrate a milestone with a group of eight or more and enjoy a special amenity package including: 5% savings on voyage fares, custom group photo, US\$150 shipboard credit for the group, and other special gifts. Milestone celebration to be communicated at time of booking.

### SAVE 5% TRAVELING AS A GROUP

Save 5% when traveling as a group of eight or more people. Valid on voyage fares only and not applicable on extensions or airfare. Deposit, final payments, and cancellation policies for group travel vary from our regular policies. Valid for new bookings only, subject to availability, and may not be combined with other

offers. Call for details.

### PAY BY DEBIT: EARN A \$100 ONBOARD CREDIT

The \$100 onboard credit offer is applied after the final payment and requires 85% of the cost of the voyage to be placed on a debit card. Maximum of one \$100 onboard credit per cabin. The \$100 onboard credit is a non-refundable, non-transferable credit that can be used for various onboard purchases such as global gallery and spa treatments. It has no cash value, cannot be refunded if not fully utilized, and will be forfeited if not fully redeemed by the end of the voyage. This offer is combinable with other offers. If the booking is altered or canceled, the onboard credit may be forfeited, and it cannot be transferred if the booking is moved to another guest. Lindblad Expeditions reserves the right to modify or cancel the offer without prior notice. Offer applies to Lindblad Expeditions' owned ships only. Offer valid only for Debit Cards issued in the United States for payments made from the United States.

### COMBINING OFFERS

Certain offers may be combinable, up to two savings opportunities, except where noted otherwise. For example, travel with a group of 8 or more on back-to-back expeditions, and take advantage of both savings.

## Included in price

All accommodations aboard ship or in hotels per itinerary; all meals as indicated in the itinerary, both aboard and onshore; beer, wine, cocktails, liquors and spirits aboard the ship (except certain premium brands which are available for purchase); hors d'oeuvres, 24-hour access to snacks, premium coffees and teas, non-alcoholic beverages, and filtered water; excursions and airport transfers to and from recommended flights, as indicated in the itinerary; crew gratuities; exploration tools curated to destination, such as Zodiacs, kayaks, guidance and company of our leading expedition staff; assistance by the National Geographic Photographer and Lindblad Expeditions-National Geographic certified photo instructor; access to the OM System Photo Gear Locker; presentations by expedition staff and expert guest speakers; complimentary parka or jacket, complimentary reusable water bottle; onboard physician consultations; morning stretch classes and 24-hour access to exercise equipment; 24-hour access to lounges, observation decks, library, and other shared spaces; park and site entrance fees, special access permits, and port taxes. Unused services or items included in our programs are non-refundable.

## Not included in price

Airfare (except flights\* when indicated as included); pre- and post-expedition extensions; additional hotel nights (except when indicated as included); private transfers; laundry, spa treatments, Wi-Fi, and phone services (except when indicated as included); travel protection plans; and passport, visa, and immigration fees.

\*Recommended flight costs include flight(s) that take place during the date range of your trip to transport travelers from one itinerary destination to another. This cost also includes ground transportation, luggage transfer, and airport assistance. If you prefer to arrange your own flights privately, have alternate means of transport, or wish to modify at a later time, please contact an Expedition Specialist at 1.833.400.0831

Additional costs associated with medical services outside onboard physician consultation.

For select voyages, completing a medical evaluation form with VIKAND is required. If you utilize your physician,

VIKAND's processing fee for your documentation will be added to your National Geographic-Lindblad Expeditions invoice. If you utilize VIKAND's physicians, an additional charge will be due and payable directly to VIKAND.

## Travel protection plan

We strongly recommend our guests to take advantage of our Travel Protection Plan. This plan offers comprehensive coverage to protect you from cancellation fees, costs incurred due to trip delays/interruption, damage or loss of baggage, medical assistance, and evacuation during your travels. Our Travel Protection Plan is available for U.S. residents only, and may be purchased any time prior to final payment due date, Travel Protection premiums are non-refundable once plan is purchased. Learn more about our Travel Protection "Plus" Plan: <https://www.expeditions.com/terms-conditions/travel-protection-plan/>

## Cancellation policy

Review our cancellation policy: <https://www.expeditions.com/cancellation-policy/>