



Patagonia & South America
54° 6' S 69° 21' W

Southern Patagonia: Glaciers, Fjords and Wildlife

Sculpted over millennia of advancing and retreating glaciers deep in the wilds of Patagonia, the Chilean fjords are a mesmerizing network of soaring snow-capped peaks and deep valleys home to extraordinary wildlife—thousands of Magellanic penguins, along with sea lions, elephant seals, dolphins, and more, make their home here. Boasting UNESCO-listed biospheres and accessing private reserves, this immersive journey explores Torres del Paine, Glacier Alley, Cape Horn, and Isla de los Estados by Zodiac, kayak, and on foot.

From
\$ 22,315 / per person
Does not include flights

	DATES Feb		DURATION 17 Days
	SHIPS <i>National Geographic Resolution</i>		
	STARTS AT Ushuaia, Argentina	→	 ENDS AT Ushuaia, Argentina

ROUTING REMINDER: *National Geographic Resolution* departures route roundtrip via Santiago; *National Geographic Explorer* and *National Geographic Endurance* route roundtrip via Buenos Aires. Please confirm the route of your departure at the time of booking with an Expedition Specialist of the Lindblad Air Department before making flight arrangements.

Highlights

- ★ Traverse UNESCO-listed Glacier Alley, home to the stunning Garibaldi Glacier and rich with wildlife, brash ice, and bergy bits
- ★ Explore Francisco Coloane Marine Park by Zodiac to see humpback whales, dolphins, sea lions, and Magellanic penguins on Rupert Isle
- ★ Delve into the wonders of Torres del Paine, A UNESCO Biosphere Reserve where extraordinary wilderness and wildlife reigns supreme
- ★ By special permission, explore Tierra del Fuego's Karukinka Natural Park, a private reserve that harbors culpeo foxes, guanacos, albatross, Andean condors, elephant seals, and more

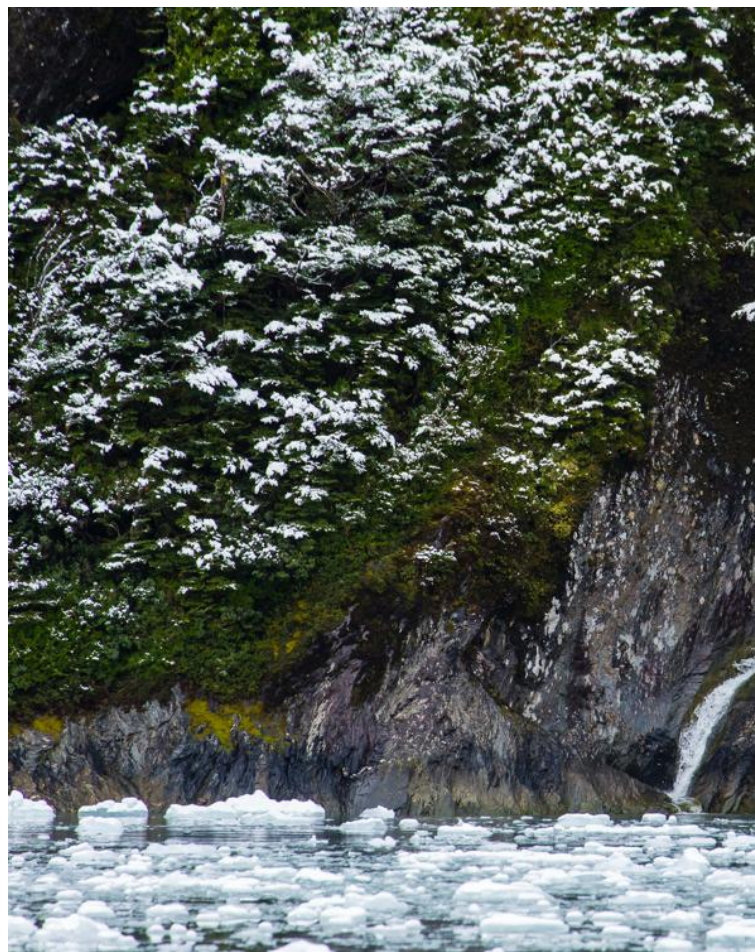



Day by day

■ DAY 1

Santiago, Chile

Arrive in Santiago, the capital city of Chile. Set against the Andes and Chilean Coastal mountain ranges, Santiago is home to half of the country's population. Transfer from the airport to the Ritz-Carlton, Santiago (or similar).

◇ DAY 2

Ushuaia / Embark Ship

Fly to Ushuaia, the southernmost city in the world. Before embarking, relax and enjoy lunch on a catamaran cruise of the Beagle Channel.

Meals included: breakfast, lunch, dinner

◇ DAYS 3-4

Exploring the Chilean Fjords: Glacier Alley

Sail into a vast wilderness of snow-capped peaks, mirror-like lakes, thick glaciers and islets blanketed with vegetation. In this pristine landscape, myriad fjords or *senos* cut between soaring granite walls and waterfalls splash down from high above.

The region you'll explore for the next two days is known as Glacier Alley. This entire region is part of a greater UNESCO Biosphere Reserve focusing on the Magallanes Sub-Antarctic Evergreen Rainforest. This incredibly biodiverse region arose with the retreat of the glaciers which formed these fjords.

Begin at Seno Pia, a secluded fjord in the northwestern arm of the Beagle Channel with an impressively large glacier at its terminus. Next is Seno Garibaldi, part of Alberto de Agostini National Park, a dramatic region where the formidable Andes meet the sea. Visit the Garibaldi Glacier by Zodiac and ship, marveling at this stunning wall of ice. Seno

Agostini is the origin of numerous glaciers from the nearby mountains. Explore this region from Zodiacs, getting close to floating brash ice and bergy bits, watching for wildlife and hoping to witness the thundering process of glacial calving.

Meals included: breakfast, lunch, dinner

◇ DAY 5

Francisco Coloane Marine Park

Located in the Strait of Magellan, Francisco Coloane Marine Park is the largest marine protected area along the Chilean coast, and it was also the first, established in 2003. This productive area supports vast and unique biological diversity, which will be the focus of your visit. A large summer population of humpback whales uses these waters as feeding grounds, as do South American sea lions. Black and white Peale's dolphins are frequently seen, and you'll search for the endemic and endangered Chilean dolphin. Explore the marine park by Zodiac, kayak and on foot. Search for large marine and terrestrial birds, including the Andean condor or the giant Antarctic petrel, and on Rupert Islet you'll visit a large Magellanic penguin colony.

Meals included: breakfast, lunch, dinner

◇ DAYS 6-7

Puerto Natales / Torres del Paine

Our next two days will be spent exploring the region around Puerto Natales and Torres del Paine National Park, a UNESCO Biosphere Reserve. After driving to the park, you'll have the option to trek on foot or explore part of the park by vehicle. The landscape is big, wide and sprawling, with some of the most dramatic mountain scenery anywhere and wildlife that includes rheas, foxes and herds of guanaco. You'll discover one of the most spectacular and wildlife-rich areas in the Americas, covering 450,000

acres of glaciers, forests, grasslands, rivers and gem-colored lagoons, crowned with the pinnacles of Torres del Paine. Enjoy opportunities to look for Andean condors or hike the beautiful terrain of the region.

Meals included: breakfast, lunch, dinner

◇ DAYS 8-9

Kirke Narrows

After a final morning in Puerto Natales, you'll have two days to continue your exploration of the Chilean fjords. Your Captain and local pilots guide the ship through Kirke Narrows, accessible only to a small expedition ship such as *National Geographic Resolution*. While the wildlife of the region will leave you speechless, the combination of unspoiled scenery, national parks and lush Magellanic forests is what makes the fjords of Chile so captivating. Explore the extensive maze of pristine channels and islands by Zodiac and kayak or take a walk in the surrounding forest.

Meals included: breakfast, lunch, dinner

◇ DAY 10

Punta Arenas / Isla Magdalena

Arrive in Punta Arenas, the largest city in Patagonia. With local guides, you'll visit the historic center of the city, the Plaza de Armas and a local handicraft market. Visit the Patagonia Institute and the Salesian Museum to learn the region's archaeology and wildlife. Alternatively, go for a hike in the Magallanes National Reserve, which offers outstanding views of the valley below and of Punta Arenas. Later, be on deck as your privately-chartered catamaran navigates the Strait of Magellan, en route to Isla Magdalena. The island has been designated a national nature reserve because of its importance as a penguin breeding site. Go ashore at the Penguins National Nature Reserve and witness Magellanic penguins in one of the most accessible Magellanic penguin rookeries in the world. Photo opportunities

abound here.

Meals included: breakfast, lunch, dinner

◇ DAYS 11-12

Karukinka Natural Park / Bahia Ainsworth

Continue to the newest and largest protected area on Tierra del Fuego: Karukinka, meaning "our land" in the language of the ancient inhabitants. By special permission, visit this private reserve, which harbors abundant wildlife, including endangered culpeo foxes, guanacos, blackbrowed albatross, Andean condors and elephant seals. On your last day in the Chilean fjords, set out to explore in Zodiacs and kayaks and on foot. Visit Bahía Ainsworth, at the base of Marinelli Glacier, to explore the subpolar Magellan Forest. Keep an eye out for southern elephant seals along the beach.

Meals included: breakfast, lunch, dinner

◇ DAYS 13-16

Cape Horn / Isla de los Estados (Staten Island), Argentina

Visit Cape Horn, the southernmost tip of the South American continent. Conditions permitting, make a landing to look out at the waters of the Drake Passage.

Continue to Isla de los Estados, whose wild, untouched landscapes are home to Magellanic penguins, fur seals, otters, sea lions and countless water birds. National Geographic-Lindblad Expeditions has received special permission to visit here. The exact schedule will remain flexible to take best advantage of conditions for exploring this natural wonderland. See a reconstruction of the 1884 San Juan de Salvamento "Lighthouse at the End of the World," which inspired Jules Verne's novel of the same name. The *National Geographic Resolution* is one of the few expedition ships to be granted access here, and the experience is bound to

be unforgettable.

Meals included: breakfast, lunch, dinner

■ DAY 17

Ushuaia / Santiago

Disembark in Ushuaia and take the recommended flight to Santiago to connect with your overnight flight home.

Meals included: breakfast

Expedition

Ushuaia, Argentina → Ushuaia, Argentina

2026 Departure Dates

Aboard *National Geographic Resolution*

25 Feb			
--------	--	--	--



National Geographic Resolution

Guests

138

Cabins

76

**The sister ship to *National Geographic Endurance*,
she explores polar & temperate regions**

Our second new polar build, *National Geographic Resolution*, is named to honor the second voyage of the legendary Captain James Cook.

A fully-stabilized vessel of the highest ice class (PC5 Category A), she will enable adventurous guests to go where few have or can. *Resolution's* most striking exterior feature is her distinctive profile, the patented X-Bow®, a game-changing design that guarantees the smoothest, most comfortable ride in all kinds of conditions; and since it eliminates bow impact, a quieter ride, as well.

An equally impressive feature may well be her capacity: she carries just 138 guests, a commitment to expedition excellence over scale. Scandinavian-inflected, luxuriously appointed, her inviting interiors would be a destination in themselves. Because she is a Lindblad expedition ship, however, her attention is focused on the world outside— with acres of window glass to keep you connected to the stunning views beyond the pane, and a fleet of expedition tools to get you out exploring.

National Geographic Endurance and *National Geographic Resolution* are next-generation expedition ships. Purpose-built for polar navigation. Fully stabilized, highly strengthened, ice-class Polar Code PC5 (Category A) vessels, they are designed to navigate polar passages year-round, and safely explore uncharted waters, while providing exceptional comfort. The patented X-bow[®] is key to their design; its powerful wave-slicing action provides an extremely smooth ride even in adverse conditions, and even reduces spray on deck for superior observation. They carry a full suite of expedition tools, and offer a variety of experience enhancing amenities.

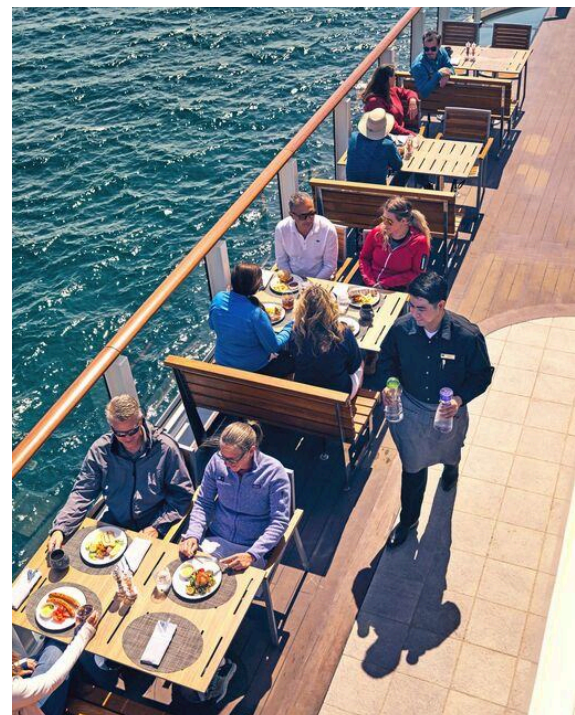

Cabin Categories

Category 1

Fore Deck: #404, 406, 408, 411, 413, 415

Cabin with two large windows, two singles that can convert to a queen, writing desk and chair, two bedside tables, window sofa, coffee table, and a closet.



Category 2

Fore Deck: #410, 412, 414, 416-419, 421-427

Cabin with two large windows, two single beds that can convert to a queen, window sofa, two-seat sofa, coffee table, writing desk with an office chair, two bedside tables, coffee table, and a closet.



Category 3

Main Deck: #512, 514-524

Cabin with balcony that features two balcony chairs, hammock, and a table; two single beds that convert to a queen; convertible sleeper sofa; writing desk with a chair; two bedside tables; coffee table; and a closet.



Category 4

Lounge Deck: #608, 610, 612, 613-623

Cabin with balcony that features two balcony chairs, hammock and a table; two single beds that can convert to a queen; pull-out sofa; coffee table; writing desk with chair; two bedside tables; and a closet.



Category 5

Bridge Deck: #700-707, 712, 713, 715, 717

Cabin with balcony that features two balcony chairs, hammock, and a table; two single beds that convert to a queen; convertible sleeper sofa; coffee table; writing desk with chair; two bedside tables; and a closet.



Category 6

Bridge Deck: #714

Junior suite with balcony that features two balcony chairs, hammock, and table; two single beds that convert to a queen; pull-out sofa; writing desk with chair; two bedside tables; coffee table; espresso maker and a closet. Guests receive priority access to one spa treatment and one igloo reservation and complementary laundry per departure.

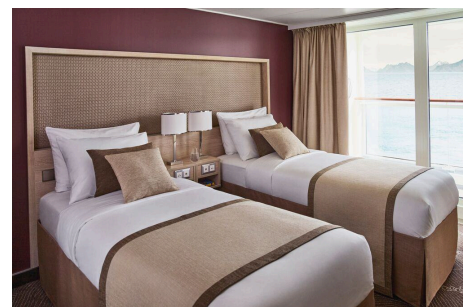

Category 7

Bridge Deck: #708-711, 716, 718, 719, 721

These large balcony suites feature two balcony chairs, hammock, and table; two single beds that can convert to a queen; pull-out sofa; coffee table; writing desk and chair; espresso maker; and a large walk-in closet with full length mirror. Expanded bathroom has a double vanity, bathtub, towel warmer and rain shower. Guests receive priority access to one spa treatment and one igloo reservation and complementary laundry per departure.

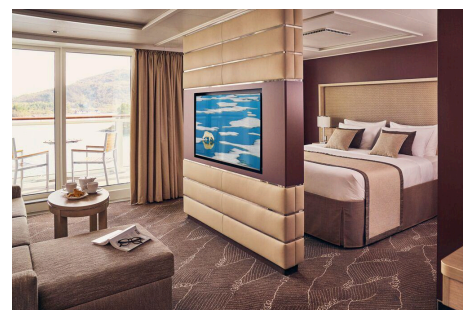

Category A Solo

Main Deck: #504, 506-511, 513

Cabin with balcony that features two balcony chairs, hammock, and a table; single bed; writing desk with an office chair; and a closet.



Category B Solo

Lounge Deck: #604-607, 609, 611

Cabin with balcony that features two balcony chairs, hammock, and a table; single bed; writing desk with chair; hammock; and a closet.



Observation Deck

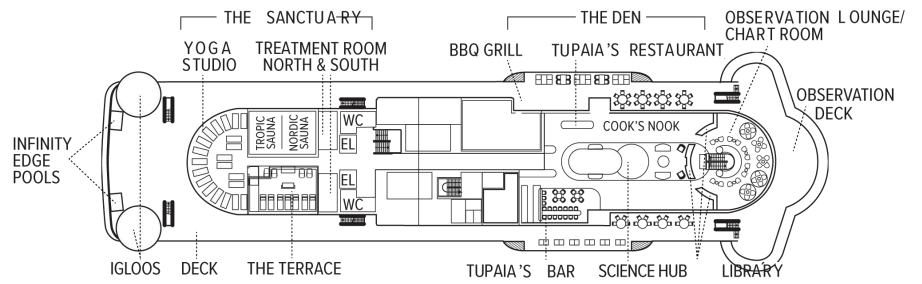

Bridge Deck

- Category 5
- Category 6
- Category 7

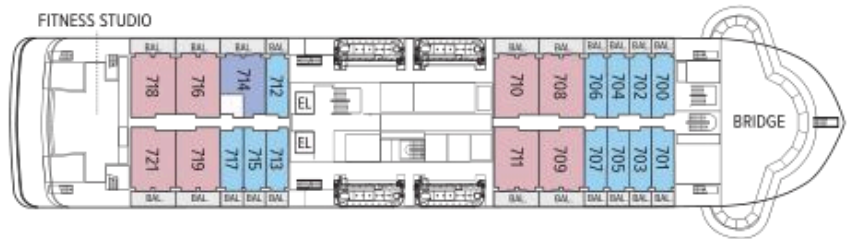

Lounge Deck

- Category 4
- Category B Solo

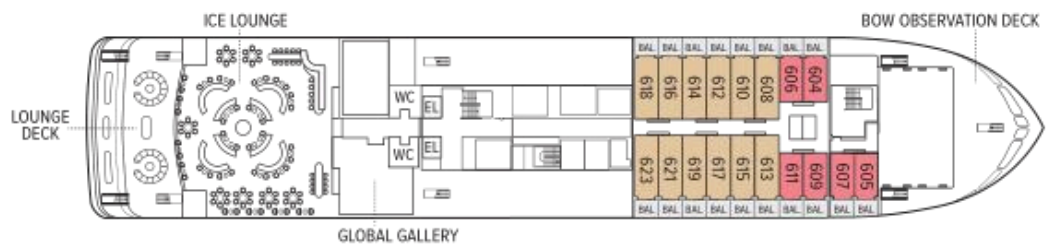

Main Deck

- Category 3
- Category A Solo



Fore Deck

- Category 1
- Category 2



Expedition Deck

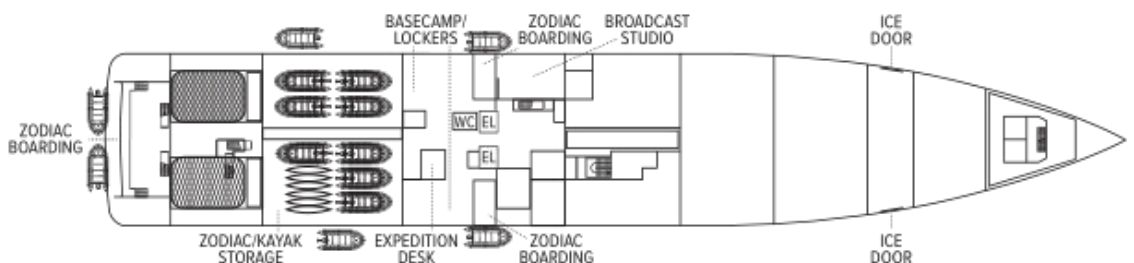

Ship amenities

Public Areas

Reception; three dining areas; an observation lounge with bar, gym, wellness area, infinity-style outdoor hot tubs with adjacent igloos; library; main lounge with full service bar, 24-hour beverage station, state-of-the-art tech for films/presentations; B&H Photo locker and a photo workshop area; science hub; an onboard broadcast studio; an expedition base with lockers for expedition gear; and open access to the Bridge, Captain, officers and on-duty wildlife spotters.

Meals

Restaurant 270° features wrap-around views; two other dining areas offer lighter, made-to-order fare or intimate, small group dinners. All feature sustainable choices, local where possible, and unassigned, flexible, inclusive seating.

Cabins

All cabins face outside with large windows, private bathroom, and climate controls. Cabins are equipped with expedition command centers with iPad tablets, multiple electrical and USB outlets, TVs, with on demand entertainment, phone, Wi-Fi, clock, barometers, hygrometers, vanity mirror, mini refrigerator, small safe, ice bucket, glasses, hair dryer, reading lights and National Geographic Atlas. Luxury linens and pillows. Bathrooms outfitted with Rain showers & hand held shower, botanically inspired shampoo, conditioner, shower gel and lotion. Complimentary insulated water bottles. Balcony cabins have hammocks, chairs and table.

Expedition Equipment

Zodiac landing craft, kayaks, snowshoes, cross-country skis, an ROV and underwater video camera for unique access to the polar undersea, hydrophone, aerial remote-controlled camera and video microscope.

Special Features

A full-time doctor, undersea specialist, National Geographic photographer, Lindblad-National Geographic certified photo instructor and video chronicler, an internet cafe and laundry. A forward and aft staircase, and elevators, reach all decks. Echoing the pioneering installation aboard *National Geographic Endurance*, artist Zaria Forman has curated a new exhibit, featuring a wide range of artists.



Wellness

A glass-enclosed yoga studio, gym, treatment rooms and spa relax area, and high and low-heat saunas with ocean views, staffed by wellness specialists.

Self-Disinfecting Ships

ACT Clean Coat™ is a light-activated, self-disinfecting cleaning process that continuously breaks down viruses, bacteria, mold, and airborne allergens across all ship surfaces. Not only does this create a cleaner, healthier shipboard environment for guests and crew alike, but this non-toxic, chemical-free system also saves more than one million gallons of water each year in our cleaning procedures, and reduces our carbon footprint as well as the amount of plastic and waste in our supply chain.

Special Offers

60% reduced deposit for any 2026 voyage

Book between June 3 and August 1, 2025 and receive 60% off the deposit due at the time of booking. Remaining deposit balance is due at the time of final payment. Additional restrictions may apply. Offer valid for new bookings only on 2026 departures, subject to availability and offer may be withdrawn at any time without prior notice, not applicable on airfare or extensions, and may not be combined with other offers. Call for details.

SUITE EXCLUSIVES

Spacious living areas and incredible views immerse you in the beauty of your marine surroundings. Our new Suite Exclusives package helps make your voyage all the more memorable. [Learn more](#)

CELEBRATE LIFE'S MILESTONES

Celebrate a milestone with a group of eight or more and enjoy a special amenity package including: 5% savings on voyage fares, custom group photo, US\$150 shipboard credit for the group, and other special gifts. Milestone celebration to be communicated at time of booking.

SAVE 5% TRAVELING AS A GROUP

Save 5% when traveling as a group of eight or more people. Valid on voyage fares only and not applicable on extensions or airfare. Deposit, final payments, and cancellation policies for group travel vary from our regular policies. Valid for new bookings only, subject to availability, and may not be combined with other offers. Call for details.

PAY BY DEBIT: EARN A \$100 ONBOARD

CREDIT

The \$100 onboard credit offer is applied after the final payment and requires 85% of the cost of the voyage to be placed on a debit card. Maximum of one \$100 onboard credit per cabin. The \$100 onboard credit is a non-refundable, non-transferable credit that can be used for various onboard purchases such as global gallery and spa treatments. It has no cash value, cannot be refunded if not fully utilized, and will be forfeited if not fully redeemed by the end of the voyage. This offer is combinable with other offers. If the booking is altered or canceled, the onboard credit may be forfeited, and it cannot be transferred if the booking is moved to another guest. Lindblad Expeditions reserves the right to modify or cancel the offer without prior notice. Offer applies to Lindblad Expeditions' owned ships only. Offer valid only for Debit Cards issued in the United States for payments made from the United States.

COMBINING OFFERS

Certain offers may be combinable, up to two savings opportunities, except where noted otherwise. For example, travel with a group of 8 or more on back-to-back expeditions, and take advantage of both savings.

Included in price

All accommodations aboard ship or in hotels per itinerary; all meals as indicated in the itinerary, both aboard and onshore; beer, wine, cocktails, liquors and spirits aboard the ship (except certain premium brands which are available for purchase); hors d'oeuvres, 24-hour access to snacks, premium coffees and teas, non-alcoholic beverages, and filtered water; excursions and airport transfers, as indicated in the itinerary, as indicated in the itinerary; crew gratuities; exploration tools curated to destination, such as Zodiacs and kayaks; guidance and company of our leading expedition staff; assistance by the National Geographic photographer and National Geographic-Lindblad Expeditions certified photo instructor; Basic Wi-Fi aboard ship; complimentary reusable water bottle; access to the OM System Photo Gear Locker; presentations by expedition staff and expert guest speakers; complimentary reusable water bottle; onboard physician consultations; morning stretch classes and 24-hour access to exercise equipment; 24-hour access to lounges, observation decks, library, and other shared spaces; park and site entrance fees, special access permits, and port taxes. Unused services or items included in our programs are non-refundable.

Not included in price

Airfare (except flights* when indicated as included); pre- and post-expedition extensions; additional hotel nights (except when indicated as included); private transfers; laundry, spa treatments, enhanced and premium Wi-Fi plans aboard expedition fleet; phone services (except when indicated as included); travel protection plans; and passport, visa, and immigration fees.

*Recommended flight costs include flight(s) that take place during the date range of your trip to transport travelers from one itinerary destination to another. This cost also includes ground transportation, luggage transfer, and airport assistance. If you prefer to arrange your own flights privately, have alternate means of transport, or wish to modify at a later time, please contact an Expedition Specialist at 1.833.400.0831

Additional costs associated with medical services outside onboard physician consultation.

Travel protection plan

We strongly recommend our guests to take advantage of our Travel Protection Plan. This plan offers comprehensive coverage to protect you from cancellation fees, costs incurred due to trip delays/interruption, damage or loss of baggage, medical assistance, and evacuation during your travels. Our Travel Protection Plan is available for U.S. residents only, and may be purchased any time prior to final payment due date. Travel Protection premiums are non-refundable once plan is purchased. Learn more about our Travel Protection "Plus" Plan: <https://www.expeditions.com/terms-conditions/travel-protection-plan/>

Cancellation policy

Review our cancellation policy: <https://www.expeditions.com/cancellation-policy/>