

Europe, British and Irish Isles, , Scandinavia & Scotland  
69° 38' N 18° 57' E

## Coastal Norwegian Voyage: Between Tromsø and Edinburgh

Venture through Norway's iconic fjords and north of the Arctic Circle on an immersive voyage that connects you with indescribable natural beauty and rich Nordic culture. Explore glacier-carved landscapes while kayaking, Zodiac cruising, and hiking amid cascading waterfalls, towering cliffs, and tranquil lakes fed by fresh meltwater. Sail among enchanted places like the Lofoten Islands and Møre og Romsdal where diverse wildlife thrives on rugged shores. For centuries, the region's waterways carried both merchants and storied Arctic explorers, and you'll delve deeper into their history in picturesque port cities, from Bergen to Tromsø.

From  
**\$ 11,587** / per person  
Does not include flights



**DATES**  
May



**DURATION**  
11 Days



**SHIPS**  
*National Geographic Endurance*



**STARTS AT**  
Tromsø,  
Norway



**ENDS AT**  
Edinburgh,  
Scotland



## Highlights

- ★ Sail into Norway's stunning, waterfall-laced fjords to discover their pristine beauty by kayak, Zodiac, or on foot
- ★ Learn the Hanseatic legacy of Bergen as you explore its charming wharf and colorful wooden buildings, designated a UNESCO World Heritage site
- ★ Visit Tromsø, known as the "Gateway to the Arctic," and learn about the many historic Arctic expeditions that set off from the city
- ★ Witness abundant birdlife and search for whales and other wildlife in the magical Lofoten Islands, Møre og Romsdal, and Tysfjorden







## Day by day

### ■ DAY 1

#### Tromsø, Norway / Embark Ship

Arrive in Tromsø, known as the “gateway to the Arctic” due to the large number of Arctic expeditions that originate here. Transfer to your meeting place in the city before spending the day at your own pace exploring the sights, sounds and tastes of this Arctic capital.

Meals included: dinner

### ◇ DAY 2

#### Senja Island

This morning, the expedition begins with a landing on Senja Island, Norway’s second largest island known for its diverse landscape and a wealth of opportunities to actively explore the natural beauty. Capture panoramic landscapes alongside your Certified Photo Instructor, glide among islands in a kayak, or take to the mountainside trails on a hike through valleys and peaks.

Meals included: breakfast, lunch, dinner

### ◇ DAY 3

#### Lofoten Islands

The Lofoten archipelago boasts an enchanting landscape of picturesque villages ringed by jagged, granite peaks. Explore an idyllic village as you venture through an area known throughout the centuries for its dramatic landscapes and cod fishing traditions. Along the way, choose to hike up to one of the region’s most iconic overlooks across granite stairs or opt for water-level views on a Zodiac cruise that will offer another perspective of the striking scenery.

Meals included: breakfast, lunch, dinner

### ◇ DAY 4

### At Sea

Spend a relaxing day at sea sailing along the Norwegian Coast. Join your officers on the Bridge and keep a watchful eye for migrating whales, or attend a presentation led by naturalists and experts. Take advantage of the amenities on board throughout the day at your leisure.

Meals included: breakfast, lunch, dinner

### ◇ DAY 5

#### Møre og Romsdal

One of the most famous regions of the Norwegian fjords, the Møre og Romsdal name comes from old Norse meaning ‘archipelago of islands.’ Spend the morning exploring one of these outer islands known for its scientific center for seabirds and expansive bird cliffs. As the species populations migrate throughout the year, you’ll have the chance to observe various birds, including storm petrels, auks, kittiwakes, gannets, or fulmars. This afternoon, venture into the region’s storied fjords and watch as the Bridge team navigates narrow gorges and spectacular scenery.

Meals included: breakfast, lunch, dinner

### ◇ DAY 6

#### Loen

The stunning, glacial mountain landscape of Nordfjord is a haven for adventurers and photographers alike. Travel by cable car to Mount Hoven, offering panoramic views on a clear day across the peaks and fjords of the region. Make sure your hiking shoes are ready to traverse the numerous trails and overlooks across this beautiful mountain and your camera is at hand to capture the wealth of photo ops, including Lovatnet Lake filled with meltwater from the surroundings glaciers.

Meals included: breakfast, lunch, dinner

## ◇ DAY 7

### Bergen

Arrive in Bergen, a storied city once known as the capital of the Hanseatic League. Take a guided walk through the historic and colorful Bryggens Wharf, a UNESCO World Heritage site or visit the Maritime Museum that shares a unique glimpse at Norwegian history. Later on, choose to wander among the wooden houses and local shops, taste some of the gastronomic specialties, or explore the trails above the city for spectacular views of the fjord below.

Meals included: breakfast, lunch, dinner

## ◇ DAYS 8-9

### At Sea / Shetland Islands, Scotland

Sail across the North Sea, a connecting route between Shetland and Norse Kingdoms and Shetland as far back as the 9th century, and enjoy the time on board to edit photographs or schedule a massage with a wellness specialist. In the afternoon, arrive at the Shetland Islands, which are characterized by deep-seated cultural traditions and dramatic, windswept landscapes. As a part of the Norwegian kingdom for over four centuries, Shetland continues to have strong Nordic ties. Explore these ancient, rural islands with locals by your side as you delve into their farming, maritime and musical traditions.

Meals included: breakfast, lunch, dinner

## ◇ DAY 10

### At Sea / Firth of Forth

Spend the day sailing along the Northern Isles as the ship makes her way south towards Edinburgh. This evening, enjoy cruising throughout the Firth of Forth. The term "firth" originates from the Norse word fjord, meaning a narrow inlet. The Firth outside of Edinburgh is formed by multiple rivers flowing

into the North Sea and is dotted with islands, each with their own unique history. Aboard your nimble expedition ship, you'll sail past these historic islands and soak in your last night in the Scottish Isles.

Meals included: breakfast, lunch, dinner

## ■ DAY 11

### Edinburgh / Disembark Ship

Disembark in Edinburgh and transfer to the airport for flights home.

Meals included: breakfast

### Southbound

Tromsø, Norway → Edinburgh, Scotland

### 2026 Departure Dates

Aboard *National Geographic Endurance*

13 May			
--------	--	--	--

### Alternative Routes

Visit [Expeditions.com](http://Expeditions.com) for more information.

### 2026 Departure Dates

03 May
--------



## National Geographic Endurance

---

Guests	Cabins
138	76

---

The most advanced ice-class expedition ship afloat, the *National Geographic Endurance* offers unprecedented access to polar regions.

The first new polar build in Lindblad's 50-year history, *National Geographic Endurance* is named to honor explorer Ernest Shackleton and his legendary Transantarctic Expedition.

A fully-stabilized vessel of the highest ice class (PC5 Category A), she will enable adventurous guests to go where few have or can. Endurance's most striking exterior feature is her distinctive profile, the patented X-Bow®, a game-changing design that guarantees the smoothest, most comfortable ride in all kinds of conditions; and since it eliminates bow impact, a quieter ride, as well.



An equally impressive feature may well be her capacity: she carries just 138 guests, a commitment to expedition excellence over scale. Scandinavian-inflected, luxuriously appointed, her inviting interiors would be a destination in themselves. Because she is a Lindblad expedition ship, however, her attention is focused on the world outside—with acres of window glass to keep you connected to the stunning views beyond the pane, and a fleet of expedition tools to get you out exploring.

*National Geographic Endurance* and *National Geographic Resolution* are next-generation expedition ships. Purpose-built for polar navigation. Fully stabilized, highly strengthened, ice-class Polar Code PC5 (Category A) vessels, they are designed to navigate polar passages year-round, and safely explore uncharted waters, while providing exceptional comfort. The patented X-bow<sup>®</sup> is key to their design; its powerful wave-slicing action provides an extremely smooth ride even in adverse conditions, and even reduces spray on deck for superior observation. They carry a full suite of expedition tools, and offer a variety of experience enhancing amenities.

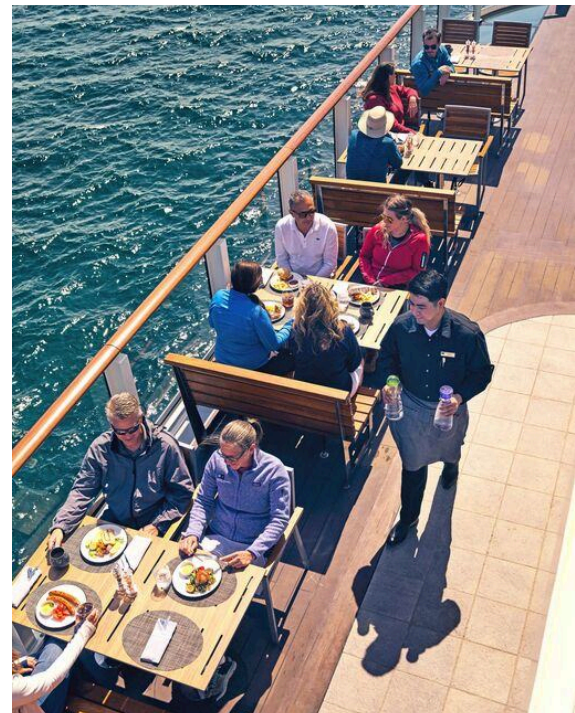
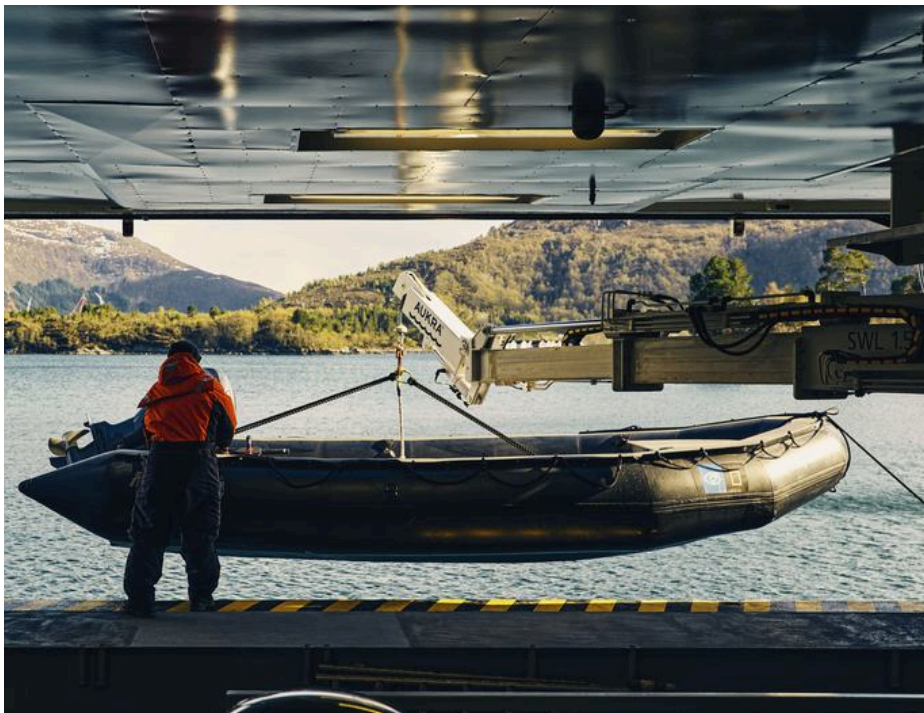



# Cabin Categories

## Category 1

**Fore Deck:** #404, 406, 408, 411, 413, 415

Fore Deck, with two large windows, two singles that can convert to a queen, armchair, writing desk and chair, two bedside tables, window sofa and a closet.



## Category 2

**Fore Deck:** #410, 412, 414, 416-419, 421-427

Fore Deck, with two large windows, two single beds that can convert to a queen, window sofa, two-seat sofa, coffee table, armchair, writing desk with an office chair, two bedside tables and a closet.



## Category 3

**Main Deck:** #512, 514-524

Cabin with balcony that features two balcony chairs, hammock, and a table; two single beds that convert to a queen; convertible sleeper sofa; writing desk with a chair; two bedside tables; coffee table; and a closet.



## Category 4

**Lounge Deck:** #608, 610, 612, 613-623

Cabin with balcony that features two balcony chairs, hammock and a table; two single beds that can convert to a queen; pull-out sofa; coffee table; writing desk with chair; two bedside tables; and a closet.



## Category 5

**Bridge Deck:** #700-707, 712, 713, 715, 717

Cabin with balcony that features two balcony chairs, hammock, and a table; two single beds that convert to a queen; convertible sleeper sofa; coffee table; writing desk with chair; two bedside tables; and a closet.



## Category 6

**Bridge Deck:** #714

Junior suite with balcony that features two balcony chairs, hammock, and table; two single beds that convert to a queen; pull-out sofa; writing desk with chair; two bedside tables; coffee table; espresso maker; and a closet. Guests receive priority access to one spa treatment and one igloo reservation and complementary laundry per departure.



## Category 7

**Bridge Deck:** #708-711, 716, 718, 719, 721

These large balcony suites feature two balcony chairs, hammock, and table; two single beds that can convert to a queen; pull-out sofa; coffee table; writing desk and chair; espresso maker; and a large walk-in closet with full length mirror. Expanded bathroom has a double vanity, bathtub, towel warmer and rain shower. Guests receive priority access to one spa treatment and one igloo reservation and complementary laundry per departure.



## Category A Solo

**Main Deck:** #504, 506-511, 513

Cabin with balcony that features two balcony chairs, hammock, and a table; single bed; writing desk with an office chair; and a closet.



## Category B Solo

**Lounge Deck:** #604-607, 609, 611

Cabin with balcony that features two balcony chairs, hammock, and a table; single bed; writing desk with chair; hammock; and a closet.





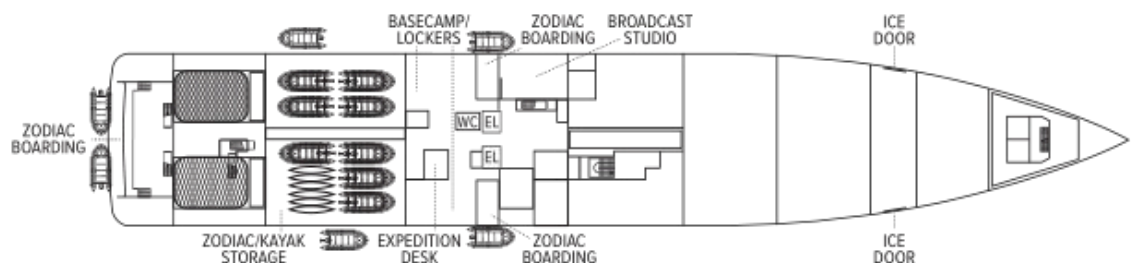
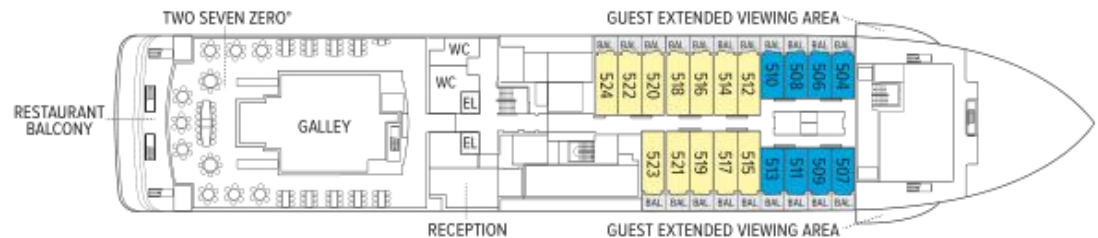
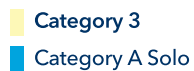
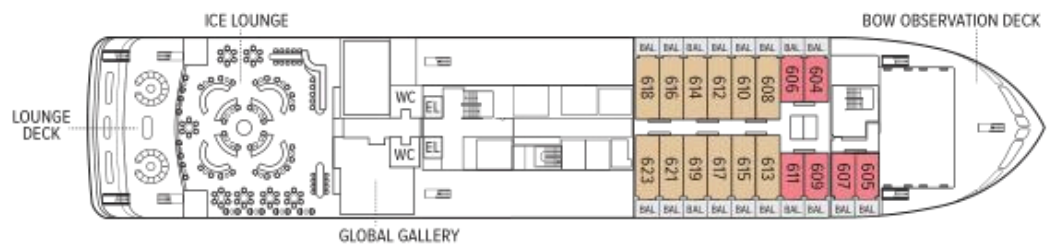
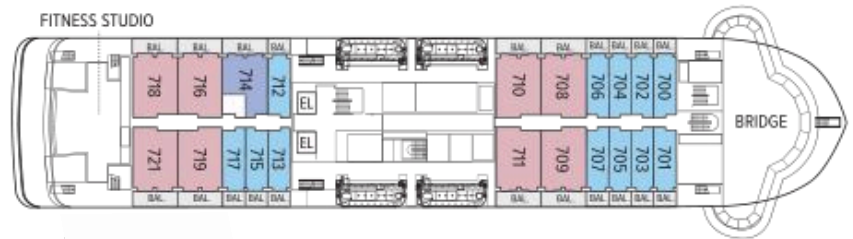
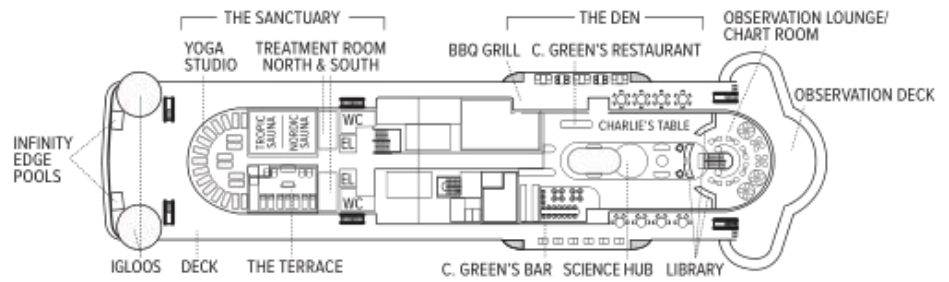

# Ship amenities

## Public Areas

Reception; three dining areas; an observation lounge with bar, gym, wellness area, infinity-style outdoor hot tubs with adjacent igloos; library; main lounge with full service bar, 24-hour beverage station, state-of-the-art tech for films/presentations; B&H Photo locker and a photo workshop area; science hub; an onboard broadcast studio; an expedition base with lockers for expedition gear; and open access to the Bridge, Captain, officers and on-duty wildlife spotters.

## Meals

Restaurant 270° features wrap-around views; two other dining areas offer lighter, made-to-order fare or intimate, small group dinners. All feature sustainable choices, local where possible, and unassigned, flexible, inclusive seating.

## Cabins

All cabins face outside with large windows, private bathroom, and climate controls. Cabins are equipped with expedition command centers with iPad tablets, multiple electrical and USB outlets, TVs, with on demand entertainment, phone, Wi-Fi, clock, barometers, hygrometers, vanity mirror, mini refrigerator, small safe, ice bucket, glasses, hair dryer, reading lights and National Geographic Atlas. Luxury linens and pillows. Bathrooms outfitted with Rain showers & hand held shower, botanically inspired shampoo, conditioner, shower gel and lotion. Complimentary insulated water bottles. Balcony cabins have hammocks, chairs and table.

## Expedition Equipment

Zodiac landing craft, kayaks, snowshoes, cross-country skis, an ROV and underwater video camera for unique access to the polar undersea, hydrophone, aerial remote-controlled camera and video microscope.

## Special Features

A full-time doctor, undersea specialist, National Geographic photographer, Lindblad-National Geographic certified photo instructor and video chronicler, an internet cafe and laundry. A forward and aft staircase, and elevators, reach all decks. Echoing the pioneering installation aboard *National Geographic Endurance*, artist Zaria Forman has curated a new exhibit, featuring a wide range of artists.



## Wellness

A glass-enclosed yoga studio, gym, treatment rooms and spa relax area, and high and low-heat saunas with ocean views, staffed by wellness specialists.

## Self-Disinfecting Ships

ACT Clean Coat™ is a light-activated, self-disinfecting cleaning process that continuously breaks down viruses, bacteria, mold, and airborne allergens across all ship surfaces. Not only does this create a cleaner, healthier shipboard environment for guests and crew alike, but this non-toxic, chemical-free system also saves more than one million gallons of water each year in our cleaning procedures, and reduces our carbon footprint as well as the amount of plastic and waste in our supply chain.



## Special Offers

### 60% reduced deposit for any 2026 voyage

Book between June 3 and August 1, 2025 and receive 60% off the deposit due at the time of booking. Remaining deposit balance is due at the time of final payment. Additional restrictions may apply. Offer valid for new bookings only on 2026 departures, subject to availability and offer may be withdrawn at any time without prior notice, not applicable on airfare or extensions, and may not be combined with other offers. Call for details.

### BRINGING THE KIDS

We believe sharing an expedition with children is a life-enhancing experience. Save \$500 for each child under the age of 18 on any departure. Not applicable on extensions or airfare. Call for details.

### CELEBRATE LIFE'S MILESTONES

Celebrate a milestone with a group of eight or more and enjoy a special amenity package including: 5% savings on voyage fares, custom group photo, US\$150 shipboard credit for the group, and other special gifts. Milestone celebration to be communicated at time of booking.

### 10% OFF BACK-TO-BACK VOYAGES

Save 10% on consecutive departures, applicable on voyage fares only and not valid on extensions or airfare. Valid for new bookings only, subject to availability, and may not be combined with other offers. Call for details.

### SAVE 5% TRAVELING AS A GROUP

Save 5% when traveling as a group of eight or more

people. Valid on voyage fares only and not applicable on extensions or airfare. Deposit, final payments, and cancellation policies for group travel vary from our regular policies. Valid for new bookings only, subject to availability, and may not be combined with other offers. Call for details.

### PAY BY DEBIT: EARN A \$100 ONBOARD CREDIT

The \$100 onboard credit offer is applied after the final payment and requires 85% of the cost of the voyage to be placed on a debit card. Maximum of one \$100 onboard credit per cabin. The \$100 onboard credit is a non-refundable, non-transferable credit that can be used for various onboard purchases such as global gallery and spa treatments. It has no cash value, cannot be refunded if not fully utilized, and will be forfeited if not fully redeemed by the end of the voyage. This offer is combinable with other offers. If the booking is altered or canceled, the onboard credit may be forfeited, and it cannot be transferred if the booking is moved to another guest. Lindblad Expeditions reserves the right to modify or cancel the offer without prior notice. Offer applies to Lindblad Expeditions' owned ships only. Offer valid only for Debit Cards issued in the United States for payments made from the United States.

### COMBINING OFFERS

Certain offers may be combinable, up to two savings opportunities, except where noted otherwise. For example, travel with a group of 8 or more on back-to-back expeditions, and take advantage of both savings.

## Included in price

All accommodations aboard ship or in hotels per itinerary; all meals as indicated in the itinerary, both aboard and onshore; beer, wine, cocktails, liquor and spirits aboard the ship (except certain premium brands which are available for purchase); hors d'oeuvres, 24-hour access to snacks, premium coffees and teas, non-alcoholic beverages, and filtered water; excursions and airport transfers to and from recommended flights, as indicated in the itinerary; crew gratuities; exploration tools curated to destination, such as Zodiacs and kayaks; guidance and company of our leading expedition staff; assistance by the National Geographic Photographer and Lindblad Expeditions-National Geographic certified photo instructor; access to the OM System Photo Gear Locker; presentations by expedition staff and expert guest speakers; complimentary reusable water bottle; onboard physician consultations; morning stretch classes and 24-hour access to exercise equipment; 24-hour access to lounges, observation decks, library, and other shared spaces; park and site entrance fees, special access permits, and port taxes. Unused services or items included in our programs are non-refundable.

## Not included in price

Airfare (except flights when indicated as included); pre- and post-expedition extensions; additional hotel nights (except when indicated as included); private transfers; laundry, spa treatments, Wi-Fi, and phone services (except when indicated as included); travel protection plans; and passport, visa, and immigration fees.

Additional costs associated with medical services outside onboard physician consultation.

## Travel protection plan

We strongly recommend our guests to take advantage of our Travel Protection Plan. This plan offers comprehensive coverage to protect you from cancellation fees, costs incurred due to trip delays/interruption, damage or loss of baggage, medical assistance, and evacuation during your travels. Our Travel Protection Plan is available for U.S. residents only, and may be purchased any time prior to final payment due date, Travel Protection premiums are non-refundable once plan is purchased. Learn more about our

Travel Protection "Plus" Plan: <https://www.expeditions.com/terms-conditions/travel-protection-plan/>

## Cancellation policy

Review our cancellation policy: <https://www.expeditions.com/cancellation-policy/>