









Coastal Wonders of Norway, the Faroe Islands and Iceland

Trace the route of early Viking explorers and see their influence in wild, remote lands. Cruise the famed Norwegian fjords and the magical Lofoten islands, explore Stone Age sites in Shetland, Scotland, and come face to face with the legacy of the Vikings amid the turf-roofed cottages and ancient sites of the Faroe Islands. Then trace Iceland's most remote shorelines, witnessing geological wonders from volcanoes to thundering waterfalls.

From
£13,694 / per person
 Does not include flights

 DATES Jun	 DURATION 15 Days
 SHIPS <i>National Geographic Resolution</i>	
 STARTS AT Tromsø, Norway	  ENDS AT Reykjavík, Iceland

Minimum Age Requirement: Any children booked on Antarctic or Arctic voyages must be at least 4 years old at time of embarkation.

Highlights

- ★ Sail into Norway's spectacular fjords and explore secluded inlets and coves by kayak or Zodiac
- ★ Observe nesting seabirds amid the towering peaks of the Lofoten islands, situated off Norway's northwestern coast
- ★ Encounter the Bronze Age ruins and Viking longhouses of Jarlshof, a prehistoric settlement in Shetland
- ★ Discover the unique culture of the Faroe Islands, where residents proudly share their age-old customs and traditions





Day by day

■ DAY 1

Tromsø, Norway / Embark Ship

Arrive in Tromsø, known as the “gateway to the Arctic” due to the large number of Arctic expeditions that originated here. Transfer to the meeting place in the city and spend the day exploring at your own pace. Check in with the hospitality desk this afternoon before embarking the ship.

Meals included: dinner

◇ DAY 2

Tysfjorden

Enter the long fjord of Tysfjorden, where only a few small villages cling to the rocky shores. Glide beneath the fjord’s steep walls explore the shore lines on your choice of expedition options, including zodiac cruising, kayaking or hiking, weather permitting.

Meals included: breakfast, lunch, dinner

◇ DAY 3

Lofoten Islands

The Lofoten archipelago boasts an enchanting landscape of picturesque villages ringed by jagged granite peaks. Enjoy village walks and island explorations as you venture through an area known for its dramatic landscapes and its cod fishing traditions throughout the centuries. A bit later, admire one of Norway’s most dramatic fjords from the deck as the ship navigates through Trollfjorden.

Meals included: breakfast, lunch, dinner

◇ DAYS 4-5

Exploring the Fjords of Norway

Carved by glaciers over millions of years, Norway’s northern coast is laced with steep-walled fjords, mountainous islands and chiseled peaks. Cruise in a Zodiac along vertical rock faces, kayak through serene fjords or go ashore on a secluded sandy beach to hike amid verdant valleys and birch forests.

Meals included: breakfast, lunch, dinner

◇ DAYS 6-8

At Sea / Shetland, Scotland

Spend a relaxing day at sea as you sail toward Shetland, an archipelago of about one hundred islands and islets located north of the Scottish mainland. Glide past the towering cliffs of Noss to look for murre, puffins, kittiwakes and other seabirds. This evening, dock overnight in Lerwick.

Lerwick is Shetland’s only official town with a little more than 7,000 inhabitants. Spend the morning delving into your choice of interests, from the ruins of Jarlshof, the Lighthouse and bird cliffs of Sumburgh Head, or by heading to the quieter western villages to hike, birdwatch and meet local fisherman. After dinner, the ship will attempt a landing at Foula, part of the Shetland Archipelago. Conditions permitting, enjoy an evening exploration on this remote island.

The last day in Shetland is spent anchored in a secluded fjord, just below the Hermness Nature Reserve. For nature lovers, there is no limit to the number of discoveries waiting along its paths, notably its extensive moorland and dramatic bird cliffs. For those looking to understand the cultural heritage of Shetland and the island of Unst, visit their cultural center and Viking project with

reconstructed longhouse.

Meals included: breakfast, lunch, dinner

◇ DAYS 9-10

The Faroe Islands

Arrive in the Faroe Islands, an autonomous archipelago within the Kingdom of Denmark. The legacy of the Vikings persists here, reflected in the language of the Faroese and their love of the sea. Visit Tórshavn, the colorful capital of the Faroe Islands, where even the government buildings are crafted in the traditional design of wooden siding with a turf roof. See the 12th-century St. Olav's Church alongside the ruins of Kirkjubøur Cathedral, which was never completed. Navigate through the islands to one of the local communities on Eysturoy, the second largest island in the Faroes. Enjoy a day alongside villagers, experiencing the warm hospitality and stunning landscapes of their beautiful fjord.

Meals included: breakfast, lunch, dinner

◇ DAYS 11-12

At Sea / Seyðisfjörður, Iceland / Grímsey

After a morning at sea, arrive at Iceland's rugged eastern coast, an unspoiled stretch of rocky outcrops, hidden coves and hills that beckon hikers. Visit Seyðisfjörður, known for its charming fishing village, or visit Skálanes Nature Reserve with its colorful wildflowers and bird cliffs. Continue to Grímsey on the Arctic Circle.

Meals included: breakfast, lunch, dinner

◇ DAYS 13-14

Westfjords

The Westfjords of Iceland are notably some of the most remote fjords in the country with many nooks and crannies or fjords and islands to explore. Spend two days enjoying expedition activities

across this dynamic corner of Iceland, meeting locals who call this region home and using the ship as a platform of adventure and discovery.

Meals included: breakfast, lunch, dinner

■ DAY 15

Reykjavík / Disembark Ship / Home

Disembark in Reykjavík and transfer to the airport for flights home.

Meals included: breakfast

Expedition

Tromsø, Norway → Reykjavík, Iceland

2026 DEPARTURE DATES

Aboard *National Geographic Resolution*

12 Jun				
--------	--	--	--	--



National Geographic Resolution

GUESTS

138

CABINS

76

The sister ship to *National Geographic Endurance*, she explores polar & temperate regions

Our second new polar build, *National Geographic Resolution*, is named to honor the second voyage of the legendary Captain James Cook. A fully-stabilized vessel of the highest ice class (PC5 Category A), she will enable adventurous guests to go where few have or can. Resolution's most striking exterior feature is her distinctive profile, the patented X-Bow®, a game-changing design that guarantees the smoothest, most comfortable ride in all kinds of conditions; and since it eliminates bow impact, a quieter ride, as well.

An equally impressive feature may well be her capacity: she carries just 138 guests, a commitment to expedition excellence over scale. Scandinavian-inflected, luxuriously appointed, her inviting interiors would be a destination in themselves. Because she is a Lindblad expedition ship, however, her attention is focused on the world outside – with acres of window glass to keep you connected to the stunning views beyond the pane, and a fleet of expedition tools to get you out exploring.

National Geographic Endurance and *National Geographic Resolution* are next-generation expedition ships. Purpose-built for polar navigation. Fully stabilized, highly strengthened, ice-class Polar Code PC5 (Category A) vessels, they are designed to navigate polar passages year-round, and safely explore uncharted waters, while providing exceptional comfort. The patented X-bow[®] is key to their design; its powerful wave-slicing action provides an extremely smooth ride even in adverse conditions, and even reduces spray on deck for superior observation. They carry a full suite of expedition tools, and offer a variety of experience enhancing amenities.



Cabin Categories

Category 1

FORE DECK #404, 406, 408, 411, 413, 415

Cabin with two large windows, two singles that can convert to a queen, writing desk and chair, two bedside tables, window sofa, coffee table, and a closet.



Category 2

FORE DECK #410, 412, 414, 416-419, 421-427

Cabin with two large windows, two single beds that can convert to a queen, window sofa, two-seat sofa, coffee table, writing desk with an office chair, two bedside tables, coffee table, and a closet.



Category 3

MAIN DECK #512-524

Cabin with balcony that features two balcony chairs, hammock, and a table; two single beds that convert to a queen; convertible sleeper sofa; writing desk with a chair; two bedside tables; coffee table; and a closet.



Category 4

LOUNGE DECK #608, 610, 612, 613-623

Cabin with balcony that features two balcony chairs, hammock and a table; two single beds that can convert to a queen; pull-out sofa; coffee table; writing desk with chair; two bedside tables; and a closet.



Category 5

BRIDGE DECK #700-707, 712, 713, 715, 717

Cabin with balcony that features two balcony chairs, hammock, and a table; two single beds that convert to a queen; convertible sleeper sofa; coffee table; writing desk with chair; two bedside tables; and a closet.



Category 6

BRIDGE DECK #714

Junior suite with balcony that features two balcony chairs, hammock, and table; two single beds that convert to a queen; pull-out sofa; writing desk with chair; two bedside tables; coffee table; espresso maker and a closet. Guests receive priority access to one spa treatment and one igloo reservation and complimentary laundry per departure.



Category 7

BRIDGE DECK #708-711, 716, 718, 719, 721

These large balcony suites feature two balcony chairs, hammock, and table; two single beds that can convert to a queen; pull-out sofa; coffee table; writing desk and chair; espresso maker; and a large walk-in closet with full length mirror. Expanded bathroom has a double vanity, bathtub, towel warmer and rain shower. Guests receive priority access to one spa treatment and one igloo reservation and complimentary laundry per departure.

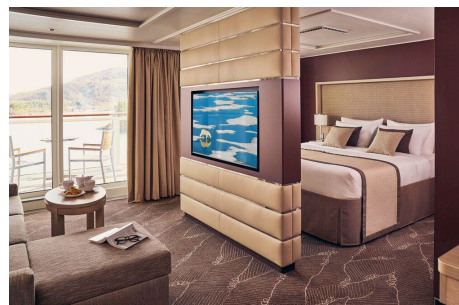

Category A Solo

MAIN DECK #504-510, 513

Cabin with balcony that features two balcony chairs, hammock, and a table; single bed; writing desk with an office chair; and a closet.



Category B Solo

LOUNGE DECK #604-607, 609, 611

Cabin with balcony that features two balcony chairs, hammock, and a table; single bed; writing desk with chair; hammock; and a closet.



Deck Plans

Observation Deck

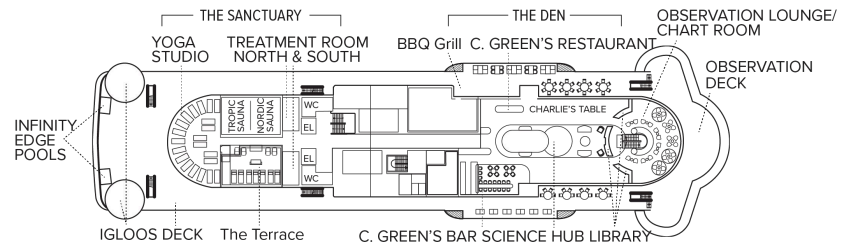

Bridge Deck

- Category 5
- Category 6
- Category 7



Lounge Deck

- Category 4
- Category B Solo

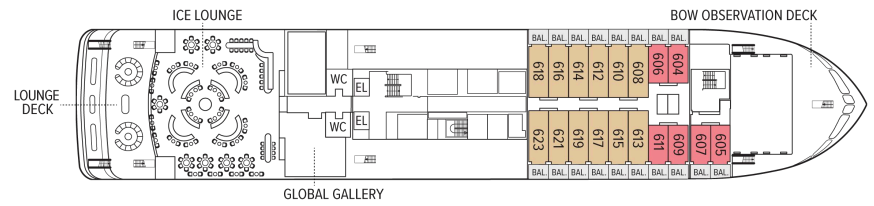

Main Deck

- Category 3
- Category 2 Solo

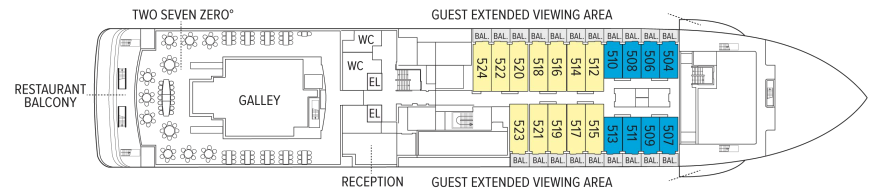

Fore Deck

- Category 1
- Category 2

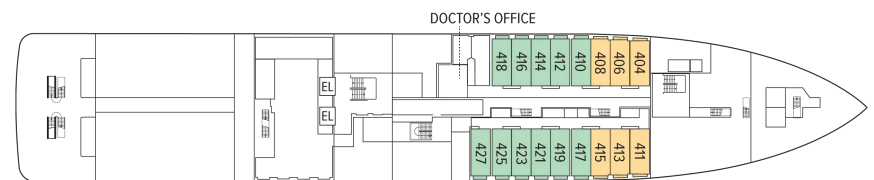

Expedition Deck

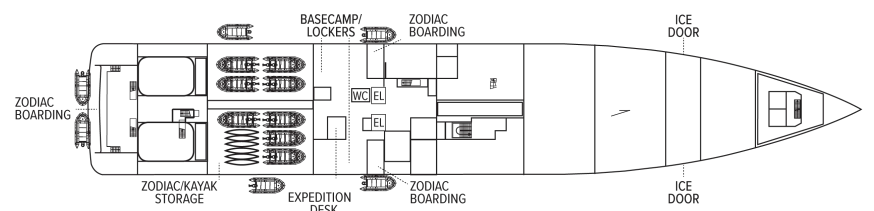

Ship Amenities

Public Areas

Reception; three dining areas; an observation lounge with bar, gym, wellness area, infinity-style outdoor hot tubs with adjacent igloos; library; main lounge with full service bar, 24-hour beverage station, state-of-the-art tech for films/presentations; OM System photo locker and a photo workshop area; science hub; an onboard broadcast studio; an expedition base with lockers for expedition gear; and open access to the Bridge, Captain, officers and on-duty wildlife spotters.

Meals

Restaurant 270° features wrap-around views; two other dining areas offer lighter, made-to-order fare or intimate, small group dinners. All feature sustainable choices, local where possible, and unassigned, flexible, inclusive seating.

Cabins

All cabins face outside with large windows, private bathroom, and climate controls. Cabins are equipped with expedition command centers with iPad tablets, multiple electrical and USB outlets, TVs, with on demand entertainment, phone, Wi-Fi, clock, barometers, hygrometers, vanity mirror, mini refrigerator, small safe, ice bucket, glasses, hair dryer, reading lights and National Geographic Atlas. Luxury linens and pillows. Bathrooms outfitted with Rain showers & hand held shower, botanically inspired shampoo, conditioner, shower gel and lotion. Complimentary insulated water bottles. Balcony cabins have hammocks, chairs and table.

Expedition Equipment

Zodiac landing craft, kayaks, snowshoes, cross-country skis, an ROV and underwater video camera for unique access to the polar undersea, hydrophone, aerial remote-controlled camera and video microscope.

Special Features

A full-time doctor, undersea specialist, National Geographic photographer, National Geographic-Lindblad Expeditions certified photo instructor and video chronicler, an internet cafe and laundry. A forward and aft staircase, and elevators, reach all decks. Echoing the pioneering installation aboard *National Geographic Endurance*, artist Zaria Forman has curated a new exhibit featuring a wide range of artists.



Wellness

A glass-enclosed yoga studio, gym, treatment rooms and spa relax area, and high and low-heat saunas with ocean views, staffed by wellness specialists.

Self-Disinfecting Ships

ACT Clean Coat™ is a light-activated, self-disinfecting cleaning process that continuously breaks down viruses, bacteria, mold, and airborne allergens across all ship surfaces. Not only does this create a cleaner, healthier shipboard environment for guests and crew alike, but this non-toxic, chemical-free system also saves more than one million gallons of water each year in our cleaning procedures, and reduces our carbon footprint as well as the amount of plastic and waste in our supply chain.

Special Offers

SAY YES—TO GOING WITHOUT SECOND THOUGHTS

Receive savings of £1100 per guest deducted from cabin fare on select 2026 voyages when you pay in full at time of booking. Applicable savings will be deducted from cabin fare before any additional savings with the purchase of cabin fare. To qualify for the savings, nonrefundable payment in full is due at time of booking. This promotional offer is subject to separate terms and conditions. Standard cancellation, refund, and change policies do not apply. All amounts paid in connection with this promotion are non-refundable and non-transferable, regardless of cancellation date, and no refund, credit, or compensation will be provided except as expressly stated herein. Promotional offer valid on new bookings only for select 2026 departures, subject to availability and offer may be withdrawn at any time without prior notice, not applicable on airfare or extensions, and may not be combined with other promotions. Additional restrictions may apply.

SUITE EXCLUSIVES

Spacious living areas and incredible views immerse you in the beauty of your marine surroundings. Our new Suite Exclusives package helps make your voyage all the more memorable. [Learn more](#)

CELEBRATE LIFE'S MILESTONES

Celebrate a milestone with a group of eight or more and enjoy a special amenity package including: 5% savings on voyage fares, custom group photo, US\$150 shipboard credit for the group, and other special

gifts. Milestone celebration to be communicated at time of booking.

COMBINING OFFERS

Certain offers may be combinable, up to two savings opportunities, except where noted otherwise. For example, travel with a group of 8 or more on back-to-back expeditions, and take advantage of both savings.

10% OFF BACK-TO-BACK VOYAGES

Save 10% on consecutive departures, applicable on voyage fares only and not valid on extensions or airfare. Valid for new bookings only, subject to availability, and may not be combined with other offers. Call for details.

SAVE 5% TRAVELING AS A GROUP

Save 5% when traveling as a group of 8 or more people. Valid for new bookings only on select departures, subject to availability, not applicable on extensions, and may not be combined with other offers. Call for details.

INCLUDED IN PRICE

All accommodations aboard ship or in hotels per itinerary; all meals as indicated in the itinerary, both aboard and onshore; beer, wine, cocktails, liquors and spirits aboard the ship (except certain premium brands which are available for purchase); hors d'oeuvres, 24-hour access to snacks, premium coffees and teas, non-alcoholic beverages, and filtered water; excursions and airport transfers to and from recommended flights, as indicated in the itinerary; crew gratuities; exploration tools curated to destination, such as Zodiacs, kayaks, guidance and company of our leading expedition staff; assistance by the National Geographic Photographer and Lindblad Expeditions-National Geographic certified photo instructor; access to the OM System Photo Gear Locker; presentations by expedition staff and expert guest speakers; complimentary parka or jacket, complimentary reusable water bottle; onboard physician consultations; morning stretch classes and 24-hour access to exercise equipment; 24-hour access to lounges, observation decks, library, and other shared spaces; park and site entrance fees, special access permits, and port taxes. Unused services or items included in our programs are non-refundable.

NOT INCLUDED IN PRICE

Airfare (except flights* when indicated as included); pre- and post-expedition extensions; additional hotel nights (except when indicated as included); private transfers; laundry, spa treatments, Wi-Fi, and phone services (except when indicated as included); travel protection plans; and passport, visa, and immigration fees.

*Recommended flight costs include flight(s) that take place during the date range of your trip to transport

travelers from one itinerary destination to another. This cost also includes ground transportation, luggage transfer, and airport assistance. If you prefer to arrange your own flights privately, have alternate means of transport, or wish to modify at a later time, please contact an Expedition Specialist at 1.833.400.0831

Additional costs associated with medical services outside onboard physician consultation.

TRAVEL PROTECTION PLAN

We strongly recommend our guests to take advantage of our Travel Protection Plan. This plan offers comprehensive coverage to protect you from cancellation fees, costs incurred due to trip delays/interruption, damage or loss of baggage, medical assistance, and evacuation during your travels. Our Travel Protection Plan is available for U.S. residents only, and may be purchased any time prior to final payment due date, Travel Protection premiums are non-refundable once plan is purchased. Learn more about our Travel Protection "Plus" Plan: <https://www.expeditions.com/terms-conditions/travel-protection-plan/>

CANCELLATION POLICY

Review our cancellation policy: <https://www.expeditions.com/cancellation-policy/>