

Pacific Northwest &amp; North America

45° 30' N 122° 40' W

# Columbia River: Harvests, History and Landscapes of the Pacific Northwest





terroirs of the Pacific Northwest through an onboard wine list curated by *Food & Wine* Executive Wine Editor Ray Isle.

Journey through the Pacific Northwest on the Columbia River, where soaring basalt cliffs, fertile valleys and historic river towns reveal the rich natural and cultural history of one of North America's most iconic waterways. Sail through landscapes shaped by glacial floods and volcanic forces alongside experts in geology and history, tracing the route of Lewis and Clark's Corps of Discovery between the Columbia Gorge and the Pacific coast. This voyage also offers immersive culinary experiences that celebrate the flavors of the Pacific Northwest. Enjoy private tastings with local winemakers, savor seasonal cuisine inspired by the region's agricultural bounty, and explore the distinctive

From

**\$ 6,150** / per person

**Does not include flights**

 <b>DATES</b> Oct	 <b>DURATION</b> 8 Days
 <b>SHIPS</b> <i>National Geographic Venture</i>	
 <b>STARTS AT</b> Portland, Oregon	→  <b>ENDS AT</b> Portland, Oregon

# Highlights

- ★ Marvel at Multnomah Falls and hike iconic Beacon Rock—an 848-foot basalt monolith rising straight from the Columbia River
- ★ Explore the Columbia River Gorge, a landscape carved by the Missoula Floods more than 13,000 years ago, alongside geology experts to illuminate the forces that shaped it
- ★ Savor gourmet, seasonal menus featuring ingredients sourced primarily from the surrounding Pacific Northwest region
- ★ In Astoria, trace the footsteps of the Corps of Discovery at Cape Disappointment, where Meriwether Lewis first glimpsed the Pacific in 1805





## Day by day

### ■ DAY 1

#### Portland, Oregon / Embark Ship

Arrive in the early afternoon in Portland, located in the shadow of snow-capped Mount Hood. Embark in the early evening and enjoy wine and champagne as the ship sails along the Willamette River under eight of Portland's 12 eclectic bridges.

**Arrival Time:** Arrive by 3:00 p.m. local time.

**Arrival City:** Portland, Oregon

Meals included: dinner

### ◇ DAY 2

#### Cruising the Columbia Gorge

Witness natural and man-made marvels as you navigate the scenic Columbia River Gorge and pass through the Bonneville Lock and Dam. Enjoy a fresh-brewed coffee on the bow, where your naturalists offer insightful perspectives on the controversial history of dams along the river. Later, enjoy an onboard tasting with your wine specialist while learning about the local terroirs.

Meals included: breakfast, lunch, dinner

### ◇ DAY 3

#### Walla Walla, Washington

Drive through some of the most fertile agricultural areas in the nation, with bright, rolling green and purple fields of sprouting wheat, asparagus and famous Walla Walla sweet onions. This morning, discover the city's thriving art scene on a guided tour, or choose to visit the Whitman Mission, a standout National Historic Site where friction between Native Americans and white missionaries erupted into an event that continues to reverberate in American culture today. After lunch at a local winery, explore charming

downtown Walla Walla at your leisure, perusing local galleries, sampling sweets at one of the country's best candy stores or stopping in cozy wine-tasting rooms.

Meals included: breakfast, lunch, dinner

### ◇ DAY 4

#### Cruising the Columbia Gorge

Spend the day cruising through some of the most picturesque and geologically significant stretches of the Columbia River and the Columbia Plateau. Your geologists will provide insight on the glacial floods that sculpted the landscape 13,000 years ago, as your food and wine expert highlights the tastes and tannins of this unique terrain. Relive the historic tales of Lewis and Clark's Corps of Discovery through the eyes of a historian as you sail by key landmarks.

Meals included: breakfast, lunch, dinner

### ◇ DAY 5

#### The Dalles or Hood River, Oregon

Make a stop at the towering Multnomah Falls before an optional hike to the iconic Beacon Rock, a basalt column towering 848 feet above the Columbia River. Later, enjoy a private event with Syncline Winery at the Columbia Gorge Interpretive Center. Savor canapes and Syncline's distinctive wines as you take in 15,000 years of cultural history, including Indigenous art and a massive working steam engine.

Meals included: breakfast, lunch, dinner

### ◇ DAY 6

#### Astoria

In the morning, navigate the Columbia River to its mouth in Astoria. Later, choose to explore Cape

Disappointment and take in the dramatic scenery where Meriwether Lewis first glimpsed the Pacific Ocean in 1805. Alternatively, enjoy a scenic hike to the Lewis and Clark Interpretive Center or embark on a culinary heritage walk.

Meals included: breakfast, lunch, dinner

◇ DAY 7

## Astoria

This morning, choose to visit the Columbia River Maritime Museum and learn about the estuary's navigational hazards and history of shipwrecks. Alternatively, take a shuttle to the Astoria Column—a monument to the natural riches of the Pacific Northwest—or explore Astoria's shops and restaurants at your own pace. In the afternoon, enjoy a scenic cruise accompanied by local wine tastings on board.

Meals included: breakfast, lunch, dinner

■ DAY 8

## Portland / Disembark Ship

Disembark in Portland after breakfast and transfer to the airport for flights home.

Meals included: breakfast

## Expedition

Portland, Oregon → Portland, Oregon

### 2027 DEPARTURE DATES

Aboard *National Geographic Venture*

11 Oct

18 Oct

25 Oct



## National Geographic Venture

GUESTS

100

CABINS

50

**The *National Geographic Venture* is a state-of-the-art expedition ship ideal for discovering remote locations in domestic waters.**

Following the build of *National Geographic Quest* at Nichols Brothers shipyard, her sister ship, *National Geographic Venture*, floated into the bay on Whidbey Island, Washington, becoming the 4th ship in the Lindblad fleet built at this storied shipyard. In the 1970s, Nichols Brothers built the twin ships *National Geographic Sea Bird* and *National Geographic Sea Lion*, which continue to sail the waters of the west coast of North America and Central America.

*National Geographic Venture*, like much of the wildlife she follows, is migratory. She follows the seasons from Alaska, along the coast of British Columbia, up the Columbia and Snake Rivers and along the Baja California coast. In each region, her design innovations were informed by 50+ years of expedition expertise to ensure extraordinary discoveries. *National Geographic Venture's* shallow draft enables her to provide intimate 'insider' experiences of the charismatic regions we explore.

Like her sister ship *National Geographic Quest*, *National Geographic Venture* has dual boarding platforms. Enabling our team to load two Zodiacs at once means guests get off ship quickly to take advantage of wildlife sightings and maximize exploring time. Modern and clean-lined, with large expanses of glass to keep you connected to the extraordinary views, *National Geographic Venture* enables you to see, do and experience the best of her geographies.



# Cabin Categories

## Category 1

MAIN DECK #301-306

Cabins feature two single beds that can convert to a Queen, a writing desk, two nightstands and two portholes, full length mirror, and reading lights.



## Category 2

MAIN DECK #307-315

Cabins feature two single beds that can convert to a Queen, a writing desk, two nightstands and two portholes, full length mirror, and reading lights.

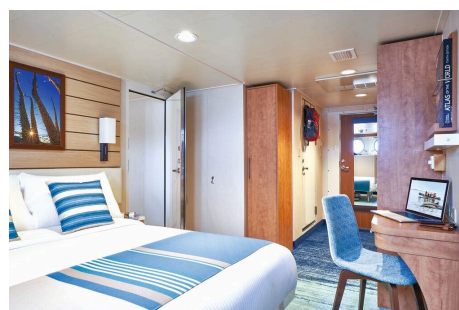

## Category 3

UPPER DECK #201-206

Cabins feature two single beds that can convert to a Queen, a writing desk, two nightstands, a large view window, full-length mirror, and reading lights.

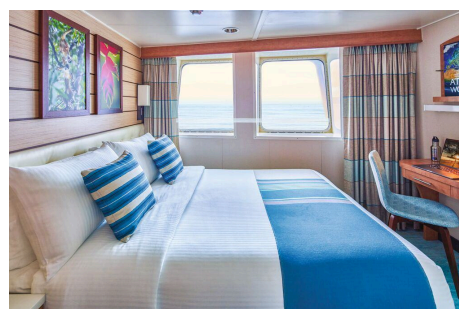

## Category 4

UPPER DECK #207-229

Cabins feature two single beds that can convert to a Queen, a writing desk, closet, two nightstands, full-length mirror, reading lights, sliding glass door, and a small, private balcony.



### Note:

Solo occupancy cabins are available in Categories 1 and 2 only. Third person rates are available in Category 5 cabins at one half the double occupancy rate.

### Connecting Cabins via internal doorway access:

Main Deck: #312-314, #311-315, #306-307;  
Upper Deck: #224-226, #225-227

## Category 5

### OBSERVATION DECK #101-108 (SUITE)

Cabins feature two single beds that can convert to a Queen, large view windows, closet, two nightstands, full-length mirror, reading lights, a suite-sized expanded bathroom, writing desk, ample storage space, and a convertible sofa bed to accommodate a third person.



# Deck Plans

## Observation Deck

Category 5

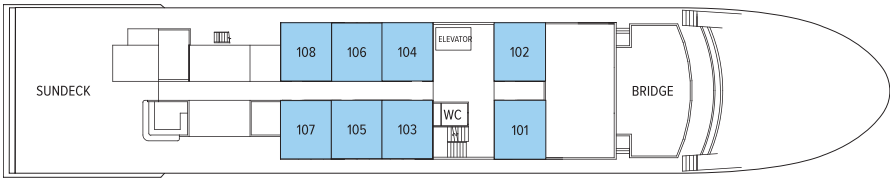

## Lounge Deck

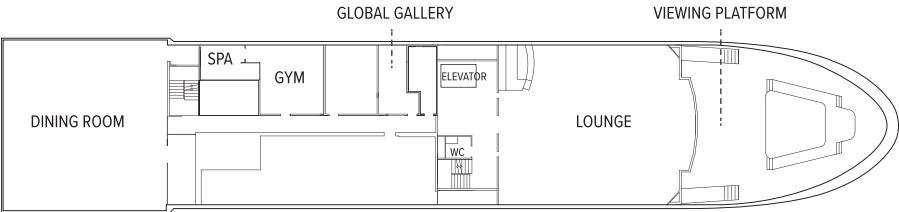

## Upper Deck

Category 3

Category 4

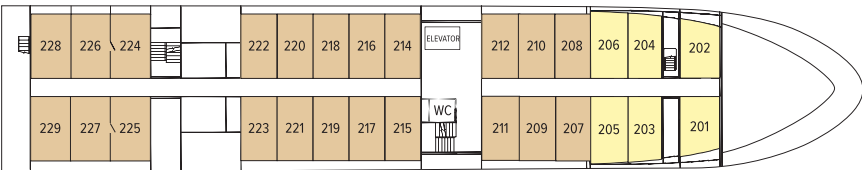

## Main Deck

Category 1

Category 2

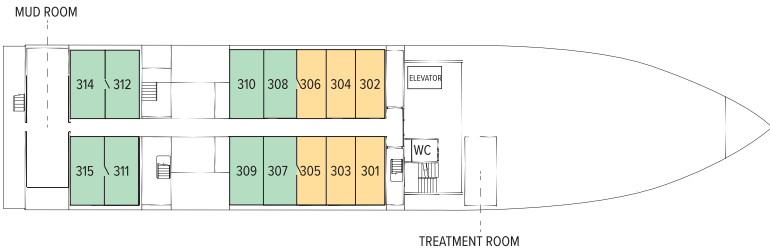

# Ship Amenities

## Public Areas

Reception; main dining area; global gallery; fitness center; lounge with full-service bar and state-of-the-art presentation facilities; observation deck; mudroom with lockers for expedition gear; partially-covered furnished sundeck; plus open access to the Bridge, the Captain, officers and on-duty wildlife spotters.

## Meals

Meals are served in the dining room at a single seating with unassigned tables for an informal atmosphere and easy mingling. Menus feature sustainable choices, local where possible.

## Cabins

50 outside cabins. All cabins face outside with windows, private bathroom, and climate controls. Cabins are equipped with Wi-Fi, phone, multiple electrical and USB outlets, and phones. Luxury linens and pillows. Botanically inspired shampoo, conditioner, shower gel, and lotion are all available in cabin bathrooms, as well as an Expedition Essential Kit. Hair dryers, complimentary insulated water bottles and a National Geographic Atlas are also available in each cabin.

## Expedition Equipment

A fleet of 8 Zodiacs, 24 kayaks, paddleboards; an ROV, hydrophone, splash-cam, underwater video camera, video microscope; snorkeling gear and wet suits for all guests (where applicable).

## Special Features

Internet access. Elevator. The design of the outside decks—with the perfect wildlife viewing platform. The proximity of the Lounge to the deck gives you instant access to spontaneous sightings. Have your camera ready!



## Wellness

A fitness center with elliptical, treadmill, weights and resistance bands; LEXspa treatment room, staffed by wellness specialists.

## Self-Disinfecting Ships

ACT Clean Coat™ is a light-activated, self-disinfecting cleaning process that continuously breaks down viruses, bacteria, mold, and airborne allergens across all ship surfaces. Not only does this create a cleaner, healthier shipboard environment for guests and crew alike, but this non-toxic, chemical-free system also saves more than one million gallons of water each year in our cleaning procedures, and reduces our carbon footprint as well as the amount of plastic and waste in our supply chain.

## Special Offers

### 50% REDUCED DEPOSIT

Book between June 10 and August 18, 2026 and receive 50% off deposit at the time of booking on voyages departing October 1, 2026 through December 31, 2027 if booked outside of final payment. Remaining deposit balance is due at the time of final payment. Standard cancellation policy applies. Additional restrictions may apply. Offer valid for new bookings, subject to availability and offer may be withdrawn at any time without prior notice, not applicable on airfare or extensions, and may not be combined with other offers. Call for details.

### CELEBRATE LIFE'S MILESTONES

Celebrate a milestone with a group of eight or more and enjoy a special amenity package including: 5% savings on voyage fares, custom group photo, US\$150 shipboard credit for the group, and other special gifts. Milestone celebration to be communicated at time of booking.

### 10% OFF BACK-TO-BACK VOYAGES

Save 10% on consecutive departures, applicable on voyage fares only and not valid on extensions or airfare. Valid for new bookings only, subject to availability, and may not be combined with other offers. Call for details.

### COMBINING OFFERS

Certain offers may be combinable, up to two savings opportunities, except where noted otherwise. For example, travel with a group of 8 or more on

back-to-back expeditions, and take advantage of both savings.

### PAY BY DEBIT: EARN A \$100 ONBOARD CREDIT

The \$100 onboard credit offer is applied after the final payment and requires 85% of the cost of the voyage to be placed on a debit card. Maximum of one \$100 onboard credit per cabin. The \$100 onboard credit is a non-refundable, non-transferable credit that can be used for various onboard purchases such as global gallery and spa treatments. It has no cash value, cannot be refunded if not fully utilized, and will be forfeited if not fully redeemed by the end of the voyage. This offer is combinable with other offers. If the booking is altered or canceled, the onboard credit may be forfeited, and it cannot be transferred if the booking is moved to another guest. Lindblad Expeditions reserves the right to modify or cancel the offer without prior notice. Offer applies to Lindblad Expeditions' owned ships only. Offer valid only for Debit Cards issued in the United States for payments made from the United States.

## INCLUDED IN PRICE

All accommodations aboard ship or in hotels per itinerary; all meals as indicated in the itinerary, both aboard and onshore; beer, wine, cocktails, and spirits (premium brands available for purchase) aboard; excursions and airport transfers to and from flights arriving and departing within recommended window, as indicated in the itinerary; exploration tools such as Zodiacs, kayaks, and stand-up paddleboards (where applicable); guidance and company of leading expedition staff; presentations by expedition staff and expert guest speakers; complimentary reusable water bottle; onboard physician consultations (where available); 24-hour access to exercise equipment (where applicable); 24-hour access to lounges, observation decks, library, and other shared spaces; basic Wi-Fi (where applicable); park and site entrance fees, special access permits, and port taxes. Unused services or items included in our programs are non-refundable.

## NOT INCLUDED IN PRICE

Airfare (except flights when indicated as included and/or as required); charter airfare (where applicable, except when indicated as included and/or as required); pre- and post-expedition extensions (except flights when indicated as included); additional hotel nights; premium cocktails and spirits; private transfers (except when indicated as included); crew gratuities; additional costs associated with medical services outside onboard physician consultation (where applicable); enhanced and premium Wi-Fi plans aboard expedition fleet; laundry, spa treatments, and phone services; travel protection plans; passport, visa and immigration fees. For select voyages, completing a medical evaluation form with VIKAND is required. If you utilize your physician, VIKAND's processing fee for your documentation

will be added to your National Geographic-Lindblad Expeditions invoice. If you utilize VIKAND's physicians, an additional charge will be due and payable directly to VIKAND.

## TRAVEL PROTECTION PLAN

We strongly recommend our guests to take advantage of our Travel Protection Plan. This plan offers comprehensive coverage to protect you from cancellation fees, costs incurred due to trip delays/interruption, damage or loss of baggage, medical assistance, and evacuation during your travels. Our Travel Protection Plan is available for U.S. residents only, and may be purchased any time prior to final payment due date, Travel Protection premiums are non-refundable once plan is purchased. Learn more about our Travel Protection "Plus" Plan: <https://www.expeditions.com/terms-conditions/travel-protection-plan/>

## CANCELLATION POLICY

Review our cancellation policy: <https://www.expeditions.com/cancellation-policy/>